

PREMIER

WALL PLATE INSTRUCTIONS FOR TV MOUNTS

PVWP-20

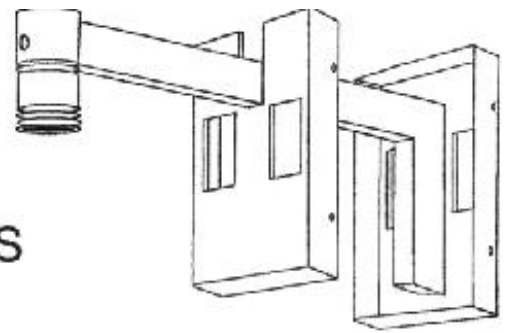

PARTS LIST

Qty	Part #	Description
1	022-1630	Back Plate Assembly
1	010-2207	Back Plate Cover

HARDWARE LIST

Ref	Qty	Part #	Description
AA	3	030-0724	1/4 x 2 1/2" Hex Screw
BB	4	030-0298	#8 x 3/8 Phillips Sheet Metal Screw
CC	1	030-0297	1/4-20 x 3/8" Set Screw

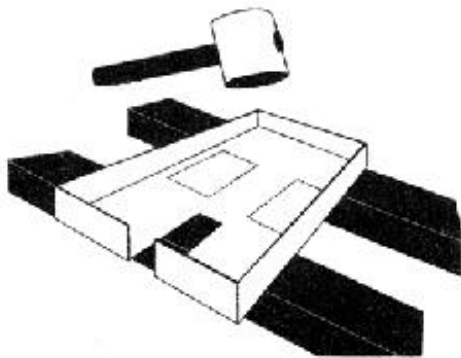

STEP 1

For your convenience there are two knockout holes in the back plate cover. If cable management is necessary, knock out one or both rectangular openings simply by placing some support under the back plate and tapping at the holes with a mallet or hammer.

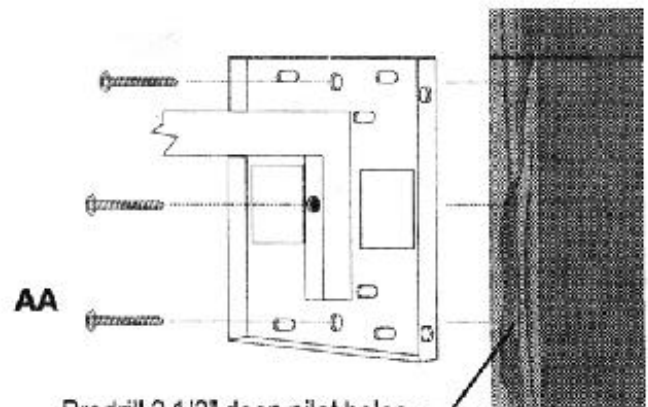

Predrill 2 1/2" deep pilot holes using a drill with an 1/8" dia. drill bit installed

STEP 2

Attach back plate assembly with screws (AA) to a single wall stud. To ensure proper installation of TV mount, use the bottom edge of the back plate as a guide for leveling.

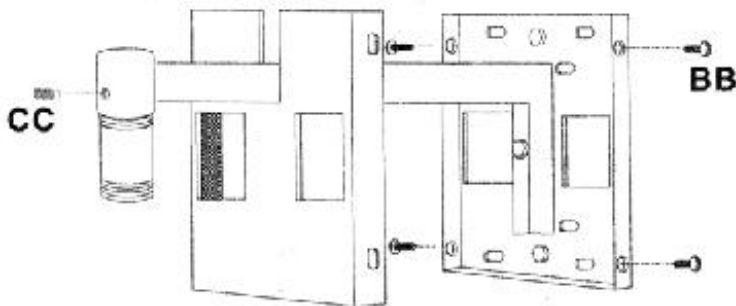

STEP 3

Complete electrical work before attaching back plate cover to back plate assembly with screws (BB). Tighten set screw (CC) to lock pipe in place.

WARNING: This unit is **not** designed to be a **swivel** unit. If you wish to use it as a swivel unit, Bretford model **TVRA must be used** along with this unit.

Progressive Marketing Products, Inc.

2980-A Enterprise Street, Brea Ca, 92821
Ph (800) 368-9700 Fax (800) 932-4888
E-mail: pmp@pmp.com Web Site: www.pmp.com