

# PBM-250L

## Projector Mount INSTALLATION INSTRUCTIONS

**NOTE:** If the (Optional) **AST-2446** adjustable height suspension adapter is a part of the installation, securely install the ceiling adapter to the ceiling at this time.

### Step 1

Invert the projector and place it on a soft and flat surface. Locate the five (5) 8 (mm) mounting points found on the bottom of the projector. Align the mounting bracket (B) to the projector (C) and secure the bracket with the five (5) 8 (mm) x 35 (mm) Phillip Screws (A) Lock Washers (D) Flat Washers (E) (supplied).

**Do not over tighten!**  
See Figure 1

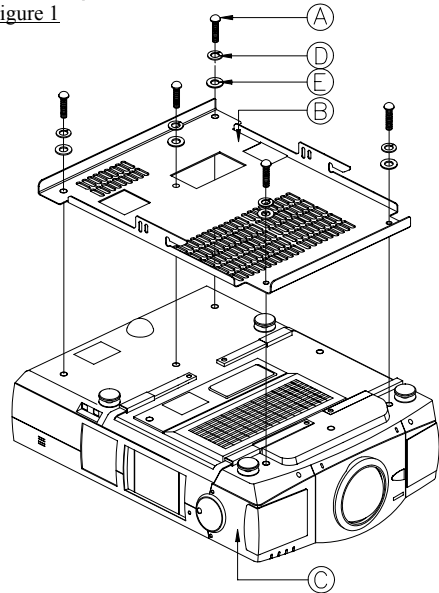

**F1**

### Step 2

Install the base box securely to the ceiling structure in accordance with proper commercial standards. Use (commercially available) suitable hardware depending on the installation requirements.

### (Refer to its Installation Instructions)

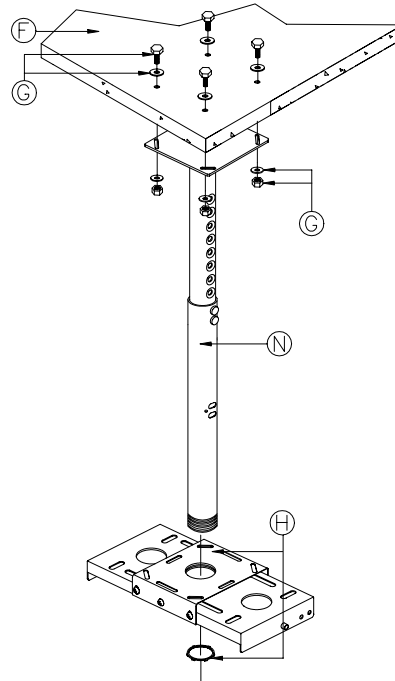

**-AST-2446-**

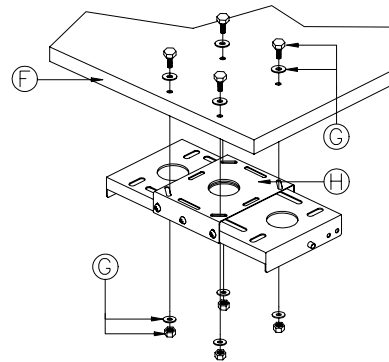

**-FIXED CEILING MOUNT-**

### Step 3

Install the two (2) conical spacers (L) and two (2) flat washers (K), two (2) hinge pin screws (J) loosely on both sides of the base box (H). Raise the projector with the mounting bracket attached and slip through the hinge pin slots openings on the bracket into the base box. Install the two (2) angle locking screws (I). Adjust the angle, lock it, and then tighten the hinge pin screws.

See Figure 2

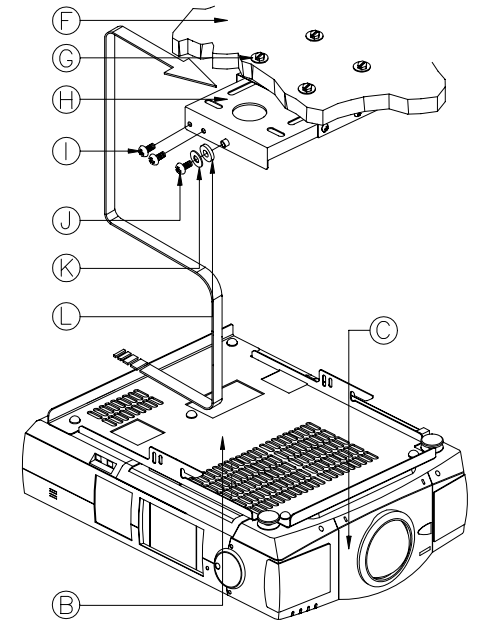

**F2**

### Step 4

Check all the hardware for proper tightness and security. Do not over tighten hardware.

Continue



□ **Step 5**

Install the two (2) conical spacers (L) and two (2) flat washers (K), two (2) hinge pin screws (J) loosely on both sides of the base box (H). Raise the projector with the mounting bracket attached and slip through the hinge pin slots openings on the bracket into the base box. Install the two (2) angle locking screws (I). Adjust the angle, lock it, and then tighten the hinge pin screws.

See Figure 3

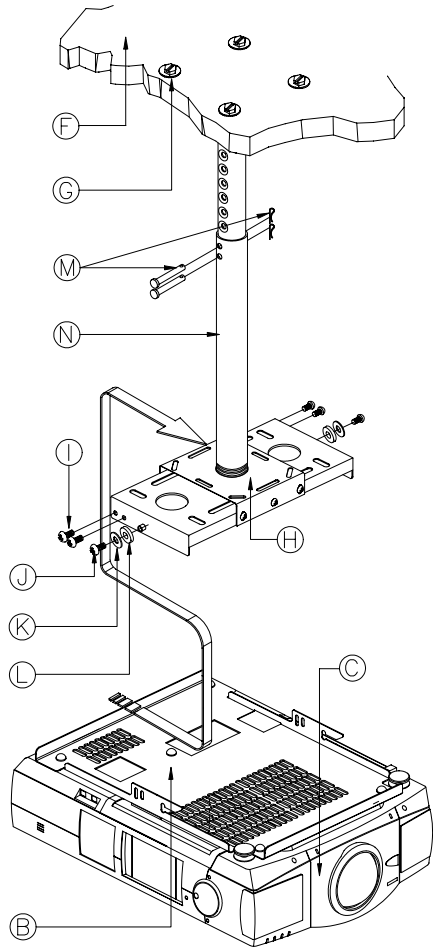

**F3**

Check all hardware for proper tighten and security.

# WARNING!

The ceiling should be capable of supporting a weight of at least five (5) times the projector(s) or monitor(s) weight. If it cannot, the ceiling must be reinforced. Proper installation procedure by qualified personnel as outlined in the installation instructions must be adhered to. Failure to do so could result in serious personal injury.

### DESCRIPTION/HARDWARE

- A. 8 (mm) x 35 (mm) Phillip Screws (5ea)
- B. PBM-250L Mounting Bracket (1ea)
- C. Projector (Not Supplied)
- D. Lock washers (5ea)
- E. Flat Washers (5ea)
- F. Ceiling Structure (See Warning Label)
- G. Suitable Hardware (Commercially Available)
- H. PBB-20RL Base Box (1ea)
- I. 6 (mm) x 12 (mm) Angle Locking Screws (2ea)
- J. 6 (mm) x 12 (mm) Hinge Pin Screws (2ea.)
- K. Flat Washers (2ea)
- L. Conical Spacers (2ea)
- M. Suspension Adapter Adjustable Pins (2ea)
- N. AST-2446 Suspension Adapter (Optional)

# INSTALLATION INSTRUCTIONS

## PBM-250L PROJECTOR MOUNT



Supplying  
the  
world  
with  
superior  
mounts

For further information or ordering assistance  
contact us at the phone/address number shown  
on the front of this page.



*"We're Customer Driven"*

