

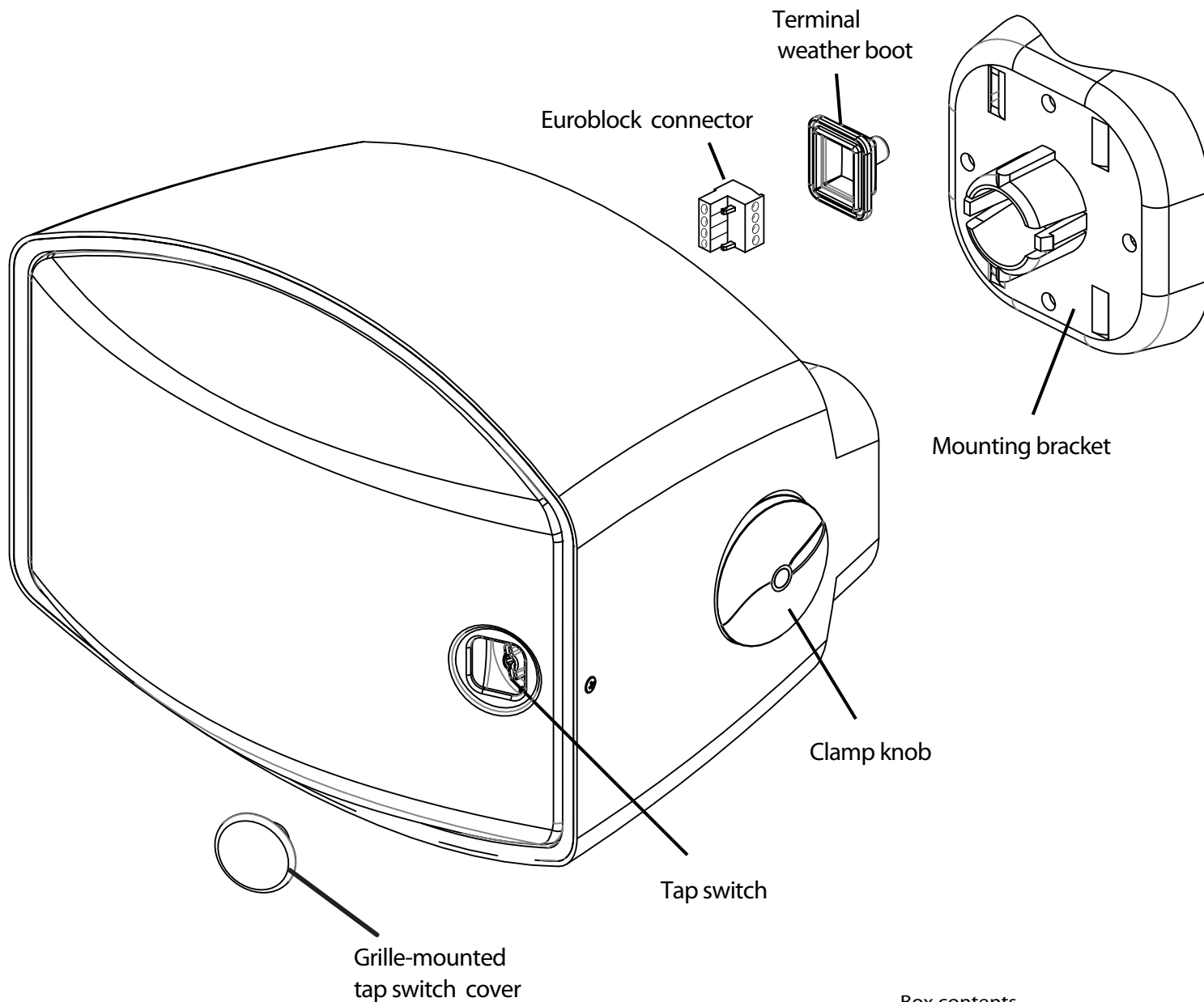

SM5 Series

Install Instructions For:
SM500i-II, SM500i-II-WX, SM590i-II, SM590i-II-WX speaker

1.435.647.9555 | 800.647.TUBE | www.soundtube.com



Box contents

- 1 Speaker
- 1 Terminal weather boot
- 1 Mounting bracket
- 1 Safety cable
- 1 Safety cable anchor screws
- 1 Euroblock connector
- 1 Grille-mounted tap switch cover
- 1 Allen hex key
- 1 M3x4mm security screw

SM500i-II, SM500i-II-WX, SM590i-II, SM590i-II-WX UL1480 (UEAY) planned

©2011 SoundTube Entertainment, Inc. All rights reserved. PNNS-SM5 rev 11.30.11

Warning

SoundTube speakers must be installed by a professional audio installer/contractor. For safety and for optimum audio performance, installer must follow all directions issued by SoundTube Entertainment.

Warning

Do not spec or install speaker near support beam, ventilation duct or other structure that may interfere with speaker function or dispersion.

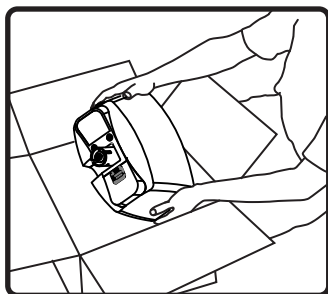

1. Unpack speaker and mounting hardware.

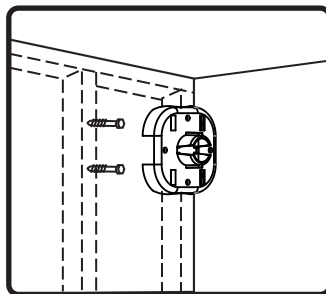

2. Choose a secure mounting surface with sufficient strength to reliably hold the speaker. Note: Bracket orientation does not matter for installation of the mounting bracket.

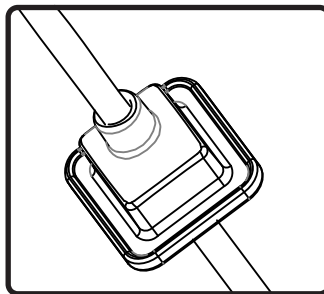

3. Slip terminal weather boot over signal wire. For environmental applications, put RTV silicone around nipple and base when installation is complete.

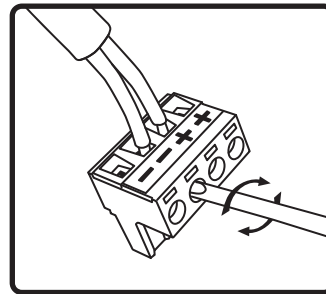

4. Connect signal wire to 4-pin Euroblock plug. Tighten unused terminal screws. Use inside positive and negative inputs for either voice coil or distributed systems. For daisy chaining, use outside positive and negative terminals.

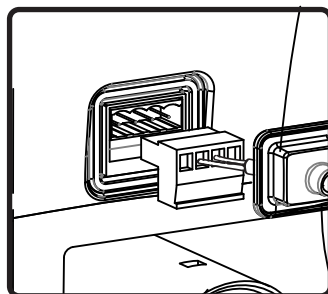

5. Insert 4-pin Euroblock plug into Euroblock jack on rear of speaker. Connectors are keyed for polarity. Terminal weather boot will seal the enclosure on rear of speaker.

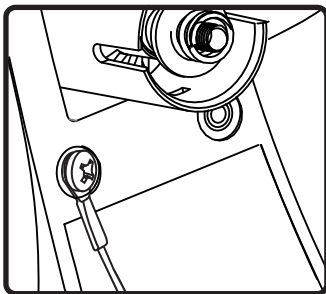

6. Use supplied screw to connect the safety cable to one of the inserts on the rear panel of the speaker. Connect other end of the safety cable to a secure mounting point.

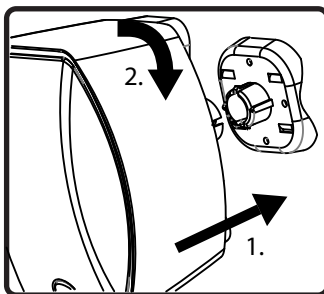

7. Line up bracket ribs with mounting tube slots and press speaker onto bracket. Twist clockwise until speaker clicks. Speaker is now locked in place.

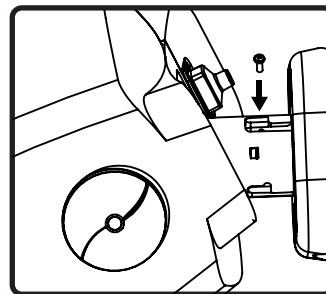

8. If speaker is within reach of the public, or extra security is desired, install the included M3x4mm security screw.

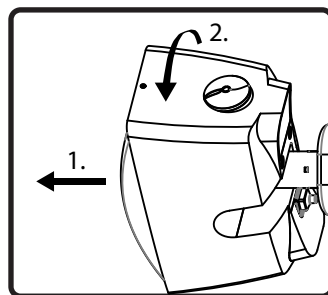

9. Firmly grip speaker and pull it away from the wall to rotate to desired mounting angle about the mounting shaft axis. Simply release speaker back toward the wall to lock into place.

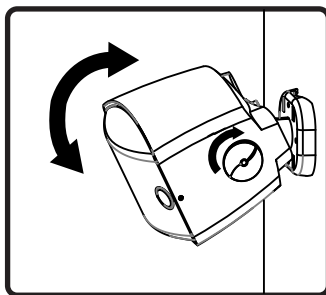

10. Make sure knob is loose, and aim speaker in desired direction (0 to 90). Tighten the knob to lock the speaker in place. FINGER TIGHT IS SUFFICIENT- DO NOT OVER TIGHTEN.

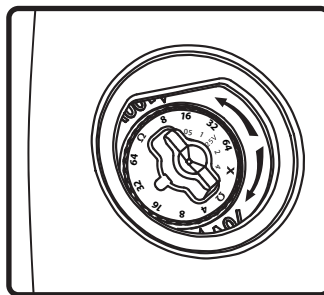

11. Select the tap position by removing the rubber plug on grille to access rotary switch. Switch is preset to maximum tap setting in 70.7V mode. Select desired setting and reinsert rubber plug.

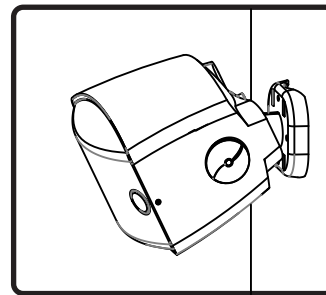

12. Done.

To loosen, use included hex key.