

Includes power supply with NEMA 1-15 plug and three adaptors



Made in U.S.A. with global components

Compact low voltage four step sequencer model SEQ-4A is designed to work with a single external switch or voltage input and low voltage remote power controls (RPCs) to provide time-delayed activation and deactivation of AC powered equipment on site or at remote locations.

Note: This sequencer is for use with compatible components that feature classic connections. It is not for use with devices that feature pass-through connections.

FEATURES:

- **Power Requirement:** 100-240VAC 12W
- **Activation Trigger:** This sequencer requires an external source for activation. See last page for compatible components.
 - Single remote SPST switch with maintained contact closure.
 - Multiple remote SPST switches with momentary contact closure and Lowell's MSM2 module connected between the sequencer and switch.
 - Voltage input (5V-24V, AC or DC)
- **Four (4) Step Delay:**
 - Time-delayed closure circuits activate in sequential order (1, 2, 3, 4) and deactivate in reverse order.
 - The delay between steps can be adjusted by setting the DIP switch on the front (2.5 to 12 seconds between steps). A reference chart is printed on the top of the chassis.
 - LEDs provide visual status of the activation sequence.
 - Includes auxiliary 24VDC output (300mA max.) for use with remote indicators, if needed.
- **Compact Chassis:** 8.00" x 3.25" x 1.95" (4 lbs.) steel chassis with black powder epoxy finish and mounting holes.
 - Unit can be installed in a remote location or rack panel (2U).
 - Operational diagram printed on chassis aids system set-up.

- **Country of Origin:** Made in U.S.A. with global components
- **Power Supply:** UL Listed power supply (100-240VAC input, 24VDC 500mA output) with 6 ft. cord and NEMA 1-15P plug. Includes three adaptors for international use (Schuko CEE 7/16, BS1362, AS3112).
- **Installation:** The sequencer is typically installed in a convenient location, while remote power controls are placed near equipment to be controlled in another rack, room or building.
 - Maximum distance between switch, sequencer and remote power controls: 22 gauge wire = 6,600 ft.; 18 gauge wire = 17,160 ft.
 - System Capacity: Accepts up to 10 RPCs per step.
- **Connections:** Order compatible remote power controls and switches separately.
- **A&E Specifications:** The four step sequencer shall be Lowell model SEQ-4A, which shall feature barrier strip terminals for connection to a single external remote switch with maintained contact closure, multiple remote switches with momentary closure and Lowell MSM2 module wired between them, or a voltage input trigger. The sequencer shall connect to external remote power controls (RPCs) to activate remote equipment in four steps with an adjustable time delay between each step. It shall activate RPCs in order (1, 2, 3, 4) and deactivate them in reverse order. The sequencer shall feature a steel chassis with mounting holes, black powder epoxy finish, and overall dimensions of 8.00" x 3.25" x 1.95". It shall be made in the USA with global components, and include a UL Listed power supply with NEMA 1-15 plug and three adaptors (Schuko CEE 7/16, BS1362, AS3112). External switches and remote power controls shall be ordered separately.

INPUT CONNECTION OPTIONS:

Dry Contact Control

Connect to any physical switch or control system that will provide a *maintained* dry contact closure

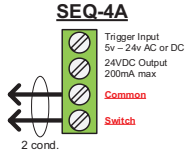

Voltage Control

Connect to any device or control system that will provide a *maintained* voltage between 5 and 24 volts AC or DC. If DC, observe polarity: Common=Neg, Trigger Input=Pos.

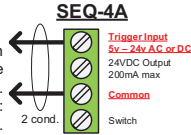

Single Remote Switch Control

Any Lowell RPSW or RPSB series *maintained* contact remote switch model (rocker or keylock)

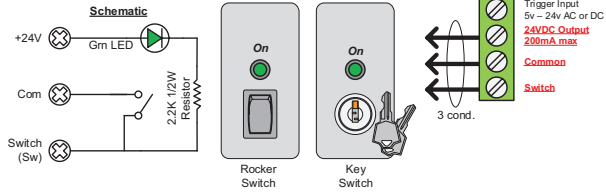

Multiple Remote Switch Control

Any Lowell RPSW2-M or RPSB2-M series *momentary* contact remote switch model (rocker or keylock) Max. 6 switches

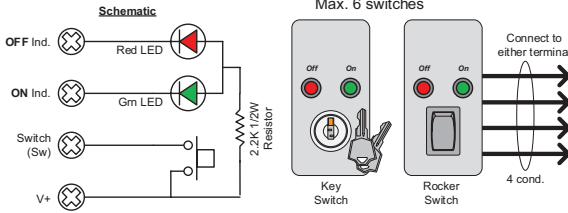

MSM2 Momentary Switch Module

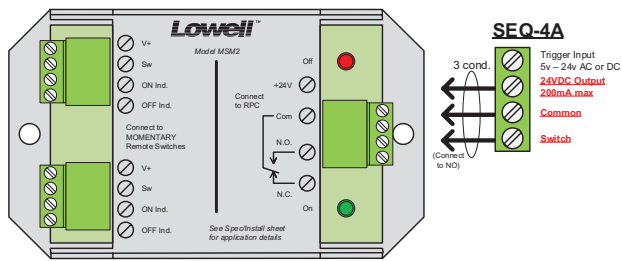

Wire requirements:

Any generic cable, shielding not needed

Maximum distance between devices:

22ga wire: 1 mile
18ga wire: 3 miles

OUTPUT CONNECTION OPTIONS:

Delay Settings

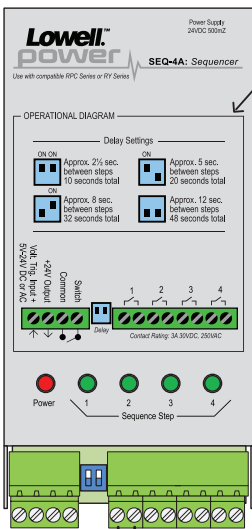
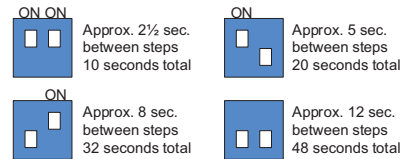

RPC unit (any model)

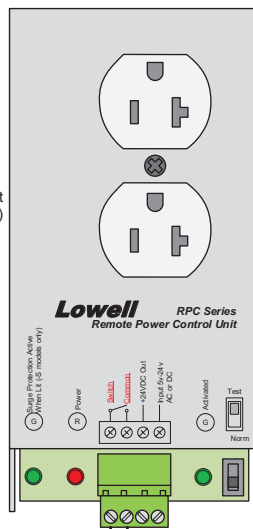

NOTE: Any combination of RPC series models and/or RY series models may be connected to each sequencer step. **Maximum 75 units per sequence step.**

RY-2A or RY-4A Relay Module

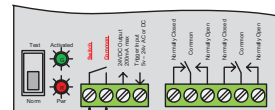

To additional RPCs and/or relay modules

NOTE: Maintain polarity (switch to switch, com to com)

Wire requirements:

Any generic cable, shielding not needed

Maximum distance between sequencer and RPCs / relays:

22ga wire: 1 mile
18ga wire: 3 miles



OPTIONS: (order separately)

• **SWITCH for single switch applications:** (RPS Series switch with maintained closure)

<i>Model</i>	<i>Description</i>	<i>Model</i>	<i>Description</i>
RPSW-P	1 LED rocker switch, white wall plate	RPSW-KP	1 LED key switch, white wall plate
RPSB-P	1 LED rocker switch, black wall plate	RPSB-R	1 LED rocker switch, 19" panel
RPSB-KR	1 LED key switch, 19" panel	RPSB-R-RJ	1 LED rocker switch, 19" panel, RJ45
RPSB-KR-RJ	1 LED key switch, 19" panel, RJ45	RPSW-P-RJ	1 LED rocker switch, white wall plate, RJ45
RPSW-KP-RJ	1 LED key switch, white wall plate, RJ45	RPSB-P-RJ	1 LED rocker switch, black wall plate, RJ45

• **SWITCH for multiple-switch applications:** (RPS Series switch with momentary closure and MSM2 module, see chart below)

<i>Model</i>	<i>Description</i>	<i>Model</i>	<i>Description</i>
RPSW-MP	1 LED rocker switch, white wall plate	RPSW2-MP	2 LED rocker switch, white wall plate
RPSB-MP	1 LED rocker switch, black wall plate	RPSB2-MP	2 LED rocker switch, black wall plate
RPSB-MR	1 LED rocker switch, 19" panel	RPSB2-MR	2 LED rocker switch, 19" panel
RPSW-MKP	1 LED key switch, white wall plate	RPSW2-MKP	2 LED key switch, white wall plate
RPSB-MKP	1 LED key switch, black wall plate	RPSB2-MKP	2 LED key switch, black wall plate
RPSB-MKR	1 LED key switch, 19" panel	RPSB2-MKR	2 LED key switch, 19" panel
RPSB2-MP-RJ	2 LED rocker switch, black wall plate, RJ45	RPSW2-MP-RJ	2 LED rocker switch, white wall plate, RJ45
RPSB2-MKP-RJ	2 LED key switch, black wall plate, RJ45	RPSW2-MKP-RJ	2 LED key switch, white wall plate, RJ45
RPSB2-MR-RJ	2 LED rocker switch, 19" panel, RJ45	RPSB2-MKR-RJ	2 LED key switch, 19" panel, RJ45

• **REMOTE POWER CONTROL:** (RPC Series with classic connections)

<i>Model</i>	<i>Description</i>	<i>Model</i>	<i>Description</i>
RPC-15	RPC with (2) 15A NEMA outlets, cord	RPC-15-S	RPC with (2) 15A NEMA outlets, surge supp, cord
RPC-15-SCD-RJ	RPC with (2) 15A NEMA outlets, cord, RJ45	RPC-15-U	RPC with (2) IEC C13 outlets, cord
RPC-20-CD	RPC with (2) 20A NEMA outlets, cord	RPC-20-SCD	RPC with (2) 20A NEMA outlets, surge supp, cord
RPC-20-SCD-RJ	RPC with (2) 20A NEMA outlets, surge supp, cord, RJ45	RPC-3N1	RPC with (8) 15A NEMA outlets, cord
RPC-20-HW	RPC with (2) 20A NEMA outlets, whip	RPC-20-SHW	RPC with (2) 20A NEMA outlets, surge supp, whip
RPC-30-SHW	RPC with 30A Twistlock outlets, surge supp, whip		

SEQ & SEQR Series Overview — sequencers with classic connections

<i>Model No.</i>	<i>Chassis</i>	<i>Steps</i>	<i>Alternate Sequence Mode</i>	<i>Onboard Switch</i>	<i>REQUIRES External Switch</i>	<i>ACCEPTS Multiple Remote Switches</i>	<i>ACCEPTS Input from Alarm System</i>	<i>ACCEPTS Input from Lowell Switch w/RJ45</i>	<i>Power Input</i>	<i>Country of Origin</i>
SEQ-4A	standalone	4	---	---	yes	through MSM2	---	---	power supply	USA
SEQ-8	standalone	8	---	---	yes	yes	---	---	power supply	USA
SEQR-4	1U panel	4	---	rocker	---	yes	yes	---	power supply	USA
SEQR-4K	1U panel	4	---	key	---	yes	yes	---	power supply	USA
SEQR-8	1U panel	8	yes	rocker	---	yes	yes	---	power supply	USA
SEQR-8K	1U panel	8	yes	key	---	yes	yes	---	power supply	USA
SEQR-8RJ	1U panel	8	yes	rocker	---	yes	yes	yes	power supply	USA

Steps = Unit activates/deactivates connected remote power controls (RPCs) in four or eight steps, with a delay between each. Up to 10 RPCs can connect to each step.

Alternate Sequence Mode = The ASM feature skips selected outputs to allow partial startup of system, useful for small events or rehearsals. It requires remote switch model RPSB-KP-ASM to enable ASM function before main switch is activated.

Onboard Switch = Sequencers without an onboard switch will require an external switch for activation.

REQUIRES External Switch = Sequencer can be controlled by one external switch, usually placed in a remote location (RPS series switch with MAINTAINED closure).

ACCEPTS Multiple Remote Switches = Sequencer can be controlled by one or more external switches placed in remote locations (RPS Series switches with MOMENTARY closure). Some models require the MSM2 module in order to accept multiple switches.

ACCEPTS Input from Alarm System = Sequencer can accept control override from an alarm system (alarm by others, not included).

ACCEPTS Input from Lowell Switch w/RJ45 = Sequencer is designed for use with a Lowell MOMENTARY switch that has a model number with "-RJ" as a suffix (see options above). Note that these switches include a single RJ45 connector and are not part of Lowell's "pass-through" series.

NOTE: For rackmount sequencers that include AC power outlets, see Lowell ACR Series or ACSPR Series.

INTERNAL USE ONLY: PN 24188