

Guitar Amplifier / Amplificateur pour guitare /
Gitarrenverstärker / Amplificador de guitarra /
Amplificador de guitarra / Amplificatore per chitarra /
Гитарный усилитель / 吉他扩音器 /
기타 앰프 / ギターアンプ

THR Series

THR30II Wireless THR10II Wireless THR10II

Quick Guide / Guide de référence rapide /
Kurzanleitung / Guia Rápido / Guía rápida /
Guida rapida / Краткое руководство /
快速指南 / 간편설명서 / クイックガイド

VDV0470

Published 2/2020 発行 POES-B0



THR30II Wireless

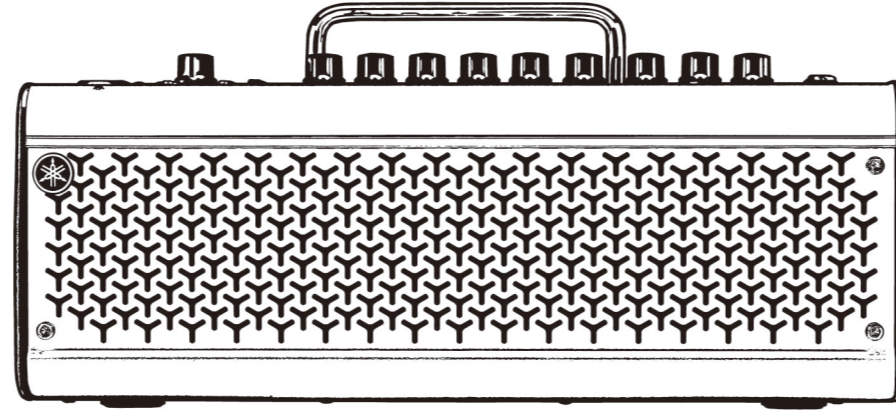

THR10II Wireless

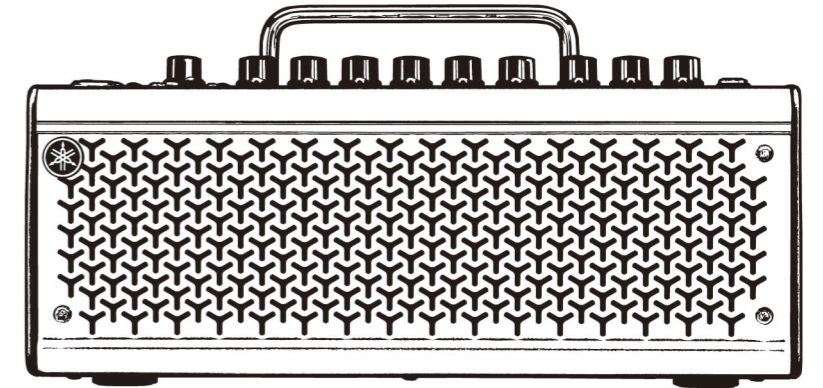

THR10II

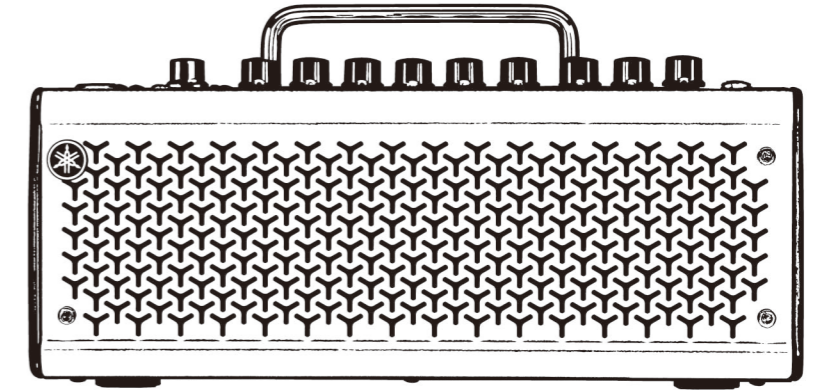

Please read Safety Instructions Sheet carefully before proceeding.
Veuillez lire attentivement la fiche d'instructions de sécurité avant de poursuivre.
Bitte lesen Sie die Sicherheitshinweise vor Gebrauch sorgfältig durch.
Leia a Folha de Instruções de Segurança com atenção antes de prosseguir.
Lea atentamente la ficha de instrucciones de seguridad antes de continuar.
Leggere attentamente le istruzioni di sicurezza prima di procedere.
Внимательно прочитайте Инструкцию по технике безопасности, прежде чем приступать к эксплуатации.
在操作使用前，请仔细阅读安全说明表。
사용하기 전에 안전 지침을 주의 깊게 읽어 보십시오.
ご使用前にSafety Instructions Sheetを必ずお読みください。

YAMAHA CORPORATION

10-1 Nakazawa-cho, Nakaku, Hamamatsu, 430-8650 Japan
Manual Development Group
© Yamaha Corporation

Main Features

- Sophisticated guitar amplifier with modeling made possible by Yamaha's original VCM technology
- THR-II Wireless models are compatible with the Line 6 Relay G10T wireless transmitter
- Bluetooth® capability enables playing music from a smart device
- Built-in rechargeable battery enables use without power adaptor

Specifications

	THR30II Wireless	THR10II Wireless	THR10II
Dimensions (W x H x D)	420 x 195 x 155 mm	368 x 183 x 140 mm	368 x 183 x 140 mm
Weight	4.3 kg	3.2kg	3.0 kg
Power Consumption	22 W	22 W	11 W
Rated Output	30 W (15 W + 15 W)	20 W (10 W + 10 W)	20 W (10 W + 10 W)
Power Source	Power Adaptor or built-in rechargeable battery		Power Adaptor
Accessories	<ul style="list-style-type: none"> • Power Adaptor (YNT345-1530) • Quick Guide (this sheet) • Safety Instructions Sheet: Includes PRECAUTIONS and NOTICE. Please read carefully before proceeding. • Service offices list • Cubase AI Download Information: Includes an access code for downloading Steinberg's DAW software Cubase AI. For instructions on downloading, installing and setting up, refer to the reference manual. 		

* For further details on the product, download the THR30II Wireless THR10II Wireless THR10II reference manual from the website: <https://download.yamaha.com/>

* In this sheet, THR30II Wireless, THR10II Wireless and THR10II are collectively called THR-II. THR30II Wireless and THR10II Wireless are called THR-II Wireless.

Power

The THR-II Wireless can operate on either DC power (via the power adaptor) or with the built-in rechargeable battery. The THR10II can operate on DC power (via the power adaptor).

When using the power adaptor

Connect the supplied power adaptor to the DC IN jack located on the rear side of the THR-II. Connect the AC plug to a power outlet.

* Follow the Safety Instructions before making connections.

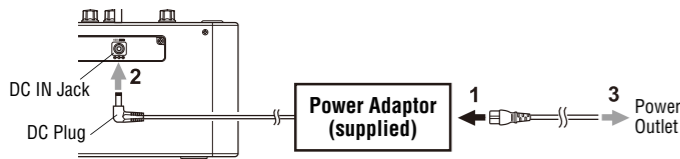

Turning the power on and off

Press the power button [] on the top of THR-II for one second to turn the power on. The LED of the power button lights when turning the power button on. The LED of the THR-II Wireless lights in green while charging. Otherwise, it lights in red.

Charging to the built-in rechargeable battery (THR-II Wireless only)

Connect the supplied power adaptor to the DC IN jack located on the rear side of the THR-II Wireless. The LED of the power button lights in green while charging.

Connection

You can connect with a standard instrument cable or the Line 6 G10T wireless transmitter.

Connecting to guitar by wireless (THR-II Wireless only)

The THR-II Wireless can connect with the Relay G10T wireless guitar transmitter (made by Line 6) by wireless. Moreover, the optimal channel is set automatically by connecting the Relay G10T to the INPUT jack located on the top of the THR-II Wireless for at least 10 seconds. For details on wireless connection, refer to the reference manual.

Charging the Relay G10T (THR-II Wireless only)

Connect the Relay G10T to the INPUT jack located on the top of the THR-II Wireless. The built-in rechargeable battery starts charging automatically.

Connecting to a smart device via Bluetooth

Press the Bluetooth button located on the top of the THR-II and operate the smart device as indicated the following table. (On the THR10II Wireless and THR10II, enable Bluetooth by pressing the [USER MEMORY] button [4] and [5] simultaneously.)

LED	Operation	LED after operation	Status
Unlit	Press for three seconds	Flashes in green	Pairing mode
Flashes in green	Configure Bluetooth on the smart device within three minutes	Lights in green	Connected
Lights in green	Play music on the smart device	Lights in green	Connected

* For details on Bluetooth configuration, refer to the manual of the smart device.

Turning the tuner on and off

Press the TUNER TAP button for one second to turn on. Press the TUNER TAP button again to turn off. For details on the tuner, refer to the reference manual.

Storing user settings

The settings for the knobs on the top of the THR-II (excepting the [GUITAR] and [AUDIO] knobs) are stored in user memory. Press one of the [USER MEMORY] buttons for 2 seconds to save your settings to that preset location. For details on the user memory, refer to the reference manual.

Application software

You can also edit the tone and settings of the THR-II with the THR Remote app. The THR Remote can be used (in addition to the top panel controls) to edit settings such as compressor, noise gate, and speaker cabinet.

For Windows and Mac, download and install THR Remote from the website: <https://download.yamaha.com/>

For Android and iOS, install THR Remote through the appropriate app store.

For details on the using THR-II with a computer, refer to the reference manual.

Connection Example (on THR30II Wireless)

- Make sure that all devices to be connected to the unit by cable are turned off.
- When connecting the unit to an external device, use an appropriate cable that matches with the jack's specifications and connect it securely.

Precautions for using the USB jack

Make sure to follow the points at right when connecting a computer to the THR-II USB jack to avoid loss of data by the computer or the THR-II freezing or shutting down.

- Order for turning the power on
THR-II Wireless → Mixer → Amp (or powered speaker)
- Order for turning the power off
Amp (or powered speaker) → Mixer → THR-II Wireless

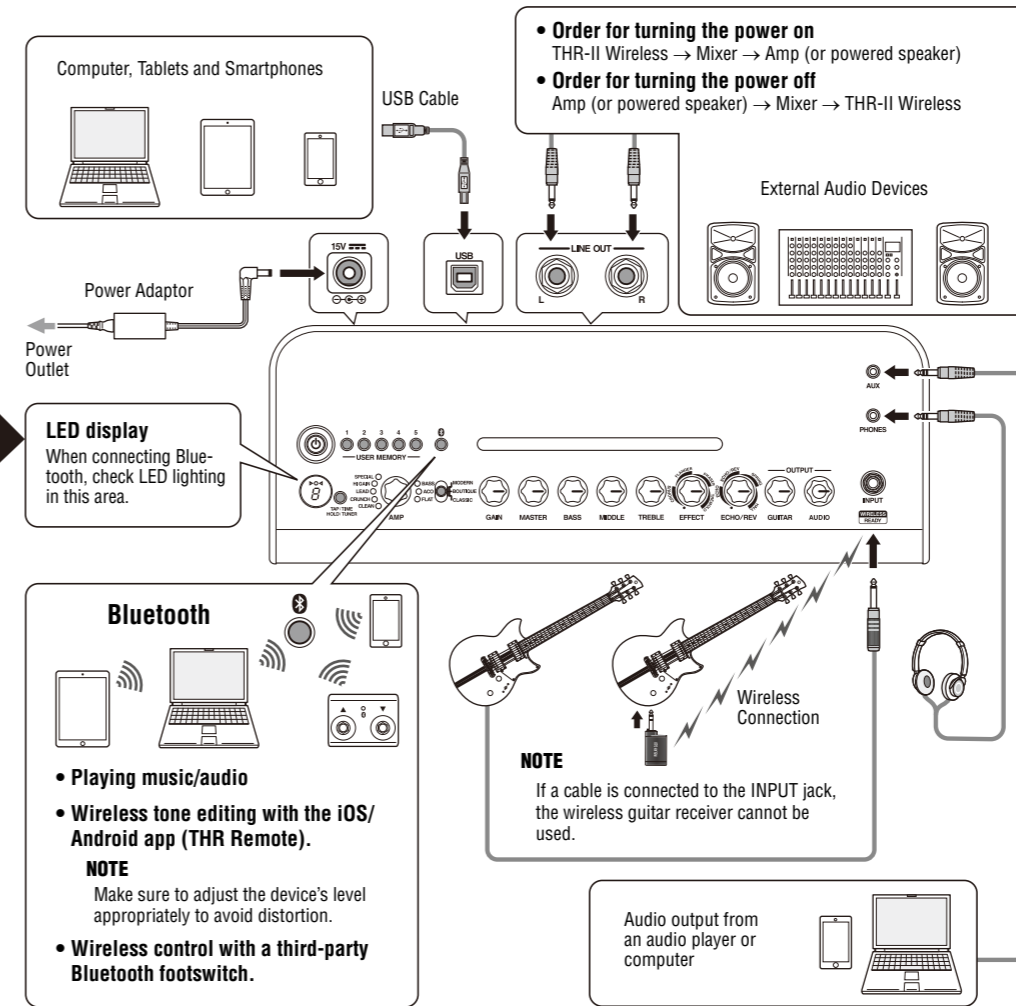

LED display
When connecting Bluetooth, check LED lighting in this area.

Bluetooth

- Playing music/audio
- Wireless tone editing with the iOS/Android app (THR Remote).
- Wireless control with a third-party Bluetooth footswitch.

NOTE
Make sure to adjust the device's level appropriately to avoid distortion.

NOTE
If a cable is connected to the INPUT jack, the wireless guitar receiver cannot be used.

Audio output from an audio player or computer

* The illustrations and LCD screens as shown in this manual are for instructional purposes only, and may appear somewhat different from those on your instrument.

Notice

- Use an AB type USB cable of less than 3 meters. USB 3.0 cables cannot be used.
- Be sure to wake the computer from suspended/sleep/standby mode before connecting a computer to the USB jack.
- Always quit all applications that are running on the computer before connecting or disconnecting the USB cable and set the volume output on the computer to its minimum level.
- When connecting or disconnecting the USB cable, be sure to set the OUTPUT controls ([GUITAR] and [AUDIO]) on the THR-II to their minimum levels.
- Wait at least 6 seconds between connecting or disconnecting the USB cable.

* For connecting Android devices, refer to the Smart Device Connection Manual for Android. For connecting iOS devices, refer to the iPhone/iPad Connection Manual Yamaha Downloads. <https://download.yamaha.com/>

Troubleshooting

No power

- Is the power adaptor properly connected?
- When the power adaptor is disconnected, has the THR-II Wireless been properly charged?

Cannot connect to the smart device by Bluetooth.

- Is the LED display turned off or flashes in green? Refer to the reference manual.
- Is the Bluetooth setting correct on the smart device? Refer to the user guide of your smart device.

No sound is output by wireless connection with a guitar.

- Are you using the Relay G10T? THR-II Wireless cannot connect to any guitar wireless transmitter except for the Relay G10T.
- Did you connect the Relay G10T to the INPUT jack located on the top of the THR-II Wireless for at least 10 seconds? The appropriate channel is set automatically.
- Is the volume control on the instrument turned up?
- Is the Tuner function switched OFF? When the tuner function is set ON, the guitar sound is muted. Press the TUNER TAP button (less than one second) to turn OFF the tuner function.