

WILLIAMEAV

Digi-Wave 400 Series

DLT 400 and DLR 400

QUICK SETUP GUIDE



Terminology

Some basic terminology is necessary to set up the Digi-Wave system correctly.

Groups are used in every mode. A group is a selection of people communicating with one another. There may be up to four groups in one area.

Channels are used in Interpretation mode. Users configure their device to listen to a certain channel based on what they need to hear, such as a specific language.

Addresses are unique numbers given to each DLT 400 transceiver in a set up. DLR receivers do not have addresses. Addresses are automatically assigned but manual assignment may be necessary. Each address is unique; addresses between 0 and 1023 can be selected. Each of the 1024 addresses is available per group.

Speaking Priority

Certain speakers can override others. There are 3 levels of priority.

Master 1 has first priority, and also sets up a majority of the settings for the Digi-Wave system.

Master 2 has second priority when speaking, but does not declare any settings for the Digi-Wave system, only for their personal device. **This is not available in Interpretation mode.**

Guest units have third priority, and can only declare settings for their device.

Modes

Intercom mode is appropriate when a group of people all need to talk and hear one another.

Tour mode is best suited when one or two people are leading a large group. The group can be configured to only listen to the leader(s) of the group, or the configuration can allow up to 6 people with a transmitter to speak.

Hearing Assistance mode is appropriate when the using the device to amplify spoken communication between users. The Tone Control in Hearing Assistance mode is naturally elevated, allowing the user to hear more clearly. Users with transmitters can be allowed to speak, or only the Master can be allowed to speak.

Interpretation mode is best suited when dealing with multiple, simultaneous audio feeds, such as multiple languages. In Interpretation Mode, **Broadcast Type** helps determine which channel the DLT transmitter will broadcast on.

- **Floor** will broadcast on channel 0. This is intended to be the main audio for the event that is being interpreted.
- **Interpreter** will broadcast on channel 1-14 depending on what is available. Each channel is able to be used by a dedicated interpreter. In **Standard Mode**, the user can hear the Floor on channel 0, and interpret on channels 1-14.
- **Bilingual Mode** and **Relay Mode** allows the interpreter to quickly switch between channels when multiple interpretation languages are involved. See full manual for details.
- **Repeater** is used to extend the range of the Digi-Wave 400 system by up to 50%. It will broadcast on one channel that needs to be extended.

Court mode allows toggling between secured groups, without letting the Guest unit on an unused or incorrect Group. A Guest unit can access up to four pre-selected groups, but nothing else.

Controls and Connectors

Note: The DLR 400 RCH does not have a talk button or accept a microphone.

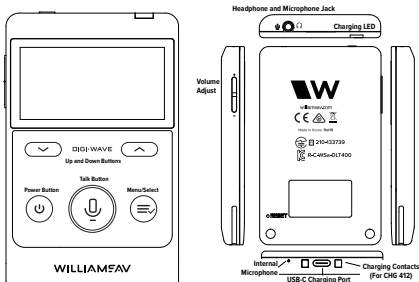

DLT 400 Pictured

Recycling Instructions



Help Williams AV protect the environment!

Please do not dispose of equipment or used batteries in the household trash. Take the equipment to an electronics recycling center or return to the factory. Take batteries to a retail or community recycling location.

Getting Started

Select the DLT Transceiver that will be the Master 1. A Master 1 device will declare a majority of the settings and can pass these settings to devices that connect with it.

Menu Navigation Buttons

- **Power Button:** Press and hold for power On/Off. Press quickly to navigate back a step when using the menu.
- **Talk Button:** The talk button will need to be used in order to talk or stop talking. This button is only on the DLT 400 transceivers.
- **Up and Down Buttons:** Navigate through menu items.
- **Menu/Select Button:** Hold the menu button down for a few seconds to enter the settings menu. In the settings menu, press the menu button to select the highlighted option and move onto the next step.

Initial Device Settings

New Settings: To start from the very beginning with your Digi-Wave settings, select New Settings. This will start you at the beginning of the set-up process where you can set Basic Settings.

Load Profile: To load an existing profile on the device, select this option and then select the profile to load. You may either load a profile as it is, or adjust the settings once it is loaded.

Join Group: If a Master 1 is already leading a Group or Channel, other devices can automatically search for the group and join it. The group or channel number could also be manually entered from this screen. Settings will be loaded from the Master 1 device, once a connection is established.

If a group or channel is locked by a Encryption PIN, the device will prompt for the PIN at this time. The device cannot join the protected group or channel without this Encryption PIN.

Basic Settings

1. Select a Mode. This determines what other settings may be available.
2. Select Speaking Priority. If this is the first DLT transceiver you are setting up, you will want to select Master 1. Typically, all other units will be Guest priority.
3. Select the group number.
4. If in Interpretation Mode, set the Broadcast Type.
5. The Master 1 can select whether to display clock and whether the clock is a 24-hour or 12-hour clock.
6. If required, manually set the address. **Automatic address selection is recommended unless there is a need to override the address.**
7. Enter Advanced Settings if more customization is needed, otherwise the device is ready to be used.

Advanced Settings

Some Advanced Settings may be missing from certain modes, or with certain configurations. Default values also may change depending on mode. Some settings include:

- **Number of Microphones:** In modes where multiple speakers are available, the number of speakers at one time can be limited.
 - **Tone Control:** Using the up and down arrow buttons, adjust the tone up or down to your preference.
 - **Side Tone Adjustment:** Adjusts the volume of the speaker's voice as heard in the headset (side tone).
-

- **Microphone Gain and Line Gain:** Gain can be used to increase the volume of the microphone or input sound.
 - **Encryption:** Extra security can be added to the transmitted signal via additional encryption. An 87-bit encryption is default, and is backwards compatible with the DLT 300 or DLR 360. 127 + 87 bit Encryption adds an additional layer of security, but is not backwards compatible.
 - **Encryption PIN:** When a group or channel has been set up with a PIN, transceivers and receivers without this PIN entered cannot listen in on the group. The same four digit code must be programmed into all of the Digi-Wave devices in the group.
 - **Allow Join Group:** other devices can be prevented from automatically joining the group. Disabling Join Group will prevent available groups from being listed under the Join Group menu. Devices will have to be manually set to the correct group or channel.
 - **Save Profile:** If the device will be used for multiple purposes, such as for tours and hearing assistance, the settings should be saved in a profile. Once saved, the settings can be easily re-loaded later by using the Load Profile option.
-

Customer Service

If you experience difficulty with your system, call Toll-Free for Customer Assistance:

1-800-843-3544 (U.S.A.) or

+1 952 943 2252 (Outside the U.S.A.)

If it is necessary to return the system for service, your Customer Service Representative will give you a Return Authorization Number (RA) and shipping instructions.

For Additional Information

This manual is a quick start guide for getting your Digi-Wave system up-and-running. Most features and customization options are not documented in this manual.

For additional information, feature instructions, commands, warranty information and more, please download the full user manual from the Digi-Wave 400 system's product page on Williams AV's website.

WILLIAMS AV

info@williamsav.com / www.williamsav.com

800-843-3544 / INTL: +1-952-943-2252

©2021 Williams AV, LLC · All Rights Reserved. MAN 255C