

**FEATURES:**

- Flexible Modular Design
- Output Level LED Indicators
- Up to 96 Total Zones
- Keyswitch Priority Lockout
- Supports 8 Rooms with 12 Presets Each
- Programmable Presets

**NEW FROM LEPRECON®**

The Litescape Architectural Series Houselite System is designed to meet the lighting challenges of architectural installations in houses of worship, theatres, corporate and municipal buildings and schools. Litescape Architectural panels allow designers to create dramatic “Litescaped” environments and “looks” that are recalled by just the touch of a button.

These environments are varied and may include accenting works of art, illuminating parking areas and walkways in universities, and enhancing the architectural features of hotels or corporate structures.

Houses of worship use architectural lighting to illuminate special religious celebrations as well as weddings, youth group programs and to enhance daily rituals. In many of these facilities lighting maintenance and design is performed on a volunteer basis, therefore ease of use is an outstanding feature built into this system.

You can mix and match Litescape Architectural stations based on the needs of your system. The system is expandable and can hold up to 30 panels. Any room/zone/preset mix is allowed. Litescape stations fit into Raco 690 series electrical boxes. (See dimensions on back page.)

All face plates are aluminum and finished in a durable baked on enamel. The color is a neutral, off-white with unobtrusive warm gray graphics. Custom colors are available. Consult factory for cost and delivery time.

*COVER PHOTO CLOCKWISE INCLUDES THE FOLLOWING STATIONS:*

*6 Preset/6 Fader w/Master/Lockout & Off, 3 Preset/3 Fader w/Master & Off, 6 Fader w/Master, 1 Preset w/Off, 12 Preset w/Off*

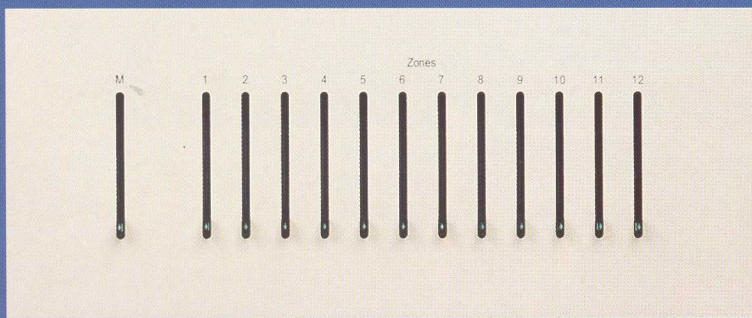

12 Fader Station w/Master

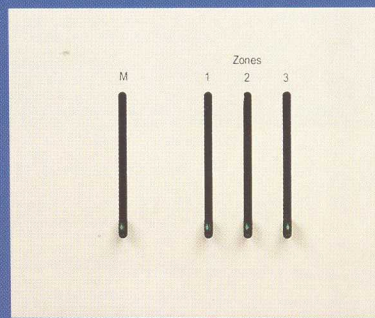

3 Fader Station w/Master

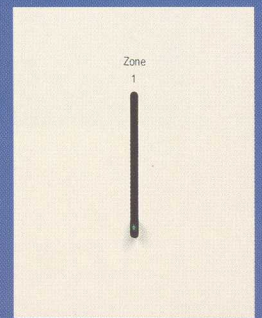

1 Fader Station

## LOCKOUT STATION

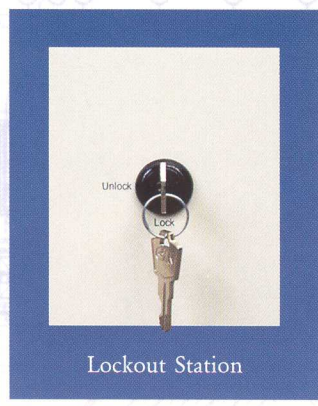

The lockout station is a security device that allows you to “lock out” certain stations. By turning the key you can prevent accidental or malicious changes in the light levels from the fader stations located in public areas.

## FADER STATION

Available in 1, 3, 6 and 12 zone configurations with master level fader on 3, 6 and 12 zone models. All feature low profile faders with output level LED indicators on each zone and master fader. All stations mount in industry standard gang boxes.

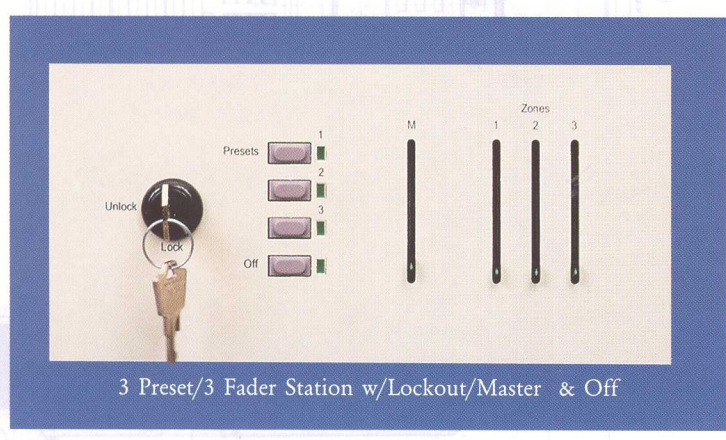

## PRESET STATION

Light levels for up to twelve zones can be assigned to any preset. Each preset can be programmed by setting a look with the zone faders and holding the preset button until the LED stops flashing. Presets can also be programmed using the Litescape Wall Dimmer or any DMX control signal. Panels are available with up to twelve preset buttons, plus an “off” button.

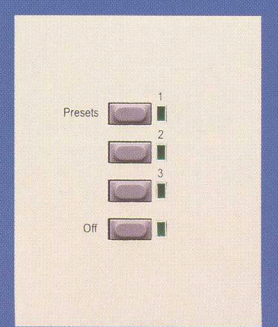
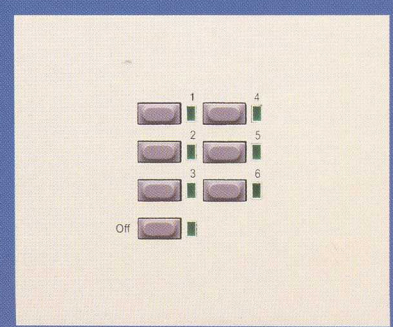
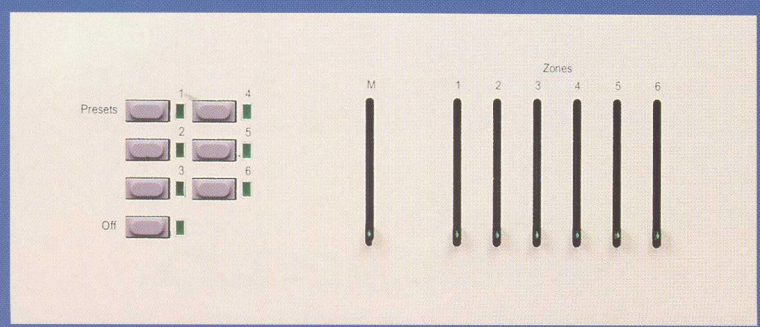

6 Preset/6 Fader Station w/ Master & Off

6 Preset Station w/Off

3 Preset Station w/Off

# LITELSCAPE HOUSELITE SYSTEM

Model #	Station Description	Outside Station Width in Inches**	Outside Station Width Metric	Outside Gang Size	Inside Gang Size
LHS Lockout	Lockout	3.59	91mm	2 Gang	1 Gang
LHS 1F	1 Fader	3.59	91mm	2 Gang	1 Gang
LHS 1P	1 Preset w/Off	3.59	91mm	2 Gang	1 Gang
LHS 3P	3 Preset w/Off	3.59	91mm	2 Gang	1 Gang
LHS 3F w/Master	3 Fader w/Master	5.41	137mm	3 Gang	2 Gang
LHS 6P	6 Preset w/Off	5.41	137mm	3 Gang	2 Gang
LHS 6F w/Master	6 Fader w/Master	7.22	183mm	4 Gang	3 Gang
LHS 12P	12 Preset w/Off	7.22	183mm	4 Gang	3 Gang
LHS 12F w/Master	12 Fader w/Master	10.84	275mm	6 Gang	5 Gang
LHS 3P/3F w/Master	3 Preset/3 Fader w/Master & Off	7.22	183mm	4 Gang	3 Gang
LHS 3P/3F w/Master & Lockout	3 Preset/3 Fader w/Master/Lockout & Off	9.03	229mm	5 Gang	4 Gang
LHS 6P/6F w/Master	6 Preset/6 Fader w/Master & Off	10.84	275mm	6 Gang	5 Gang
LHS 6P/6F w/Master & Lockout	6 Preset/6 Fader w/Master/Lockout & Off	12.66	321mm	7 Gang	6 Gang
LHS Processor*					

\*One Processor board is required per station location

\*\*To determine the back box size for multiple panel combinations, total the outside gang size of each panel and subtract 1 gang.

Example 2 + 3 + 4 - 1 = 8 gang back box. To determine the back box size for individual panels, use the inside gang size.

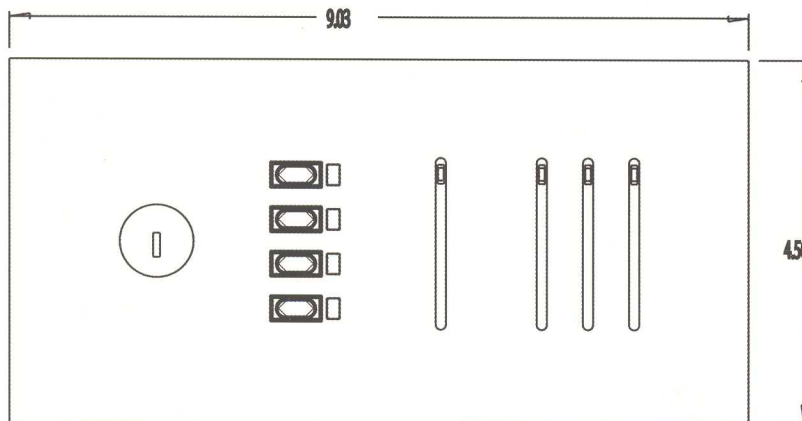

3 Preset/3 Fader w/Master/Lockout & Off Shown in Drawing Above

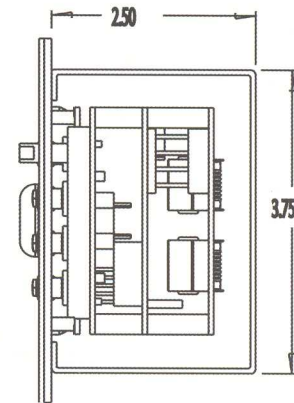

## FULL ONE YEAR WARRANTY

For a period of one year from the date of sale, Leprecon LLC will replace any defective parts and will repair any defective module returned to the factory prepaid, without charge for parts or labor. Please consult your dealer for full warranty details.

**Leprecon**®

[www.leprecon.com](http://www.leprecon.com)