

SUBSTATIONS

RS-450, RS-460, RS-470

Thank you for purchasing TOA's Substation.

Please carefully follow the instructions in this manual to ensure long, trouble-free use of your equipment.

Note: For operation of the units, refer to the N-8000 series operating instructions.

1. GENERAL DESCRIPTION

The RS-450, RS-460, RS-470 are substations to be connected to the N-8400RS Substation Interface Unit. The RS-450 features indoor design, the RS-460 robust indoor design, and the RS-470 robust design with Dust/Water Protection Conforming to IP54 level.

Warning

This is a class A product. In a domestic environment this product may cause radio interference in which case the user may be required to take adequate measures.

2. CONNECTIONS

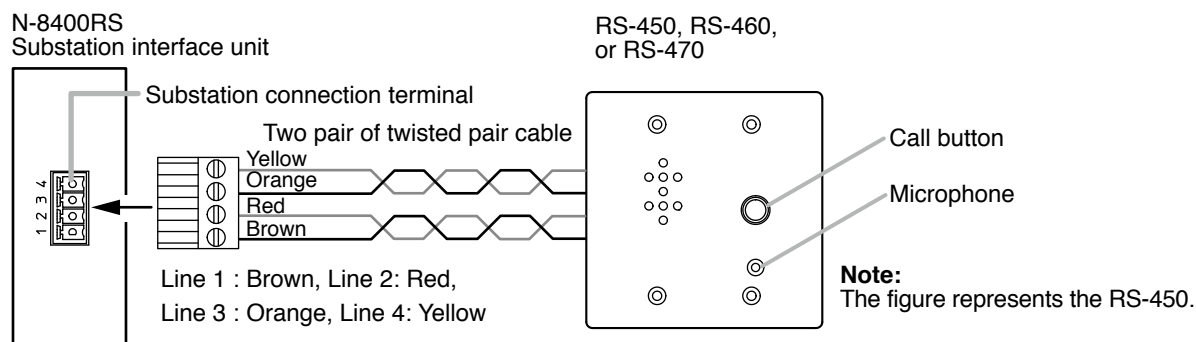

3. INSTALLATION

[RS-450 dimensional diagram]

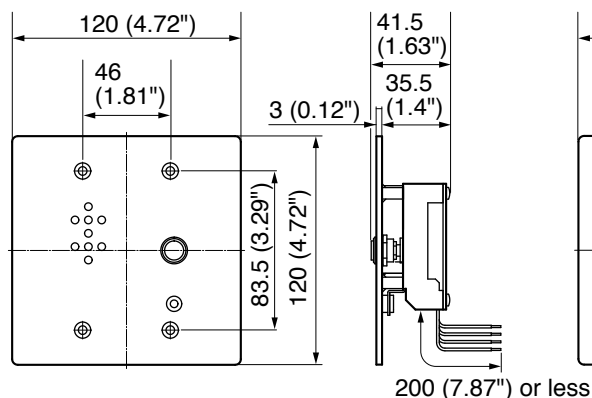

[RS-460/470 dimensional diagram]

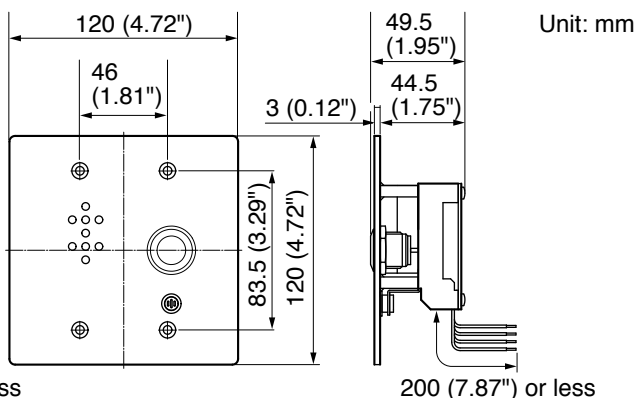

Mount the substation to the YC-302 2-gang electrical box mounted in the wall or YC-822/YC-823 Wall-mount box.

Notes

- When using the PA paging function, keep the station as far away from the PA paging speaker as possible to avoid acoustic feedback.
- When installing the RS-470 at outdoor or locations where it gets wet with water, tightly seal the panel edges. Besides, provide a weep hole at the underside of the mounting box to permit water to drain off.

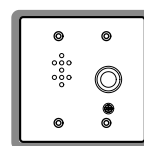

RS-470's front panel

Seal the panel edges.

[Flush mounting using an electrical box]

Mount the substation to an electrical box mounted to the wall.

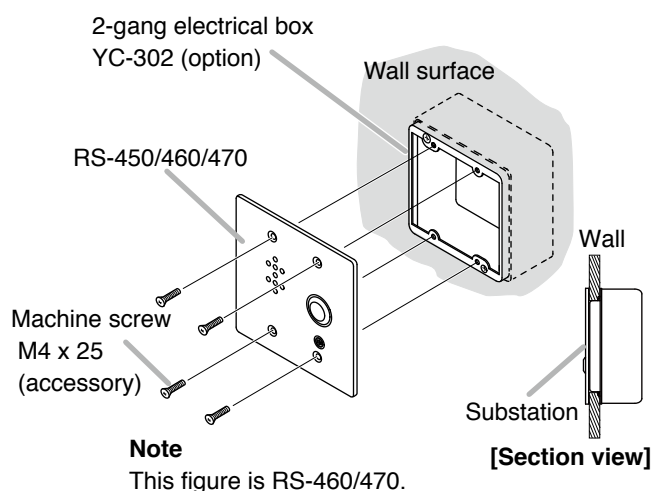

[Wall surface mounting using the Wall-mount box]

Attach the substation to the wall-mount box.

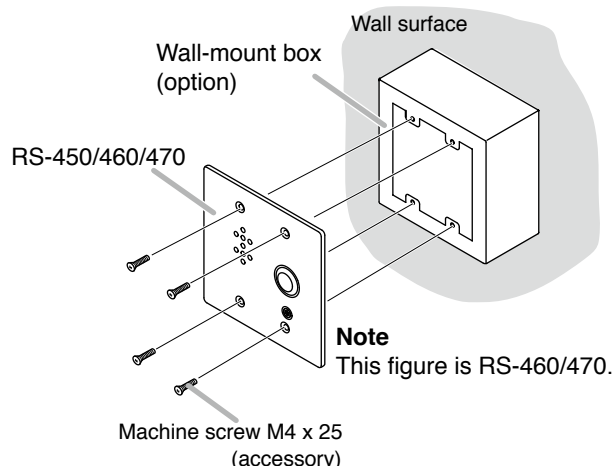

Accessory screws

The RS-450, RS-460, and RS-470 come with 2 types of screws: M4 x 25 and UNC No. 6-32 x 18. For the electrical box or the wall-mount box provided with unified threads, use the UNC No. 6-32 x 18.

4. SPECIFICATIONS

Model No.		RS-450	RS-460	RS-470
Call Button		Momentary (Emergency call: Press twice within 400 ms.)		
Rated Input		1 W		
Internal Speaker		Cone-type		
Internal Mic		Electret condenser type		
Wiring		Twisted pair cables (2-pair)		
Transmission Range		1 km (3280.84 ft)/ø0.5 mm (AWG24) 1.5 km (4921.26 ft)/ø0.65 mm (AWG22) 2 km (6561.68 ft)/ø0.9 mm (AWG19)		
Operating Temperature		-10 to +50°C (14 to 122°F) (Temperature range not to freeze the speaker and switch)		
Housing Protection		—	BS EN62262: 2002: IK02 equivalent	
Dust/Water Protection		—		IP54
Finish	Panel	Stainless steel, hairline		
	Call button	Resin, black	Metal, silver	
	Circuit board	(RS-470 only) Weather-resistant coating		
Dimensions	(w)	120 mm (4.72")		
	(h)	120 mm (4.72")		
	(d)	41.5 mm (1.63")	49.5 mm (1.95")	
Weight		510 g (1.121 lb)	540 g (1.19 lb)	550 g (1.21 lb)
Accessory		No. 6-32 UNC x 18 ... 4, Machine screw M4 x 25 ... 4		
Applicable Box		For flush-mount: 2-gang electrical box: YC-302 (option) For surface-mount: Indoor wall-mount box YC-822 (option) Outdoor wall-mount box YC-823 (option, RS-470 only)		

Note: The design and specifications are subject to change without notice for improvement.

Traceability Information for Europe

Manufacturer:
TOA Corporation
7-2-1, Minatojima-Nakamachi, Chuo-ku, Kobe, Hyogo, Japan

Authorized representative:
TOA Electronics Europe GmbH
Suederstrasse 282, 20537 Hamburg, Germany

URL: <http://www.toa.jp/>

TOA Corporation

133-06-00036-00