

Antenna Bulkhead Connector Kit



Features

- Allows for remote antenna mounting in metal cabinets
- Includes two BNC bulkhead connectors and two 3' BNC cables

Description

The ATW-BH1 bulkhead connector kit permits the extension of wireless antenna connection locations to the external walls and/or blank panels of a metal equipment rack. It is designed to work with any wireless system that uses BNC-type antenna connections. The kit consists of two BNC-BNC male bulkhead connectors with mounting hardware and two 3' RG-58 BNC-BNC cables. (Note: this kit does not contain antennas, drill bits or "D" punches.)

Architect's and Engineer's Specifications

The BNC bulkhead connection kit shall allow the antenna connections of associated wireless equipment to be extended to the external walls and/or a blank panel of a metal equipment rack. It shall consist of a pair of BNC-BNC male bulkhead type connectors and two 3' RG-58 BNC-BNC cables along with all associated hardware to secure the connectors to a metal panel. Provide one Bulkhead connector kit for each set of RF inputs as required.

The Audio-Technica ATW-BH1 is specified.

Recommended Mounting Hole

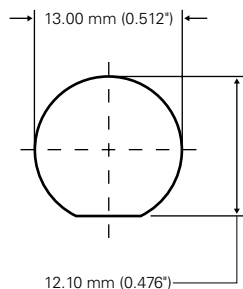

Note: Maximum panel thickness: 5.5 mm (0.217").



Audio-Technica U.S., Inc., 1221 Commerce Drive, Stow, Ohio 44224
Audio-Technica Limited, Old Lane, Leeds LS11 8AG England
©2010 Audio-Technica U.S., Inc. audio-technica.com

0001-0093-00