

ATMOS[®] FEAR

blizzard
BIG BAD LOFO



 **blizzard**

Blizzard Lighting, LLC
www.blizzardlighting.com
Waukesha, WI USA
Copyright (c) 2018

1. GETTING STARTED

What's Included?

- 1 x AtmosFEAR® Big Bad Lo Fo
- 2 x Extension Hoses
- 1 x Nozzle Connector
- 1 x Remote Control
- An Ever-So-Handy Power Cord
- This Lovely User Manual

Getting It Out Of The Box

Congratulations on your purchase of the biggest, baddest, event-ready low-lying fog machine available, the AtmosFEAR® Big Bad Lo Fo! Now that you're the proud owner of a AtmosFEAR® Big Bad Lo Fo, you should carefully unpack it and check the contents to ensure that all parts are present and in good condition. If anything looks as if it has been damaged in transit, notify the shipper immediately and keep the packing material for inspection. Please save the carton and all packing materials. If the unit must be returned to the factory, it is important that it be returned in the original factory box and packing.

Powering Up!

This unit must be powered directly off a switched circuit and **cannot be run off a rheostat (variable resistor) or dimmer circuit, even if the rheostat or dimmer channel is used solely for a 0% to 100% switch.**

AC Voltage - Please verify that the unit is suitable for your local power supply. See the unit's specifications for more information. The listed current rating is its average current draw under normal conditions.

Warning! Verify that the voltage on your unit matches the line voltage applied. Damage to your device may result if the voltage applied does not match the voltage indicated in the specifications. All units must be connected to circuits with a suitable Ground (Earthing).

Getting A Hold Of Us

If something is wrong, please just visit our website at www.blizzardlighting.com and open a support ticket. We'll be happy to help, honest.

Disclaimer: The information and specifications contained in this document are subject to change without notice. Blizzard Lighting™ assumes no responsibility or liability for any errors or omissions that may appear in this user manual. Blizzard Lighting™ reserves the right to update the existing document or to create a new document to correct any errors or omissions at any time. You can download the latest version of this document from www.blizzardlighting.com.

Author:	Date:	Last Edited:	Date:
J. Thomas	1/30/2018	J. Thomas	3/27/2018

SAFETY INSTRUCTIONS



Please read these instructions carefully. They include important information about the installation, usage and maintenance of this product.

Attention:

To keep your AtmosFEAR® Big Bad Lo Fo in good working order please remember to:

- **Use only water-based, non-toxic fog fluid in the fluid tank.**
- **Keep the machine clean.**
- **Turn the power off before adding fog fluid.**
- **Turn the power off when not in use.**

And also...

- ALWAYS make sure that you are connecting to the proper voltage, and that the line voltage you are connecting to is not higher than that stated on the decal or rear panel of the fixture.
- This product is intended for indoor use only.
- To prevent risk of fire or shock, do not expose fixture to rain or moisture.
- Make sure there are no flammable materials close to the unit while operating.
- The unit must be used in a location with adequate ventilation, at least 20in (50cm) from adjacent surfaces. Be sure that no air intake slots are blocked.
- ALWAYS disconnect from the power source before servicing or replacing fuse and be sure to replace with same fuse size and type.
- DO NOT operate at ambient temperatures higher than 104°F (40°C).
- In the event of a serious operating problem, stop using the unit immediately. NEVER try to repair the unit by yourself. Repairs carried out by unskilled people can lead to damage or malfunction. Please contact the nearest authorized technical assistance center. Always use the same type spare parts.
- Make sure the power cord is never crimped or damaged.
- Never disconnect the power cord by pulling or tugging on the cord.

Caution! There are no user serviceable parts inside the unit. Do not open the housing to attempt any repairs yourself. In the unlikely event your unit may require service, please visit our support website at: www.blizzardlighting.com/support.

2. MEET THE ATMOSFEAR® BIG BAD LO FO

INTRODUCTION:

AtmosFEAR® Big Bad Lo Fo is an amazing low-lying fog machine which is based on ultrasonic atomization. Co2 or dry ice is not needed to create stunning fog effects, just good ol' fashioned water!

This device comes with a nozzle connector for the water supply, and the tank can automatically fill with water to the proper level, using it's built-in float.

The bottom of the water tank is fitted with piezoelectric disks which vibrate to ultrasonic frequencies, causing the water to atomize into a mist.

In a separate tank in the front cabinet of the unit, you can add any type of water based fog liquid (light, standard, heavy, etc.) in order to give on the effect different dimension, intensity and duration.

MAIN FEATURES:

- DMX controllable water-based low-lying machine
- Tour-ready ATA-spec flight case with wheels
- 2000W heat exchanger
- Underside valve for easy tank draining
- Includes nozzle connector, and dual fog output hoses
- Auto, remote control, DMX512 working modes
- Timer with interval and duration settings
- Touch screen LCD control panel menu display
- On-screen fault warnings for remote, sensor, heater, and low fluid
- 3/5-pin DMX connectivity
- 3-channel DMX control
- Rugged and well-built (It hits the gym regularly)
- PowerCON® compatible power input connector

DMX Reference (3-Channel Mode)

Ch.	Value	What it does
1	000 <--> 127 128 <--> 255	Fog emission off Fog emission on
2	000 <--> 255	Fan speed (0% <--> 100%)
3	000 <--> 255	Fog volume setting (0% <--> 100%)

Figure 1: AtmosFEAR® Big Bad Lo Fo Pin-Up Picture

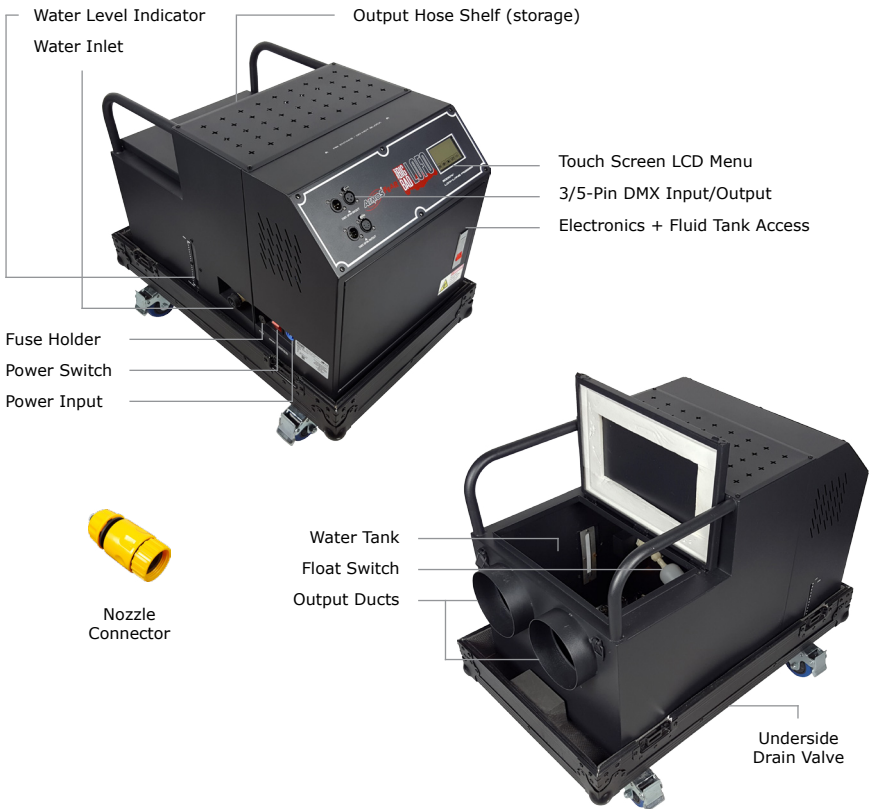

Initial Setup

Step 1: Place the machine on a flat surface and in a suitable large area with at least 20in (50cm) open space around the machine.

Step 2: Fill the fluid tank with quality water-based, non-toxic fog fluid. For best performance, we recommend using Blizzard Lighting’s own Steam™ fog fluid products.

Step 3: Fill the water tank manually, or via the water inlet connection.

Step 4: Connect the hoses to the output ducts.

Step 5: Connect the machine to suitable rated power supply, and turn to power switch on.

Step 6: Warming up can take up to 5-8 minutes. The LCD menu will display “Ready” when it is ready for use.

Automatic Water Injection

You can fill the water tank manually, or connect a water supply directly to the water inlet located on the side of the machine. Use the supplied nozzle and faucet connectors as needed. If a water supply is connected to the water inlet, the unit will automatically adjust the water level by use of the float switch inside the water tank.

Note: When filling the tank, the water level needs to be covering the water level sensors by at least about 3-4 cm. If there is not enough water in the tank, the red warning LED near the sensors will illuminate. Sporadic fog output, or if the fog itself is rising too high are also signs of the water level being too low.



Water Drainage

The water tank drainage valve is located on the underside of the unit. Open the valve to drain the water tank, and be sure to close the valve when draining is complete.

Remote Control

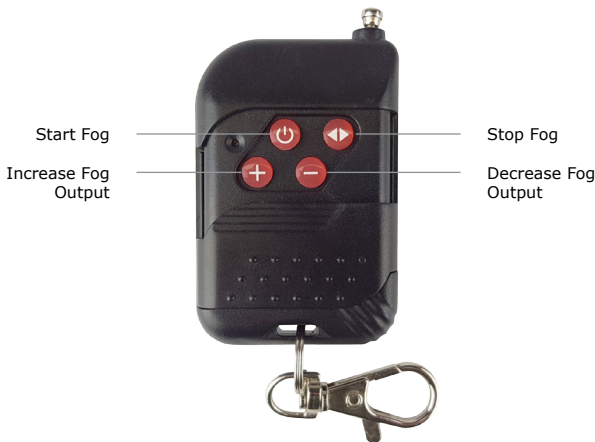

3. SETUP



Before replacing a fuse, disconnect the power cord.
ALWAYS replace with the same type and rating of fuse.

Fuse Replacement

With a Philips screwdriver, unscrew the fuse holder out of its housing and remove the blown fuse from its holder. Replace the blown fuse with a fuse of the exact same type and rating, then screw the fuse holder back into place and reconnect power.

Connecting A Bunch of AtmosFEAR® Big Bad Lo Fo's

You will need a serial data link to run shows using a DMX-512 controller or to run shows on two or more units set to sync in master/slave operating mode. The combined number of channels required by all the units on a serial data link determines the number of units the data link can support.

Units on a serial data link must be daisy chained in one single line. Also, connecting more than 32 units on one serial data link without the use of a DMX optically-isolated splitter may result in deterioration of the digital DMX signal. The maximum recommended cable-run distance is 500 meters (1640 ft).

Data/DMX Cabling

To link units together you'll need data cables. You should use data-grade cables that can carry a high quality signal and are less prone to electromagnetic interference.

Take It To The Next Level: Setting Up DMX Control

Step 1: Connect the male connector of the DMX cable to the female connector (output) on the controller.

Step 2: Connect the female connector of the DMX cable to the first unit's male connector (input). *Note:* It doesn't matter which unit address is the first one connected. We recommend connecting them in terms of their proximity to the controller, rather than connecting the lowest fixture number first, and so on.

Step 3: Connect others in the chain from output to input as above. Place a DMX terminator on the output of the final unit to ensure best communication.

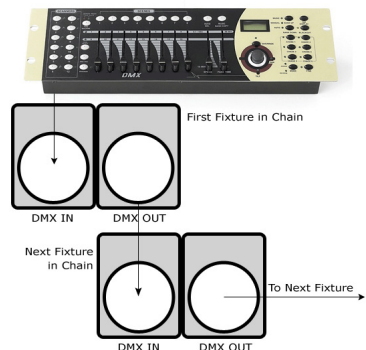

4. OPERATING ADJUSTMENTS

The Control Panel

All the settings possible with the AtmosFEAR® Big Bad Lo Fo are accessed by using the touch screen LCD control panel on the front of the unit. There are 5 control buttons on the display which provide functionality and allow you to navigate through the various options.



Button	Function
<MENU>	Used to navigate to a previous higher-level menu item.
<UP>	Value adjustment upward.
<DOWN>	Value adjustment downward.
<ENTER>	Is used to select and confirm/store the current selection.
<TIMER>	Starts or stops timer operation.

To navigate the control menu, use the <MENU> button to scroll through the various options. The currently highlighted option will be flashing, and can have its values changed by using the <UP/DOWN> buttons. After a value has been changed, press the <ENTER> button to save.

Note: Once a DMX signal is received, manual mode is deactivated.

Fault Warnings

From left to right: Remote / Fault of Sensor / Fault of Heater / Lack of Fluid



**The above warning icons will only appear on the menu when there is a fault.*

Control Panel Menu Structure

Interval	0s–255s (seconds)	Pause time between timed output
DMX	1–512	Set the starting DMX address
Volume	0%–100%	Set the volume output
Fan Speed	1%–100%	Set the fan speed
Duration	0s–200s (seconds)	Duration time of timed operation

DMX Configuration

1. Press the **<MENU>** button until **DMX** is highlighted and flashing.
2. Use **<UP/DOWN>** to select the starting address 1–512.
3. Press the **<ENTER>** button to confirm.

Interval and Duration Settings

Interval settings control the period of time in between timed fog outputs (in seconds), while duration settings are used to control the actual period of time of the timed output (in seconds) while using timer mode.

1. Press the **<MENU>** button repeatedly until **Interval** or **Duration** is highlighted and flashing.
2. Use **<UP/DOWN>** to select the number of seconds (0–200).
3. Press the **<ENTER>** button to confirm.
4. Press the **<TIMER>** button to start your configured timed output.

Set the Output Volume

1. Press **<MENU>** repeatedly until **Volume** flashes on the display.
2. Use **<UP/DOWN>** to select an output volume percentage (1%–100%).
3. Press the **<ENTER>** button to confirm.

Set the Fan Speed

1. Press **<MENU>** repeatedly until **Fan Speed** flashes on the display.
2. Use **<UP/DOWN>** select a total speed percentage (1%–100%).
3. Press the **<ENTER>** button to confirm.

Keeping Your AtmosFEAR® Big Bad Lo Fo As Good As New

This unit is a rugged, tough piece of professional equipment, and as long as you take care of it, it will take care of you. That said, like anything, you'll need to take care of it if you want it to operate as designed. You should absolutely keep the fixture clean, especially if you are using it in an environment with a lot of dust, haze, wild animals, wild teenagers or spilled drinks.

Cleaning Instructions:

- 1.) You should follow these instructions after approximately 40 hours of use.
- 2.) Take off the fluid nozzle before heating the machine, and clean the nozzle with straight vinegar.
- 3.) To clean the fluid tank, pour in and run a solution of 80% distilled water and 20% white vinegar through the machine. When empty turn off the machine.
- 4.) Wait for it to cool down, re-install the nozzle, and you can now add more fluid to prepare for its next use.

Returns (Gasp!)

We've taken a lot of precautions to make sure you never even have to worry about sending a defective unit back, or sending a unit in for service. But, like any complex piece of equipment designed and built by humans, once in a while, something doesn't go as planned. If you find yourself with a fixture that isn't behaving like a good little fixture should, you'll need to obtain a Return Authorization (RA).

Don't worry, this is easy. Just go to our website and open a support ticket at www.blizzardlighting.com/support, and we'll issue you an RA. Then, you'll need to send the unit to us using a trackable, pre-paid freight method. We suggest using USPS Priority or UPS. Make sure you carefully pack the fixture for transit, and whenever possible, use the original box & packing for shipping.

When returning your fixture for service, be sure to include the following:

- 1.) Your contact information (Name, Address, Phone Number, Email address).
- 2.) The RA# issued to you
- 3.) A brief description of the problem/symptoms.

We will, at our discretion, repair or replace the fixture. Please remember that any shipping damage which occurs in transit to us is the customer's responsibility, so pack it well!

Shipping Issues

Damage incurred in shipping is the responsibility of the shipper, and must be reported to the carrier immediately upon receipt of the items. Claims must be made within seven (7) days of receipt.

Tech Specs!

Weight & Dimensions	
Width	34.7 in (88 cm)
Depth	19.3 in (49 cm)
Height	20.5 in (60 cm)
Weight	96 lb. (44 kg)
Power	
Operating Voltage	AC110-220V 50/60HZ
Power Consumption	1983W, 19.1A, PF: .99
Fuse	15A, 250V
Thermal	
Max. Operating Temp.	104 degrees F (40 degrees C) ambient
Operation/Capacity	
Warm-up Time	5-8 min.
Water Tank Capacity	13L
Fluid Tank Capacity	2L
Output	8,000 cubic ft./minute continuous output
Fluid Consumption	1h/L
Output Hose	2x10 FT
Control	
Protocol	USITT DMX-512
DMX Channels	3-channel
Input	3/5-pin XLR Male
Output	3/5-pin XLR Female
Warranty	
	1-year limited warranty



Enjoy your product!
Our sincerest thanks for your purchase!
--The team @ Blizzard Lighting