

### General Description

Shure Microflex® MX200 Series microphones are miniature electret condenser microphones designed for miking choirs and performance groups. They are typically suspended over the heads of the performers. Their high sensitivity and wide frequency range make them suitable for recording, as well as sound reinforcement applications. An attached 101 mm (4 in.) gooseneck allows them to be easily aimed at the sound source.

- Wide dynamic range and frequency response for accurate sound reproduction
- Interchangeable cartridges that provide a choice of polar pattern for each application
- White or black finish that blends unobtrusively with most surroundings

- RF filtering

### Model Variations

Microflex MX202 microphones are available in black or white with a choice of in-line preamplifier or plate-mount preamplifier.

The polar pattern of the included cartridge is indicated by a model number suffix:

- /C** Cardioid
- /S** Supercardioid
- /N** Cartridge not included

### Interchangeable Cartridges

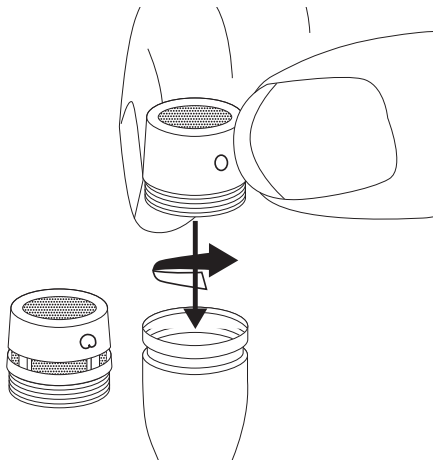

Microflex microphones use interchangeable cartridges that allow you to choose the polar pattern for different installations.

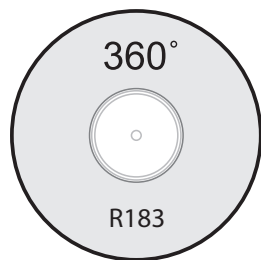

Omnidirectional

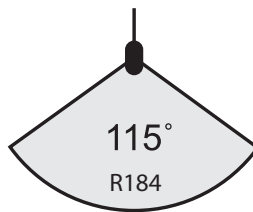

Supercardioid

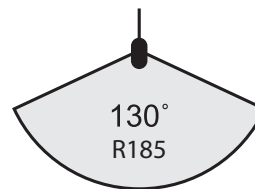

Cardioid

Cartridge Polar Patterns

### Snap-Fit Windscreen

- Snap into the groove below the cartridge.
- To remove, spread the gap with a screwdriver or thumbnail.
- Provides 30 dB of "pop" protection.

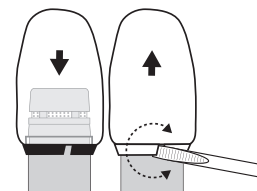

## Preamp Gain

If necessary, the preamplifier gain can be reduced by 12 dB. Contact an authorized Shure service center for information.

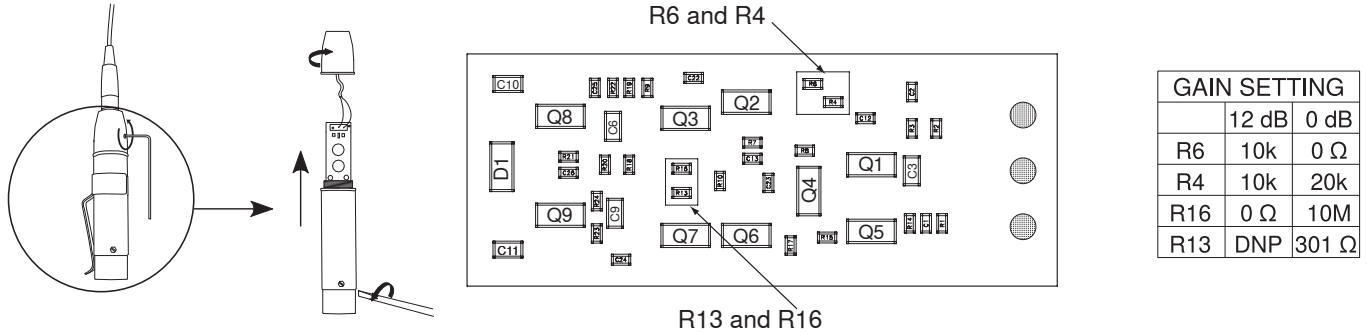

GAIN SETTING		
	12 dB	0 dB
R6	10k	0 Ω
R4	10k	20k
R16	0 Ω	10M
R13	DNP	301 Ω

## RFI Filtering

**Important:** Microphones must be used with the RK100PK and RK202PK plate-mounted preamp to optimize RF immunity.

## Microphone Placement

The microphone is most stable when the gooseneck is bent into a "lazy S" shape. Use the supplied hanging clip and heavy thread or monofilament fishing line to suspend the microphone at a specific location.

- For choir installations, hang a microphone 0.6 to 0.9m (2 to 3 ft.) in front of the first row, and 0.6 to 0.9m (2 to 3 ft.) over the heads of the singers in the last row. Aim the microphone at the back row.
- When miking groups that move or vary in size, use a boom stand and the supplied stand adapter.
- If four or more microphones will be open at once, an automatic mixer, such as the Shure SCM810 or SCM410, is recommended. Set up the automatic mixer so that all overhead microphones gate on simultaneously.

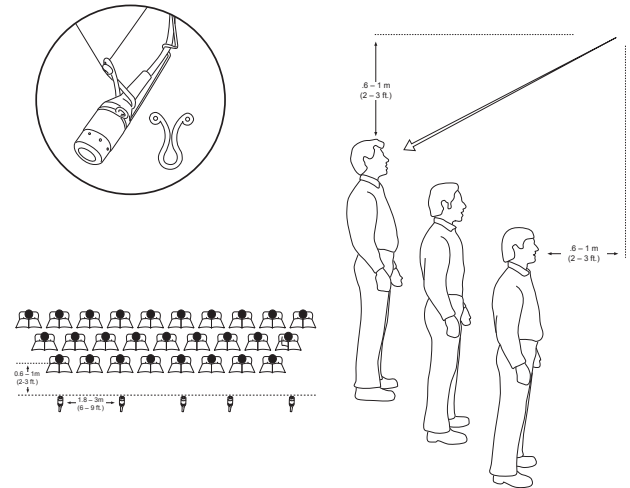

## Permanent Installation

### Installing the In-Line Preamp

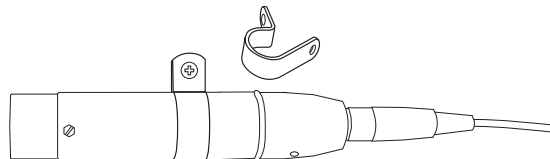

Use the two supplied mounting clamps to hold the preamp in place on a wall or ceiling.

## Ceiling Tile Installation

1. Drill a 1/2 in. hole into the ceiling tile. CAUTION: To avoid tile damage, use a 1/2 in. augur bit and drill very slowly.
2. Unplug the mini 4-pin connector from the preamp and feed the cable through the hole.
3. Place the rubber grommet, tip down, over the cable and position it to suspend the microphone at the appropriate height.
4. Fit the grommet securely into the hole. For 5/8 in. ceiling tile, use the supplied washer.
5. Reconnect the preamp.

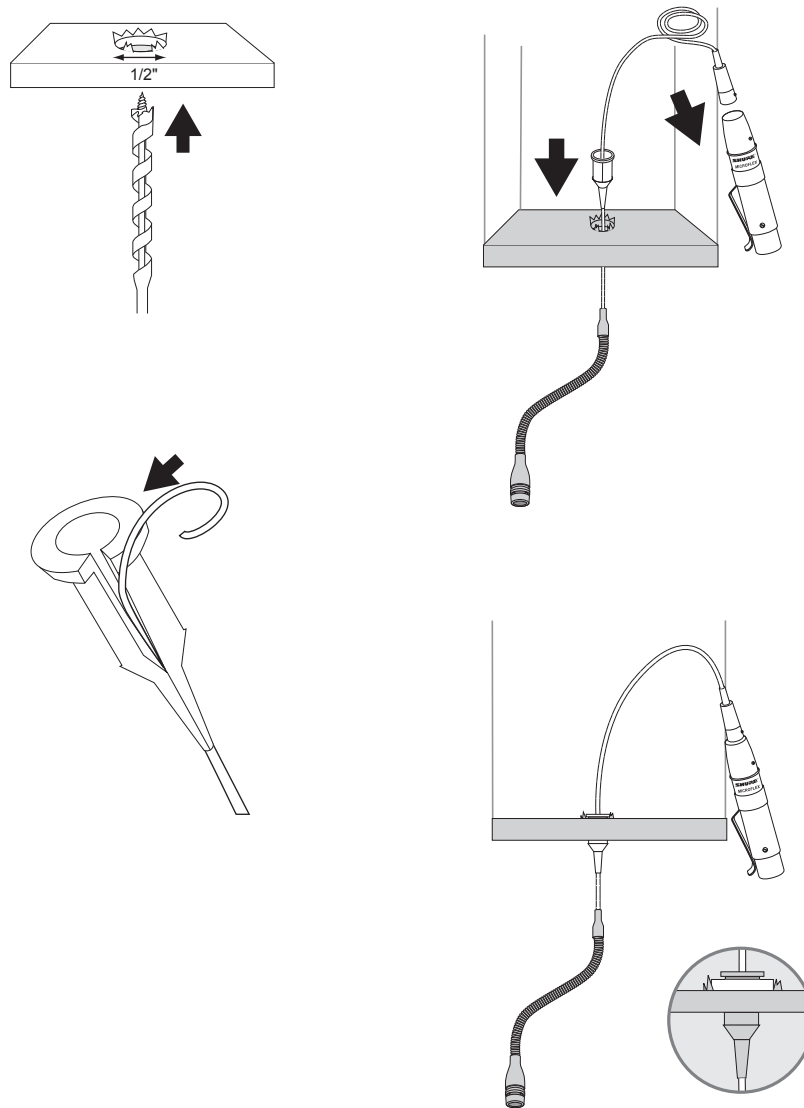

## Plate Mount Preamp Installation

The plate-mounted preamp allows you to mount the preamp in an electrical box and use conduit to run cable through ceilings and walls.

1. Remove preamp housing by removing two phillips head screws.
2. Remove knock-out from the hole in the center of the cover plate (if present).
3. Cut cable to desired hanging length, allowing for a 76 to 101 mm (3 to 4 in.) service loop.
4. Clamp strain relief around cable and insert strain relief into hole in plate.
5. Connect cable leads to input terminal block (B = Black, R = Red, S = Shield).
6. Using professional-quality, two-conductor, shielded microphone cable, thread output cable from outside of preamp through hole with black bushing.
7. Connect cable to output terminal block (Pin 2 = +, Pin 3 = -, Shield = S).
8. Reattach the preamplifier housing.

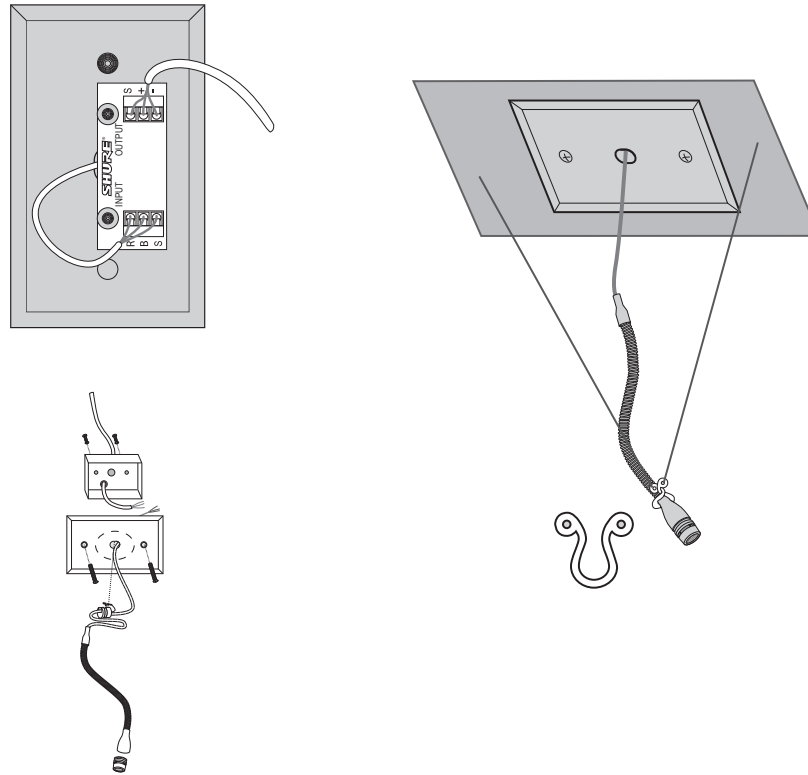

## Specifications

**Note:** Yellowing of any plastic material can be caused from cigarette smoke, ultra violet rays, and other chemical interactions. Once plastic has yellowed, there typically is no cleaning method that will restore the whiteness.

## Accessories

### Furnished Accessories

Black Snap-Fit Foam Windscreens (4) for BETA98, BETA98A, BETA98/S, BETA98D/S, BETA98H/C, MX183, MX184, MX185, MX202, WH30, WL183, WL184 and WL185	RK183WS
Black Snap-Fit Foam Windscreens (4) for Beta 98, Beta 98A, Beta 98/S, Beta 98D/S, Beta 98H/C, MX183, MX184, MX185, MX202, WH30, WL183, WL184 and WL185	
White Snap-Fit Windscreen	95B2064
Preamplifier Kit, Plate Mounted, White (MX202BP and MX202WP)	RK202PK
Stand Adaptor (MX202B and MX202W)	65B1752

### Optional Accessories

Small Black Desk/Table Stand for MX202 Microphones	A202BB
--	--------

### Replacement Parts

RFI Resistant, Inline Preamp for all MX Models (Black)	RK100PK
RFI Resistant, Inline Preamp for all MX Models (White)	RK100PKW
Black or White Omnidirectional Cartridge for all MX- (Microflex®) Models and WL183	R183B
White Omnidirectional Cartridge for MX- (Microflex®) Models	R183W
Black or White Supercardioid Cartridge for all MX- (Microflex®) and WL183, WL184 and WL185 Models	R184B
White Supercardioid Cartridge for MX- (Microflex®) Models	R184W
Black or White Cardioid Cartridge for WL185 and all MX- (Microflex®) Models	R185B
White Cardioid Cartridge for MX- (Microflex®) Models	R185W
Strain Relief (MX202BP and MX202WP)	80A479
Clamp (MX202B and MX202WP)	80A476
Hang Clip	80B489

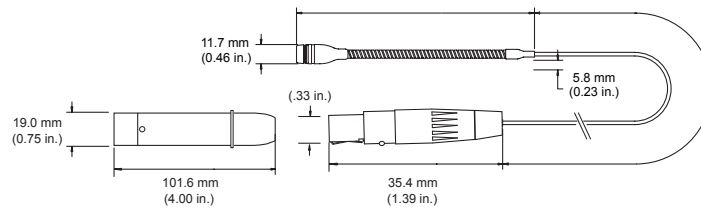
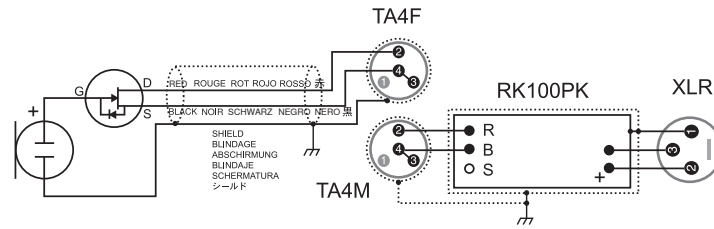

## Certifications

Meets essential requirements of all applicable European Directives.

Eligible for CE marking.

The CE Declaration of Conformity can be obtained from:  
[www.shure.com/europe/compliance](http://www.shure.com/europe/compliance)

Authorized European representative:  
 Shure Europe GmbH  
 Headquarters Europe, Middle East & Africa  
 Department: EMEA Approval  
 Jakob-Dieffenbacher-Str. 12  
 75031 Eppingen, Germany  
 Phone: +49-7262-92 49 0  
 Fax: +49-7262-92 49 11 4  
 Email: [info@shure.de](mailto:info@shure.de)