

Luma-Net® to LumaCAN® Gateway

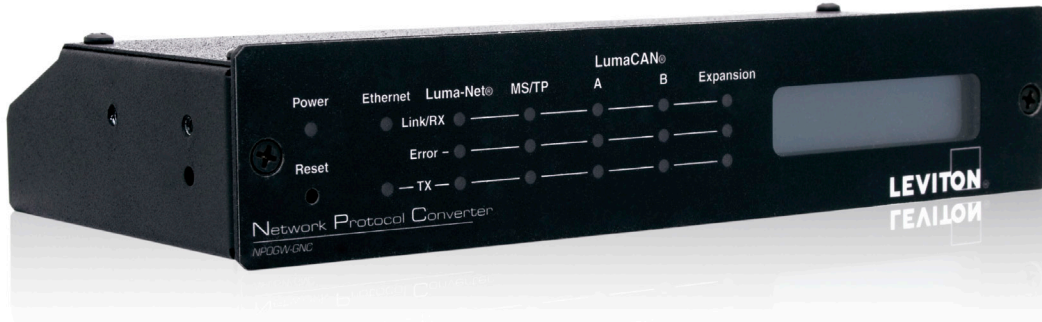

DEFINITION

The Luma-Net® to LumaCAN® gateway offers convenient network conversion in order to provide seamless communication between products on either system. The Gateway exchanges channel data between the Luma-Net and LumaCAN networks, allowing devices using different protocols to seamlessly operate together. The Gateway is easily configurable through a web-based interface or by directly editing the SD card configuration file.

FEATURES

- The bidirectional protocol converts from Luma-Net to LumaCAN* and vice versa
- Processes channel, group and dimmer status messages
- Converts between LumaCAN 2 and LumaCAN 3*
- 250 nodes per subnet with 254 subnets
- LCD front panel provides system start-up information, displays address information for Luma-Net, LumaCAN and ethernet, and error information
- Activity LED: Luma-Net, LumaCAN, ethernet
- Update software via FTP
- Real time clock for time stamping of log file entries
- Reset switch
- Factory default button to restore factory settings
- Rack ears included for mounting in a standard EIA 19" rack, IRU
- 2 Gateways may be installed side by side in side-by-side IRU space

*Converts between two protocols of your choice

PRODUCT DATA

SYSTEM EXAMPLE 1

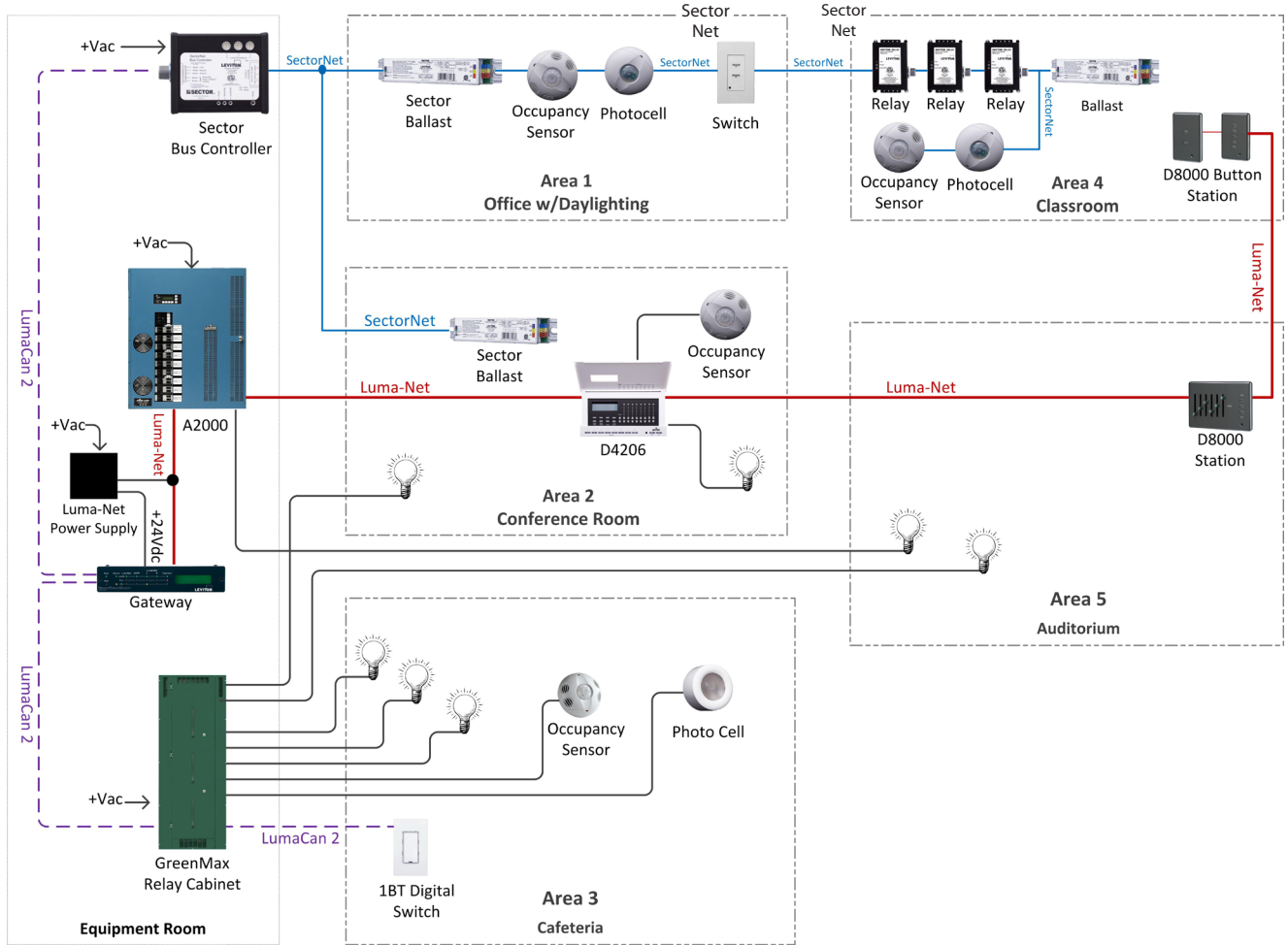

NOTE: Control philosophy should be kept to a singular type for each room, for example GreenMAX™ digital switches and Dimensions® D4000 stations should not be installed in the same room but may be installed in separate rooms.

SYSTEM EXAMPLE 2

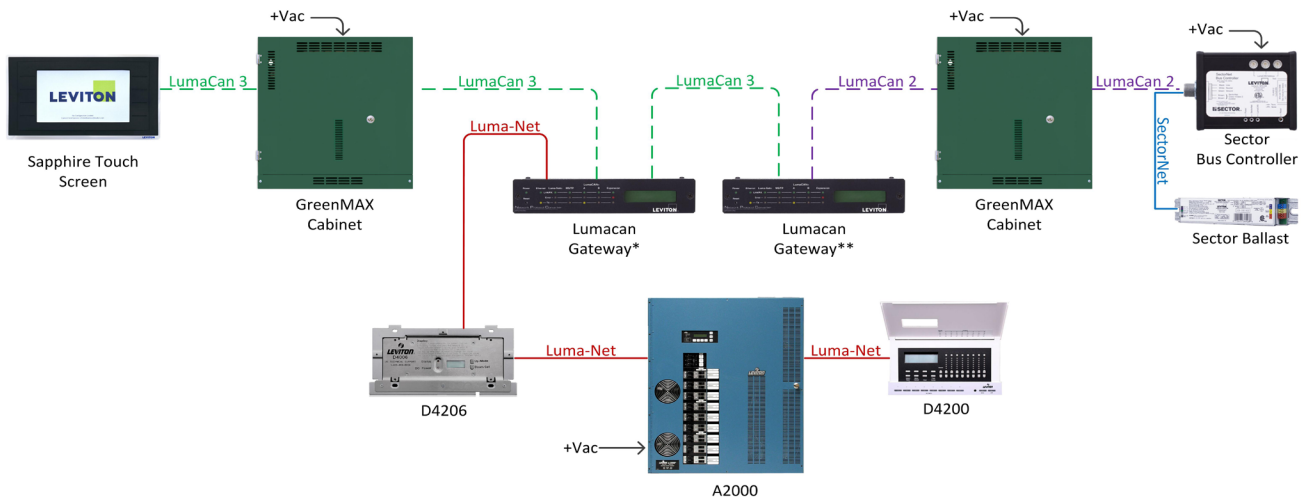

*Connects Luma-Net to LumaCan 3
 ** Connects LumaCan 2 to LumaCan 3

CLASSROOM APPLICATION

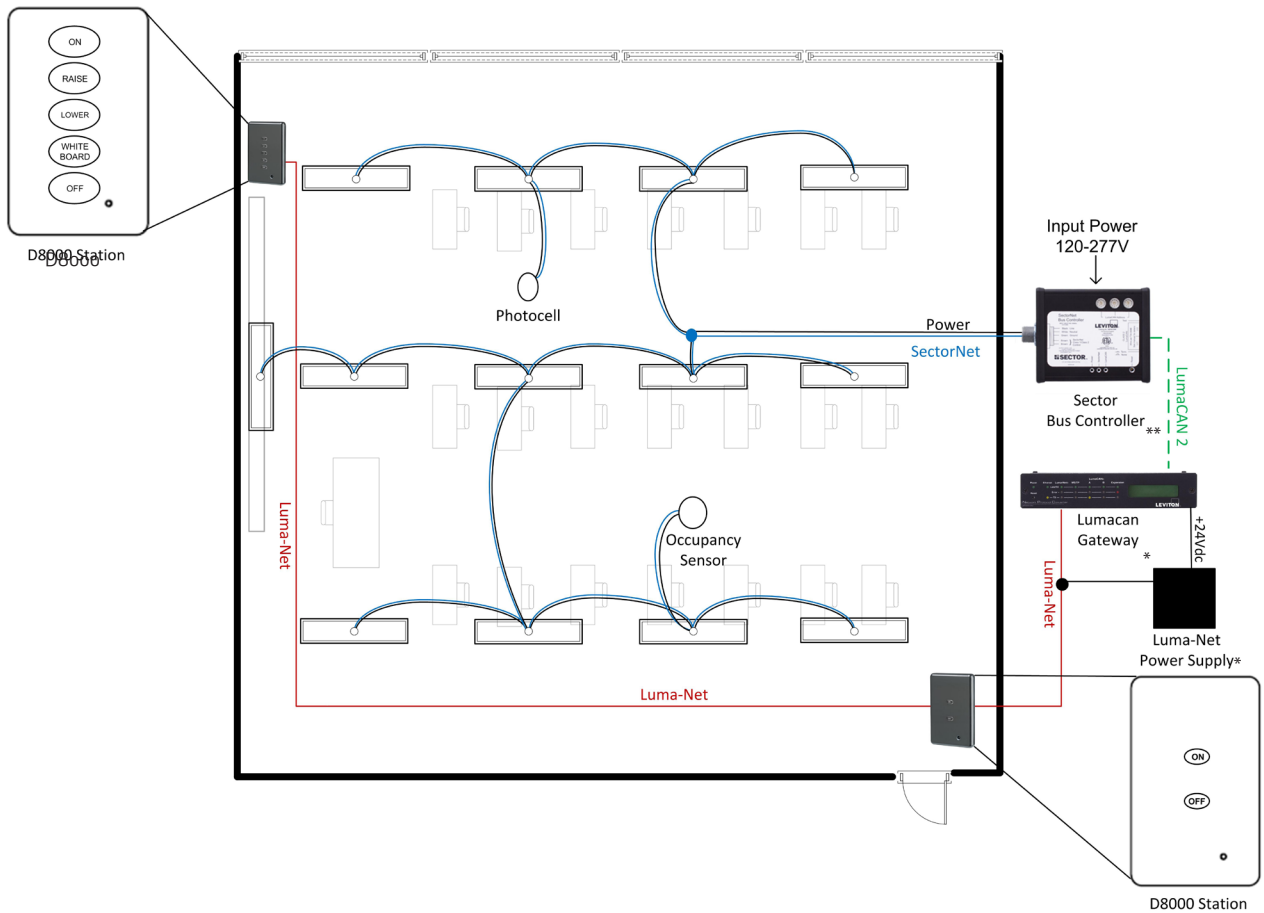

* Only one needed per system
** One required per 8 areas or 64 devices

BACK PANEL CONFIGURATION

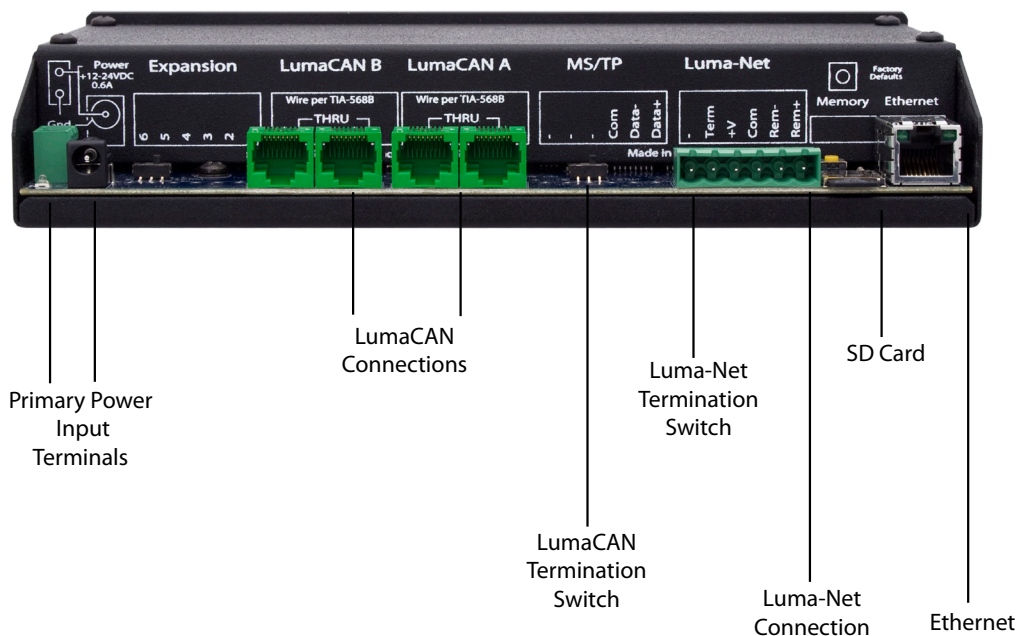

Luma-Net® to LumaCAN® Gateway

PRODUCT DATA



SPECIFICATIONS

ELECTRICAL	
Power Requirements	12-24 VDC, can be powered via the LumaCAN bus or hardwired terminals
Power Consumption	0.6A
SIZE	
Dimensions	8.695" x 4.99" x 1.547"/22.09 x 12.67 x 3.93 cm
Weight	1.8 lbs/81.65 kg
ENVIRONMENTAL	
Operating Temperature Range	32°F to 104°F (0°C to 40°C)
Relative Humidity	5% to 95% non-condensing, for indoor use only
OTHER	
Installation Requirements	Stand alone (desktop) or 19" EIA rack mount, 1 RU & power
Certifications	CE, IEC 61000-4-2, RoHS compliant, FCC
Warranty	Limited Two-Year Warranty

ORDERING INFORMATION

CAT NO.	DESCRIPTION
NP00G-000	Luma-Net to LumaCAN Gateway
ACCESSORIES	
EIA00-S01	1RU 19" EIA Rack, surface mount enclosure, opening on side
PST24-D25	Luma-NET power supply, UL listed, 120-230VAC, 50/60 Hz input, 24VDC 2.5A output. Surface mounted with terminals (not suitable for use in CE Markets)

LEVITON SPECIFICATION SUBMITTAL

JOB NAME:	CATALOG NUMBERS:
JOB NUMBER:	

Leviton Manufacturing Co., Inc. Lighting & Energy Solutions

20497 SW Teton Avenue, Tualatin, OR 97062 • Tel: 1-800-736-6682 • Fax: 503-404-5594 • Tech Line (6:00AM-4:00PM P.S.T. Mon-Fri): 1-800-959-6004

Leviton Manufacturing Co., Inc. Global Headquarters

201 N. Service Rd. Melville, NY 11747-3138 • Tech Line: 1-800-824-3005 • Fax: 1-800-832-9538

Leviton Manufacturing of Canada, Ltd.

165 Hymus Boulevard, Pointe Claire, Quebec H9R 1E9 • Telephone: 1-800-469-7890 • FAX: 1-800-563-1853

Leviton S. de R.L. de C.V.

Lago Tana 43, Mexico DF, Mexico CP 11290 • Tel. (+52) 55-5082-1040 • FAX: (+52) 5386-1797 • www.leviton.com.mx

Visit our Website at: www.leviton.com/les

© 2013 Leviton Manufacturing Co., Inc. All rights reserved. Subject to change without notice.

G-8623A/L13-aa
REV DEC 2013