

# SPEECS

PEAVEY ELECTRONICS

## The Scorpion® Series Speakers

**Scorpion® S - 10825 - 8 Ohm  
00013770**

**Scorpion® S - 12825 - 8 Ohm  
00013750**

The Scorpion® Series 10, and 12 musical instrument loud speakers have earned a reputation of unequalled tonal response and reliability. Their use in a wide range of professional musical instrument systems has proven the Scorpion superiority.

Our exclusive field replaceable basket/cone assembly, first introduced in the Black Widow® Series, exemplifies the Scorpion's many unique capabilities and advantages.

During modern performance situations, damaging D.C. voltages or other unwanted signal sources could possibly damage any loud speaker or cause complete failure. Although this is not a common occurrence, the Peavey Scorpion Series has been designed to deal with such incidents with our field replaceable basket/cone assembly. In the event of speaker damage/failure, the musician/sound crew can easily remove the magnet from the basket assembly with three bolts, clean the gap and utilize a new basket/cone assembly for replacement. This unique system saves time, money and, many



times, the performance itself! The high power handling capability coupled with a large 2 1/2" diameter ribbon aluminum voice coil allows any model Scorpion to produce very high sound pressure levels and maintain those levels over a long period of time.

The die cast aluminum frame and large magnetic assembly with vented pole piece ensures superior cooling, long life and durability.



The unique die cast frame of the Scorpion also incorporates a “square frame” design allowing these fine transducers to be utilized in a variety of small, compact enclosures. Because of the Scorpion’s “adaptability” to

many enclosure designs (infinite baffle, tuned and ported, etc.), the modern musician will find distinct advantages for utilizing our Scorpions over competing transducers. For example, full range response for guitar amplification

or excellent high end/mid range response for bi-amped (or tri-amped) bass and key board rigs.

Our 10” and 12”, 8 ohm loudspeakers are now available to discriminating musicians who require superb sound reproduction, outstanding durability and high sound pressure levels.

## APPLICATIONS

The S-10825 and S-12825 Scorpion® loud speakers are ideally suited for lead and rhythm guitar applications. The extended bandwidth and excellent high frequency response provide superb performance for electric bass and bass bi-amp configurations, and because of their versatility, the Scorpion Series also can be used for many keyboard systems.

SPECIFICATIONS	00013770	00013750
MODEL	Scorpion® S - 10825 - 8 Ohm	Scorpion S - 12825 - 8 Ohm
DIAMETER	10"	12"
IMPEDANCE	8 Ohms	8 Ohms
POWER CAPACITY	800W peak	800W peak
	400W program	400W program
	200W continuous	200W continuous
SENSITIVITY	95.1 dB/1W 1m	94.9 dB/1W 1m
USABLE FREQ. RANGE	80 Hz ~ 4 kHz	60 Hz - 4 kHz
VOICE COIL DIAMETER	2.5" / 63.5 mm	2.5" / 63.5 mm
VOICE COIL MATERIAL	Kevlar® impreganated cellulose	Kevlar® impreganated cellulose
NET WEIGHT	7.5 lbs. / 3.4 kg	7.8 lbs. / 3.54 kg
Znom (Ohms)	8	8
Revc (Ohms)	5.58	5.34
Sd (square meters)	0.031	0.050
BL (T/M)	10.60	10.51
Fo (Hz)	102.0	59.4
Vas (liters)	14.6	66.6
Cms (uM/N)	104.3	187.2
Mms (gm)	23.30	38.30
Qms	7.00	5.25
Qes	0.742	0.691
Qts	0.671	0.611
Xmax (mm)	0.06	0.25
Le (mH)	0.40	0.30
SPL (1W 1m)	95.1	94.9
No (%)	2.03	1.96
Vd (cu in/ml)	1.1 / 19	0.76 / 12.5
Pmax (Watts pgm)	400	400
Disp. (cu. in /ml)	91 / 1491	126 / 2064

# Peavey Scorpion<sup>®</sup> speakers

feature convenient field-replaceable baskets. Replaceable baskets eliminate the need for re-coning speakers and the frustration and delays associated with the re-coning process. It only takes a few minutes to replace a basket and you are back in business. It just can't get any easier than the four steps outlined here.

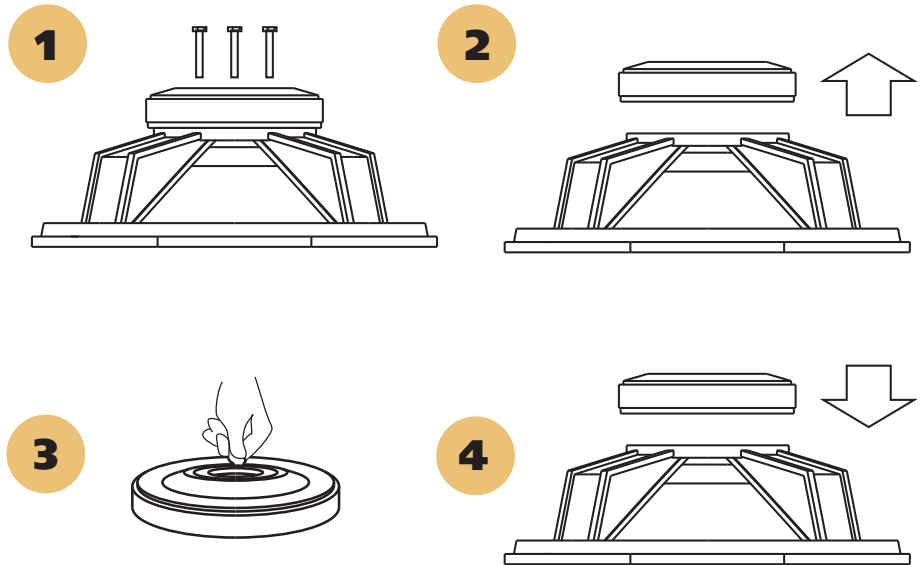

## **Baskets are replaced in four easy steps:**

- 1** Remove three screws on back of magnet structure.
- 2** Lift the magnet structure off the basket frame.
- 3** Clean the voice coil "gap".
- 4** Align screw holes, lower structure into place on new basket frame, insert screws and tighten.

## ONE YEAR LIMITED WARRANTY

NOTE: For details, refer to the warranty statement. Copies of this statement may be obtained online at [www.peavey.com](http://www.peavey.com).



*Features and specifications subject to change without notice.*

**Peavey Electronics Corporation • 5022 Hartley Peavey Drive • Meridian • MS • 39305**

**(601) 483-5365 • FAX (601) 486-1278 • [www.peavey.com](http://www.peavey.com)**

**©2011 Printed in the U.S.A. 10/11 80306038**



Logo referenced in Directive 2002/96/EC Annex IV  
(OJ(L)37/38,13.02.03 and defined in EN 50419: 2005  
The bar is the symbol for marking of new waste and  
is applied only to equipment manufactured after  
13 August 2005