

The Light Source

Mega-Coupler with Flat Head Bolt

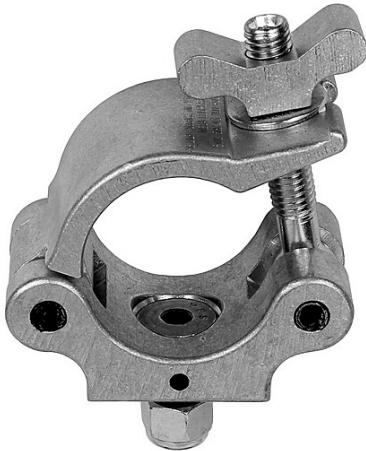

This Mega-Coupler replaces the standard Hex Head bolt with a flat head countersunk bolt.

Available with a 1/2" flat head base or a 3/8" flat head base to fit a flat head bolt. An Allen wrench is required to adjust this bolt.

Also available with an M12 flat head metric bolt (40mm length) to fit the Martin Mac 101 LED light or other European fixtures. Order codes for counter sunk couplers with metric bolts are MLB-M12CS and MLM-M12CS.

You can also replace the standard Light Source wing nut with a steel wing nut.

Minimum Size	1 1/4" pipe, 1.66OD truss tube
Maximum Size	2" pipe, 2.050OD truss tube
Safe Vertical Working Load	1100 pounds
Hardware	1/2" x 1.5" flat head bolt or 3/8" x 1.5" flat head bolt Nylock Nut Belleville Washer
Weight	1.1 pounds
Case Quantities	24
Order Codes	MLM1/2CS Mega-Coupler with CS base and 1/2" Flat Head Bolt, Silver MLB1/2CS Mega-Coupler with CS base and 1/2" Flat Head Bolt, Black Anodized MLM3/8CS Mega-Coupler with CS base and 3/8" Flat Head Bolt, Silver MLB3/8CS Mega-Coupler with CS base and 3/8" Flat Head Bolt, Black Anodized SF M12X40MM-APL M12 x 40mm Flat Head Bolt to fit MAC 101, Silver MLB-M12CS Mega-Coupler with Flat Head Bolt and Metric Hardware, Black Anodized MLM-M12CS Mega-Coupler with Flat Head Bolt and Metric Hardware, Silver