

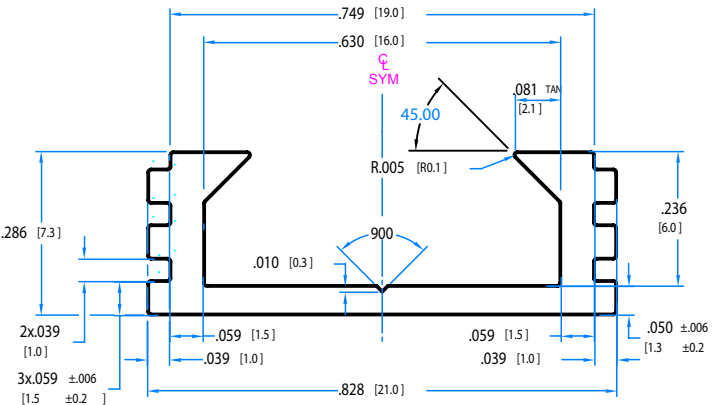

FLEX CHANNEL™

Aluminum Tracks For All Elation Flex Products

FLEX CHANNEL™ is a line of rugged aluminum tracks, suitable for wet location installations, and are compatible with all Elation FLEX Tape WP™ products. Optional UV stabilized lens covers and 45° bracket accessories are available.

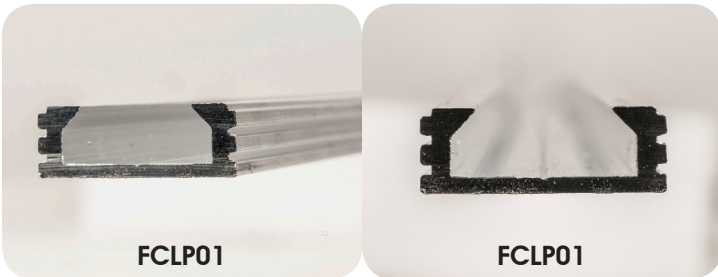

FLEX CHANNEL LOW PROFILE	
MATERIAL / RATING	Aluminum / Wet Locations
DIMENSIONS (L x W x H)	4.0" x 0.75" x 0.28" (101.6mm x 19.1mm x 7.1mm)
COMPATIBLE PRODUCTS	FLEX LED TAPE WP, FLEX PIXEL WP
ORDER CODE	ITEM
FCLP01	Flex Channel Low Profile
FCM045	Optional 45° Bracket and Screws (Set of 4)

Specifications are subject to change without notice ©Elation Professional 01/11/17

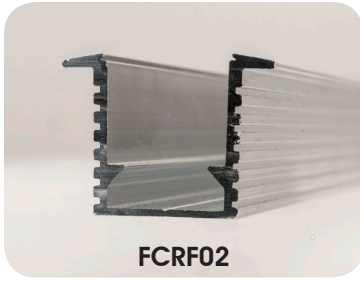

FCRF02

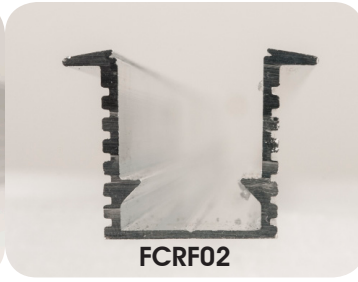

FCRF02

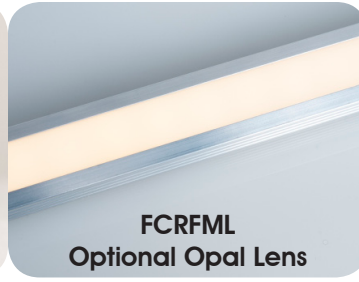

FCRFML
Optional Opal Lens



FCRFFL
Optional Frosted Lens

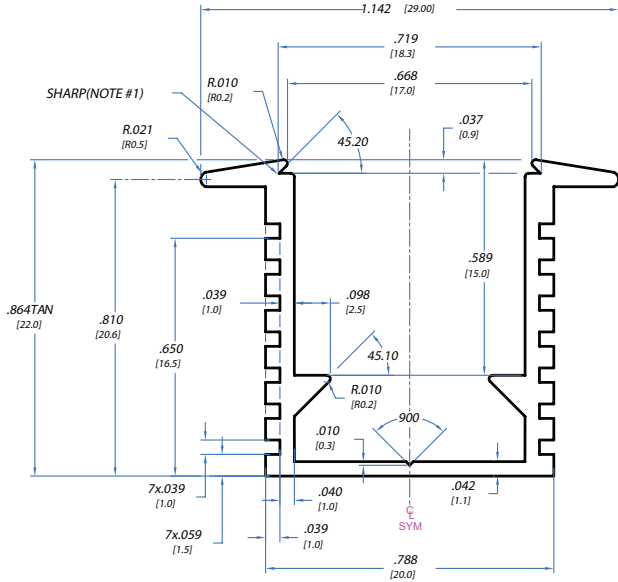

FLEX CHANNEL RECESSED	
MATERIAL / RATING	Aluminum Channel + Polycarbonate Lens / Wet Locations (both)
DIMENSIONS (L x W x H)	4.0" x 1.14" x 0.86" (101.6mm x 29.0mm x 21.8mm)
COMPATIBLE PRODUCTS	FLEX LED TAPE WP, FLEX PIXEL WP
ORDER CODE	ITEM
FCRF02	Flex Channel Recessed
FCRFML	Optional Opal Lens (UV Stabilized)
FCRFFL	Optional Frosted Lens (UV Stabilized)

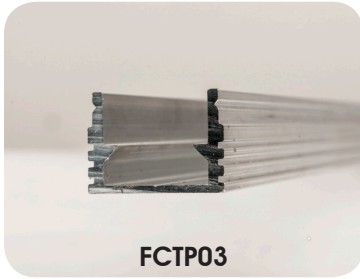

FCTP03

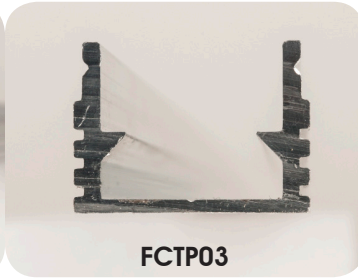

FCTP03



FCTP24
Optional Opal Lens



FCTP12
Optional Frosted Lens

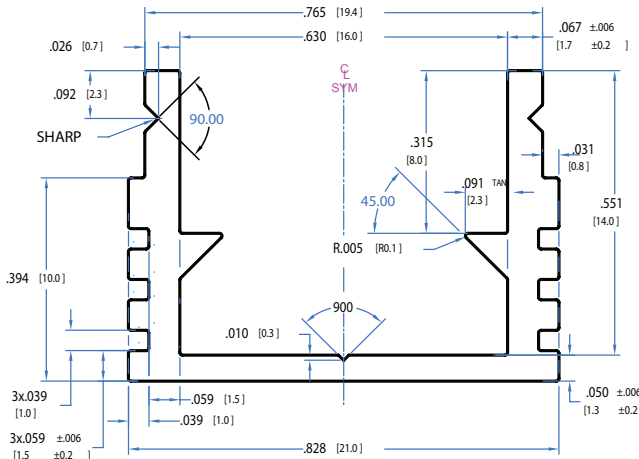

FLEX CHANNEL TALL PROFILE	
MATERIAL / RATING	Aluminum Channel + Polycarbonate Lens / Wet Locations (both)
DIMENSIONS (L x W x H)	4.0" x 0.76" x 0.5" (101.6mm x 19.3mm x 12.7mm)
COMPATIBLE PRODUCTS	FLEX LED TAPE WP, FLEX PIXEL WP
ORDER CODE	ITEM
FCTP03	Flex Channel Tall Profile
FCM045	Optional 45° Bracket and Screws (Set of 4)
FCTP24	Optional Opal Lens (UV Stabilized)
FCTP12	Optional Frosted Lens (UV Stabilized)



Specifications are subject to change without notice ©Elation Professional 01/11/17

Elation Professional USA | 6122 S. Eastern Ave. | Los Angeles, CA. 90040
323-582-3322 | 323-832-9142 fax | www.elationlighting.com | info@elationlighting.com

Elation Professional B.V. | Junostraat 2 | 6468 EW Kerkrade, The Netherlands
+31 45 546 85 66 | +31 45 546 85 96 fax | www.elationlighting.eu | info@elationlighting.eu