

SUMMARY

The Chalice 150 down light follows the Altman Lighting tradition of lighting quality. Designed specifically for the demands of theaters, churches and public venues, the Chalice 150 is a 145W White LED pendant fixture that is an energy-efficient solution to general lighting needs. The Chalice 150 addresses and alleviates the typical maintenance routines of changing lamps and ballasts in difficult-to-access locations. The Chalice 150 uses a single-point source for optimal beam control, and offers a variety of reflector options for ceiling heights from 15 to 50 feet. Its powerful and clean non-pixelated and non-granulated output blends to seamless coverage in the most elegant setting. Extremely smooth dimming reproduces the comfortable feel of traditional incandescent sources, at a fraction of the power consumption. Either Mains Dimmer or DMX control allows each fixture to be controlled independently or in groups, from an architectural control system and/or directly from a theatrical control console.

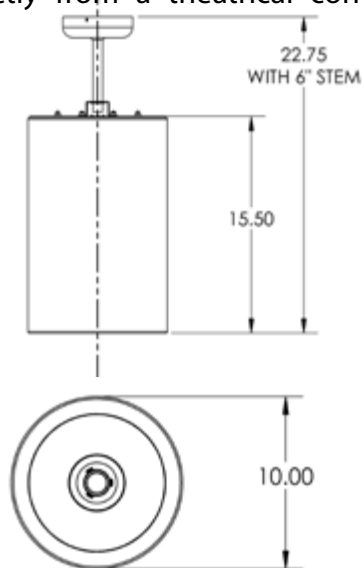

FEATURES

- Available in three hanging configurations: Pendant (stem or cable), Wall, or Yoke mount.
- 7 interchangeable reflectors.
- Over 10,000 lumens.
- Greater than 90 CRI.
- Single Channel High Resolution DMX Digital Dimming and Mains Dim Models
- Pushbutton DMX addressing.
- Black, White, Silver and custom colors available.
- CCT Options: 2700K, 3000K, 4000K, 5000K.
- Selectable actions on loss of control signal (for DMX Models only).
- ETL, cETL Listed (for Indoor Use)
- Made in the USA

SPECIFICATIONS

Source: 145 Watt Fixed White LED
Light : Output: > 10,000 Lumens **
Lumens/Watt: 74.0 **
CRI: > 90
Color Temperature: Choice of 2700, 3000, 4000, & 5000 Kelvin White
Input Voltage: 100 -277 VAC 50/60hz - DMX MODEL
 100 -240 VAC 50/60hz - MAINS DIM MODEL

Current DMX MODEL: 1.2Amps (@120VAC)
 0.68Amps (@220VAC)
 0.58Amps (@277VAC)

Current (MAINS DIM MODEL): 1.01A @ 120 VAC
 0.50A @240 VAC

Power Factor (MAINS DIM MODEL): >.92 full load

Current Inrush (MAINS DIM MODEL): 15Apk Max 1/2 cycle @230VAC.

Quiescent Load: 3.1 Watts (DMX MODEL ONLY)

Ambient Temperature: 0 to 40 degrees C (32 to 104 F)

Humidity: 5%-95% Non condensing

Cooling: Fanless Convection Cooling

Weight: 17.6 pounds (8kg) luminarie only.

Compliance: ETL / cETL Listed

** interdepdant upon reflector choice

PERFORMANCE

Model	Description
CD*150-**-***_****_*****	Chalice 150 Single Point 145W LED Pendant Mount Downlight
* (Mounting Method)	Add the following code for Hanging Method: P=Pendant Mount or Aircraft Cable, Y=Yoke Mount, W=Wall Mount
** (LED Color Temp)	Add the following code for Emitter CCT: 2K, 3K, 4K, & 5K, (Nb.2K=2700 Kelvin)
*** (Body Color)	Add the following code for Body Color: B=Black, W=White, S=Silver, C=Custom
****(Intensity Control)	D= DMX, M = Mains Dim
***** (Dim Curve Setting)	120=120V, 220=220V, Mains Dim Only

ACCESSORIES

Accessories P/N	Description
19-F13379	20 Degree Narrow Spot Reflector
19-F13380	29 Degree Spot Reflector
19-F13325	39 Degree Narrow Flood Reflector
19-F13381	46 Degree Medium Flood Reflector
19-F13401	51 Degree Wide Flood Reflector
19-F13402	64 Degree Very Wide Flood Reflector
19-F13838	91 Degree Extra Wide Flood Reflector

Accessories P/N	Description
510	Malleable Iron Pipe Clamp
99-C545-S-*	Ball Mount Assembly (* Color) BL=BLack, WH=WHite, SL=SLiver.
70-3980	Aircraft Cable Suspension Assembly
SS-8CDL-DMXTERM	DMX 120-Ohm Terminator Kit

Reflector Type	Lumen Output	10'-0" (3.048m)	20'-0" (6.096m)	30'-0" (9.144m)	40'-0" (12.192m)
20 Degree Narrow Spot	10746	515.4 fc (5547.7 Lux)	130.1fc (1400.3 Lux)	58.52 fc (629.9 Lux)	33.73 fc (363 Lux)
29 Degree Spot	9697	227.4 fc (2447.7 Lux)	58.36 fc (628.1 Lux)	26.67 fc (287.0 Lux)	15.41 fc (165.87 Lux)
39 Degree Narrow Flood	8983	112.4 fc (1209.8 Lux)	28.81 fc (310.1 Lux)	13.25 fc (142.6 Lux)	7.89 fc (84.9 Lux)
46 Degree Medium Flood	8845	135.7 fc (1460.6 Lux)	35.02 fc (376.9 Lux)	15.92 fc (171.3 Lux)	9.32 fc (100.3 Lux)
51 Degree Wide Flood	9155	93.95 fc (1011 Lux)	24.96 fc (268.6 Lux)	11.46 fc (123.3 Lux)	6.69 fc (72.0 Lux)
64 Degree Very Wide Flood	9260	84.7 fc (911.7 Lux)	21.96 fc (236.3 Lux)	10.28 fc (110.6 Lux)	6.08 fc (65.4 Lux)
91 Degree Extra Wide Flood	9200	47.5 fc (511.3 Lux)	12.9fc (138.1 Lux)	6.3fc (67.81 Lux)	3.23 fc (34.7 Lux)

** NOTE: Some Clipping of the beam will occur with the use of this 91 Degree Extra Wide Flood Reflector please see Chalice 150 IES files at www.altmanlighting.com for beam characteristics.