

SONY

SOUND & VIDEO
CONTRACTOR
WINNER
BEST SHOW
InfoComm 2015

TECHNOLOGY
WINNER
BEST SHOW
InfoComm 2015

Anywhere. Anytime.

SRG-300SE -1080/60p 3G-SDI and Live IP Streaming PTZ Camera

Sony's Expanding SRG PTZ Camera Line-Up is Ideal for City Council, Faith-Based Communities, Hospitality, Healthcare, Education, Sports, and more.

The SRG-300SE camera joins Sony's SRG PTZ high definition remotely operated camera line-up. The SRG-300SE builds on the SRG-300H's full HD (1080/60p) imaging, pace-setting 30x optical zoom and offers 3G-SDI interface for long distance, single cable transmission of 1080/60p 4:2:2 broadcast quality baseband digital video. It also is equipped with two audio inputs (a LINE input and a MIC input) for embedding audio into the IP stream. Its non-intrusive, compact camera body will be welcomed by healthcare and sports users who require high-end HD in 1080/60p quality without distracting the patient or the athlete. Furthermore, H.264 compressed video over IP can also be simultaneously streamed in varying, selectable bit rates to accommodate the given network bandwidth.

Audiences in overflow rooms or remote venues can monitor the event live and can also control the pan/tilt/zoom functions of the camera over IP. This enhances learning experiences and lets viewers feel like they have a front row seat. This new camera is ideal as a single-source PTZ camera with Sony's renowned high picture quality and reliability at an affordable price.

The PMW-RX50 1080/60p 3G-SDI recorder is a compact companion deck that records valuable content captured by the SRG-300SE camera. Just a single BNC coaxial cable run (up to a maximum of 262 feet) is all you need to preserve the highest quality 1080/60p content.



Key Features:

- 1/2.8" Exmor® CMOS Sensor - 1080/60p, 1080/60i, 720/60p
- Simultaneous 3G-SDI and IP H.264 Full HD streaming
- Network Port 10BASE-T/100BASE-TX (RJ-45)
- Web-viewing function for remote camera control for up to 20 clients
- High 30x Optical Zoom (12x Digital Zoom)
- 65° horizontal wide field of view
- Pan/Tilt angle: Pan +/- 170°; Tilt + 90°/-20°
- 3.5mm and RCA Mono audio inputs (embedded audio in IP stream)
- Built-in audio control (including Simplified Equalizer)



Simulated images

www.sony.com/PTZ



SRG-300SE & SRG-300SE/W PTZ Cameras

CAMERA	
Image Sensor	1/ 2.8 Exmor® CMOS
Number of Effective Pixels	Approx. 2.1 Megapixels
Signal System	1080/59.94p (A/B), 50p (A/B), 29.97p, 25p / 1080/59.94i, 50i / 720/59.94p, 50p, 29.97p, 25p
Minimum Illumination (50IRE)	1.4 lux (F1.6, 50 IRE, high-sensitivity mode OFF, 30 fps) 0.35 lux (F1.6, 50 IRE, high-sensitivity mode ON, 30 fps)
S/N Ratio	50 dB
Gain	Auto/Manual (0 to +43 dB)
Shutter Speed	1/1 to 1/10000 sec (59.94 Hz system)
Exposure Control	Auto, Manual, Priority AE (Shutter, Iris), Exposure Compensation, Bright
White Balance	Auto, Indoor, Outdoor, One-push auto, ATW, Manual
Optical Zoom / Digital Zoom	30x / 12x
Focusing System	Auto/Manual
Horizontal Viewing Angle	63.7 degree (wide)
Focal Length	F=4.3mm (wide) to 129mm (tele) F.16 to 4.7
Minimum Object Distance	10mm (wide) ~ 1200mm (tele)
Pan/Tilt Angle	Pan: +/- 170° Tilt: 90° / -20°
Pan/Tilt Speed (Max.)	Pan 100°/sec Tilt 90°/sec
Preset Position	256 * Presets 17 to 256 are stored on the PC/Laptop and save Pan/Tilt/Zoom/Focus only
CAMERA FEATURES	
Day/Night ICR	YES
Wide-D	YES (View-DR® technology)
Image Stabilization	YES
Image Flip	YES
INTERFACE	
HD Video Output	3G-SDI (does not support audio transmission)
Audio Inputs	MIC: Mini jack 3.5 mm (monaural: 2.5 VDC plug-in power), LINE in: RCA (monaural)
Camera Control Interface	RS-422, IP via CGI

Peripheral Equipment

RS-422 Serial VISCA™ Control



RM-IP10

- Comfortable P/T/Z operation with the optical three-axis joystick
- Versatile camera adjustment by simple panel operation

Dimensions

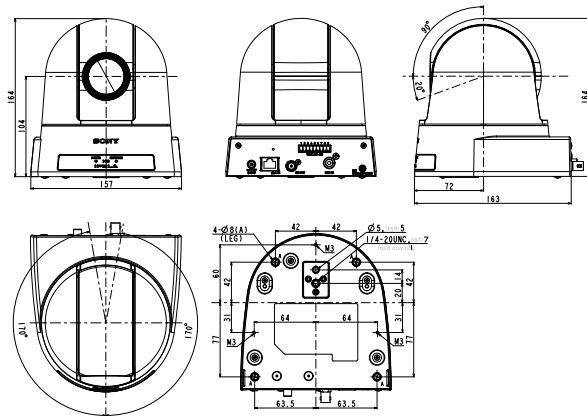

VIDEO	
Resolution	1920 x 1080, 1280 x 720, 1024 x 576, 720 x 576, 720 x 480, 704 x 576, 640 x 480, 640 x 360, 352 x 288, 320 x 184 (H.264, JPEG)
Compression Format	H.264, JPEG
Max. Frame Rate	H.264: 60 fps (1920 x 1080) / JPEG: 30 fps (1920 x 1080)
Bitrate Compression Mode	CBR/VBR (selectable)
Multi Streaming Capability	Triple Streaming
Number of Clients	20 *Up to 10 clients can receive video and audio combined streaming
AUDIO	
Compression Format	AAC-LC (64kbps/128kbps)
SYSTEM REQUIREMENTS	
Operating System	Mac OS® (plug-in free viewer only) Android®/iOS (Smart phone viewer only) Windows Vista™ (32 bit) Ultimate, Business Edition, Windows® 8 Pro (32/64 bit) Microsoft® DirectX 9.0c <
Processor	Intel Core i 7 2.8 GHz<
Memory	2 GB <
Web Browser	Microsoft Internet Explorer® Ver. 8.0 - 11.0 Firefox® Ver. 19.02 (Plug-in viewer only) Safari® Ver. 5.1 (Plug-in viewer only) Google Chrome® Ver. 25.0 (Plug-in version only)
NETWORK	
Protocols	IPv4, TCP, UDP, ARP, ICMP, IGMP, HTTP, DHCP, DNS, NTP, RTP/ RTCP, RTSP over TCP, RTSP over HTTP, IPv6, HTTPS, SNMP (v1, v2c, v3), SSL
GENERAL	
Power Requirements / Consumption	DC 12V (DC 10.8 to 13.2V) / 16.8W
Operating Temperature	32° F to 104° F (0° C to 40° C)
Storage Temperature	-4° F to +140° F (-20° C to +60° C)
Dimensions (W x H x D) / Weight	6-1/4 x 6-1/2 x 6-1/2 inches (157 x 164 x 163mm) / Approx. 3lb. 1.4 oz. (1.4 kg)
Supplied Accessories	AC Power Adaptor (1), AC Power Cable (1), Ceiling Bracket (2), RS-422 Connector Plus (1), Wire Rope (1), Screw M3 x 8 (8)

PMW-RX50 Portable Recorder

RECORDER	
3GSDI/HDSDI/SDSI Input	BNC (x1), 3G/HD/SD Selectable, SMPTE424M/292M/259M standards
3GSDI/HDSDI/SDSI Output	BNC (x2), 3G/HD/SD Selectable, SMPTE424M/292M/259M standards
Analog Composite Output	BNC (x1), NTSC, PAL or HD-Y
HDMI Output	Type A 19pin (x1), output
Analog Audio Input	XLR 3pin (CH1, CH2), LINE: -4dBu (reference level)
Analog Audio Output	Phone jack (CH1, CH2), -10dBu (reference level)
Headphone Output	Stereo mini-jack (x1)
i.LINK** Interface	IEEE1394, 4pin (x1)
USB	USB Type-A (x1), USA Type-mini B (x1)

*i.LINK is a trademark of Sony used only to designate that a product contains an IEEE1394 connector. Not all products with an i.LINK connector will necessarily communicate with each other. For information on compatibility, operating conditions, and proper connection, please refer to the documentation supplied with any device with an i.LINK connector.

Rear Panel



Sony Electronics Inc.
1 Sony Drive
Park Ridge, NJ 07656
www.sony.com/PTZ
IS-1262

©2015 Sony Electronics Inc. All rights reserved.
Reproduction in whole or in part without written permission is prohibited.
Features and specifications are subject to change without notice.
Screen images are simulated.
Weights and dimensions are approximate.
Sony, Exmor, View-DR, VISCA, and the Sony logo are trademarks of Sony.
All other trademarks are the property of their respective owners.