

High Performance Portable Projectors

Advanced Networking Capabilities

- Integrated RJ45 connection for quick connection to the LAN (10/100 base-T capability)
- Remote diagnostics enable the user to monitor and make adjustments to the projector remotely
- PC CTL 4.0 controls the power switching input selection and other functions while managing lamp usage and a variety of other vital information over the network. Email notification and projector scheduling for better asset management is included with the software.
- PC CTL 5.0 for MAC users
- Control and receive important broadcast messages via Crestron Roomview™
- Wireless Image Utility (WIU) sends images directly from an iPad to the projector (requires wireless LAN module NP05LM1)
- Simple Access Point Sending photos and documents have never been easier from a computer or iPad.
- MultiPresenter enables up to 16 wireless devices to be connected to the projector simultaneously with access controlled by the moderator.

Image Express Lite

Dedicated projector software provides wired and wireless data and audio transmission via peer-to-peer or over the network.

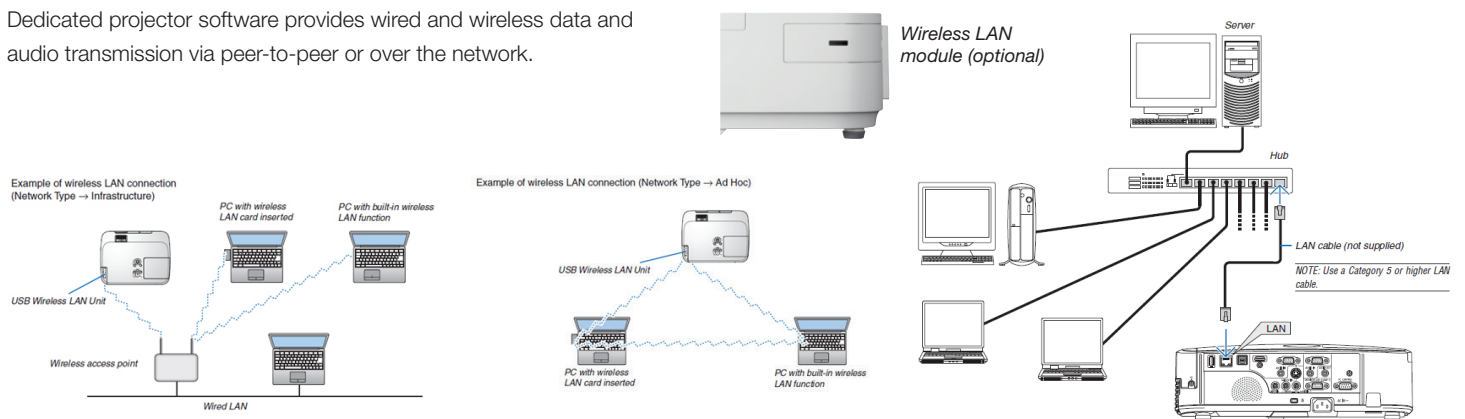

Advanced ECO Mode

ECO Mode

Lamp control selections with the ability to change power dependent on the ambient lighting conditions. With a built-in ambient light sensor, automatic adjustment of the projector's lamp provides unprecedented brightness control resulting in bright images for most environments. Automatically dim the image with the new Auto-dim feature to control the brightness of static images and extend lamp life. Constant brightness control prevents the usual drop in brightness over time while maximizing lamp life.

Built-in wall color correction presets

These provide for adaptive color tone correction to display properly on non-white surfaces.



On a green wall...

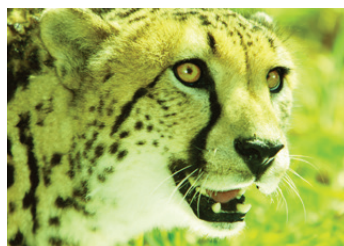

BEFORE auto wall correction



AFTER auto wall correction

M Series Features

Multi-screen Projection Function*

The multi-screen projection function allows you to share screens from multiple devices on various split-screen displays. Display information from up to 16 PCs, tablet PCs, smart phones, and other network connected devices on a multi-screen display of up to 16 screens. Easily share screens and information regardless of device or operating system.

*Requires an optional wireless LAN module for wireless connection. PCs require the installation of the Image Express Utility Lite software on the included CD-ROM. Smart phones and tablets require the download and installation of our Wireless Image Utility software.

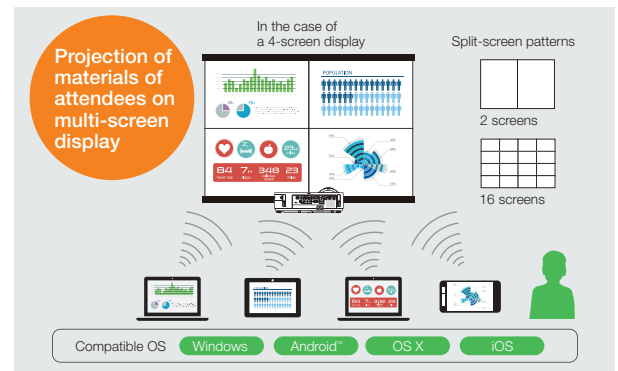

Top cover lamp change

This feature provides for easy lamp changes without removal of the projector from the mount.



Shielded Optical Structure and filterless Design

The filter-free design and shielded engine eliminate the hassle and time spent monitoring and/or changing filters.



Key optical parts are shielded for dust protection.



Magnetic sensor is effective against dust.

Remote control

Easy control from remote allows you to adjust lamp mode, aspect ratio, volume and image all with the touch of a button.



Dual HDMI inputs

Among the M Series' wide selection of inputs are 2 HDMI w/HDCP (one MHL compatible) for connecting to high-definition sources such as Blu-ray players, cable boxes, satellite receivers and personal computers.



Variable audio-out

This input enables the remote control to be used to adjust volume of self powered external speakers that are connected to the projector. In stand-by mode, the audio-out stays active, allowing the last input used to pass to the self-powered external speakers.



Full HD 3D video (144Hz)

When combined with active shutter glasses and 3D emitter, the M Series Projectors create 3D images from a computer or Blu-ray player. The projectors utilize the 3D sync line output to connect to the 3D emitter. Optional 3D glasses and emitters by XPAND are available from NEC (X105-RF-X2 / AD025-RF-X1)



USB Viewer

In instances when you'd prefer to leave your laptop behind for a presentation, M Series projectors can deliver a solution. Using the presentation conversion software included with your projector, simply place your file onto a USB drive and plug it into the projector's USB port. This allows you to display images stored as .jpgs from optional USB memory.



USB input

Your connection options go even further with the M Series. Connect your laptop or PC directly to the projector using the USB port and a standard USB cable.



	NP-M403H	NP-M323W / M363W	NP-M283X / M323X / M363X / M403X	NP-M333XS / NP-M353WS
Projection System	Single DLP® (0.65")	Single DLP® (0.65")	Single DLP® (0.55")	Single Chip DLP (0.55" / 0.65")
Resolution	1920 x 1080 (1080p Full HD)	1280 x 800 (WXGA)	1024 x 768 (XGA)	1024 x 768 (XGA) / 1280 x 800 (WXGA)
Lens	Manual zoom (x1.7) / manual focus, F=2.4 - 3.1, f=17.09 - 29.05mm, throw ratio 1.5 - 2.55	Manual zoom (x1.7) / manual focus, F=2.4 - 3.1, f=17.09 - 29.05mm, throw ratio 1.2 - 2.04	Manual zoom (x1.7) / manual focus, F=2.4 - 3.2, f=18.0 - 30.6mm, throw ratio 1.2 - 2.04	1.2 X Digital Zoom / manual focus F = 2.4, f = 6.5mm throw ratio 0.56 / 0.45
Light source (lamp)	ECO mode	162W	135W / 150W	162W
	ECO mode off	270W	225W / 250W	270W
Lamp life	ECO mode	8,000 H	8,000 H	8,000 H
	ECO mode off	3,500 H	3,500 H	3,500 H
Image size	30 to 300 inches	30 to 300 inches	30 to 300 inches	60 - 150 in., 1.5 - 3.1m
Light output	Normal	4,000 ANSI lumens	3,200 / 3,600 ANSI lumens	3300 / 3500 ANSI lumens
	ECO mode			
Contrast ratio (white/black)	Approximately 80% of normal 10,000:1			
Maximum resolution	Up to WUXGA (1920 x 1200)			
Synchronization range	Horizontal	15kHz to 100kHz (RGB: 24 kHz or over)		
	Vertical	50Hz to 120Hz (HDMI: 50 - 85Hz)		
Keystone correction	Horizontal	Manual: +/- 25 degrees		N/A
	Vertical	Auto / manual: +/- 30 degrees		
Input terminals	Computer	Mini D-sub 15 pin x 1		
	Audio	Stereo mini jack x 1		
	Video	RCA x 1		
	Audio	(L/R) RCA x 1		
	HDMI	HDMI x 2 (HDMI 1 supports MHL function)		
	Microphone	Stereo mini jack, dynamic mic, condenser mic		
	3D Sync	Mini 3-pin		
USB Port	Type A	USB 2.0 (USB viewer) powered		
	Type B	USB display / mouse control		
Output terminals		Mini D-sub 15 pin x 1		
	Audio	Stereo mini jack x 1 (NAO)		
Wired LAN port	RJ45 (10 BASE-T / 100 BASE-TX) x 1			
Control terminals	D-Sub 9-pin x 1			
Built-in speaker	20W monaural			
Usage environment	Operational temperature	41 to 104 degrees Fahrenheit, 20 to 80% humidity (no condensation)		
	Storage temperature	14 to 122 degrees Fahrenheit, 20 to 80% humidity (no condensation)		
Power requirements	100-240 VAC 50/60Hz			
Input current	3.9 A to 1.9 A	3.6 A to 1.4 A	3.9 A to 1.5 A	3.9A / 1.6A
Power consumption	ECO mode off	338W	283W / 316W	255W / 283W / 316W / 338W
	ECO mode	221W	186W/205W	170W/186W/205W/221W
	Standby (network)			0.5W or less
	Standby (normal)			0.15W or less
Net dimensions (W x H x D)	368 x 108 x 292mm (14.5" x 4.3" x 11.5")			368 x 134 x 291mm (14.5" x 5.3" x 11.5")
Weight	3.5kg / 7.7lbs			3.7kg/8.2lbs
Gross dimensions (W x D x H)	459 x 225 x 381mm (18.1" x 8.9" x 15.2")			
Gross weight	5.2kg / 11.5lbs			

UNIQUE FEATURES

BrilliantColor advanced video processing from Texas Instruments delivers more vibrant and realistic colors and blacks rich in detail.

DICOM Simulation enables users in medical training environments to display accurate diagnostic images

Advanced AccuBlend™ ensures detailed images when non-native resolution sources are connected to the projector

Filter Free with shielded engine eliminates the hassle and time spent monitoring and /or changing filters.

Built-in closed captioning enables decoding and display of text information from a video

64-step image magnification with location control

Countdown sleep timer can be set to automatically turn off the projector

WARRANTY

Registered owners receive a 2 year parts and labor warranty (M403H 3 year) including InstaCare. The lamp is covered for one year or 500 hours, whichever comes first. InstaCare provides the original owner one year of either limited 3 business day repair/return or next business day exchange. Extended warranties are available for purchase.

SHIPS WITH

Carrying case (excludes M333XS and M353WS), remote control, batteries, power cord, RGB signal cable, built-in lens cover, user's manual on CD-ROM, quick start guide, and product registration card

ORDERING MODEL NUMBERS

NP-M283X	NP-M323X	NP-M363X
NP-M403X	NP-M323W	NP-M363W
NP-M403H	NP-M333XS	NP-M353WS

Accessories

- NP01MR** IR receiver enables PJ remote to control PC and MAC functions
- NP05LM1** 802.11b/g/n wireless LAN adapter
- SPKR30** Amplified 30-watt speaker
- MP300CM** Ceiling mount
- NP01UCM** Universal ceiling mount for projectors weighing less than 40 pounds
- NP02GL** Active shutter 3D glasses (PC only)
- NP05WK1** Wall mount for M333XS and M353WS
- X105-RF-X2** XPAND RF 3D glasses
- AD025-RF-X1** XPAND RF 3D emitter
- SCP200** Adjustable suspended ceiling plate for use with ceiling mount
- NP27LP** Replaceable lamp for M283X
- NP28LP** Replacement lamp for M323X & M323W
- NP29LP** Replacement lamp for M363X & M363W
- NP30LP** Replacement lamp for M403H, M403X, M333XS and M353WS
- RMT-PJ36** Replacement remote control
- NP05WK1** Short throw projector wall mount
- NP03WI** Interactive module with two pens for M333XS and M353WS
- NP02PI** Interactive stylus pen

Additional accessories are available, including screens, carts, mount accessories and replacement cables. Visit www.necdisplay.com for details.



Advanced AccuBlend, ECO Mode and Virtual Remote are trademarks of NEC Display Solutions. HDMI, the HDMI logo and High-Definition Multimedia Interface are trademarks or registered trademarks of HDMI Licensing LLC. All other brand or product names are trademarks or registered trademarks of their respective holders. Product specifications subject to change.