

X10-Lite/X10-Lite-S

High Performance LED Light

Instruction Manual

PROSeries

Thank you for purchasing the X10-Lite / X10-Lite-S High Performance LED Light. We strongly recommend that you read this Instruction Manual on how to best use the X10-Lite / X10-Lite-S and keep this manual for future reference. If you have any additional questions, please contact the appropriate IDX office listed at the end of this manual.

Features

- Compact, Light Weight, High Performance LED Light
- Maximum 16W power consumption
- The light brightness is seamlessly adjustable from 100% – 0%
- The encapsulated LEDs have an extensive life of 50,000 hours

Specification

- Input Voltage : DC6.0V ~ DC17.0V
- Power consumption : 16W Max.
- Brightness : 1450 lux @1m
- Dimmer control : 100% ~ 0%
- Beam angle : 90° / 45°
- Color temperature : 4500K / 3200K
- Dimensions : 108(W) x 150(H) x 129(D) mm / 4.25(W) x 5.90(H) x 5.07(D) inches
- Weight : 470 g / 1.03 lb (approx.)

Compatibility (As of October 2013)

Model	Battery type
X10-Lite	IDX 7.4V Li-ion Battery : SSL-JVC50
X10-Lite-S	Sony Li-ion Battery : NP-F770 / F970

Parts Description

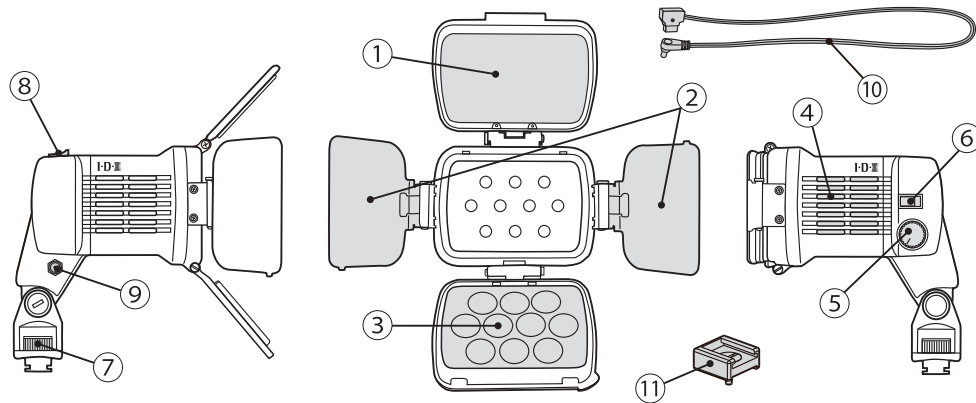

- | | | |
|-------------------|--------------------------|--------------------------------|
| ① Diffuser | ⑤ Dimmer Control Dial | ⑨ DC Input Connector (DC6~17V) |
| ② Barn Door | ⑥ Power Switch | ⑩ D-Tap DC Cable |
| ③ Condensing Lens | ⑦ Lock knob | ⑪ Shoe Adaptor |
| ④ Air Vent | ⑧ Battery Release Button | |

How to Attach and Remove Battery / Connect DC Input

How to Attach and Remove Battery

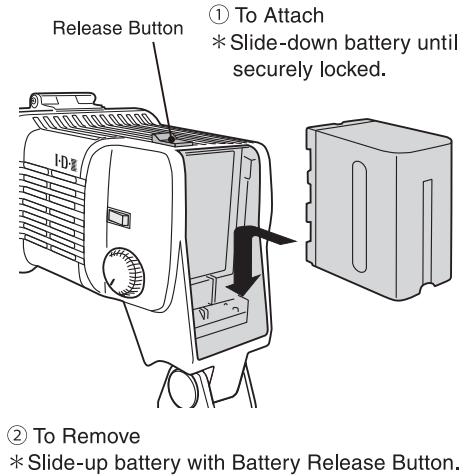

How to connect DC Input

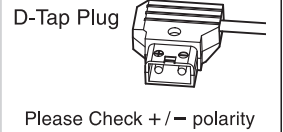
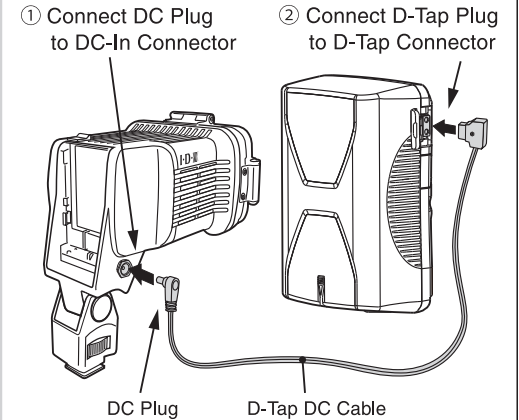

CAUTION This unit should be used under DC input condition DC6.0V-17.0V. It can cause a heat/smoke/fire.

Attachment to Camera

Attachment (to camera shoe)

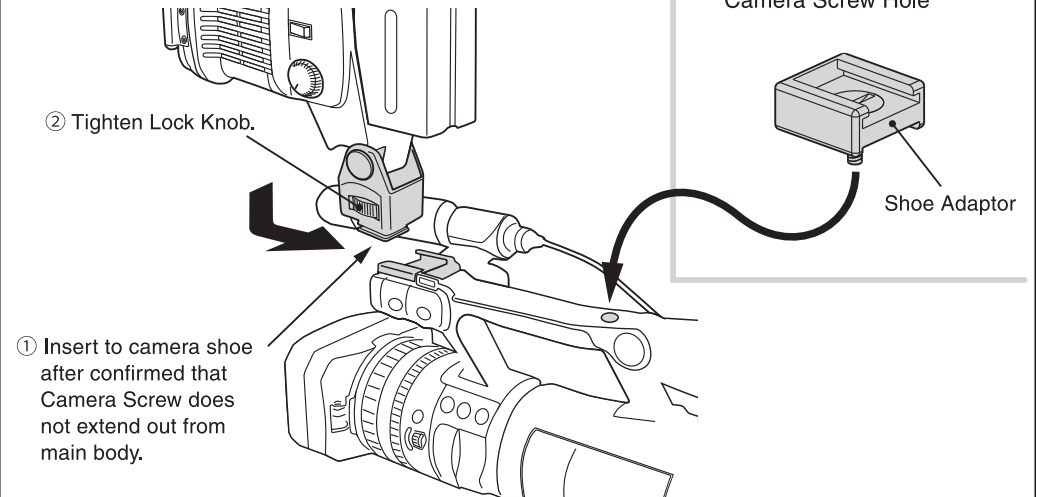

Attachment to 1/4 – 20(inch) Camera Screw Hole

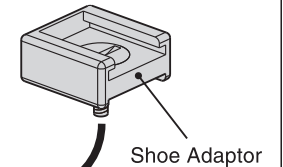

Design and specification are subject to change without notice.



IDX Company, Ltd. : 6-28-11 Shukugawara, Tamaku, Kawasaki-shi, Kanagawa-ken 214-0021 Japan
 Tel : +81-44-850-8801 Fax : +81-44-850-8838 E-mail : idx.japan@idx.tv
IDX System Technology, Inc. : 19001 Harborgate Way, Suite 105, Torrance, CA 90501 USA
 Tel : +1-310-328-2850 Fax : +1-310-328-8202 E-mail : idx.usa@idx.tv
IDX Technology Europe, Ltd. : Unit 9, Langley Park, Waterside Drive, Langley, Berkshire SL3 6AD England
 Tel : +44-1753-547692 Fax : +44-1753-546660 E-mail : idx.europe@idx.tv

