



**Industry Standards**

- NEMA Type 1
- UL 50—Type 1
- CUL Type 1 (Equivalent to CSA)

**Application**

- Designed for use as a junction box or pull box
- For indoor use to provide protection against contact with enclosed equipment where moisture and dust are not a problem

**Construction**

- Enclosure and cover are manufactured from 16, 14, or 12 gauge steel
- Available with or without knockouts. For no knockouts, refer to suffix **-NK** in catalog number
- Available with or without paint. For no paint, refer to suffix **-NP** in catalog number. Note: Unpainted enclosures are made from galvanized steel
- Covers have teardrop slots for easy installation and are attached to body with plated screws
- Grounding emboss provided with green plated grounding screw
- Holes are incorporated into the back of enclosure for mounting

**Finish**

- ANSI 61 gray polyester powder coating inside and out unless otherwise specified

**Accessories**

- Replacement Covers – see Covers, pg. 18-20
- Touch-up paint – see Accessories, pg. 37
- Wood Back Panels – see Panels, pg. 21-22
- Replacement Screws – see Accessories, pg. 37

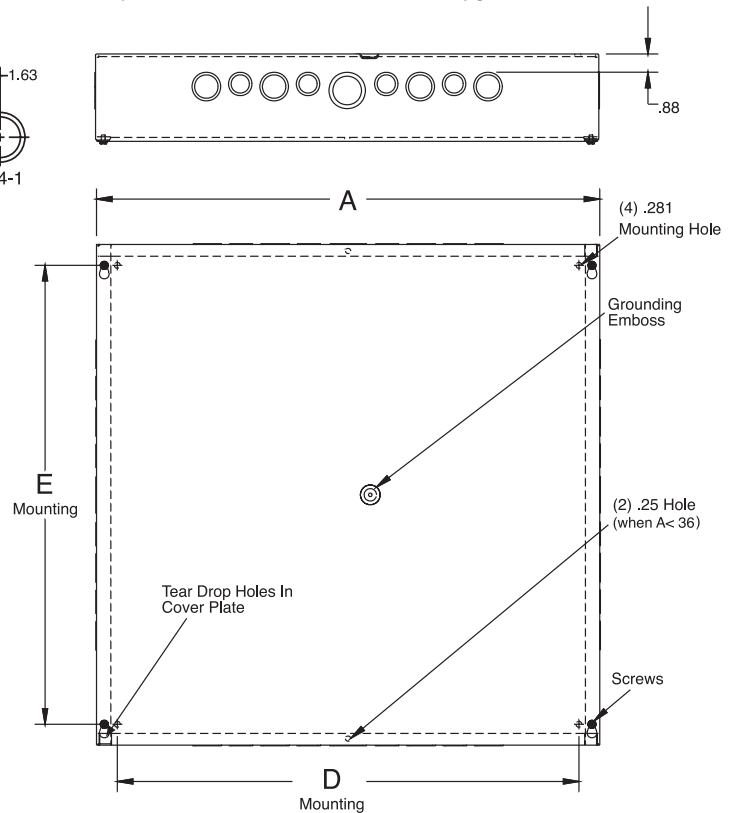
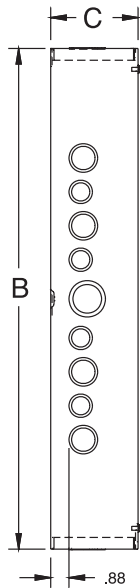
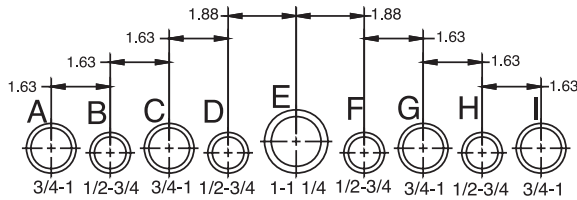

CATALOG NO.	PRODUCT FAMILY	UPC # (7-84572)	WEIGHT (LBS)	CTN QTY	W X H X D	KO A SIDE	KO B SIDE
444-SC1	SC1C	10650	2.2	6	4 x 4 x 4	B-C	NONE
444-SC1-NK	SC1C	10652	2.2	6	4 x 4 x 4	NONE	NONE
444-SC1-NK-NP	SC1C	15483	2.2	6	4 x 4 x 4	NONE	NONE
464-SC1	SC1C	10704	2.8	4	4 x 6 x 4	B-C	B-C-D
464-SC1-NK	SC1C	10705	4.5	4	4 x 6 x 4	NONE	NONE
464-SC1-NK-NP	SC1C	19632	2.8	4	4 x 6 x 4	NONE	NONE
464-SC1-NP	SC1C	31193	2.8	4	4 x 6 x 4	B-C	B-C-D
663-SC1	SC1C	10790	2.9	12	6 x 6 x 3	B-C-D	B-C-D
663-SC1-NK	SC1C	10791	2.9	12	6 x 6 x 3	NONE	NONE
663-SC1-NK-NP	SC1C	21830	2.9	12	6 x 6 x 3	NONE	NONE
664-SC1	SC1C	10801	3.4	9	6 x 6 x 4	B-C-D	NONE
664-SC1-NK	SC1C	10803	3.4	9	6 x 6 x 4	NONE	NONE
664-SC1-NK-NP	SC1C	10804	3.4	9	6 x 6 x 4	NONE	NONE
664-SC1-NP	SC1C	16191	3.4	9	6 x 6 x 4	B-C-D	NONE
666-SC1	SC1C	10818	4.5	6	6 x 6 x 6	B-C-D	NONE
666-SC1-NK	SC1C	10819	4.5	6	6 x 6 x 6	NONE	NONE



CATALOG NO.	PRODUCT FAMILY	UPC # (7-84572)	WEIGHT (LBS)	CTN QTY	W X H X D	KO A SIDE	KO B SIDE
666-SC1-NK-NP	SC1C	15355	4.5	6	6 x 6 x 6	NONE	NONE
666-SC1-NP	SC1C	30985	4.5	6	6 x 6 x 6	B-C-D	NONE
684-SC1	SC1C	10859	4	9	6 x 8 x 4	B-C-D	F-G-H-I
684-SC1-NK	SC1C	10860	4	9	6 x 8 x 4	NONE	NONE
684-SC1-NK-NP	SC1C	20886	4	9	6 x 8 x 4	NONE	NONE
684-SC1-NP	SC1C	18007	4	9	6 x 8 x 4	B-C-D	F-G-H-I
686-SC1	SC1C	10863	5.2	6	6 x 8 x 6	B-C-D	F-G-H-I
686-SC1-NK	SC1C	10864	5.2	6	6 x 8 x 6	NONE	NONE
686-SC1-NK-NP	SC1C	21059	5.2	6	6 x 8 x 6	NONE	NONE
686-SC1-NP	SC1C	30159	5.2	6	6 x 8 x 6	B-C-D	F-G-H-I
6124-SC1	SC1C	10764	5.5	6	6 x 12 x 4	B-C-D	C-D-E-F-G
6124-SC1-NK	SC1C	15543	5.5	6	6 x 12 x 4	NONE	NONE
6126-SC1	SC1C	10765	7	2	6 x 12 x 6	B-C-D	C-D-E-F-G
6126-SC1-NK	SC1C	17754	7	2	6 x 12 x 6	NONE	NONE
884-SC1	SC1C	10938	5	6	8 x 8 x 4	F-G-H-I	NONE
884-SC1-NK	SC1C	10940	5	6	8 x 8 x 4	NONE	NONE
884-SC1-NK-NP	SC1C	15357	5	6	8 x 8 x 4	NONE	NONE
886-SC1	SC1C	10955	6.5	4	8 x 8 x 6	F-G-H-I	NONE
886-SC1-NK	SC1C	10956	6.5	4	8 x 8 x 6	NONE	NONE
886-SC1-NK-NP	SC1C	15358	6.5	4	8 x 8 x 6	NONE	NONE
886-SC1-NP	SC1C	19650	6.5	4	8 x 8 x 6	F-G-H-I	NONE
888-SC1	SC1C	10971	7.5	2	8 x 8 x 8	F-G-H-I	NONE
888-SC1-NK	SC1C	10972	7.5	2	8 x 8 x 8	NONE	NONE
888-SC1-NK-NP	SC1C	15509	7.5	2	8 x 8 x 8	NONE	NONE
888-SC1-NP	SC1C	32326	7.5	2	8 x 8 x 8	F-G-H-I	NONE
8104-SC1	SC1C	10879	7	5	8 x 10 x 4	F-G-H-I	F-G-H-I
8104-SC1-NK	SC1C	10880	7	5	8 x 10 x 4	NONE	NONE
8104-SC1-NK-NP	SC1C	21057	7	5	8 x 10 x 4	NONE	NONE
8104-SC1-NP	SC1C	30485	7	5	8 x 10 x 4	F-G-H-I	F-G-H-I
8106-SC1	SC1C	10885	7.5	4	8 x 10 x 6	F-G-H-I	F-G-H-I
8106-SC1-NK	SC1C	10886	7.5	4	8 x 10 x 6	NONE	NONE
8106-SC1-NK-NP	SC1C	24737	7.5	4	8 x 10 x 6	NONE	NONE
8106-SC1-NP	SC1C	31005	7.5	4	8 x 10 x 6	F-G-H-I	F-G-H-I
8124-SC1	SC1C	10892	6.7	3	8 x 12 x 4	F-G-H-I	C-D-E-F-G
8124-SC1-NK	SC1C	10893	6.7	3	8 x 12 x 4	NONE	NONE
8124-SC1-NK-NP	SC1C	23645	6.7	3	8 x 12 x 4	NONE	NONE
8126-SC1	SC1C	10898	8.5	2	8 x 12 x 6	F-G-H-I	C-D-E-F-G
8126-SC1-NK	SC1C	10899	8.5	2	8 x 12 x 6	NONE	NONE
8126-SC1-NK-NP	SC1C	21060	8.5	2	8 x 12 x 6	NONE	NONE
10104-SC1	SC1C	10017	7	3	10 x 10 x 4	F-G-H-I	NONE
10104-SC1-NK	SC1C	10018	7	3	10 x 10 x 4	NONE	NONE
10104-SC1-NK-NP	SC1C	15344	7	3	10 x 10 x 4	NONE	NONE
10104-SC1-NP	SC1C	16190	7	3	10 x 10 x 4	F-G-H-I	NONE
10106-SC1	SC1C	10030	8.5	2	10 x 10 x 6	C-D-E-F-G	NONE
10106-SC1-NK	SC1C	10031	8.5	2	10 x 10 x 6	NONE	NONE
10106-SC1-NK-NP	SC1C	15456	8.5	2	10 x 10 x 6	NONE	NONE
10106-SC1-NP	SC1C	20888	8.5	2	10 x 10 x 6	C-D-E-F-G	NONE
10124-SC1	SC1C	10065	8	3	10 x 12 x 4	C-D-E-F-G	C-D-E-F-G
10124-SC1-NK	SC1C	10066	8	3	10 x 12 x 4	NONE	NONE
10124-SC1-NK-NP	SC1C	15345	8	3	10 x 12 x 4	NONE	NONE
10124-SC1-NP	SC1C	31006	8	3	10 x 12 x 4	C-D-E-F-G	C-D-E-F-G
10126-SC1	SC1C	10071	9.5	2	10 x 12 x 6	C-D-E-F-G	C-D-E-F-G
10126-SC1-NK	SC1C	10072	9.5	2	10 x 12 x 6	NONE	NONE
10126-SC1-NP	SC1C	32327	9.5	2	10 x 12 x 6	C-D-E-F-G	C-D-E-F-G
12124-SC1	SC1C	10113	9.2	4	12 x 12 x 4	C-D-E-F-G	NONE
12124-SC1-NK	SC1C	10115	9.2	4	12 x 12 x 4	NONE	NONE
12124-SC1-NK-NP	SC1C	10116	9.2	4	12 x 12 x 4	NONE	NONE
12124-SC1-NP	SC1C	17591	9.2	4	12 x 12 x 4	C-D-E-F-G	NONE
12126-SC1	SC1C	10133	11	3	12 x 12 x 6	C-D-E-F-G	NONE
12126-SC1-NK	SC1C	10135	11	3	12 x 12 x 6	NONE	NONE
12126-SC1-NK-NP	SC1C	10136	11	3	12 x 12 x 6	NONE	NONE
12126-SC1-NP	SC1C	16189	11	3	12 x 12 x 6	C-D-E-F-G	NONE
12128-SC1	SC1C	10153	13	2	12 x 12 x 8	C-D-E-F-G	NONE
12128-SC1-NK	SC1C	10154	13	2	12 x 12 x 8	NONE	NONE
12128-SC1-NK-NP	SC1C	15469	13	2	12 x 12 x 8	NONE	NONE
12128-SC1-NP	SC1C	20537	13	2	12 x 12 x 8	C-D-E-F-G	NONE
121212-SC1-NK	SC1C	24378	15.4	1	12 x 12 x 12	NONE	NONE
12164-SC1	SC1C	10177	11.3	3	12 x 16 x 4	C-D-E-F-G	B-C-D-E-F-G-H
12164-SC1-NK	SC1C	10178	11.3	3	12 x 16 x 4	NONE	NONE
12164-SC1-NK-NP	SC1C	15346	11.3	3	12 x 16 x 4	NONE	NONE
12164-SC1-NP	SC1C	32328	11.3	3	12 x 16 x 4	C-D-E-F-G	B-C-D-E-F-G-H
12166-SC1	SC1C	10183	13.5	2	12 x 16 x 6	C-D-E-F-G	B-C-D-E-F-G-H
12166-SC1-NK	SC1C	10184	13.5	2	12 x 16 x 6	NONE	NONE
12166-SC1-NK-NP	SC1C	15347	13.5	2	12 x 16 x 6	NONE	NONE
12166-SC1-NP	SC1C	30984	13.5	2	12 x 16 x 6	C-D-E-F-G	B-C-D-E-F-G-H
12184-SC1	SC1C	10202	12.7	3	12 x 18 x 4	C-D-E-F-G	A-B-C-D-E-F-G-H-I

CATALOG NO.	PRODUCT FAMILY	UPC # (7-84572)	WEIGHT (LBS)	CTN QTY	W X H X D	KO A SIDE	KO B SIDE
12184-SC1-NK	SC1C	10203	12.7	3	12 x 18 x 4	NONE	NONE
12184-SC1-NK-NP	SC1C	21058	12.7	3	12 x 18 x 4	NONE	NONE
12186-SC1	SC1C	10209	14.5	2	12 x 18 x 6	C-D-E-F-G	A-B-C-D-E-F-G-H-I
12186-SC1-NK	SC1C	10210	14.5	2	12 x 18 x 6	NONE	NONE
12186-SC1-NK-NP	SC1C	16421	14.5	2	12 x 18 x 6	NONE	NONE
12188-SC1	SC1C	10216	17	1	12 x 18 x 8	C-D-E-F-G	A-B-C-D-E-F-G-H-I
12188-SC1-NK	SC1C	10217	17	1	12 x 18 x 8	NONE	NONE
12188-SC1-NK-NP	SC1C	31727	17	1	12 x 18 x 8	NONE	NONE
121810-SC1	SC1C	10198	19	1	12 x 18 x 10	C-D-E-F-G	A-B-C-D-E-F-G-H-I
12244-SC1	SC1C	10229	15.8	3	12 x 24 x 4	C-D-E-F-G	A-B-C-D-E-F-G-H-I
12244-SC1-NK	SC1C	15584	15.8	3	12 x 24 x 4	NONE	NONE
12246-SC1	SC1C	10232	18.8	2	12 x 24 x 6	C-D-E-F-G	A-B-C-D-E-F-G-H-I
12246-SC1-NK	SC1C	10233	18.8	2	12 x 24 x 6	NONE	NONE
12246-SC1-NK-NP	SC1C	23762	18.8	2	12 x 24 x 6	NONE	NONE
15186-SC1	SC1C	10265	17.5	2	15 x 18 x 6	B-C-D-E-F-G-H	A-B-C-D-E-F-G-H-I
15186-SC1-NK	SC1C	10266	17.5	2	15 x 18 x 6	NONE	NONE
15186-SC1-NK-NP	SC1C	28142	17.5	2	15 x 18 x 6	NONE	NONE
16164-SC1	SC1C	10283	14	3	16 x 16 x 4	B-C-D-E-F-G-H	NONE
16164-SC1-NK	SC1C	10284	14	3	16 x 16 x 4	NONE	NONE
16164-SC1-NK-NP	SC1C	25802	14	3	16 x 16 x 4	NONE	NONE
16166-SC1	SC1C	10285	16.5	2	16 x 16 x 6	B-C-D-E-F-G-H	NONE
16166-SC1-NK	SC1C	10286	16.5	2	16 x 16 x 6	NONE	NONE
16166-SC1-NK-NP	SC1C	15348	16.5	2	16 x 16 x 6	NONE	NONE
16166-SC1-NP	SC1C	30484	16.5	2	16 x 16 x 6	B-C-D-E-F-G-H	NONE
18184-SC1	SC1C	10300	17	3	18 x 18 x 4	A-B-C-D-E-F-G-H-I	NONE
18184-SC1-NK	SC1C	10301	17	3	18 x 18 x 4	NONE	NONE
18184-SC1-NK-NP	SC1C	10302	17	3	18 x 18 x 4	NONE	NONE
18184-SC1-NP	SC1C	20538	17	3	18 x 18 x 4	A-B-C-D-E-F-G-H-I	NONE
18186-SC1	SC1C	10309	20.5	2	18 x 18 x 6	A-B-C-D-E-F-G-H-I	NONE
18186-SC1-NK	SC1C	10310	20.5	2	18 x 18 x 6	NONE	NONE
18186-SC1-NK-NP	SC1C	10311	20.5	2	18 x 18 x 6	NONE	NONE
18186-SC1-NP	SC1C	15955	20.5	2	18 x 18 x 6	A-B-C-D-E-F-G-H-I	NONE
18188-SC1	SC1C	10319	24	1	18 x 18 x 8	A-B-C-D-E-F-G-H-I	NONE
18188-SC1-NK	SC1C	10320	24	1	18 x 18 x 8	NONE	NONE
18188-SC1-NK-NP	SC1C	15349	24	1	18 x 18 x 8	NONE	NONE
18188-SC1-NP	SC1C	20536	24	1	18 x 18 x 8	A-B-C-D-E-F-G-H-I	NONE
181810-SC1	SC1C	10294	25	1	18 x 18 x 10	A-B-C-D-E-F-G-H-I	NONE
181810-SC1-NK	SC1C	10295	25	1	18 x 18 x 10	NONE	NONE
181810-SC1-NK-NP	SC1C	21064	25	1	18 x 18 x 10	NONE	NONE
181812-SC1	SC1C	10298	28	1	18 x 18 x 12	A-B-C-D-E-F-G-H-I	NONE
181812-SC1-NK	SC1C	10299	28	1	18 x 18 x 12	NONE	NONE
181812-SC1-NK-NP	SC1C	24736	28	1	18 x 18 x 12	NONE	NONE
18244-SC1	SC1C	10333	23.5	2	18 x 24 x 4	A-B-C-D-E-F-G-H-I	A-B-C-D-E-F-G-H-I
18244-SC1-NK	SC1C	10334	23.5	2	18 x 24 x 4	NONE	NONE
18244-SC1-NK-NP	SC1C	32330	23.5	2	18 x 24 x 4	NONE	NONE
18246-SC1	SC1C	10338	27	1	18 x 24 x 6	A-B-C-D-E-F-G-H-I	A-B-C-D-E-F-G-H-I
18246-SC1-NK	SC1C	10339	27	1	18 x 24 x 6	NONE	NONE
18246-SC1-NK-NP	SC1C	15350	27	1	18 x 24 x 6	NONE	NONE
18246-SC1-NP	SC1C	32331	27	1	18 x 24 x 6	A-B-C-D-E-F-G-H-I	A-B-C-D-E-F-G-H-I
18248-SC1	SC1C	10346	30	1	18 x 24 x 8	A-B-C-D-E-F-G-H-I	A-B-C-D-E-F-G-H-I
18248-SC1-NK	SC1C	10347	30	1	18 x 24 x 8	NONE	NONE
18248-SC1-NK-NP	SC1C	21063	30	1	18 x 24 x 8	NONE	NONE
182410-SC1	SC1C	10330	34	1	18 x 24 x 10	A-B-C-D-E-F-G-H-I	A-B-C-D-E-F-G-H-I
182410-SC1-NK	SC1C	24593	34	1	18 x 24 x 10	NONE	NONE
182410-SC1-NK-NP	SC1C	32332	34	1	18 x 24 x 10	NONE	NONE
182412-SC1	SC1C	10332	36	1	18 x 24 x 12	A-B-C-D-E-F-G-H-I	A-B-C-D-E-F-G-H-I
182412-SC1-NK	SC1C	20294	36	1	18 x 24 x 12	NONE	NONE
182412-SC1-NK-NP	SC1C	24797	36	1	18 x 24 x 12	NONE	NONE
24244-SC1	SC1C	10417	30.5	2	24 x 24 x 4	A-B-C-D-E-F-G-H-I	NONE
24244-SC1-NK	SC1C	10418	30.5	2	24 x 24 x 4	NONE	NONE
24244-SC1-NK-NP	SC1C	15473	30.5	2	24 x 24 x 4	NONE	NONE
24244-SC1-NP	SC1C	32333	30.5	2	24 x 24 x 4	A-B-C-D-E-F-G-H-I	NONE
24246-SC1	SC1C	10423	33.5	1	24 x 24 x 6	A-B-C-D-E-F-G-H-I	NONE
24246-SC1-NK	SC1C	10424	33.5	1	24 x 24 x 6	NONE	NONE
24246-SC1-NK-NP	SC1C	15352	33.5	1	24 x 24 x 6	NONE	NONE
24246-SC1-NP	SC1C	20539	33.5	1	24 x 24 x 6	A-B-C-D-E-F-G-H-I	NONE
24248-SC1	SC1C	10434	38	1	24 x 24 x 8	A-B-C-D-E-F-G-H-I	NONE
24248-SC1-NK	SC1C	10435	38	1	24 x 24 x 8	NONE	NONE
24248-SC1-NK-NP	SC1C	10436	38	1	24 x 24 x 8	NONE	NONE
242410-SC1	SC1C	10408	41	1	24 x 24 x 10	A-B-C-D-E-F-G-H-I	NONE
242410-SC1-NK	SC1C	10409	41	1	24 x 24 x 10	NONE	NONE
242410-SC1-NK-NP	SC1C	20887	41	1	24 x 24 x 10	NONE	NONE
242412-SC1	SC1C	10413	44	1	24 x 24 x 12	A-B-C-D-E-F-G-H-I	NONE
242412-SC1-NK	SC1C	10414	44	1	24 x 24 x 12	NONE	NONE
242412-SC1-NK-NP	SC1C	20648	44	1	24 x 24 x 12	NONE	NONE
24308-SC1	SC1C	10460	45	1	24 x 30 x 8	A-B-C-D-E-F-G-H-I	A-B-C-D-E-F-G-H-I

SC1—SCREW COVER JUNCTION BOXES—TYPE 1



SC1—SCREW COVER JUNCTION BOXES & COVERS—TYPE 1

CATALOG NO.	PRODUCT FAMILY	UPC # (7-84572)	WEIGHT (LBS)	CTN QTY	W X H X D	KO A SIDE	KO B SIDE
24308-SC1-NK	SC1C	10461	45	1	24 x 30 x 8	NONE	NONE
24308-SC1-NK-NP	SC1C	32334	45	1	24 x 30 x 8	NONE	NONE
243010-SC1	SC1C	10447	50	1	24 x 30 x 10	A-B-C-D-E-F-G-H-I	A-B-C-D-E-F-G-H-I
243010-SC1-NK	SC1C	10448	50	1	24 x 30 x 10	NONE	NONE
243010-SC1-NK-NP	SC1C	21065	50	1	24 x 30 x 10	NONE	NONE
243012-SC1	SC1C	10450	54	1	24 x 30 x 12	A-B-C-D-E-F-G-H-I	A-B-C-D-E-F-G-H-I
243012-SC1-NK-NP	SC1C	21067	54	1	24 x 30 x 12	NONE	NONE
24366-SC1	SC1C	10479	54	1	24 x 36 x 6	A-B-C-D-E-F-G-H-I	A-B-C-D-E-F-G-H-I
24366-SC1-NK	SC1C	10480	54	1	24 x 36 x 6	NONE	NONE
24366-SC1-NK-NP	SC1C	32335	54	1	24 x 36 x 6	NONE	NONE
24366-SC1-NP	SC1C	32336	54	1	24 x 36 x 6	A-B-C-D-E-F-G-H-I	A-B-C-D-E-F-G-H-I
24368-SC1	SC1C	10485	59	1	24 x 36 x 8	A-B-C-D-E-F-G-H-I	A-B-C-D-E-F-G-H-I
24368-SC1-NK	SC1C	10486	59	1	24 x 36 x 8	NONE	NONE
24368-SC1-NK-NP	SC1C	10487	59	1	24 x 36 x 8	NONE	NONE
243610-SC1	SC1C	10470	77	1	24 x 36 x 10	A-B-C-D-E-F-G-H-I	A-B-C-D-E-F-G-H-I
243610-SC1-NK	SC1C	24105	77	1	24 x 36 x 10	NONE	NONE
243612-SC1	SC1C	10471	83	1	24 x 36 x 12	A-B-C-D-E-F-G-H-I	A-B-C-D-E-F-G-H-I
243612-SC1-NK	SC1C	19903	83	1	24 x 36 x 12	NONE	NONE
243612-SC1-NK-NP	SC1C	10472	83	1	24 x 36 x 12	NONE	NONE
30306-SC1-NK	SC1C	10521	66	1	30 x 30 x 6	NONE	NONE
30306-SC1-NK-NP	SC1C	15475	66	1	30 x 30 x 6	NONE	NONE
30308-SC1-NK	SC1C	10528	76	1	30 x 30 x 8	NONE	NONE
30308-SC1-NK-NP	SC1C	24913	76	1	30 x 30 x 8	NONE	NONE
303010-SC1-NK	SC1C	10508	81	1	30 x 30 x 10	NONE	NONE
303010-SC1-NK-NP	SC1C	21066	81	1	30 x 30 x 10	NONE	NONE
303012-SC1-NK	SC1C	10511	95	1	30 x 30 x 12	NONE	NONE
303012-SC1-NK-NP	SC1C	21068	95	1	30 x 30 x 12	NONE	NONE
30366-SC1-NK	SC1C	10543	87	1	30 x 36 x 6	NONE	NONE
30366-SC1-NK-NP	SC1C	32337	87	1	30 x 36 x 6	NONE	NONE
30368-SC1-NK	SC1C	23846	95	1	30 x 36 x 8	NONE	NONE
30368-SC1-NK-NP	SC1C	16466	95	1	30 x 36 x 8	NONE	NONE
303610-SC1-NK-NP	SC1C	32338	103	1	30 x 36 x 10	NONE	NONE
303612-SC1-NK	SC1C	17923	111	1	30 x 36 x 12	NONE	NONE
303612-SC1-NK-NP	SC1C	32339	111	1	30 x 36 x 12	NONE	NONE
36364-SC1-NK	SC1C	10591	105	1	36 x 36 x 4	NONE	NONE
36366-SC1-NK	SC1C	10596	115	1	36 x 36 x 6	NONE	NONE
36366-SC1-NK-NP	SC1C	15477	115	1	36 x 36 x 6	NONE	NONE
36368-SC1	SC1C	24886	124	1	36 x 36 x 8	NONE	NONE
36368-SC1-NK	SC1C	10601	124	1	36 x 36 x 8	NONE	NONE
36368-SC1-NK-NP	SC1C	15353	124	1	36 x 36 x 8	NONE	NONE
363610-SC1-NK	SC1C	10584	134	1	36 x 36 x 10	NONE	NONE
363610-SC1-NK-NP	SC1C	24032	134	1	36 x 36 x 10	NONE	NONE
363612-SC1-NK	SC1C	10586	144	1	36 x 36 x 12	NONE	NONE
363612-SC1-NK-NP	SC1C	17418	144	1	36 x 36 x 12	NONE	NONE
363618-SC1-NK	SC1C	10590	173	1	36 x 36 x 18	NONE	NONE
36486-SC1-NK	SC1C	10612	150	1	36 x 48 x 6	NONE	NONE
48486-SC1-NK	SC1C	10731	192	1	48 x 48 x 6	NONE	NONE
484812-SC1-NK	SC1C	10724	220	1	48 x 48 x 12	NONE	NONE

**COVERS**

44XSC1	CNAC	10694	0.3	1	4 x 4
46XSC1	CNAC	10719	0.4	1	4 x 6
66XSC1	CNAC	10857	0.8	1	6 x 6
68XSC1	CNAC	10867	1	1	6 x 8
612XSC1	CNAC	10767	1.5	1	6 x 12
88XSC1	CNAC	10999	1	1	8 x 8
810XSC1	CNAC	10890	1.2	1	8 x 10
812XSC1	CNAC	10908	1.4	1	8 x 12
1010XSC1	CNAC	10062	2	1	10 x 10
1012XSC1	CNAC	10081	2.2	1	10 x 12
1212XSC1	CNAC	10175	2.5	1	12 x 12
1216XSC1	CNAC	10197	2.9	1	12 x 16
1218XSC1	CNAC	10225	3.2	1	12 x 18
1224XSC1	CNAC	10244	4.3	1	12 x 24
1518XSC1	CNAC	10274	4	1	15 x 18
1616XSC1	CNAC	10288	3.8	1	16 x 16
1818XSC1	CNAC	10328	4.8	1	18 x 18
1824XSC1	CNAC	10354	6.4	1	18 x 24
1830XSC1	CNAC	10366	8	1	18 x 30
2424XSC1	CNAC	10446	10.9	1	24 x 24
2430XSC1	CNAC	10468	12.3	1	24 x 30
2436XSC1	CNAC	10492	16.4	1	24 x 36
3030XSC1	CNAC	10535	12.3	1	30 x 30
3036XSC1	CNAC	10553	19	1	30 x 36
3636XSC1	CNAC	10606	23	1	36 x 36
3648XSC1	CNAC	10621	26	1	36 x 48
4848XSC1	CNAC	10740	42	1	48 x 48



NK=no knockout, NP=no paint

# SCREW COVER ENCLOSURE

## NEMA TYPE-1 SCREW COVER PULL BOX

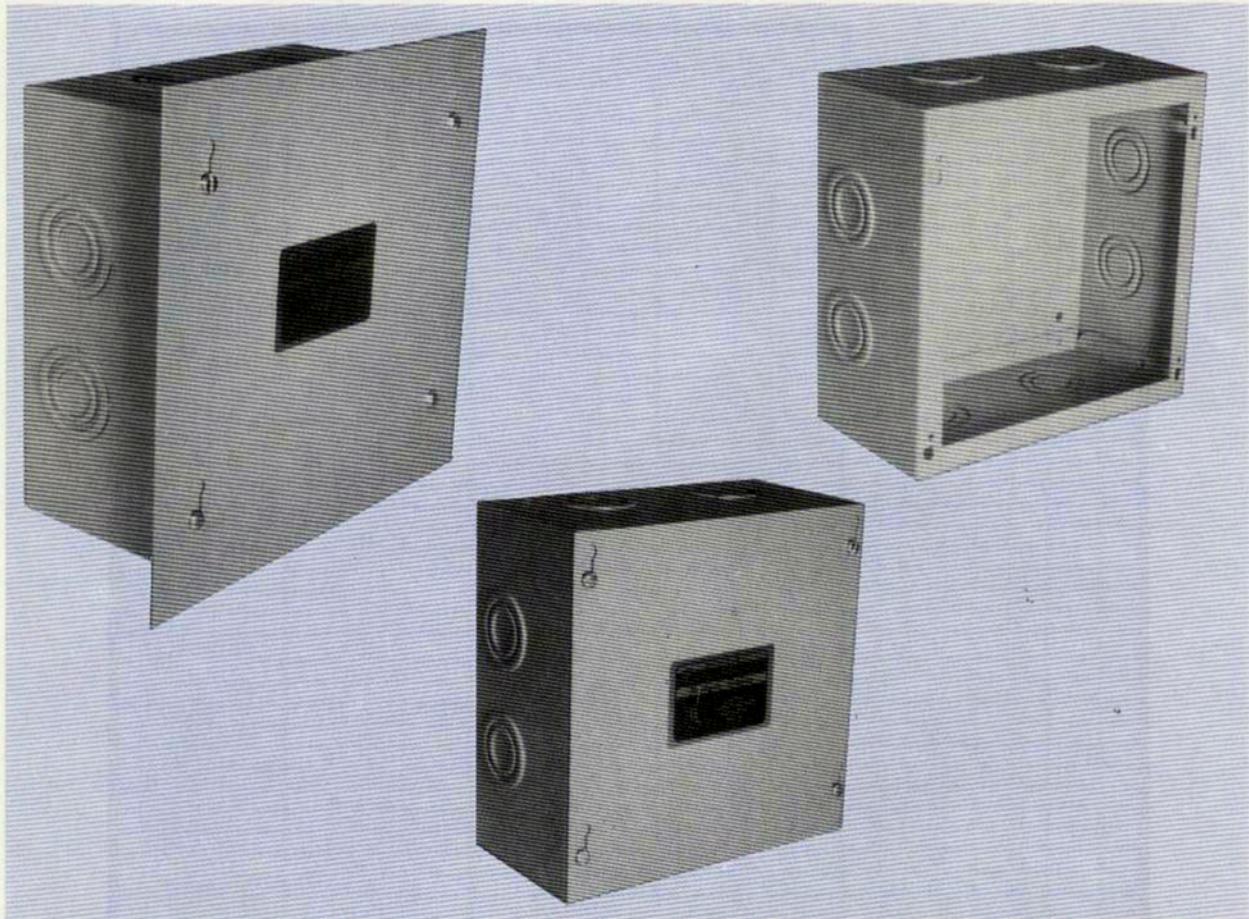

### APPLICATION

WIRE GUARD Nema Type-1 Screw Cover Enclosures are designed for use as junction and pull boxes. This box is intended for indoor use primarily to provide protection against contact with the enclosed equipment.

### CONSTRUCTION

Made from 16 gauge, 14 gauge and 12 gauge steel. Flat, removable covers are fastened with screws through keyhole slots which eliminate the necessity of entirely removing the screws when taking the cover off. Various sizes of easily removable concentric knockouts are furnished on all four sides of standard enclosures with knockouts. Enclosures are also readily available without knockouts. Holes are provided in the back of the box for mounting. Flush covers and screw cover enclosures must be ordered separately for flush installations.

### FINISH

Standard enclosures are available in either of two finishes.

- A. High-gloss gray baked enamel inside and out over phosphatized surfaces.
- B. Galvanized steel-no paint.

### MODIFICATIONS

WIRE GUARD can supply holes, cutouts, specially located knockouts, special sizes, finishes, materials, colors, fabricated promptly to your specifications. Please consult the factory for prices and availability.

### PACKAGING

Enclosures are shipped only in standard quantities as listed under pre-pack carton quantity. All enclosures not listing a pre-pack are available individually.

### INDUSTRY STANDARDS

These enclosures conform to the National Electrical Manufacturers Association (NEMA) standard for Type-1 (General purpose) enclosures. All enclosures are listed by Underwriters' Laboratories, Inc. (UL).

See following pages for Catalog Numbers and Knockout data →



WIRE GUARD SYSTEMS, INC.  
2050 EAST SLAUSON AVENUE  
HUNTINGTON PARK, CA . 90255

TELEPHONE: (213) 588-2166

FAX: (213) 588-5027



# SCREW COVER ENCLOSURE

SCREW COVER  
CATALOG NUMBERS

NEMA TYPE-1

STD. PACK	BOX SIZE W x H x D	WITH KNOCKOUTS		WITHOUT KNOCKOUTS	
		ENAMEL CATALOG #	GALVANIZED CATALOG #	ENAMEL CATALOG #	GALVANIZED CATALOG #
12	4 x 4 x 3	443F	443GE	443NKE	443NKGE
12	4 x 4 x 4	444F	444GE	444NKE	444NKGE
12	4 x 6 x 4	464F	464GE	464NKE	464NKGE
8	5 x 5 x 3	553F	553GE	553NKE	553NKGE
8	6 x 6 x 3	663F	663GE	663NKE	663NKGE
8	6 x 6 x 4	664F	664GE	664NKE	664NKGE
6	6 x 6 x 6	666F	666GE	666NKE	666NKGE
1	6 x 8 x 3	683F	683GE	683NKE	683NKGE
6	6 x 8 x 4	684F	684GE	684NKE	684NKGE
4	6 x 8 x 6	686F	686GE	686NKE	686NKGE
1	6 x 10 x 4	6104F	6104GE	6104NKE	6104NKGE
1	6 x 10 x 6	6106F	6106GE	6106NKE	6106NKGE
4	6 x 12 x 4	6124F	6124GE	6124NKE	6124NKGE
1	6 x 12 x 6	6126F	6126GE	6126NKE	6126NKGE
6	8 x 8 x 4	884F	884GE	884NKE	884NKGE
4	8 x 8 x 6	886F	886GE	886NKE	886NKGE
3	8 x 8 x 8	888F	888GE	888NKE	888NKGE
6	8 x 10 x 4	8104F	8104GE	8104NKE	8104NKGE
4	8 x 10 x 6	8106F	8106GE	8106NKE	8106NKGE
6	8 x 12 x 4	8124F	8124GE	8124NKE	8124NKGE
2	8 x 12 x 6	8126F	8126GE	8126NKE	8126NKGE
6	10 x 10 x 4	10104F	10104GE	10104NKE	10104NKGE
4	10 x 10 x 6	10106F	10106GE	10106NKE	10106NKGE
6	10 x 12 x 4	10124F	10124GE	10124NKE	10124NKGE
4	10 x 12 x 6	10126F	10126GE	10126NKE	10126NKGE
4	12 x 12 x 4	12124F	12124GE	12124NKE	12124NKGE
4	12 x 12 x 6	12126F	12126GE	12126NKE	12126NKGE
3	12 x 12 x 8	12128F	12128GE	12128NKE	12128NKGE
1	12 x 12 x 12	121212F	121212GE	121212NKE	121212NKGE
3	12 x 15 x 4	12154F	12154GE	12154NKE	12154NKGE
1	12 x 15 x 6	12156F	12156GE	12156NKE	12156NKGE
3	12 x 16 x 4	12164F	12164GE	12164NKE	12164NKGE
2	12 x 16 x 6	12166F	12166GE	12166NKE	12166NKGE
3	12 x 18 x 4	12184F	12184GE	12184NKE	12184NKGE
2	12 x 18 x 6	12186F	12186GE	12186NKE	12186NKGE
1	12 x 18 x 8	12188F	12188GE	12188NKE	12188NKGE
1	12 x 18 x 10	121810F	121810GE	121810NKE	121810NKGE
3	12 x 24 x 4	12244F	12244GE	12244NKE	12244NKGE
2	12 x 24 x 6	12246F	12246GE	12246NKE	12246NKGE
1	12 x 24 x 8	12248F	12248GE	12248NKE	12248NKGE
1	12 x 24 x 10	122410F	122410GE	122410NKE	122410NKGE
1	12 x 24 x 12	122412F	122412GE	122412NKE	122412NKGE
1	12 x 30 x 4	12304F	12304GE	12304NKE	12304NKGE
1	12 x 30 x 6	12306F	12306GE	12306NKE	12306NKGE
1	12 x 36 x 4	12364F	12364GE	12364NKE	12364NKGE
1	12 x 36 x 6	12366F	12366GE	12366NKE	12366NKGE
1	15 x 15 x 4	15154F	15154GE	15154NKE	15154NKGE
1	15 x 15 x 6	15156F	15156GE	15156NKE	15156NKGE
1	15 x 18 x 4	15184F	15184GE	15184NKE	15184NKGE
1	15 x 18 x 6	15186F	15186GE	15186NKE	15186NKGE
1	15 x 18 x 8	15188F	15188GE	15188NKE	15188NKGE
1	15 x 24 x 4	15244F	15244GE	15244NKE	15244NKGE
1	15 x 24 x 6	15246F	15246GE	15246NKE	15246NKGE
1	15 x 30 x 4	15304F	15304GE	15304NKE	15304NKGE
1	15 x 30 x 6	15306F	15306GE	15306NKE	15306NKGE

34

TELEPHONE: (213) 588-2166  
FAX: (213) 588-5027

WIRE GUARD SYSTEMS, INC.  
2050 EAST SLAUSON AVENUE  
HUNTINGTON PARK, CA. 90255



# SCREW COVER ENCLOSURE

NEMA TYPE-1

SCREW COVER  
CATALOG NUMBERS

STD. PACK	BOX SIZE W x H x D	WITH KNOCKOUTS		WITHOUT KNOCKOUTS	
		ENAMEL CATALOG #	GALVANIZED CATALOG #	ENAMEL CATALOG #	GALVANIZED CATALOG #
1	15 x 36 x 4	15364E	15364GE	15364NKE	15364NKGE
1	15 x 36 x 6	15366E	15366GE	15366NKE	15366NKGE
1	16 x 16 x 4	16164E	16164GE	16164NKE	16164NKGE
1	16 x 16 x 6	16166E	16166GE	16166NKE	16166NKGE
1	16 x 16 x 8	16168E	16168GE	16168NKE	16168NKGE
1	16 x 24 x 4	16244E	16244GE	16244NKE	16244NKGE
1	16 x 24 x 6	16246E	16246GE	16246NKE	16246NKGE
1	16 x 24 x 8	16248E	16248GE	16248NKE	16248NKGE
1	18 x 18 x 4	18184E	18184GE	18184NKE	18184NKGE
1	18 x 18 x 6	18186E	18186GE	18186NKE	18186NKGE
1	18 x 18 x 8	18188E	18188GE	18188NKE	18188NKGE
1	18 x 18 x 10	181810E	181810GE	181810NKE	181810NKGE
1	18 x 18 x 12	181812E	181812GE	181812NKE	181812NKGE
1	18 x 24 x 4	18244E	18244GE	18244NKE	18244NKGE
1	18 x 24 x 6	18246E	18246GE	18246NKE	18246NKGE
1	18 x 24 x 8	18248E	18248GE	18248NKE	18248NKGE
1	18 x 24 x 10	182410E	182410GE	182410NKE	182410NKGE
1	18 x 24 x 12	182412E	182412GE	182412NKE	182412NKGE
1	18 x 30 x 4	18304E	18304GE	18304NKE	18304NKGE
1	18 x 30 x 6	18306E	18306GE	18306NKE	18306NKGE
1	18 x 30 x 8	18308E	18308GE	18308NKE	18308NKGE
1	18 x 30 x 10	183010E	183010GE	183010NKE	183010NKGE
1	18 x 30 x 12	183012E	183012GE	183012NKE	183012NKGE
1	18 x 36 x 4	18364E	18364GE	18364NKE	18364NKGE
1	18 x 36 x 6	18366E	18366GE	18366NKE	18366NKGE
1	24 x 24 x 4	24244E	24244GE	24244NKE	24244NKGE
1	24 x 24 x 6	24246E	24246GE	24246NKE	24246NKGE
1	24 x 24 x 8	24248E	24248GE	24248NKE	24248NKGE
1	24 x 24 x 10	242410E	242410GE	242410NKE	242410NKGE
1	24 x 24 x 12	242412E	242412GE	242412NKE	242412NKGE
1	24 x 30 x 4	24304E	24304GE	24304NKE	24304NKGE
1	24 x 30 x 6	24306E	24306GE	24306NKE	24306NKGE
1	24 x 30 x 8	24308E	24308GE	24308NKE	24308NKGE
1	24 x 30 x 10	243010E	243010GE	243010NKE	243010NKGE
1	24 x 30 x 12	243012E	243012GE	243012NKE	243012NKGE
1	24 x 36 x 4	24364E	24364GE	24364NKE	24364NKGE
1	24 x 36 x 6	24366E	24366GE	24366NKE	24366NKGE
1	24 x 36 x 8	24368E	24368GE	24368NKE	24368NKGE
1	24 x 36 x 10	243610E	243610GE	243610NKE	243610NKGE
1	24 x 36 x 12	243612E	243612GE	243612NKE	243612NKGE
1	24 x 42 x 4	24424E	24424GE	24424NKE	24424NKGE
1	24 x 42 x 6	24426E	24426GE	24426NKE	24426NKGE
1	24 x 48 x 4	24484E	24484GE	24484NKE	24484NKGE
1	24 x 48 x 6	24486E	24486GE	24486NKE	24486NKGE
1	30 x 30 x 4	30304E	30304GE	30304NKE	30304NKGE
1	30 x 30 x 6	30306E	30306GE	30306NKE	30306NKGE
1	30 x 30 x 8	30308E	30308GE	30308NKE	30308NKGE
1	30 x 30 x 10	303010E	303010GE	303010NKE	303010NKGE
1	30 x 30 x 12	303012E	303012GE	303012NKE	303012NKGE
1	30 x 36 x 4	30364E	30364GE	30364NKE	30364NKGE
1	30 x 36 x 6	30366E	30366GE	30366NKE	30366NKGE
1	30 x 36 x 8	30368E	30368GE	30368NKE	30368NKGE
1	30 x 36 x 10	303610E	303610GE	303610NKE	303610NKGE
1	30 x 36 x 12	303612E	303612GE	303612NKE	303612NKGE



WIRE GUARD SYSTEMS, INC.  
2050 EAST SLAUSON AVENUE  
HUNTINGTON PARK, CA. 90255

TELEPHONE: (213) 588-2166

FAX: (213) 588-5027

35

# SCREW COVER ENCLOSURE

SCREW COVER  
CATALOG NUMBERS

NEMA TYPE-1

STD. PACK	BOX SIZE W x H x D	WITHOUT KNOCKOUTS	
		ENAMEL CATALOG #	GALVANIZED CATALOG #
1	30 x 42 x 4	30424NKF	30424NKGE
1	30 x 42 x 6	30426NKF	30426NKGE
1	30 x 42 x 8	30428NKF	30428NKGE
1	30 x 42 x 10	304210NKF	304210NKGE
1	30 x 42 x 12	304212NKF	304212NKGE
1	30 x 48 x 4	30484NKF	30484NKGE
1	30 x 48 x 6	30486NKF	30486NKGE
1	30 x 48 x 8	30488NKF	30488NKGE
1	30 x 48 x 10	304810NKF	304810NKGE
1	30 x 48 x 12	304812NKF	304812NKGE
1	30 x 60 x 4	30604NKF	30604NKGE
1	30 x 60 x 6	30606NKF	30606NKGE
1	30 x 60 x 8	30608NKF	30608NKGE
1	30 x 60 x 10	306010NKF	306010NKGE
1	30 x 60 x 12	306012NKF	306012NKGE
1	30 x 72 x 4	30724NKF	30724NKGE
1	30 x 72 x 6	30726NKF	30726NKGE
1	30 x 72 x 8	30728NKF	30728NKGE
1	30 x 72 x 10	307210NKF	307210NKGE
1	30 x 72 x 12	307212NKF	307212NKGE
1	36 x 36 x 4	36364NKF	36364NKGE
1	36 x 36 x 6	36366NKF	36366NKGE
1	36 x 36 x 8	36368NKF	36368NKGE
1	36 x 36 x 10	363610NKF	363610NKGE
1	36 x 36 x 12	363612NKF	363612NKGE
1	36 x 42 x 4	36424NKF	36424NKGE
1	36 x 42 x 6	36426NKF	36426NKGE
1	36 x 42 x 8	36428NKF	36428NKGE
1	36 x 42 x 10	364210NKF	364210NKGE
1	36 x 42 x 12	364212NKF	364212NKGE
1	36 x 48 x 4	36484NKF	36484NKGE
1	36 x 48 x 6	36486NKF	36486NKGE
1	36 x 48 x 8	36488NKF	36488NKGE
1	36 x 48 x 10	364810NKF	364810NKGE
1	36 x 48 x 12	364812NKF	364812NKGE
1	36 x 60 x 4	36604NKF	36604NKGE
1	36 x 60 x 6	36606NKF	36606NKGE
1	36 x 60 x 8	36608NKF	36608NKGE
1	36 x 60 x 10	366010NKF	366010NKGE
1	36 x 60 x 12	366012NKF	366012NKGE
1	36 x 72 x 4	36724NKF	36724NKGE
1	36 x 72 x 6	36726NKF	36726NKGE
1	36 x 72 x 8	36728NKF	36728NKGE
1	36 x 72 x 10	367210NKF	367210NKGE
1	36 x 72 x 12	367212NKF	367212NKGE
1	48 x 48 x 4	48484NKF	48484NKGE
1	48 x 48 x 6	48486NKF	48486NKGE
1	48 x 48 x 8	48488NKF	48488NKGE
1	48 x 48 x 10	484810NKF	484810NKGE
1	48 x 48 x 12	484812NKF	484812NKGE
1	48 x 60 x 4	48604NKF	48604NKGE
1	48 x 60 x 6	48606NKF	48606NKGE
1	48 x 60 x 8	48608NKF	48608NKGE
1	48 x 60 x 10	486010NKF	486010NKGE
1	48 x 60 x 12	486012NKF	486012NKGE
1	48 x 72 x 4	48724NKF	48724NKGE
1	48 x 72 x 6	48726NKF	48726NKGE
1	48 x 72 x 8	48728NKF	48728NKGE
1	48 x 72 x 10	487210NKF	487210NKGE
1	48 x 72 x 12	487212NKF	487212NKGE

36

TELEPHONE: (213) 588-2166

FAX: (213) 588-5027

WIRE GUARD SYSTEMS, INC.  
2050 EAST SLAUSON AVENUE  
HUNTINGTON PARK, CA. 90255





# SCREW COVER ENCLOSURE

NEMA TYPE-1

FLUSH COVERS  
CATALOG NUMBERS

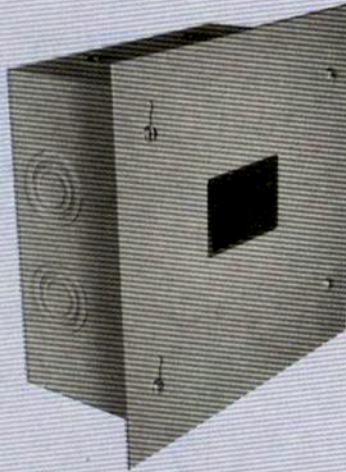

**WIRE GUARD Flush Covers** mount on screw cover pull boxes for flush installation. Flush Covers and pull boxes must be ordered separately. These covers have a high gloss gray baked enamel finish over phosphatized surfaces.

A pair of grip handles is welded on all covers to fit boxes with a height or width dimension exceeding 30".

\* GRIP HANDLES ON COVER

BOX SIZE W x H	ENAMEL CATALOG #	FLUSH COVER SIZE	BOX SIZE W x H	ENAMEL CATALOG #	FLUSH COVER SIZE
4 x 4	44FL-C	5.5 x 5.5	18 x 18	1818FL-C	19.5 x 19.5
4 x 6	46FL-C	5.5 x 7.5	18 x 24	1824FL-C	19.5 x 25.5
5 x 5	55FL-C	6.5 x 6.5	18 x 30	1830FL-C	19.5 x 31.5
6 x 6	66FL-C	7.5 x 7.5	18 x 36	1836FL-C	19.5 x 37.5
6 x 8	68FL-C	7.5 x 9.5	24 x 24	2424FL-C	25.5 x 25.5
6 x 10	610FL-C	7.5 x 11.5	24 x 30	2430FL-C	25.5 x 31.5
6 x 12	612FL-C	7.5 x 13.5	24 x 36	2436FL-C	25.5 x 37.5
8 x 8	88FL-C	9.5 x 9.5	24 x 42	2442FL-C	25.5 x 43.5
8 x 10	810FL-C	9.5 x 11.5	24 x 48	2448FL-C	25.5 x 49.5
8 x 12	812FL-C	9.5 x 13.5	30 x 30	3030FL-C	31.5 x 31.5
10 x 10	1010FL-C	11.5 x 11.5	30 x 36	3036FL-C	31.5 x 37.5
10 x 12	1012FL-C	11.5 x 13.5	30 x 42	3042FL-C	31.5 x 43.5
12 x 12	1212FL-C	13.5 x 13.5	30 x 48	3048FL-C	31.5 x 49.5
12 x 15	1215FL-C	13.5 x 16.5	30 x 60	3060FL-C	31.5 x 61.5
12 x 16	1216FL-C	13.5 x 17.5	30 x 72	3072FL-C	31.5 x 73.5
12 x 18	1218FL-C	13.5 x 19.5	36 x 36	3636FL-C	37.5 x 37.5
12 x 24	1224FL-C	13.5 x 25.5	36 x 42	3642FL-C	37.5 x 43.5
12 x 30	1230FL-C	13.5 x 31.5	36 x 48	3648FL-C	37.5 x 49.5
12 x 36	1236FL-C	13.5 x 37.5	36 x 60	3660FL-C	37.5 x 61.5
15 x 15	1515FL-C	16.5 x 16.5	36 x 72	3672FL-C	37.5 x 73.5
15 x 18	1518FL-C	16.5 x 19.5	48 x 48	4848FL-C	49.5 x 49.5
15 x 24	1524FL-C	16.5 x 25.5	48 x 60	4860FL-C	49.5 x 61.5
15 x 30	1530FL-C	16.5 x 31.5	48 x 72	4872FL-C	49.5 x 73.5
16 x 16	1616FL-C	17.5 x 17.5			
16 x 24	1624FL-C	17.5 x 25.5			



WIRE GUARD SYSTEMS, INC.  
2050 EAST SLAUSON AVENUE  
HUNTINGTON PARK, CA . 90255

TELEPHONE: (213) 588-2166

FAX: (213) 588-5027

37

# SCREW COVER ENCLOSURE

## NEMA TYPE-1 KNOCKOUT DETAIL

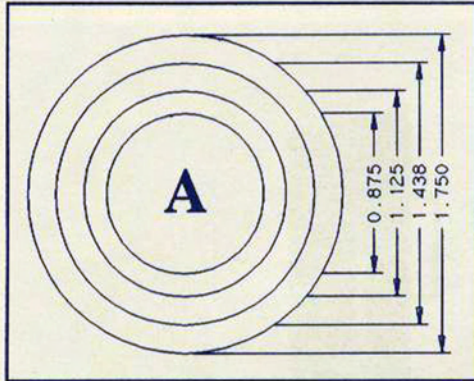

(4) 9/32 DIA. (ON 16 & 14 GA. BOXES)  
 (4) 7/16 DIA. (ON 12 GA. BOXES)

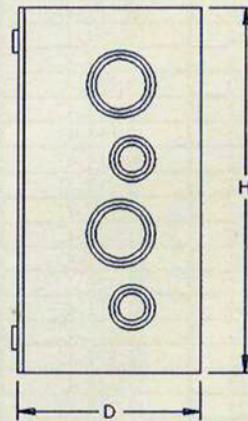
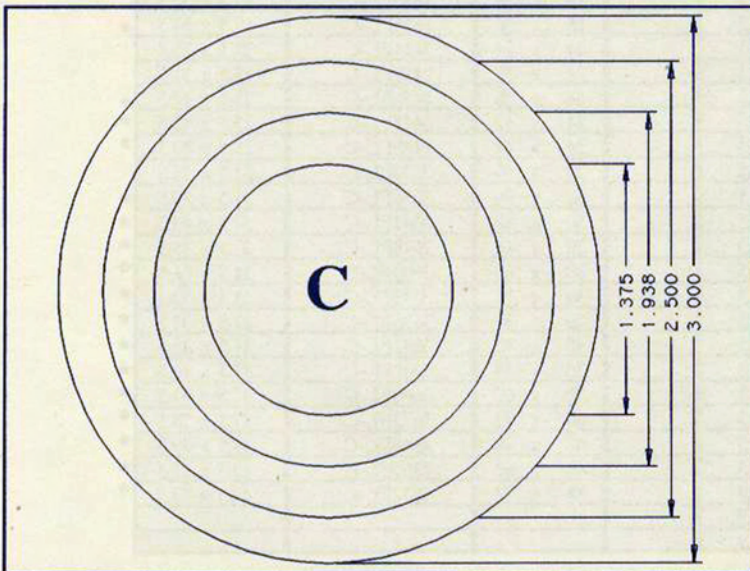
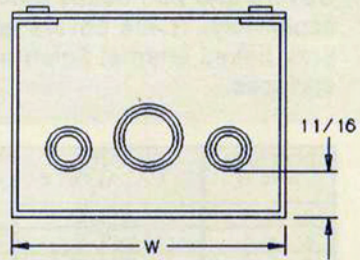
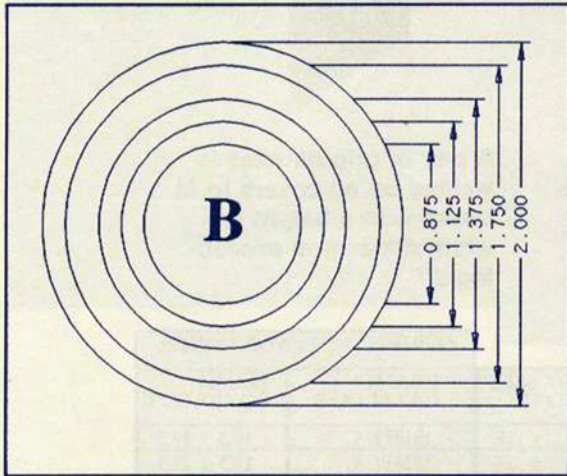
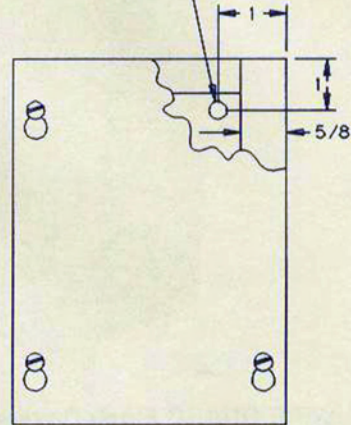

# SCREW COVER ENCLOSURE

## NEMA TYPE -1 KNOCKOUT PATTERN

KNOCKOUT PATTERN

W x H x D	"W" SIDE	"H" SIDE
4 x 4 x 3	A	A
4 x 4 x 4	A	A
4 x 6 x 4	A	A-A
5 x 5 x 3	A	A
6 x 6 x 3	A-A	A-A
6 x 6 x 4	A-A	A-A
6 x 6 x 6	C	A-A
6 x 8 x 3	A-A	A-A
6 x 8 x 4	A-A	A-A
6 x 8 x 6	C	C-A
6 x 10 x 4	A-A	A-A-A
6 x 10 x 6	C	C-A-C
6 x 12 x 4	A-A	A-A-A-A
6 x 12 x 6	C	C-A-C
8 x 8 x 4	A-A	A-A
8 x 8 x 6	C-A	C-A
8 x 8 x 8	C-A	C-A
8 x 10 x 4	A-A	A-A-A
8 x 10 x 6	C-A	A-C-A
8 x 12 x 4	A-A	A-A-A-A
8 x 12 x 6	C-A	C-A-C
10 x 10 x 4	B-B-B	B-B-B
10 x 10 x 6	A-C-A	A-C-A
10 x 12 x 4	A-A-A	A-A-A-A
10 x 12 x 6	A-C-A	C-A-C
12 x 12 x 4	A-A-A-A	A-A-A-A
12 x 12 x 6	C-A-C	C-A-C
12 x 12 x 8	C-A-C	C-A-C
12 x 12 x 12	C-A-C	C-A-C
12 x 15 x 4	A-A-A-A	A-A-A-A-A
12 x 15 x 6	C-A-C	A-A-A-A-A
12 x 16 x 4	A-A-A-A	A-A-A-A-A
12 x 16 x 6	C-A-C	C-A-A-C
12 x 18 x 4	A-A-A-A	6-A'S
12 x 18 x 6	C-A-C	C-A-A-A-C
12 x 18 x 8	C-A-C	C-A-A-A-C
12 x 18 x 10	C-A-C	C-A-A-A-C
12 x 24 x 4	A-A-A-A	8-A'S
12 x 24 x 6	C-A-C	C-5A'S-C
12 x 24 x 8	C-A-C	C-5A'S-C
12 x 24 x 10	C-A-C	C-5A'S-C
12 x 24 x 12	C-A-C	C-5A'S-C
12 x 30 x 4	A-A-A-A	9-A'S
12 x 30 x 6	C-A-C	C-7A'S-C
12 x 36 x 4	A-A-A-A	12-A'S
12 x 36 x 6	C-A-C	C-9A'S-C
15 x 15 x 4	A-A-A-A	A-A-A-A
15 x 15 x 6	C-A-A-C	C-A-A-C
15 x 18 x 4	A-A-A-A	6-A'S
15 x 18 x 6	C-A-A-C	C-A-A-A-C
15 x 18 x 8	C-A-A-C	C-A-A-A-C
15 x 24 x 4	A-A-A-A	8-A'S
15 x 24 x 6	C-A-A-C	C-5A'S-C
15 x 30 x 4	A-A-A-A	9-A'S
15 x 30 x 6	C-A-A-C	C-7A'S-C

KNOCKOUT PATTERN

W X H X D	"W" SIDE	"H" SIDE
15 x36 x 4	A-A-A-A	12-A'S
15 x36 x 6	C-A-A-C	C-9A'S-C
16 x16 x 4	A-A-A-A-A	A-A-A-A-A
16 x16 x 6	C-A-A-C	C-A-A-C
16 x16 x 8	C-A-A-C	C-A-A-C
16 x24 x 6	C-A-A-C	C-5A'S-C
16 x24 x 8	C-A-A-C	C-5A'S-C
18 x18 x 4	6A'S	6A'S
18 x18 x 6	C-A-A-A-C	C-A-A-A-C
18 x18 x 8	C-A-A-A-C	C-A-A-A-C
18 x18 x10	C-A-A-A-C	C-A-A-A-C
18 x18 x12	C-A-A-A-C	C-A-A-A-C
18 x24 x 4	6A'S	8A'S
18 x24 x 6	C-A-A-A-C	C-5A'S-C
18 x24 x 8	C-A-A-A-C	C-5A'S-C
18 x24 x10	C-A-A-A-C	C-5A'S-C
18 x24 x12	C-A-A-A-C	C-5A'S-C
18 x30 x 4	6A'S	9A'S
18 x30 x 6	C-A-A-A-C	C-7A'S-C
18 x30 x 8	C-A-A-A-C	C-7A'S-C
18 x30 x10	C-A-A-A-C	C-7A'S-C
18 x30 x12	C-A-A-A-C	C-7A'S-C
18 x36 x 4	6A'S	12A'S
18 x36 x 6	C-A-A-A-C	C-9A'S-C
24 x24 x 4	8A'S	8A'S
24 x24 x 6	C-5A'S-C	C-5A'S-C
24 x24 x 8	C-5A'S-C	C-5A'S-C
24 x24 x10	C-5A'S-C	C-5A'S-C
24 x24 x12	C-5A'S-C	C-5A'S-C
24 x30 x 4	8A'S	9A'S
24 x30 x 6	C-5A'S-C	C-7A'S-C
24 x30 x 8	C-5A'S-C	C-7A'S-C
24 x30 x10	C-5A'S-C	C-7A'S-C
24 x30 x12	C-5A'S-C	C-7A'S-C
24 x36 x 4	8A'S	12A'S
24 x36 x 6	C-5A'S-C	C-9A'S-C
24 x36 x 8	C-5A'S-C	C-9A'S-C
24 x36 x10	C-5A'S-C	C-9A'S-C
24 x36 x12	C-5A'S-C	C-9A'S-C
24 x42 x 4	8A'S	12A'S
24 x42 x 6	C-5A'S-C	C-9A'S-C
24 x48 x 4	8A'S	12A'S
24 x48 x 6	C-5A'S-C	C-9A'S-C
30 x30 x 4	9A'S	9A'S
30 x30 x 6	C-7A'S-C	C-7A'S-C
30 x30 x 8	C-7A'S-C	C-7A'S-C
30 x30 x10	C-7A'S-C	C-7A'S-C
30 x30 x12	C-7A'S-C	C-7A'S-C
30 x36 x 4	9A'S	12A'S
30 x36 x 6	C-7A'S-C	C-9A'S-C
30 x36 x 8	C-7A'S-C	C-9A'S-C
30 x36 x10	C-7A'S-C	C-9A'S-C
30 x36 x12	C-7A'S-C	C-9A'S-C



WIRE GUARD SYSTEMS, INC.  
2050 EAST SLAUSON AVENUE  
HUNTINGTON PARK, CA . 90255

TELEPHONE: (213) 588-2166  
FAX: (213) 588-5027

39