

RAYZOR Q12 ZOOM™

user manual

©2014 ELATION PROFESSIONAL all rights reserved. Information, specifications, diagrams, images, and instructions herein are subject to change without notice. ELATION PROFESSIONAL logo and identifying product names and numbers herein are trademarks of ELATION PROFESSIONAL. Copyright protection claimed includes all forms and matters of copyrightable materials and information now allowed by statutory or judicial law or hereinafter granted. Product names used in this document may be trademarks or registered trademarks of their respective companies and are hereby acknowledged. All non-ELATION brands and product names are trademarks or registered trademarks of their respective companies.

ELATION PROFESSIONAL and all affiliated companies hereby disclaim any and all liabilities for property, equipment, building, and electrical damages, injuries to any persons, and direct or indirect economic loss associated with the use or reliance of any information contained within this document, and/or as a result of the improper, unsafe, insufficient and negligent assembly, installation, rigging, and operation of this product.

Elation Professional USA | 6122 S. Eastern Ave. | Los Angeles, CA. 90040
323-582-3322 | 323-832-9142 fax | www.elationlighting.com | info@elationlighting.com

Elation Professional B.V. | Junostraat 2 | 6468 EW Kerkrade, Netherlands
+31 45 546 85 66 | +31 45 546 85 96 fax | www.elationlighting.eu | info@elationlighting.eu

DOCUMENT VERSION



Please check www.elationlighting.com for the latest revision/update of this manual.

| Date | Document Version | Software Version | DMX Channel Modes | Notes |
|--------|------------------|------------------|-------------------|------------------|
| 7/2014 | 1 | ≥1.0 | 17/20/28 | Initial release. |

CONTENTS

| | |
|----------------------------------|----|
| General Information | 4 |
| Warranty | 6 |
| Safety Instructions | 7 |
| General Guidelines | 8 |
| Fixture Overview | 9 |
| Fixture Installation | 10 |
| Understanding DMX | 13 |
| Fixture Menu | 17 |
| DMX Channel Functions And Values | 27 |
| LED Groups | 30 |
| Error Codes | 31 |
| Cleaning and Maintenance | 32 |
| Technical Specifications | 33 |
| Optional Accessories | 36 |

GENERAL INFORMATION

INTRODUCTION

Congratulations, you have just purchased one of the most innovative and reliable lighting fixtures on the market today! The **RAYZOR Q12 ZOOM™** has been designed to perform reliably for years when the guidelines in this booklet are followed. Please read and understand the instructions in this manual carefully and thoroughly before attempting to operate this unit. These instructions contain important information regarding safety during use and maintenance.

UNPACKING

Thank you for purchasing the **RAYZOR Q12 ZOOM™** by Elation Professional®. Every **RAYZOR Q12 ZOOM™** has been thoroughly tested and has been shipped in perfect operating condition. Carefully check the shipping carton for damage that may have occurred during shipping. If the carton appears to be damaged, carefully inspect your unit for damage and be sure all accessories necessary to operate the unit have arrived intact. In the event damage has been found or parts are missing, please contact our customer support team for further instructions. Please do not return this unit to your dealer without first contacting customer support at the number listed below. Please do not discard the shipping carton in the trash. Please recycle whenever possible.

BOX CONTENTS

- (2) Omega Brackets
- (1) 5pin DMX Cable
- (1) powerCON Cable
- (1) Safety Cable
- Manual & Warranty Card



MANUAL UPDATES

Please check www.elationlighting.com for the latest updated version of this manual.

CUSTOMER SUPPORT

Elation Professional® provides a customer support line, to provide set up help and to answer any question should you encounter problems during your set up or initial operation. You may also visit us on the web at www.elationlighting.com for any comments or suggestions. For service related issue please contact Elation Professional®.

ELATION SERVICE USA - Monday - Friday 8:00am to 5:00pm PST

Voice: 323-582-3322

Fax: 323-832-9142

E-mail: support@elationlighting.com

ELATION SERVICE EUROPE - Monday - Friday 08:30 to 17:00 CET

Voice: +31 45 546 85 30

Fax: +31 45 546 85 96

E-mail: support@elationlighting.eu

WARRANTY REGISTRATION

The **RAYZOR Q12 ZOOM™** carries a two-year (730 days) limited warranty. Please fill out the enclosed warranty card to validate your purchase. All returned service items whether under warranty or not, must be freight pre-paid and accompany a return authorization (R.A.) number. The R.A. number must be clearly written on the outside of the return package. A brief description of the problem as well as the R.A. number must also be written down on a piece of paper and included in the shipping container. If the unit is under warranty, you must provide a copy of your proof of purchase invoice. Items returned without a R.A. number clearly marked on the outside of the package will be refused and returned at customer's expense. You may obtain a R.A. number by contacting customer support at 323-582-3322.



IMPORTANT NOTICE!

There are no user serviceable parts inside this unit. Do not attempt any repairs yourself; doing so will void your manufactures warranty. Damages resulting from modifications to this fixture and/or the disregard of safety and general user instructions found in this user manual void the manufactures warranty and are not subject to any warranty claims and/or repairs.

2 - YEAR LIMITED WARRANTY

A. Elation Professional® hereby warrants, to the original purchaser, Elation Professional® products to be free of manufacturing defects in material and workmanship for a period of two years, (730 days) from the date of purchase. This warranty shall be valid only if the product is purchased within the United States of America, including possessions and territories. It is the owner's responsibility to establish the date and place of purchase by acceptable evidence, at the time service is sought.

B. For warranty service, send the product only to the Elation Professional® factory. All shipping charges must be pre-paid. If the requested repairs or service (including parts replacement) are within the terms of this warranty, Elation Professional® will pay return shipping charges only to a designated point within the United States. If the entire instrument is sent, it must be shipped in its original package. No accessories should be shipped with the product. If any accessories are shipped with the product, Elation Professional® shall have no liability what so ever for loss of or damage to any such accessories, nor for the safe return thereof.

C. This warranty is void if the serial number has been altered or removed; if the product is modified in any manner which Elation Professional® concludes, after inspection, affects the reliability of the product; if the product has been repaired or serviced by anyone other than the Elation Professional® factory unless prior written authorization was issued to purchaser by Elation Professional®; if the product is damaged because not properly maintained as set forth in the instruction manual.

D. This is not a service contract, and this warranty does not include maintenance, cleaning or periodic check-up. During the period specified above, Elation Professional® will replace defective parts at its expense, and will absorb all expenses for warranty service and repair labor by reason of defects in material or workmanship. The sole responsibility of Elation Professional® under this warranty shall be limited to the repair of the product, or replacement thereof, including parts, at the sole discretion of Elation Professional®. All products covered by this warranty were manufactured after January 1, 1990, and bare identifying marks to that effect.

E. Elation Professional® reserves the right to make changes in design and/or improvements upon its products without any obligation to include these changes in any products theretofore manufactured.

F. No warranty, whether expressed or implied, is given or made with respect to any accessory supplied with products described above. Except to the extent prohibited by applicable law, all implied warranties made by Elation Professional® in connection with this product, including warranties of merchantability or fitness, are limited in duration to the warranty period set forth above. And no warranties, whether expressed or implied, including warranties of merchantability or fitness, shall apply to this product after said period has expired. The consumer's and or Dealer's sole remedy shall be such repair or replacement as is expressly provided above; and under no circumstances shall Elation Professional® be liable for any loss or damage, direct or consequential, arising out of the use of, or inability to use, this product.

G. This warranty is the only written warranty applicable to Elation Professional® Products and supersedes all prior warranties and written descriptions of warranty terms and conditions heretofore published.

SAFETY INSTRUCTIONS



The **RAYZOR Q12 ZOOM™** is an extremely sophisticated piece of electronic equipment. To guarantee a smooth operation, it is important to follow the guidelines in this manual. The manufacturer of this device will not accept responsibility for damages resulting from the misuse of this fixture due to the disregard of the information printed in this manual.



This device falls under **PROTECTION CLASS 1**. It's essential this device be grounded properly. Only qualified personnel should perform all electrical connections.



CAUTION!

Never touch the device during operation!
The housing may heat up



CAUTION!

Never look directly into the light source,
as sensitive persons may suffer an epileptic shock.



CAUTION!

Keep this device away from rain and moisture !



CAUTION!

Unplug mains lead before opening the housing.

- For proper operation, follow the **Installation** guidelines described in this manual. Only qualified and certified personnel should perform installation of this fixture and only the original rigging parts (brackets) included with this fixture should be used for installation. Any modifications will void the original manufactures warranty and increase the risk of damage and/or personal injury.
- Never look directly into the light source of this fixture to prevent risk of injury to your retina, which may induce blindness. Those suffering from **EPILEPSY** should avoid looking directly into the light source of this unit at all times.
- The fan and air inlets must remain clean and never blocked. Allow approx. 6" (15cm) between this fixture and other devices or a wall for proper cooling.
- Always disconnect from main power source before performing any type of service and/or cleaning procedure. Only handle the power cord by the plug end, never pull out the plug by tugging the wire portion of the cord.
- Do not operate this fixture if the power cord has become frayed, crimped and/or damaged. If the power cord is damaged, replace it immediately with a new one of similar power rating.

GENERAL GUIDELINES

- **NEVER OPEN THIS FIXTURE WHILE IN USE!**
- During the initial operation of this fixture, a light smoke or smell may emit from the interior of the fixture. This is a normal process and is caused by excess paint in the interior of the casing burning off from the heat associated with the lamp and will decrease gradually over time.
- This fixture is a professional lighting effect designed for **INDOOR / DRY LOCATIONS ONLY** on stage, in nightclubs, theatres, etc.
- Please make sure there are **NO FLAMMABLE MATERIALS** close to the fixture while operating, to prevent any fire hazard.
- **Minimum** distance of inflammable materials from the surface **1.6 feet (0.5m)**.
- The fixture must be installed in a location with adequate ventilation, at least 1.5 feet (.5m) from adjacent surfaces. Be sure no air ventilation slots are blocked.
- **DO NOT** attempt installation and/or operation without knowledge how to do so.
- **DO NOT** allow operation by persons who are not qualified to operate this type of fixture. Most damages are the result of operations by nonprofessionals.
- Consistent operational breaks may ensure the fixture will function properly for many years to come.
- **DO NOT** shake fixture, avoid brute force when installing and/or operating fixture.
- Always install the fixture with an appropriate safety cable. When installing the fixture in a suspended environment, always use mounting hardware that is no less than M10 x 25 mm, also be sure the hardware is insert in the pre-arranged screw holes in the bracket of the fixture.
- Use the original packaging and materials to transport the fixture in for service.
- **DO NOT TOUCH** the housing bare-hand during its operation. Turn OFF the power and allow approximately 15 minutes for the fixture to cool down before replacing or serving.

FIXTURE OVERVIEW

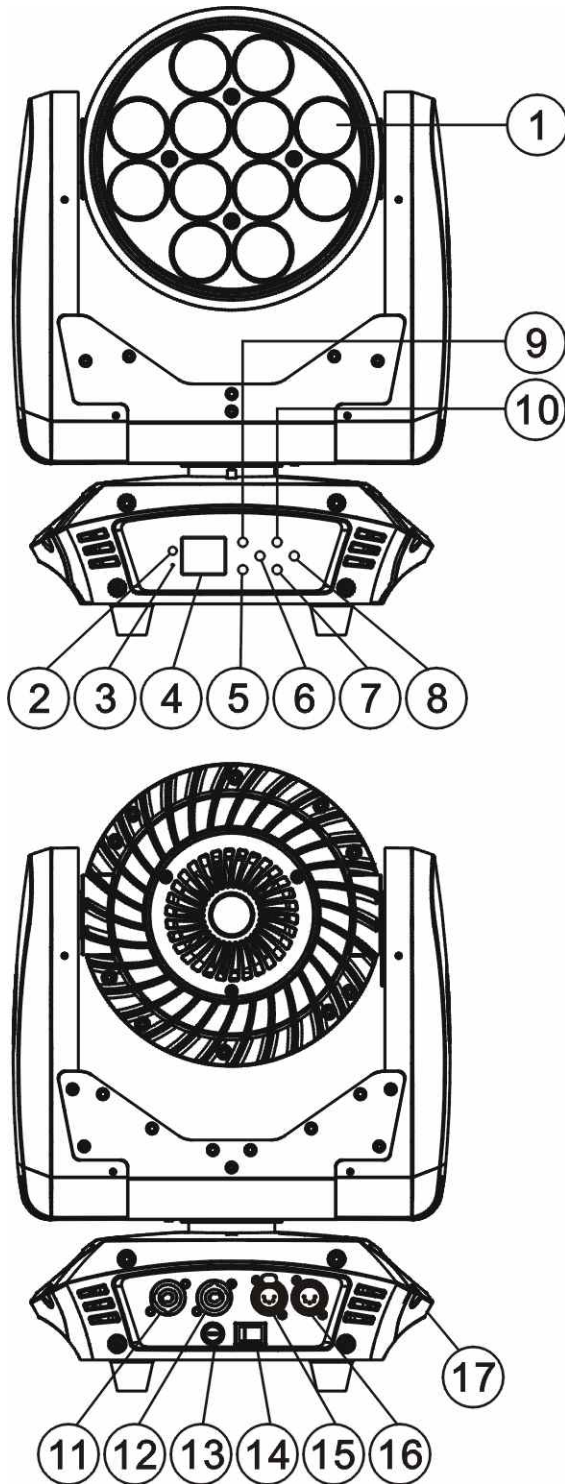

1. LED Array
2. DC Switch
3. Microphone
4. LCD Menu Function Display
5. ENTER Button
6. LEFT Button
7. DOWN Button
8. RIGHT Button
9. MODE/ESC Button
10. UP Button
11. powerCON IN
12. powerCON OUT
13. Fuse
14. Power Switch
15. 5pin DMX OUT
16. 5pin DMX IN
17. Carrying Handle(s)

FIXTURE INSTALLATION



CAUTION!

Please consider the GB7000.15/EN60598-2-17 and the other respective national norms during the installation. The installation must only be carried out by a qualified person.



CAUTION!

The electric connection must only be carried out by a qualified electrician.



CAUTIONS

- For added protection, mount the fixture in areas outside walking paths, seating areas, or in areas where unauthorized personnel might reach the fixture.
- Ambient operating temperature range for this fixture is **14° to 113°F. (-10° to 45°C)**
Do not use the fixture under or above this temperature.
- Before mounting the fixture to any surface, make sure the installation area can hold a minimum point load of 10 times the weight of the fixture. **(230 lbs / 104 kg)**
- Fixture installation must always be secured with a secondary safety attachment, such as an appropriate safety cable.
- Never stand directly below the device when mounting, removing or servicing.

MOUNTING POINTS

- Overhead mounting requires extensive experience, including amongst others calculating working load limits, installation material being used, and periodic safety inspection of all installation material and the device. If you lack these qualifications, do not attempt the installation yourself. Improper installation can result in bodily injury.
- Fixture is fully operational in the specific mounting positions as illustrated below.

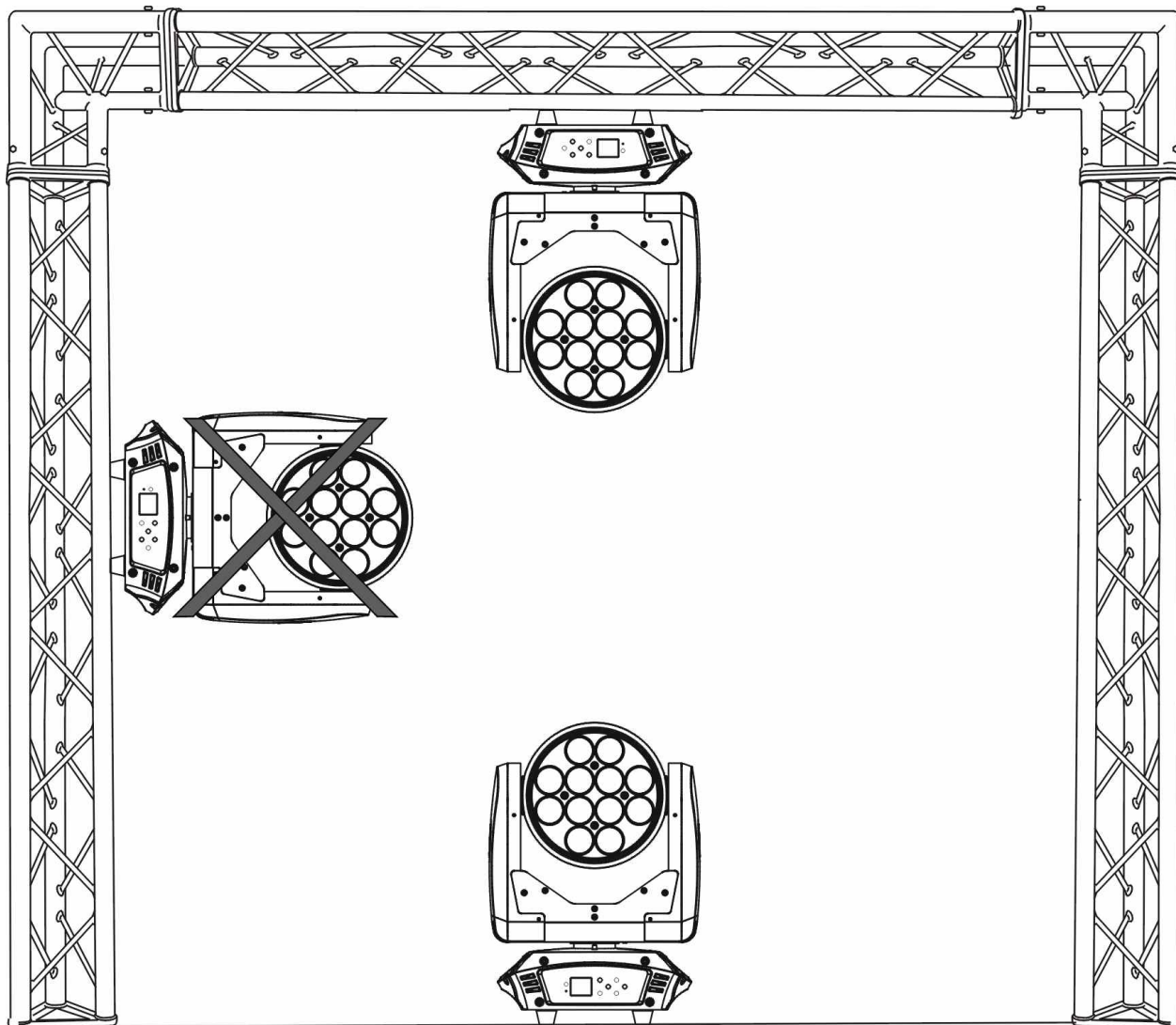

SAFETY CABLE

Always use a Safety Cable whenever installing this fixture in a suspended environment to ensure the fixture will not drop if the clamp fails.

CLAMP MOUNTING

The **RAYZOR Q12 ZOOM™** provides a unique mounting bracket assembly that integrates the bottom of the base, the included **Omega Brackets (x2)** and safety cable rigging point in one unit (see the illustration below). When mounting this fixture to truss be sure to secure an appropriately rated clamps to the included omega brackets using a M10 screw fitted through the center hole of the **Omega Bracket**. Be sure to attach the included **Safety Cable** to the fixture using the safety cable rigging point integrated in the base assembly.

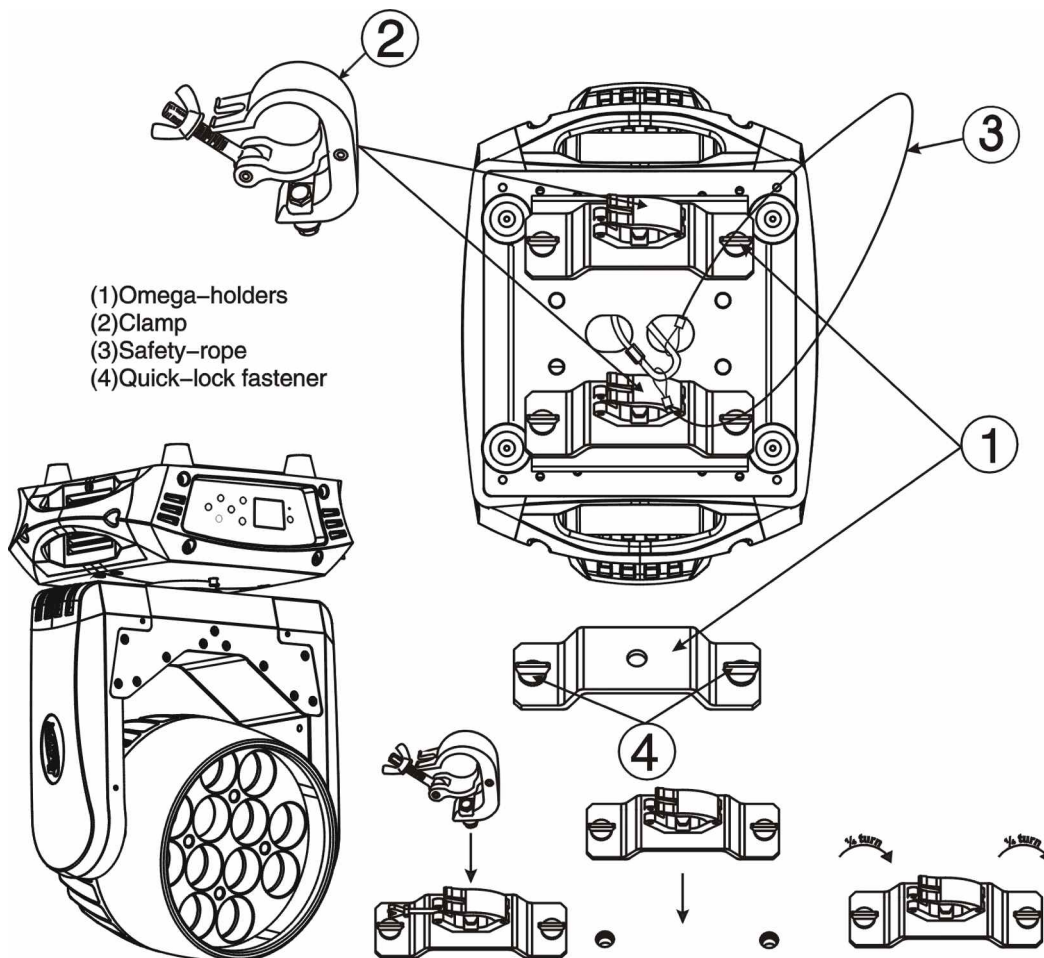

SECURING

Regardless of the rigging option you choose for your **RAYZOR Q12 ZOOM™** always be sure to secure your fixture with a safety cable. The fixture provides a built-in rigging point for a safety cable on the hanging bracket as illustrated above. Be sure to only use the designated rigging point for the safety cable and never secure a safety cable to a carrying handle.

UNDERSTANDING DMX

DMX-512

DMX is short for Digital Multiplex. This is a universal protocol used by most lighting and controller manufactures as a form of communication between intelligent fixtures and controllers. DMX allows all makes and models of different manufactures to be linked together and operate from a single controller. This is possible as long as all the fixtures and the controller are DMX compliant. A DMX controller sends the DMX data instructions to the fixture allowing the user to control the different aspects of an intelligent light. DMX data is sent out as serial data that travels from fixture to fixture via data "IN" and data "OUT" XLR terminals located on the fixtures (most controllers will only have output jacks).

DMX LINKING

To ensure proper DMX data transmission, always use proper DMX cables and a terminator. When using several DMX fixtures try to use the shortest cable path possible. Never split a DMX line with a "Y" style connector. The order in which the fixtures are connected in a DMX line does not influence the DMX addressing. For example; a fixture assigned a starting DMX address of 1 may be placed anywhere in the DMX chain, at the beginning, at the end, or anywhere in the middle. The DMX controller knows to send data assigned to address 1 to that fixture no matter where it is located in the DMX chain. The **RAYZOR Q12 ZOOM™** can be controlled via DMX-512 protocol and the DMX address is set via the control menu.

DATA CABLE (DMX Cable) REQUIREMENTS (For DMX and Master/Slave Operation)

Your fixture and your DMX controller require a standard 3pin or 5pin XLR connector for data input and data output (see figure below). If you are making your own cables, be sure to use two conductor, shielded digital DMX cable rated at 120 ohms; this cable is designed for DMX transmission and may be purchased from your Elation dealer or at most professional lighting retailers. Your cables should be made with a male and female XLR connector on either end of the cable. Also, remember that a DMX line must be daisy chained and cannot be split, unless using an approved DMX splitter such as **Elation's Opto Branch 4™, Opto Branch 8™, or DMX-Branch/4™**.

DMX Output
3-Pin XLR Socket



DMX Input
3-Pin XLR Socket



- 1: Ground
- 2: Data (-)
- 3: Data (+)

DMX Output
5-Pin XLR Socket



DMX Input
5-Pin XLR Socket

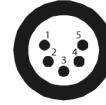

- 1: Ground
- 2: Data (-)
- 3: Data (+)
- 4: Open
- 5: Open



Be sure to follow the above figure when making your own cables. Do not use the ground lug on the XLR connector. Do not connect the cable's shield conductor to the ground lug or allow the shield conductor to come in contact with the XLR outer casing. Grounding the shield could cause a short circuit and erratic behavior.

DMX-512 CONTROLLER CONNECTION

Connect the provided XLR cable to the female XLR output of your controller and the other side to the male XLR input of the **RAYZOR Q12 ZOOM™**. The diagram below illustrates a typical DMX-512 connection when the fixture is in the **28 Channel Extended Mode**. You can chain multiple panels together through serial linking. The cable that should be used is two conductor, shielded DMX cable with XLR input and output connectors. Always be sure daisy chain your in and out data connections, never split or "Y" your DMX connections unless you are using an approved DMX splitter such as **Elation's Opto Branch 4™, Opto Branch 8™, or DMX-Branch/4™**.

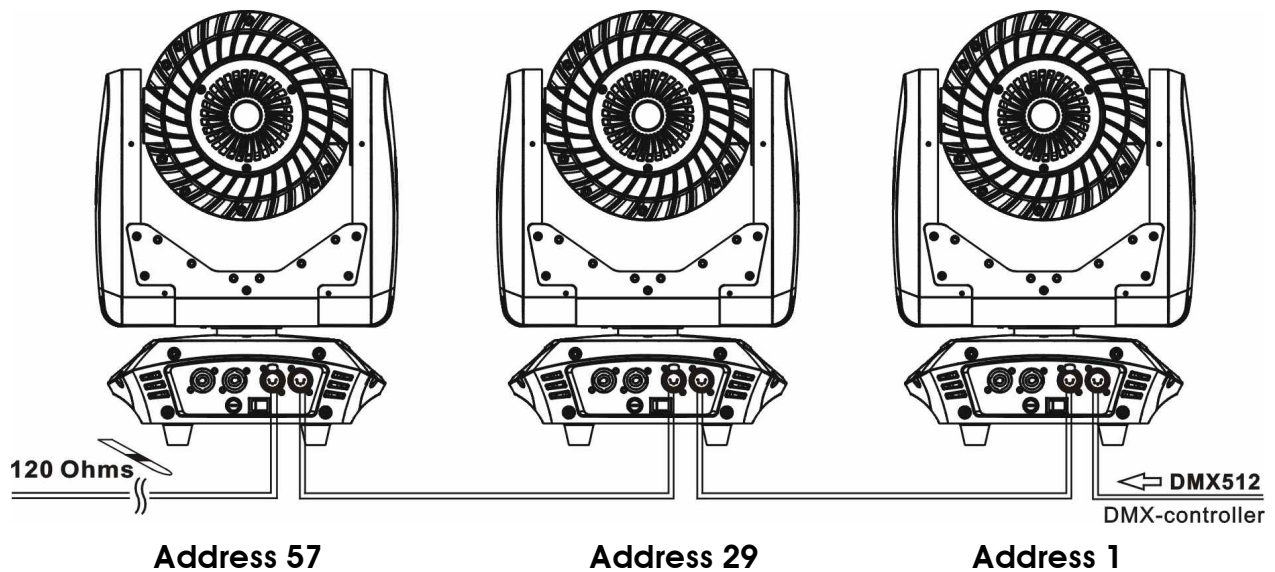

DMX-512 CONNECTION WITH DMX TERMINATOR

A DMX terminator should be used in all DMX lines especially in longer runs. The use of a terminator may avoid erratic behavior in your DMX line. A terminator is a 120 ohm 1/4 watt resistor that is connected between pins 2 and 3 of a male XLR connector (DATA + and DATA -). This fixture is inserted in the female XLR connector of the last fixture in your daisy chain to terminate the line. Using a line terminator will decrease the possibilities of erratic behavior.

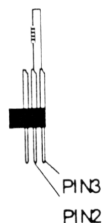
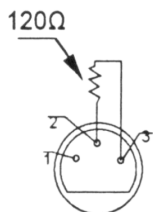

Termination reduces signal errors and avoids signal transmission problems and interference. It is always advisable to connect a DMX terminal, (Resistance 120 Ohm 1/4 W) between PIN 2 (DMX-) and PIN 3 (DMX +) of the last fixture.

5pin XLR DMX CONNECTORS

Some manufactures use 5pin XLR connectors for DATA transmission in place of 3pin. 5pin XLR fixtures may be implemented in a 3pin XLR DMX line. When inserting standard 5pin XLR connectors in to a 3pin line a cable adaptor must be used, these adaptors are readily available at most electric stores. The following chart details a proper cable conversion.

| 3-Pin XLR to 5-Pin XLR Conversion | | |
|-----------------------------------|------------------------|---------------------|
| Conductor | 3-Pin XLR Female (Out) | 5-Pin XLR Male (In) |
| Ground/Shield | Pin 1 | Pin 1 |
| Data Compliment (- signal) | Pin 2 | Pin 2 |
| Data True (+ signal) | Pin 3 | Pin 3 |
| Not Used | | Pin 4 - Do Not Use |
| Not Used | | Pin 5 - Do Not Use |

DMX ADDRESSING

All fixtures should be given a DMX starting address when using a DMX controller, so the correct fixture responds to the correct control signal. This digital starting address is the channel number from which the fixture starts to “listen” to the digital control information sent out from the DMX controller. The allocation of this starting DMX address is achieved by setting the correct DMX address on the digital display located on the back of the fixture.

You can set the same starting address for all fixtures or a group of fixtures, or set different address for each individual fixture. Be advised that setting all fixtures to the same DMX address will subsequently control all fixtures in the same fashion, in other words, changing the settings of one channel will affect all the fixtures simultaneously.

If you set each fixture to a different DMX address, each unit will start to “listen” to the channel number you have set, based on the quantity of control channels (DMX channels) of each fixture. That means changing the settings of one channel will only affect the selected fixture.

In the case of the **RAYZOR BEAM Q12 ZOOM™**, when in the **28 Channel Extended Mode** you should set the starting DMX address of the first unit to 1, the second unit to 29 (1 + 28), the third unit to 57 (29 + 28), and so on.

Note: During start-up the **RAYZOR Q12 ZOOM™** will automatically detect whether a DMX data signal is being received or not. If DMX data signal is being received, the display will show "**Addr=XXX**" (**XXX** representing the actual DMX address). If the fixture is not receiving a DMX signal the display will flash. If your fixture is connected to a DMX controller and the display is flashing (not receiving a DMX signal), please check the following:

- The 3pin or 5pin XLR input plug (cable with DMX signal from controller) is not connected or is not inserted completely into the DMX input jack of the fixture.
- The DMX controller is switched off or defective.
- The DMX cable or connector is defective.
- A DMX terminator has been inserted into the last fixture in your DMX chain.

FIXTURE MENU

ON-BOARD SYSTEM MENU

The **RAYZOR Q12 ZOOM™** comes with an easy to navigate system menu. The next section will detail the functions of each command in the system menu.

LCD MENU CONTROL PANEL

The control panel (see image below) located on back of the fixture allows you to access the main menu and make all necessary adjustments to the **RAYZOR Q12 ZOOM™**. During normal operation, pressing **MODE/ESC** button once will access the fixture's main menu. Once in the main menu you can navigate through the different functions and access the sub-menus with the **UP, DOWN, RIGHT, and LEFT** buttons. Once you reach a field that requires adjusting, press the **ENTER** button to activate that field and use the **UP** and **DOWN** buttons to adjust the field. Pressing the **ENTER** button once more will confirm your setting. You may exit the main menu at any time without making any adjustments by pressing the **MODE/ESC** button.



| ELATION© RAYZOR Q12 ZOOM™ SYSTEM MENU | | | | | |
|--|---|---|-----------------------------------|------------------------------------|-----------------------------|
| Specifications are subject to change without any prior written notice. | | | | | |
| MAIN MENU | SUB MENU | OPTIONS / VALUES (Default Settings in BOLD) | | DESCRIPTION | |
| FUNCTION | Set DMX Address | A001 ~ AXXX | | DMX Address Setting | |
| | DMX Value | ALL..... | | DMX Value Display | |
| | Slave Mode | Slave 1, Slave2, Slave3 | | Slave Setting | |
| | Auto Program | Master / Alone | | Auto Program | |
| | Sound Control | Master / Alone | | Sound Control | |
| INFORMATION | Time Information | Current Time | XXXX (Hours) | Fixture Run Time From Power ON | |
| | | Total Run Time | XXXX (Hours) | Fixture Total Run Time | |
| | | Last Run Time | XXXX (Hours) | Clear Fixture Last Run Time | |
| | | LastRun Password | Password=XXX | Timer Password 038 | |
| | | Clean Last Run | ON / OFF | Clear Fixture Last Run Time | |
| | Temperature Info | Head Temperature | XXX C° / F° | Temperature in Fixture Head | |
| Software Version | V1.0.1... | | Software Version | | |
| PERSONALITY | Status Settings | Address via DMX | ON/OFF | Address Via DMX | |
| | | No DMX Status | Close/ Hold /Auto | Auto Run If No DMX | |
| | | Pan Reverse | ON/OFF | Pan Reverse Movement | |
| | | Tilt Reverse | ON/OFF | Tilt Reverse Movement | |
| | | Pan Degree | 630/ 540 | Pan Degree Select | |
| | | Feedback | ON/OFF | Movement Feedback | |
| | | Movement Speed | Speed 1 ~ 4 | Movement Mode Select | |
| | | Mic Sensitivity | 0~99% | Sensitivity Of Mic | |
| | Hibernation | OFF, 01M~99M, 15M | Stand By Mode | | |
| | Service Setting | Password | Password=XXX | | Service Password 050 |
| | | RDM PID | XXXXXX | | RDM PID Code |
| | Fans Control | Auto , High, Low | | Fans Speed Setting | |
| | Display Setting | Shutoff Time | 02~60m 05m | Display Shut Off Time | |
| | | Display Reverse | ON/OFF | Display Reverse 180° | |
| | | Key Lock | ON/OFF | Key Lock | |
| | | Disp Flash | ON/OFF | Display Flash | |
| | Temperature C/F | Celsius/Fahrenheit | | Temperature Switch Between C° / F° | |
| Initial Status | PAN =XXX | | Initial Effect Position | | |
| Dimmer Modes | Standard, Stage, TV, Architectural, Theatre | | Dimmer Mode Settings | | |
| Reset Default | ON/OFF | | Restore Factory Settings | | |
| Reset Function | Reset All | | | Reset All Motors | |
| | Reset Pan/Tilt | | | Reset Pan/Tilt | |
| | Reset Zoom | | | Reset Zoom | |
| Effect Adjust | Test Channel | AUTO | | Test Functions | |
| | Manual Control | AUTO =XXX, | | Fine Adjustments | |
| | Calibrate Values | Calibrate Password | | Password 050 | |
| | | PAN, TILT, ZOOM | | Calibrate/Adjust Effects | |
| User Mode Set | User Mode | Stand Mode | | DMX Channel Modes | |
| | | Basic Mode | | | |
| | | Extend Mode | | | |
| | | User Mode A | | | |
| | Edit User Mode | User Mode B | | User Defined Channel Assignment | |
| User Mode C | | | | | |
| | Max Channel = XX | | Edits User Defined | | |
| | PAN = CH01 | | Channel Assignments | | |
| Edit Program | Select Programs | Auto Pro Part1 = Program 1~10 (Program 1) | | Select Programs To Be Run | |
| | | Auto Pro Part2 = Program 1~10 (Program 2) | | | |
| | | Auto Pro Part3 = Program 1~10 (Program 3) | | | |
| | Edit Program | Program 1 | Program Test | Testing Program | |
| | | : | Step 01=SCxxx | Program In Loop | |
| | Edit Scenes | Program 10 | Step 64=SCxxx | Save and Exit | |
| | | Scene 001 | Pan,Tilt,..... | Save and Automatically Return | |
| ~ | | --Fade Time-- | Manual Scenes Edit | | |
| Scene 250 | --Scene Time-- | | | | |
| Record Controller | XX~XX | Input By Outside | Stores Scenes via Ext DMX Console | | |
| | | | Automatic Scenes Recorder | | |

FUNCTION - Set DMX Address

Define desired DMX address via the Control Panel.

FUNCTION - DMX Value

Display DMX 512 value of each channel.

FUNCTION - Slave Mode

Define fixture slave mode (**Slave1, Slave2, Slave3**).

FUNCTION - Auto Program

Define fixture mode (**Master or Alone**) for running Auto Programs. Select desired internal programs under "**Select Program**", set the number of steps under "**Edit Program**", and edit individual scenes under "**Edit Scenes**".

FUNCTION - Sound Control

Define fixture mode (**Master or Alone**) for running Auto Programs via sound activation, default is **Master**.

INFORMATION - Time Information - Current Time

Displays fixture run time from last power ON.

The counter is reset after each time the fixture is powered OFF.

INFORMATION - Time Information - Total Run Time

Displays fixture total run time.

INFORMATION - Time Information - Last Run Time

Displays fixture run time for a given period of time (i.e. rental period).

This counter can be reset.

INFORMATION - Time Information - LastRun Password

Display the fixture timer password. (**038**)

INFORMATION - Time Information - Clear Last Run

Resets the last run time of the fixture.

INFORMATION - Temperature Information - Head Temperature

Displays temperature of the fixture.

INFORMATION - Software Version

Displays software version of the fixture.

PERSONALITY - Status Settings - Address Via DMX

When ON, define the desired DMX address via an external controller.

1. Connect the fixture to the external controller and power ON.
2. Set the DMX value of **Channel 1** on the controller to **(7)**.
3. Set the DMX value of **Channel 2** on the controller to **(7)** or **(8)**.
When set to **(7)**, the DMX address can be set between **(1)** and **(255)**.
When set to **(8)**, the DMX address can be set between **(256)** and **(511)**.
4. Using **Channel 3** on the controller set the desired DMX address of the fixture.

Example 1:

If the desired DMX address is **57**, set **Channel 1** to a value of **(7)**, set **Channel 2** to a value of **(7)**, and then set **Channel 3** to a value of **(57)**.

Example 2:

If the desired DMX address is **420**, set **Channel 1** to a value of **(7)**, set **Channel 2** to a value of **(8)**, and then set **Channel 3** to a value of **(164)**. ($256+164=420$)

5. After setting **Channel 3** to the desired DMX address value, wait for approximately 20 seconds for the fixture to complete the address reset function.

PERSONALITY - Status Settings - No DMX Status

Define how fixture operates if NO DMX signal is detected.

PERSONALITY - Status Settings - Pan Reverse

When ON, all PAN movements are reversed (inverted).

PERSONALITY - Status Settings - Tilt Reverse

When ON, all TILT movements are reversed (inverted).

PERSONALITY - Status Settings - Pan Degree

Select desired maximum degree of the Pan movement.

PERSONALITY - Status Settings - Feedback

When ON, the fixture automatically performs PAN / TILT correction in the event either one is disrupted during normal operation.

PERSONALITY - Status Settings - Movement Speed

Select desired Movement Speed.

PERSONALITY - Status Settings – Mic Sensitivity

Select desired Microphone Sensitivity.

PERSONALITY - Status Settings – Hibernation

Select desired Hibernation time.

PERSONALITY – Service Setting - Password

Displays the service setting password. **(050)**

PERSONALITY – Service Setting - RDM PID

RDM (Remote Device Management)

PERSONALITY – Fans Control

Select desired Fan setting.

PERSONALITY - Display Setting – Shutoff Time

Define how many minutes before the LCD Menu display will automatically shut OFF.

PERSONALITY - Display Setting – Display Reverse

When ON, the LCD Menu display by is rotated (inverted) 180°.

PERSONALITY - Display Setting – Key Lock

When ON, Control Panel buttons lock automatically after exiting main menu for 15 seconds. To unlock, keep **MODE/ESC** button pressed for 3 seconds.

PERSONALITY - Display Setting – Disp Flash

When ON, the LCD Menu display will flash consistently.

PERSONALITY – Temperature C/F

Define how fixture displays internal temperature (Celsius or Fahrenheit).

PERSONALITY – Initial Status

Create custom PAN/TILT and Effect settings and save as a custom Home Position.

PERSONALITY – Dimmer Modes

Select desired DIMMER MODE (Standard, Stage, TV, Architectural, Theatre).

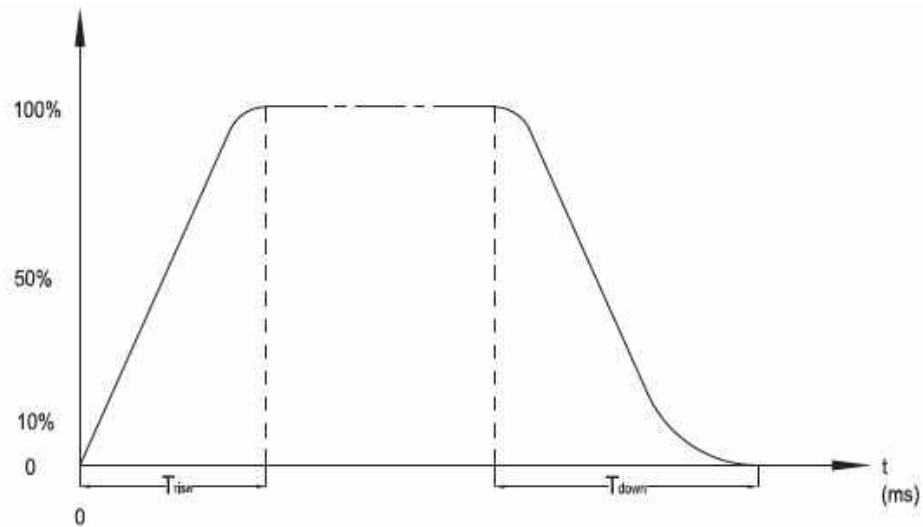

| Ramp Effect | OS (Fade Time) | | 1S (Fade Time) | |
|---------------|-----------------|-----------------|-----------------|-----------------|
| | T_{rise} (ms) | T_{down} (ms) | T_{rise} (ms) | T_{down} (ms) |
| Standard | 0 | 0 | 0 | 0 |
| Stage | 780 | 1100 | 1540 | 1660 |
| TV | 1180 | 1520 | 1860 | 1940 |
| Architectural | 1380 | 1730 | 2040 | 2120 |
| Theatre | 1580 | 1940 | 2230 | 2280 |

PERSONALITY – Reset Default

When ON, all factory settings are restored.

RESET FUNCTION - Reset ALL

Reset ALL internal motors to Home Position.

RESET FUNCTION - Reset PAN and TILT

Reset only PAN and TILT motors to Home Position.

RESET FUNCTION - Reset ZOOM

Reset only ZOOM motor to Home Position.

EFFECT ADJUST – Test Channel

Select and auto test each channel function independently from the DMX controller.

EFFECT ADJUST – Manual Control

Select and manually test and fine adjust each individual channel function independently from DMX control board. This function will center PAN and TILT motors and set dimmer to 100%. PAN and TILT functions will still operate if the fixture needs to be positioned to a flat clear surface. With the individual functions, you can focus the light on a flat surface (wall) and perform fine adjustments.

EFFECT ADJUST – Calibration



ONLY QUALIFIED TECHNICIANS SHOULD PERFORM THIS FUNCTION.

This function allows small adjustments to be made to compensate for wear or in the event a sensor has been knocked slightly out of place. Because improper use of this function can result in undesired operation this function has been password protected. The password is **050** and must be entered each time the calibration menu function is entered. Because calibration is an extremely delicate procedure, instructions on performing this action are left out of this manual. For a first time calibrator, please contact our customer support team for step-by-step instructions.

USER MODE SET – User Mode

Select operating mode, which includes DMX Channel and User defined modes.

USER MODE SET – Edit User Mode

Create user defined channel orders allowing the fixture to match the channel order of other fixtures on the market for easier operation. A total of three user modes may be configured: User Mode A, User Mode B, and User Mode C.

EDIT PROGRAM – Select Program

Select one of the (10) user defined internal Auto Programs.

EDIT PROGRAM – Edit Program

Edit any of the (10) user defined internal Auto Programs.

EDIT PROGRAM – Edit Scenes

Edit any of the scenes of the internal Auto Programs.

EDIT PROGRAM – Record Controller

The fixture features an integrated DMX-recorder by which you can transmit the programmed scenes from your DMX-controller to the moving head. Adjust the desired scene numbers via the encoder (from – to). When you call up the scenes at your controller, they will automatically be transmitted to the moving head.

EDIT PROGRAM – Record Controller – Working With Built In Programs

A Master unit can send up to 3 different data groups to the Slave units, i.e. a Master unit can start 3 different Slave units, which run 3 different programs. The Master unit sends the 3 program parts in a continuous loop.



The Slave unit receives data from the Master unit according to the group which the Slave unit was assigned to. If e.g. a Slave unit is set to “**Slave 1**” in the menu “**Set to Slave**”, the Master unit sends “**Auto Program Part 1**” to the Slave unit.

If set to “**Slave 2**”, the Slave unit receives “**Auto Program Part 2**”.

To start an Auto Program proceed as follows:

1. Slave Setting

- Select “**Function Mode**”.
- Press **ENTER** to confirm.
- Select “**Set to Slave**”.
- Press **ENTER** to confirm.
- Select “**Slave 1**”, “**Slave 2**” or “**Slave 3**”.
- Press **ENTER** to confirm.
- Press **MODE/ESC** in order to return to the main menu.

2. Automatic Program Run

- Select “**Function Mode**”.
- Press **ENTER** to confirm.
- Select “**Auto Program**”.
- Press **ENTER** to confirm.
- Select “**Master**” or “**Alone**”.
- Press **ENTER** to confirm.
- Press **MODE/ESC** in order to return to the main menu.

EDIT PROGRAM – Record Controller – Working With Built-In Program [continued]

3. Program Selection for Auto Pro Part

- Select “**Edit Program**”.
- Press **ENTER** to confirm.
- Select “**Select Programs**”.
- Press **ENTER** to confirm.
- Select “**Auto Pro Part 1**”, “**Auto Pro Part 2**” or “**Auto Pro Part 3**”, and select which Slave program is to be sent. Selection “**Part 1**” means, that the Slave unit runs the same program as the master units.
- Press **ENTER** to confirm.
- Press **MODE/ESC** in order to return to the main menu.

4. Program Selection for Edit Program

- Select “**Edit Program**”.
- Press **ENTER** to confirm.
- Select “**Edit Program**”.
- Press **ENTER** to confirm.
- Select the desired program to edit specific scenes of.
- Press **ENTER** to confirm.
- Press **MODE/ESC** in order to return to the main menu.

5. Automatic Scene Recording

- Select “**Edit Program**”.
- Press **ENTER** to confirm.
- Select “**Edit Scenes**”.
- Select desired scene numbers. A maximum of 250 scenes can be programmed.
- Press **ENTER** to confirm.
- Press **MODE/ESC** in order to return to the main menu.

EDIT PROGRAM – Record Controller – Working With Built-In Program [continued]

Example:

Program 2 includes scenes: 10, 11, 12, & 13

Program 4 includes scenes: 8, 9, & 10

Program 6 includes scenes: 12, 13, 14, & 15

Auto Pro Part 1 is Program 2

Auto Pro Part 2 is Program 3

Auto Pro Part 3 is Program 6

The 3 Slave groups run the Auto Program in certain time segments, as shown below:

Part 1:

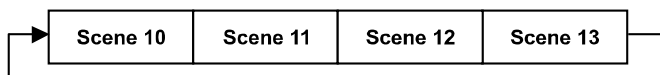

Part 2:

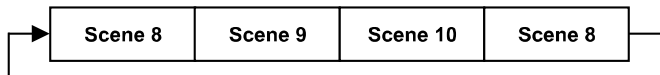

Part 3:

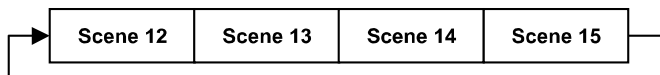

DMX CHANNEL FUNCTIONS AND VALUES

| ELATION® RAYZOR Q12 ZOOM™ | | | |
|---|-------|--------|----------|
| DMX Channel Values / Functions (28 DMX Channels) | | | |
| Specifications are subject to change without any prior written notice. | | | |
| *Position of LED GROUPS 2 and 3 depends on the orientation of the fixture head. | | | |
| MODE / CHANNEL | | | FUNCTION |
| BASIC | STAND | EXTEND | VALUE |
| 1 | 1 | 1 | |
| | | | 0-255 |
| | 2 | 2 | |
| | | | 0-255 |
| 2 | 3 | 3 | |
| | | | 0-255 |
| | 4 | 4 | |
| | | | 0-255 |
| 3 | 5 | | |
| | | | 0-255 |
| 4 | 6 | | |
| | | | 0-255 |
| 5 | 7 | | |
| | | | 0-255 |
| 6 | 8 | | |
| | | | 0-255 |
| 7 | 9 | 5 | |
| | | | 0-31 |
| | | | 32-63 |
| | | | 64-95 |
| | | | 96-127 |
| | | | 128-159 |
| | | | 160-191 |
| | | | 192-223 |
| 224-255 | | | |
| 8 | 10 | 6 | |
| | | | 0-255 |
| 9 | 11 | 7 | |
| | | | 0-31 |
| | | | 32-63 |
| | | | 64-95 |
| | | | 96-127 |
| | | | 128-159 |
| 160-255 | | | |
| 10 | 12 | 8 | |
| | | | 0-255 |
| | 13 | 9 | |
| | | | 0-255 |

| ELATION® RAYZOR Q12 ZOOM™ | | | | |
|--|---------------|--------|--------------------------|--------------------------|
| DMX Channel Values / Functions (28 DMX Channels) | | | | |
| Specifications are subject to change without any prior written notice. | | | | |
| MODE / CHANNEL | | | FUNCTION | |
| BASIC | STAND | EXTEND | VALUE | |
| 11 | 14 | 10 | COLOR MACROS | |
| | | | 0-7 | NO Function |
| | | | 8-39 | From RED to YELLOW |
| | | | 40-71 | From YELLOW to GREEN |
| | | | 72-103 | From GREEN to CYAN |
| | | | 104-135 | From CYAN to BLUE |
| | | | 136-167 | From BLUE to MAGENTA |
| | | | 168-199 | From MAGENTA to RED |
| | | | 200-231 | From RED to WHITE |
| | | | 232-255 | RANDOM From SLOW to FAST |
| 12 | 15 | 11 | COLOR PRESETS | |
| | | | 0-10 | NO Function |
| | | | 11-20 | WHITE 2,700K |
| | | | 21-30 | WHITE 3,200K |
| | | | 31-40 | WHITE 4,300K |
| | | | 41-50 | WHITE 5,600K |
| | | | 51-60 | WHITE 6,500K |
| | | | 61-70 | WHITE 8,000K |
| | | | 71-100 | BLUE / RED |
| | | | 101-130 | BLUE / GREEN |
| | | | 131-160 | GREEN / RED |
| | | | 161-190 | RED / BLUE |
| | | | 191-220 | GREEN / BLUE |
| 221-255 | RED / GREEN | | | |
| 13 | 16 | 12 | COLOR MODE | |
| | | | 0-189 | NO Function |
| | | | 190-254 | EDIT a New WHITE Balance |
| | | | 255 | SAVE a New WHITE Balance |
| 14 | 17 | 13 | CHASE MACROS | |
| | | | 0-10 | NO Function |
| | | | 11-40 | Chase Macro 1 |
| | | | 41-70 | Chase Macro 2 |
| | | | 71-100 | Chase Macro 3 |
| | | | 101-130 | Chase Macro 4 |
| | | | 131-160 | Chase Macro 5 |
| | | | 161-190 | Chase Macro 6 |
| | | | 191-220 | Chase Macro 7 |
| 221-255 | Chase Macro 8 | | | |
| 15 | 18 | 14 | CHASE MACRO SPEED | |
| | | | 0-225 | FAST to SLOW |

| ELATION® RAYZOR Q12 ZOOM™ | | | | |
|--|-------|--------|---------|---------------------------------------|
| DMX Channel Values / Functions (28 DMX Channels) | | | | |
| Specifications are subject to change without any prior written notice. | | | | |
| MODE / CHANNEL | | | VALUE | FUNCTION |
| BASIC | STAND | EXTEND | | |
| | | 15 | | RED LED - Group [1] |
| | | | 0-255 | Red (0-Black - 255-100%) |
| | | 16 | | GREEN LED - Group [1] |
| | | | 0-255 | Green (0-Black - 255-100%) |
| | | 17 | | BLUE LED - Group [1] |
| | | | 0-255 | Blue (0-Black - 255-100%) |
| | | 18 | | WHITE LED - Group [1] |
| | | | 0-255 | White (0-Black - 255-100%) |
| | | 19 | | RED LED - Group [2]* |
| | | | 0-255 | Red (0-Black - 255-100%) |
| | | 20 | | GREEN LED - Group [2]* |
| | | | 0-255 | Green (0-Black - 255-100%) |
| | | 21 | | BLUE LED - Group [2]* |
| | | | 0-255 | Blue (0-Black - 255-100%) |
| | | 22 | | WHITE LED - Group [2]* |
| | | | 0-255 | White (0-Black - 255-100%) |
| | | 23 | | RED LED - Group [3]* |
| | | | 0-255 | Red (0-Black - 255-100%) |
| | | 24 | | GREEN LED - Group [3]* |
| | | | 0-255 | Green (0-Black - 255-100%) |
| | | 25 | | BLUE LED - Group [3]* |
| | | | 0-255 | Blue (0-Black - 255-100%) |
| | | 26 | | WHITE LED - Group [3]* |
| | | | 0-255 | White (0-Black - 255-100%) |
| 16 | 19 | 27 | | PAN / TILT MOVEMENT SPEED |
| | | | 0-225 | PAN / TILT MAX to MIN Speed |
| | | | 226-235 | Blackout by Movement |
| | | | 236-255 | NO Function |
| 17 | 20 | 28 | | LAMP ON/OFF, RESET, INTERNAL PROGRAMS |
| | | | 0-79 | Normal |
| | | | 80-84 | ALL Motor Reset |
| | | | 85-87 | SCAN Motor Reset |
| | | | 88-90 | NO Function |
| | | | 91-93 | SAVE WHITE Balance Enabled |
| | | | 94-96 | NO Function |
| | | | 97-99 | ZOOM Motor Reset |
| | | | 100-119 | Internal Program 1 |
| | | | 120-139 | Internal Program 2 |
| | | | 140-159 | Internal Program 3 |
| | | | 160-179 | Internal Program 4 |
| | | | 180-199 | Internal Program 5 |
| | | | 200-219 | Internal Program 6 |
| | | | 220-239 | Internal Program 7 |
| | | | 240-255 | SOUND Control (Scene of Program 1) |

LED GROUPS

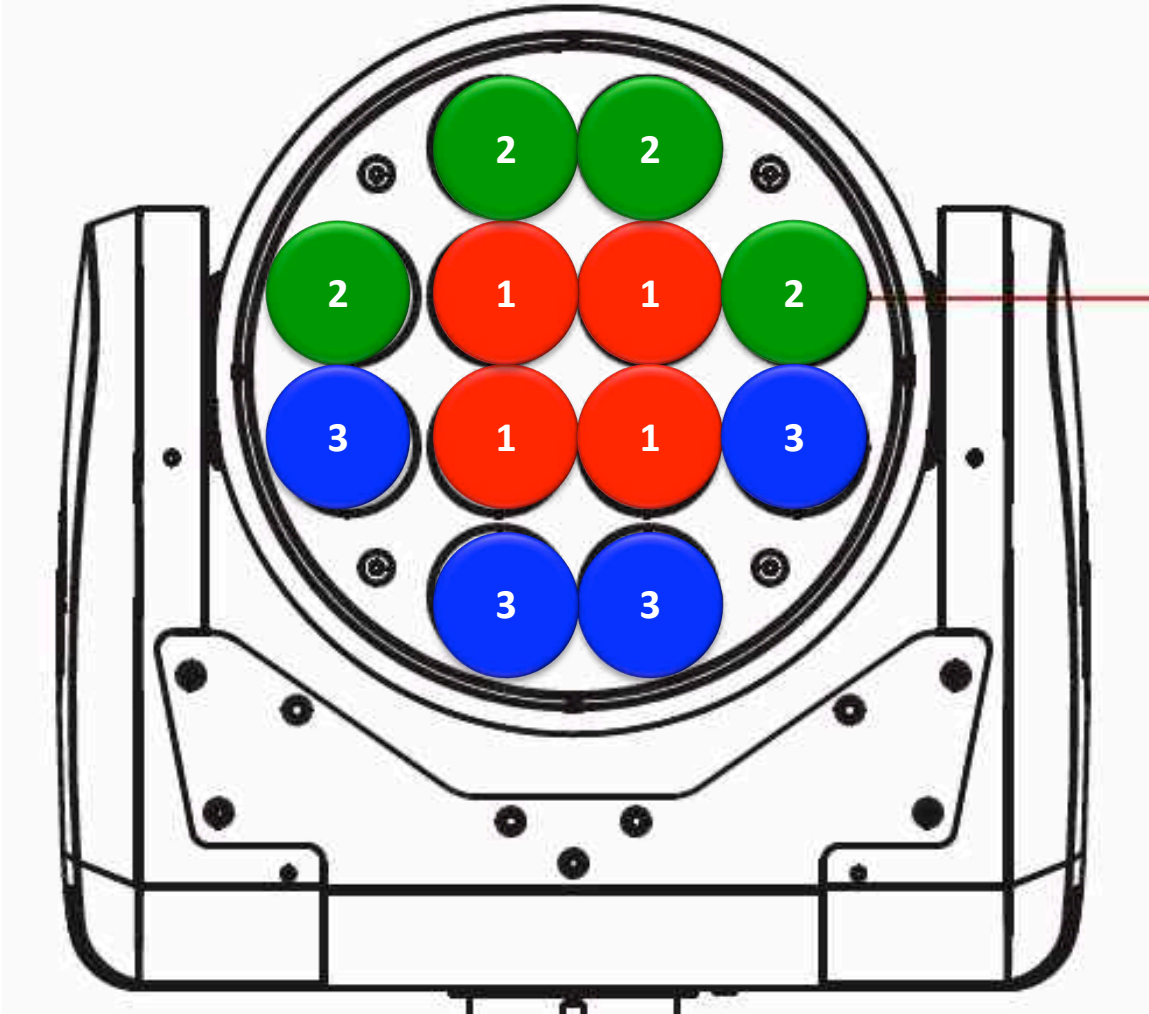

ERROR CODES

When power is applied, the fixture automatically enters a **“Reset/Test”** mode. This mode brings all the internal motors to a home position. If there is an internal problem with one or more of the motors an error code will flash in the display in the form of **“Err channel is XX”** where as **XX** will represent a specific function. The display may show one or multiple error codes. For example, when the display shows **“Err Channel is Pan Movement”**, it means the Pan Yoke is not in the home position. If there are multiple errors at the same time, you may see the error messages **“Err Channel is Pan Movement”**, **“Err Channel is Tilt Movement”** flash for 2 times.

If errors occur during the initial start-up procedure the fixture will self-generate a second reset signal and try to realign all the motors and correct the errors. If any errors persist after a second attempt a third attempt will be made. If after a third attempt all the errors have not been corrected the fixture will make the following determinations:

- **3 or More Errors** - The fixture cannot function properly with three or more errors therefore the fixture will place itself in a stand-by mode until subsequent repairs can be made.
- **Less Than 3 Errors** - The fixture has less than 3 errors; therefore most other functions will work properly. The fixture will attempt to operate normally until the errors can be corrected by a technician. The errors in question will remain flashing in the display as a reminder of internal errors.

PAN- Movement Er (PAN-Yoke Movement Error)

This message will appear after the reset of the fixture if the yoke’s magnetic-indexing circuit malfunction (sensor failed or magnet missing) or the stepping-motor is defective (or its driving IC on the main PCB). The PAN- movement is not located in the default position after the reset.

TILT- Movement Er (TILT-Head Movement Error)

This message will appear after the reset of the fixture if the head’s magnetic-indexing circuit malfunctions (sensor failed or magnet missing) or the stepping-motor is defective (or its driving IC on the main PCB). The TILT- movement is not located in the default position after the reset.

CLEANING AND MAINTENANCE



CAUTION!

Disconnect from mains before starting maintenance operation.

CLEANING

Frequent cleaning is recommended to insure proper function, optimized light output, and an extended life. The frequency of cleaning depends on the environment in which the fixture operates: damp, smoky or particularly dirty environments can cause greater accumulation of dirt on the fixture's optics.

- Clean the external lens surface at least every 20 days with a soft cloth to avoid dirt/debris accumulation. Never use alcohol, solvents, or ammonia based cleaners.

MAINTENANCE

Regular inspections are recommended to insure proper function and extended life. There are no user serviceable parts inside this fixture, please refer all other service issues to an authorized Elation service technician. Should you need any spare parts, please order genuine parts from your local Elation dealer.

Please refer to the following points during routine inspections:

- A detailed electric check by an approved electrical engineer every 3 months, to make sure the circuit contacts are in good condition and prevent overheating.
- Be sure all screws and fasteners are securely tightened at all times. Loose screws may fall out during normal operation resulting in damage or injury.
- Check for any deformations on the housing, color lenses, rigging hardware and rigging points (ceiling, suspension, trussing). Deformations in the housing could allow for dust to enter into the fixture. Damaged rigging points or unsecured rigging could cause the fixture to fall and seriously injure a person(s).
- Inspect all moving parts and make sure there are no signs of wear and rotate/move without imbalances.
- Electric power supply cables must not show any damage, material fatigue or sediments. Never remove the ground prong from the power cable.

TECHNICAL SPECIFICATIONS

FEATURES

Compact and Fast Zoom Wash LED Illuminare
13° - 29° Motorized Zoom
RGBW Color Mixing and Color Macros
Variable Color Temperatures (2,700K - 8,000K)
Variable Dimming Modes
Multiple Pixel Zone Control and Chase Effects
RDM - Remote Device Management
Flicker Free Operation for Broadcast TV and FILM

SOURCE

(12) 15W Quad Color RGBW LEDs
100,000 Hour Average LED Life

PHOTOMETRIC DATA

Distance @8.2 ft (2.5m)
5,680 LUX 528 FC (13° Min Zoom Full ON)
3,200 LUX 297 FC (13° Min Zoom WHITE LEDs Full ON)
806 LUX 75 FC (29° Max Zoom Full ON)
470 LUX 44 FC (29° Max Zoom WHITE LEDs Full ON)

EFFECTS

Multiple Pixel Zone Control
Color Macro and Chase Effects
Strobe: 1-18fps
Dimming: 0% - 100%
Variable Dimming Modes

COLOR

RGBW Color Mixing
Variable Color Temperatures (2,700K - 8,000K)

CONTROL / CONNECTIONS

(3) DMX Channel Modes (17 / 20 / 28)
RDM (Remote Device Management)
6 Button Touch Control Panel
Full Color 180° Reversible LCD Menu Display
16 Bit 3-Phase Motors
8 / 16 Bit Resolution Adjustable Movement
5pin DMX In/Out
powerCON Power In/Out

SIZE / WEIGHT

Length: 11.9" (302mm)
Width: 8.4" (214mm)
Vertical Height: 17.1" (434)
Weight: 23.0 lbs. (10.4 kg)

ELECTRICAL / THERMAL

AC 100-240V - 50/60Hz
200W Max Power Consumption
-13°F to 113°F (-25°C to 45°C)

APPROVALS / RATINGS

CE Approved
RoHS Compliant
IP20 Rated

INSTALLATION

Rigging: Clamps (Not Included)
Working Position: Flat Surface / Inverted (180°)

INCLUDED ITEMS

Omega Brackets, 5pin DMX Cable, Safety Cable, powerCON Cable

Please Note: Specifications and improvements in the design of this unit and this manual are subject to change without any prior written notice.

PHOTOMETRIC DATA

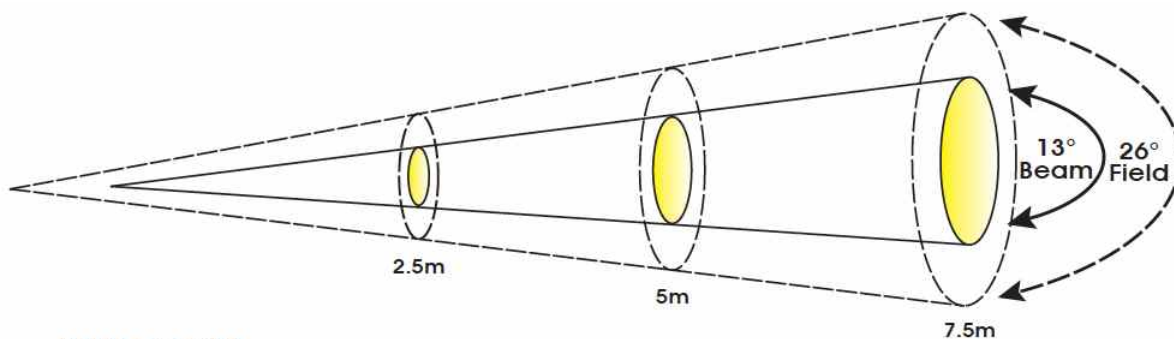

MIN ZOOM

| | m | ft | m | ft | m | ft |
|--------------------|------|-----|-----|------|------|------|
| Distance | 2.5 | 8.2 | 5 | 16.4 | 7.5 | 24.6 |
| 13° Beam Diameter | 0.55 | 1.8 | 1.1 | 3.6 | 1.65 | 5.4 |
| 26° Field Diameter | 1.15 | 3.8 | 2.3 | 7.5 | 3.45 | 11.3 |

| Photometrics | lux | fc | lux | fc | lux | fc |
|--------------|-------|-----|-------|-----|-----|----|
| RED LEDs | 1,150 | 107 | 345 | 32 | 153 | 14 |
| GREEN LEDs | 2,650 | 246 | 730 | 68 | 327 | 30 |
| BLUE LEDs | 250 | 23 | 73 | 7 | 36 | 3 |
| WHITE LEDs | 3,200 | 297 | 871 | 81 | 390 | 36 |
| FULL ON | 5,680 | 528 | 1,477 | 137 | 660 | 61 |

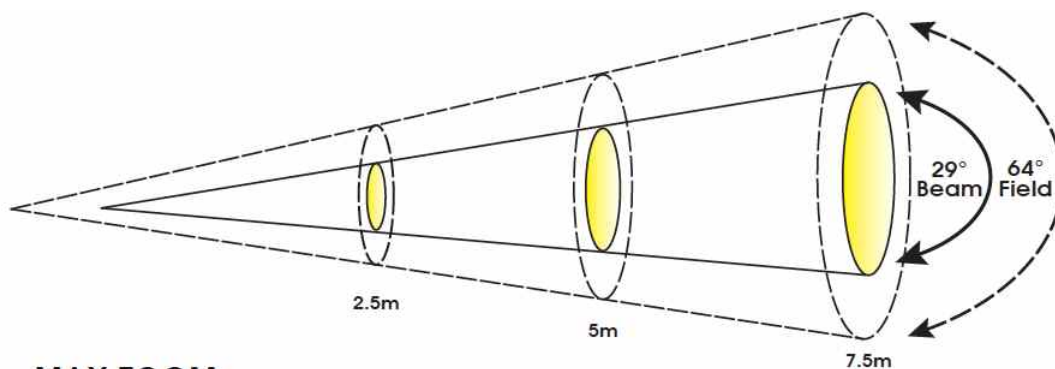

MAX ZOOM

| | m | ft | m | ft | m | ft |
|--------------------|-----|------|-----|------|-----|------|
| Distance | 1 | 3.3 | 2 | 6.6 | 3 | 9.8 |
| 29° Beam Diameter | 1.3 | 4.3 | 2.6 | 8.5 | 3.9 | 12.8 |
| 64° Field Diameter | 3.1 | 10.2 | 6.2 | 20.3 | 9.3 | 30.5 |

| Photometrics | lux | fc | lux | fc | lux | fc |
|--------------|-----|----|-----|----|-----|----|
| RED LEDs | 173 | 16 | 45 | 4 | 21 | 2 |
| GREEN LEDs | 389 | 36 | 101 | 9 | 48 | 4 |
| BLUE LEDs | 43 | 4 | 11 | 1 | 6 | 1 |
| WHITE LEDs | 470 | 44 | 120 | 11 | 57 | 5 |
| FULL ON | 806 | 75 | 210 | 20 | 99 | 9 |

Please Note: Specifications and improvements in the design of this unit and this manual are subject to change without any prior written notice.

DIMENSIONAL DRAWINGS

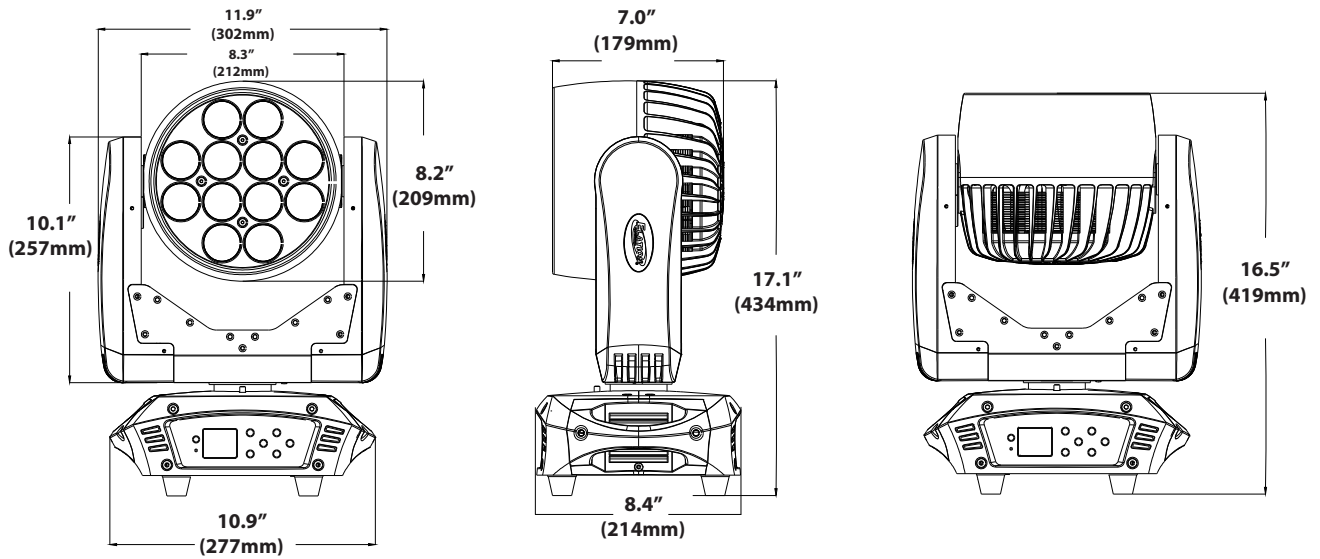

CIRCUIT SCHEMATICS

pending

Please Note: Specifications and improvements in the design of this unit and this manual are subject to change without any prior written notice.

OPTIONAL ACCESSORIES

| ORDER CODE | ITEM |
|---------------|---|
| TRIGGER CLAMP | Heavy Duty Wrap Around Hook Style Clamp |
| ** pending ** | Road Case For Rayzor Q12 Zoom™ |
| ELO211 | Eloader II™ Software Updater Box |
| EWDMXSYSTEM | Wireless DMX System (1 Transmitter, 1 Receiver) |
| EWDMXT | Wireless DMX Transmitter |
| EWDMXR | Wireless DMX Receiver |
| AC3PDMX5PRO | 5 ft. (1.5m) 5pin PRO DMX Cable |
| AC5PDMX10PRO | 10 ft. (3m) 5pin PRO DMX Cable |
| AC5PDMX15PRO | 15 ft. (4.5m) 5pin PRO DMX Cable |
| AC5PDMX25PRO | 25 ft. (7.5m) 5pin PRO DMX Cable |

