

BVV3000 INFINIUM

Vintage 300-Watt All-Valve Bass Amplifier Head with INFINIUM Valve Life Multiplier

Valve Bass Amplifier Head

- Hand-built 300-Watt bass amplifier head driven by 6 x 6550 valves
- Vintage design from the '60s featuring 3 x 12AX7 and 2 x 12AU7 valves for harmonically rich and vibrant valve sound
- Revolutionary INFINIUM Valve Life Multiplier technology: – Extends the life of your amplifier's expensive power valves up to 20 times. – Provides incredible reliability and consistent tone over the complete lifespan of your valves – No need for expensive matched valve sets – Allows you to mix and match any combination of compatible valve types and brands – Monitors performance of each power tube continuously and displays defective valves to allow for easy and individual replacement
- Voicing selector provides you with 5 classic sound variations to suit your playing style
- Dedicated Bass, Mid and Treble controls and High/Low switches for ultimate sound shaping
- Balanced XLR DI for direct connection to your mixing console
- Slave Output to connect with additional amplifiers
- Preamp Out and Power Amp In connectors allow you a signal tap from the preamp section and a direct access to the power amp for even greater versatility



Leave it to BUGERA to bring the classic all-valve bass amp up to date. Lovingly handmade and sporting vintage styling, the BVV3000 INFINIUM merges in-your-face bass with state-of-the-art features, such as a 5-position Voicing selector and our new INFINIUM Valve Life Multiplier technology, which will keep your BVV3000 sounding great for many years to come.

With 300-Watts of chest-pounding output, the BVV3000 melds old-school aggressive attitude with a touch of nostalgia, creating tones that are only possible from an all-valve amplifier.

All-Valve Design

There are lots of amplifiers on the market today that claim to be valve amps just because they've got a 12AX7 inside. But it takes a whole lot more than just a preamp tube to qualify an amp as being "all-valve." The BVV3000 is a true all-valve bass amp with three 12AX7 and two 12AU7 valves. Two trios of 6550 (also known as KT88) output tubes operate in classic "push-pull" mode to create 300 Watts of room-shaking thunder.

Each BUGERA valve goes through a rigorous 48-hour burn-in process before being individually evaluated by a skilled Quality Control Inspector (a real live human being). Only about one in every ten valves actually gets the go-ahead for use in our amps. The rest get tossed onto the slag-heap, where they are melted down to make shot glasses.

Continued on next page



THE SOUL OF VALVES
Bugera

BVV3000 INFINIUM

Vintage 300-Watt All-Valve Bass Amplifier Head with INFINIUM Valve Life Multiplier

Features

- Adjustable Bias control allows you to easily bias the power amp valves for optimum performance
- Valve protection circuitry, auto-fault mode and fan cooling for ultimate amp protection
- 3 speaker outputs: two ¼" jacks and a professional speaker connector (compatible with Neutrik Speakon)
- Impedance switch (2 and 4 Ohms) to match virtually any speaker cabinet
- High-quality components and exceptionally rugged construction ensure long life

Taming the Beast

The BVV3000 is so much more than just raw power. The all-tube preamp provides tremendous tone-shaping control. Sure, you get the standard boost/cut capability from the BASS (centered at 40Hz) and TREBLE (4kHz) knobs, but the real "voice" of your bass is defined by its midrange content.

BVV3000's 5-position FREQUENCY selector lets you choose the center frequency that best suits your playing style, or the one that brings out your instrument's true personality. Just select from 220 Hz, 450 Hz, 800 Hz, 1.6 kHz and 3.0 kHz and turn the MIDRANGE knob to boost or cut by as much as 15dB—and that's a lot! And if you want even more tone-sculpting options, engage the ULTRA-LOW switch for an additional +2 dB boost @ 40 Hz, or the ULTRA-HIGH switch for a soaring top-end boost of +9 dB @ 8 kHz.

Use Your Connections

When it comes to connectivity, the BVV3000 is brimming with capability. A balanced XLR DI output is provided for connecting to front-of-house or recording consoles without any additional hardware. The CHANNEL INSERT section features a PREAMP OUTPUT and a POWER AMP IN jack, creating the ideal path for external dynamics processors, such as limiters or compressors, or even a graphic EQ to further fine-tune your tone. The Power Amp In jack also provides a great way to connect an additional BVV3000 stack for the gig that calls for a larger-than-life, take-no-prisoners wall of bass. Simply connect the SLAVE OUTPUT from your main BVV3000 to the Power Amp In on the second BVV3000 system and rattle the rafters!

High-Current Speaker Connections

In addition to the two ¼" speaker jacks on the rear panel of the BVV3000, we've also provided a professional high-current, twist-lock socket,

which ensures that all of BVV3000's massive output is transferred to the speaker cabinet, not lost in the form of heat in less efficient cabling. By setting the IMPEDANCE switch to 2 Ohms, you can daisy-chain two (2) BB410 cabinets for a chest-pounding bass tour de force.

INFINIUM Valve Life Multiplier Technology

Our revolutionary INFINIUM Valve Life Multiplier technology is like having your very own technician inside your amp constantly monitoring and tweaking valve performance for the ultimate in tonal integrity and reliability. This revolutionary circuit not only optimizes the performance of each output tube, it dynamically balances the drive between them to more evenly distribute the load. With INFINIUM, your tubes last up to 20 times longer, saving you substantial money over the lifespan of your amplifier. INFINIUM also compensates for the effects of aging, automatically adjusting current levels to keep your valves sounding as good as the day they were installed.

If and when a valve does reach the end of its life, the system even tells you which one to replace. All you need do is replace the faulty valve and let INFINIUM take care of the rest for you. This all adds up to more consistent sound quality and longer life for your valves. Maintenance for valve amps has never been this easy!

Value

When it comes to all-valve tone, functionality and versatility, the BUGERA BVV3000 INFINIUM is the value leader in its class—and its chest-pounding output keep the dance floor busy at a price that will keep you smiling. Or, you could spend a whole lot more and get an amp from that company whose name rhymes with "Damp Leg". The choice is yours.

Stop by your authorized BUGERA dealer today and put the BVV3000 INFINIUM to the test.

THE SOUL OF VALVES
Bugera

BVV3000 INFINIUM

Vintage 300-Watt All-Valve Bass Amplifier Head with INFINIUM Valve Life Multiplier

Features

Front Panel

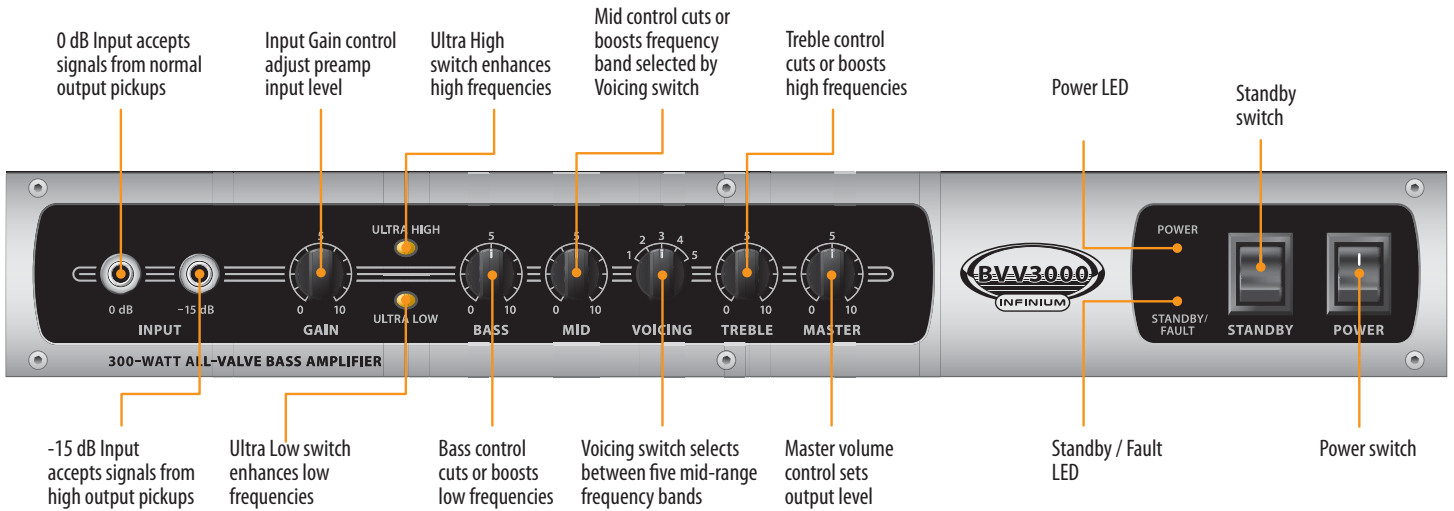

Rear Panel

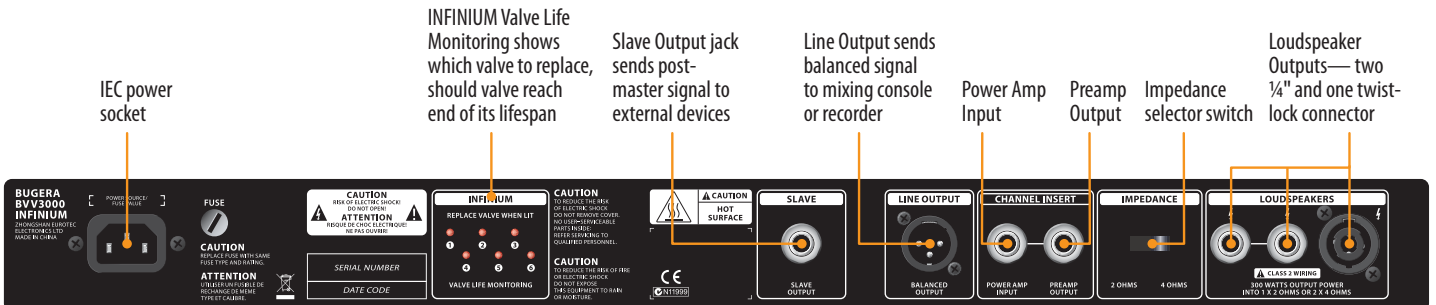

BVV3000 INFINIUM

Vintage 300-Watt All-Valve Bass Amplifier Head with INFINIUM Valve Life Multiplier

Hook-up

Standard Hookup

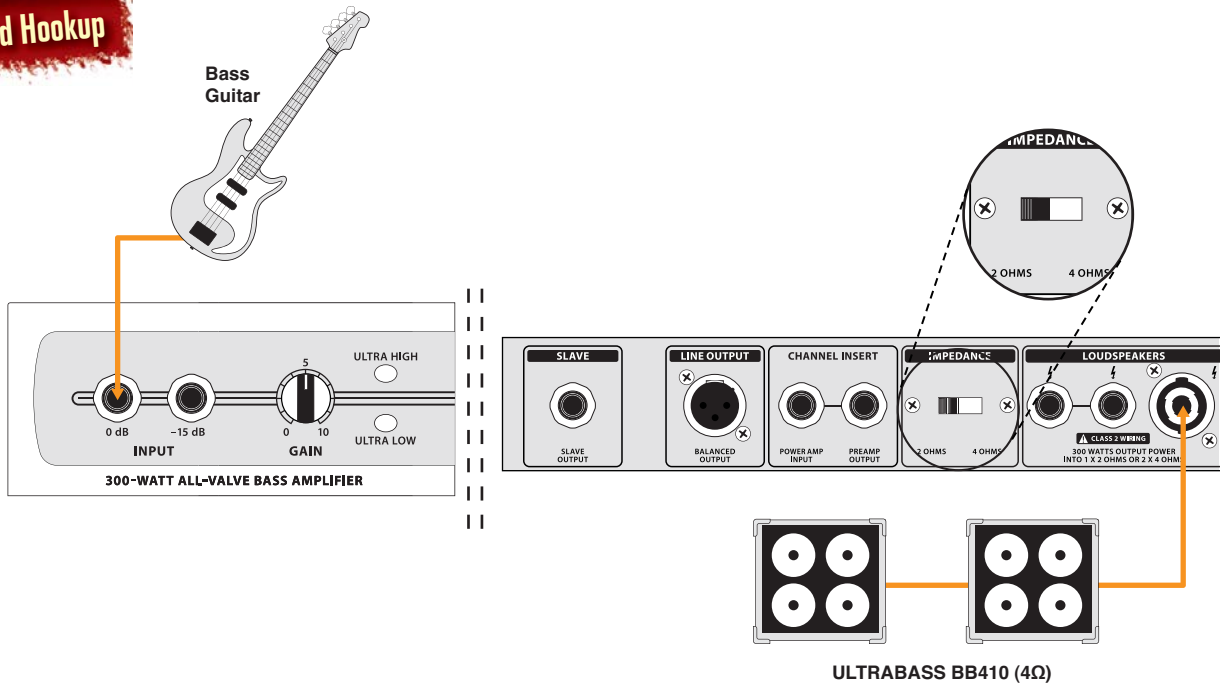

Recording Hookup

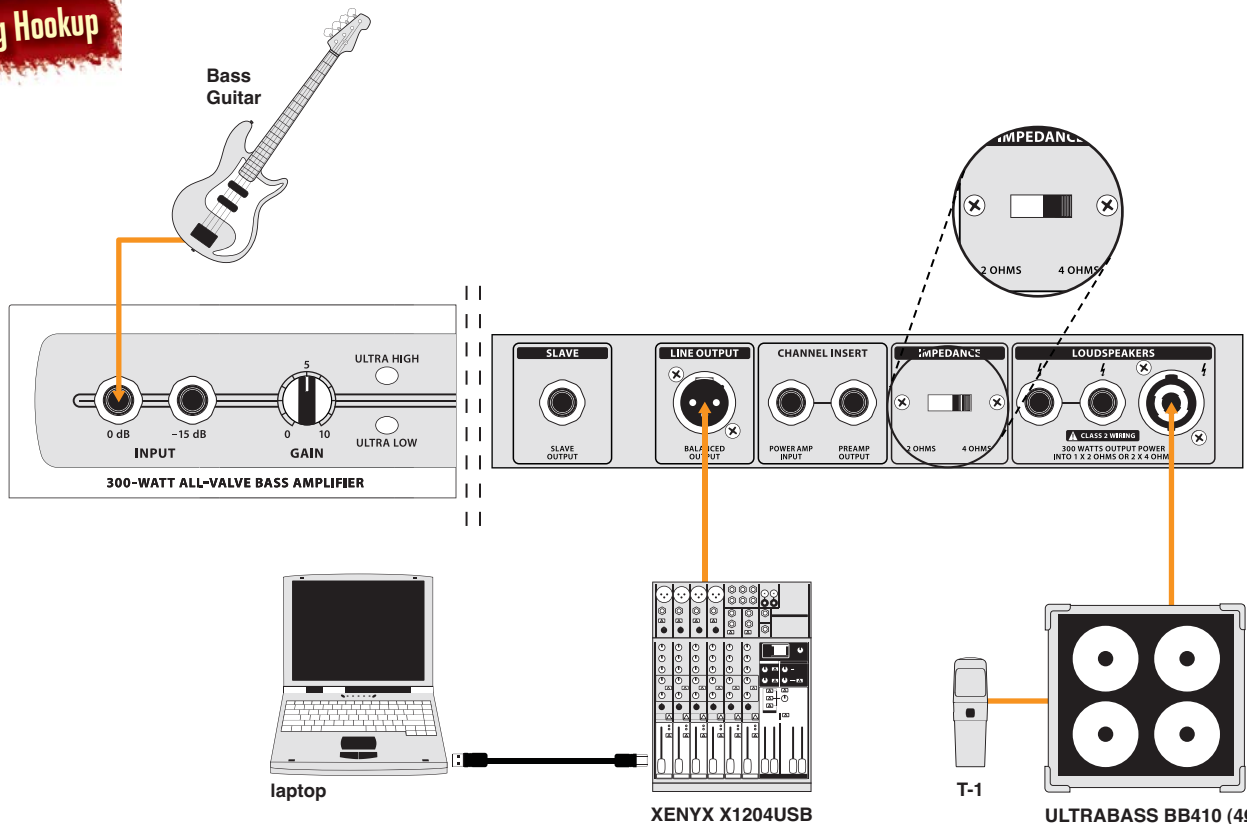

BVV3000 INFINIUM

Vintage 300-Watt All-Valve Bass Amplifier Head with INFINIUM Valve Life Multiplier



BVV3000 Setup with Slave System

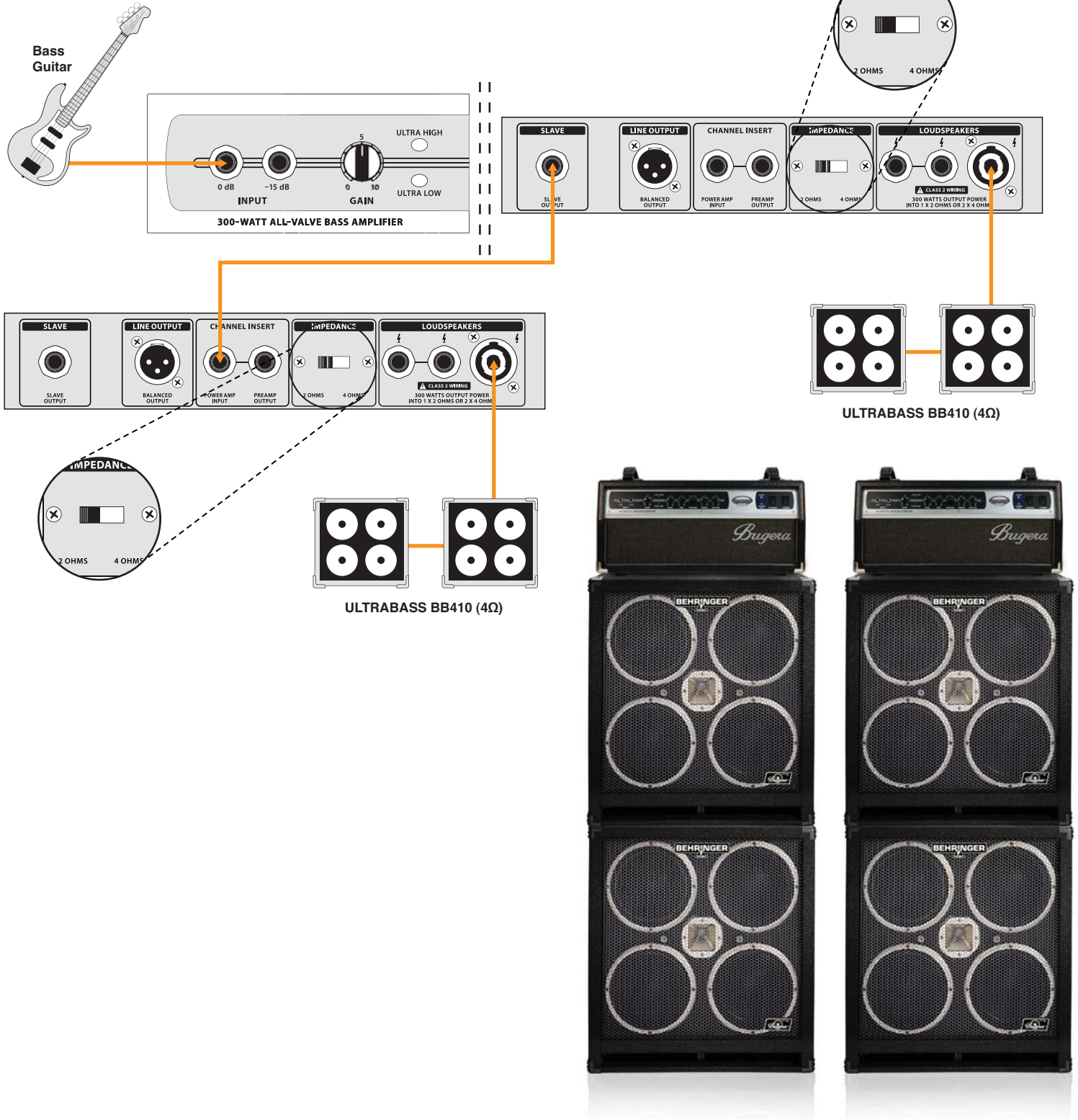

BVV3000 INFINIUM

Vintage 300-Watt All-Valve Bass Amplifier Head with INFINIUM Valve Life Multiplier

Specs

Audio Inputs

0 dB Instrument Input	¼" mono jack, unbalanced
Impedance	appr. 1 MΩ

-15 dB Instrument Input	¼" mono jack, unbalanced
Impedance	appr. 120 kΩ

Power Amp	¼" mono jack, unbalanced
Impedance	appr. 55 kΩ

Audio Outputs

Slave Output	¼" mono jack, unbalanced
Impedance	appr. 2.2 kΩ

Line Output	XLR, balanced
Impedance	appr. 600 Ω

Preamp Output	¼" mono jack, unbalanced
Impedance	appr. 20 kΩ

Loudspeaker Connectors	2 x ¼" TS jack 1 x professional speaker connector
Impedance	2 Ω / 4 Ω switchable

System Data

Output Power	
Impedance setting	2 Ohms
Power	320 W

Impedance setting	4 Ohms
Power	295 W

RMS	240 Watts / 240 Watts
-----	-----------------------

Peak	300 Watts / 300 Watts
------	-----------------------

Valves	3 x 12AX7 / 2 x 12AU7 6 x 6550
---------------	-----------------------------------

Tone controls

Ultra High	+9 dB @ 9 kHz
------------	---------------

Ultra Low	+2 dB @ 40 Hz -12 dB @ 500 Hz
-----------	----------------------------------

Bass	-10 dB / +15 dB @ 50 Hz
------	-------------------------

Mid / Voicing	-18 dB / +10 dB @ 220 Hz, 450 Hz, 900 Hz, 1.6 kHz, 3 kHz
---------------	--

Treble	-18 dB / +16 dB @ 5 kHz
--------	-------------------------

Power Supply / Voltage (Fuses)

USA / Canada	120 V~, 60 Hz (T 10 A H 250 V)
--------------	-----------------------------------

UK / Australia	240 V~, 50 Hz (T 5 A H 250 V)
----------------	----------------------------------

Europe	230 V~, 50 Hz (T 5 A H 250 V)
--------	----------------------------------

China	220-230 V~, 50/60 Hz (T 5 A H 250 V)
-------	---

Japan	100 V~, 50/60 Hz (T 10 A H 250 V)
-------	--------------------------------------

Power consumption	max. 700 Watts
-------------------	----------------

Mains connection	Standard IEC receptacle
------------------	-------------------------

Dimensions / Weight

Dimensions (HxWxD)	appr. 11.5 x 23.6 x 12.5" appr. 290 x 598 x 318 mm
--------------------	---

Weight	appr. 74.5 lbs / 33.8 kg
--------	--------------------------

We are constantly striving to maintain the highest professional standards. As a result of these efforts, modifications may be made from time to time to existing products without prior notice. Specifications and appearance may differ from those listed or illustrated.

Contact Info

BUGERA Support

For service, support or additional information, please refer to behringer.com or contact the BEHRINGER company nearest you.

Europe
BEHRINGER International GmbH
Otto-Brenner-Strasse 4a
47877 Willich, Germany
Tel.: +49 2154 9206 4149
Fax: +49 2154 9206 4199

USA/Canada
MUSIC Group Services USA, Inc.
18912 North Creek Parkway
Suite 200
Bothell, WA 98011
Tel.: +1 425 672 0816
Fax: +1 425 673 7647

Singapore
MUSIC Group Services SG (Pte.) Ltd.
1 Kim Seng Promenade #08-08
Great World City West Tower
Singapore 237994
Tel.: +65 6845 1800
Fax: +65 6214 0275

Australia
MUSIC Group Services AU Pty Ltd
Suite 3, 60-64 Railway Road
Blackburn, Victoria, 3130
Tel.: +613 9877 7170
Fax: +613 9877 7870

Japan
BEHRINGER Japan K.K.
Matsushita Building, 8F
Kanda-Ogawa Machi 3-3-2
Chiyoda-ku, Tokyo 101-0052
Tel.: +81 3 5281 1180
Fax: +81 3 5281 1181

©2011 Red Chip Company Ltd. Technical specifications and appearance subject to change without notice. The information contained herein is correct at the time of printing. All trademarks (except BUGERA, the BUGERA logo, THE SOUL OF VALVES, TRIREC and BEHRINGER) mentioned belong to their respective owners, and such use neither constitutes a claim of the trademarks by Red Chip nor affiliation of the trademark owners with Red Chip. Red Chip accepts no liability for any loss which may be suffered by any person who relies either wholly or in part upon any description, photograph or statement contained herein. Colours and specification may vary from product. RED CHIP COMPANY LTD. Trident Chambers, Wickhams Cay, P.O. Box 146, Road Town, Tortola, British Virgin Islands. Products are exclusively distributed by BEHRINGER. 985-10000-00460