

# Gantom iQx: Controllable Image Projector

GT-GB2-CW-BL

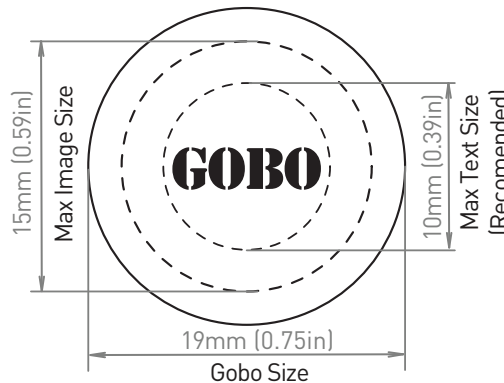
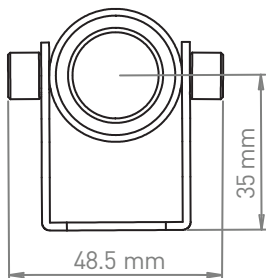
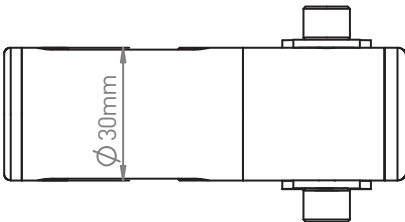
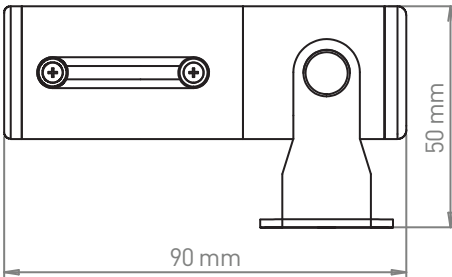

## GANTOM iQ: CONTROLLABLE IMAGE PROJECTOR

With the same sharp optics as the original Gantom iQ micro image projector, the Gantom iQx packs even more functionality to the product by integrating DMX control and a pattern generator. Brightness, speed, and pattern can be selected over 3 DMX channels. Preset patterns can also be stored to the fixture for standalone operation to run without signal (DarkBox Programmer required).

Built in patterns include blink, strobe, fade, power surge, and candle flicker; perfect for adding a dynamic element to any display. A projected sign that automatically fades in and out without additional controls is sure to catch any customer's attention.

## FEATURES

- Smallest pattern projector on the market
- 3 DMX channels of control: intensity, speed, pattern
- Programmable to run without DMX signal (standalone operation)
- Zoom adjustable using front sliding lens
- Focus adjustable using rear sliding lens
- Supports full color user made patterns
- Cree XP-G LED
- Internal constant current driver
- Easy installation and reconfiguration
- Indoor and outdoor use

## SPECIFICATIONS

Max wattage	2.7W
Input voltage	12VDC
Current draw	< 225mA
Light beam angle	25°-40°
Dimensions	30mmØ x 90mm
Lead wire length	360mm
IP rating	IP65
Gobo size	19mm OD, 15mm ID
Exterior Finish	Black anodized aluminum
Power Connector	2.1mm ID / 5.5mm OD DC jack with screw terminal adapter
Signal Connector	3.5mm TRS jack with screw terminal adapter
Catalog #	GT-GB2-CW-BL

	Center Beam Lux		Beam Width	
	25°	40°	25°	40°
1m	350Lux	200Lux	0.4m	0.6m
2m	90Lux	50Lux	0.9m	1.3m
3m	35Lux	20Lux	1.3m	2.2m

[www.darklightsystem.com](http://www.darklightsystem.com)

Address 27811 Avenue Hopkins Ste 8, Valencia, CA 91355  
Phone (661) 347-0779 Fax (661) 793-6985 Email [info@darklightsystem.com](mailto:info@darklightsystem.com)

Proud member of

