

Atlona HDBaseT Extender Family



Atlona HDBaseT Extender Family



AT-HDTX-RSNET

Beyond Ordinary Video

Our family of HDBaseT extenders offers higher resolutions at longer distances, power over category cable (PoCc), and options for control, distance, form factor, and connectors, so you can customize an installation with just the right features while reducing costs. Choose RSNET for the longest distances and complete control; ROADNET for rental and staging applications; or DVI RSNET for electronics with DVI connectors. Choose WP (wall plates in US and UK form factor) extenders for use behind displays. Choose IR for applications that require only IR control or HD for applications that rely on local control.

Atlona Advantages	
GO FARTHER Up to 328 ft (100 m). Value models use HDBaseT for transmission up to 230 ft (70 m)	CONVENIENT CAPTIVE-SCREW TERMINATIONS for power and control help reduce wire bundles for cleaner racks and more reliable connections
POWER OVER CATEGORY CABLE PoCc eliminates the need for a power supply at the receiver	LOCKING HDMI PORTS for extra-secure connections and uninterrupted signals
MORE OPTIONS Signal and connector options including HDMI or DVI for video/audio, HDBaseT on RJ45 or etherCON	RESOLUTIONS UP TO ULTRAHD (4Kx2K)
MORE CONTROL Ethernet, RS-232, and bi-directional IR for third-party-controller compatibility	PASSES CEC SIGNALS future-ready
ETHERNET/INTERNET Allows in-zone Internet access to any Internet-capable device. Smart TVs will allow Internet access and apps. AVRs with Internet can access streaming audio apps.	SUPPORTS ALL EMBEDDED AUDIO SIGNALS including Dolby True HD and DTS-HD Master Audio
ROADNET FOR RENTAL AND STAGING Specifically designed for rental and staging, with extra-robust RJ45 etherCON connectors to withstand the rigors and chaos of live performance and temporary installation. Quick-connect power supply for faster setup and breakdown	HDBASET PERFORMS AT TWO LEVELS: 328-foot distance up to 1080p; 230 ft @ Ultra HD (4Kx2K) with Cat5e/6; 328-foot with Cat6a/7; OR 230ft@ 1080p over CAT6a/7; 197ft@1080p over CAT5e/6; and 130ft@4Kx2K over CAT5e/6. Confirm performance for specific products. Pairing 328-foot-max with 230-foot-max results in 230-foot-max performance.
DVI OPTION with DVI connector instead of HDMI connector, ideal for PC users and the medical industry. This adapter has HDMI-compatible electronics with DVI connectors for max flexibility including capability to transmit audio and Ultra HD (4Kx2K)	UPGRADE IN THE FIELD USB port so firmware can be upgraded in the field to save time and money

Atlona HDBaseT TX HDMI
Rental/Staging Box
w/etherCON, Ethernet, RS-232, and IR



AT-HDTX-ROADNET

Atlona HDBaseT TX DVI Box
w/Ethernet, RS-232, and IR



AT-DVITX-RSNET

Atlona HDBaseT TX HDMI Box
w/Ethernet, RS-232, and IR



AT-HDTX-RSNET

Atlona HDBaseT TX HDMI Box
w/IR



AT-HDTX-IR

Atlona HDBaseT TX HDMI Box



AT-HDTX

Family Comparison Chart

SOLUTIONS	TX	RX	PoCc	328 ft (100 m max)	230 ft (70 m max)	IR	RS-232	Ethernet
MAX CONTROL								
AT-HDTX-RSNET	X		X	X		X	X	X
AT-HDRX-RSNET		X	X	X		X	X	X
AT-DVITX-RSNET	X		X	X		X	X	X
AT-DVIRX-RSNET		X	X	X		X	X	X
AT-HDTX-ROADNET	X		X	X		X	X	X
AT-HDRX-ROADNET		X	X	X		X	X	X
IR CONTROL								
AT-HDTX-IR	X		X		X	X		
AT-HDRX-IR		X	X		X	X		
AUDIO/VIDEO ONLY								
AT-HDTX	X		X		X			
AT-HDRX		X	X		X			

Specifications

BANDWIDTH	10.2 Gbps				
VIDEO	Up to UltraHD (4Kx2K)				
PORTS	RSNET	ROADNET	IR	HD	DVI
HDBaseT	1 x RJ45	1 x etherCON NE8MC	1 x RJ45	1 x RJ45	1 x RJ45
IR In/Out	1 x 5 pin captive screw	1 x 5 pin captive screw	1 x 5 pin captive screw	N/A	1 x 5 pin captive screw
RS-232	1 x 3 pin captive screw	1 x 3 pin captive screw	N/A	N/A	1 x 3 pin captive screw
Power	1 x 2 pin captive screw	Locking power connector	1 x 2 pin captive screw	1 x 2 pin captive screw	1 x 2 pin captive screw
Firmware Upgrade	1 x mini USB	1 x mini USB	1 x mini USB	1 x mini USB	1 x mini USB
Ethernet	1 x RJ45	1 x RJ45	N/A	N/A	1 x RJ45
Audio/Video	1 x HDMI female	1 x HDMI female	1 x HDMI female	1 x HDMI female	1 x DVI female
DISTANCE	328 ft (100 m) @1080p 328 ft (100 m) @4Kx2K over Cat6a/7 230 ft (70 m) @4Kx2K over Cat5e/6		230 ft (70 m) @1080p over Cat6a/7 197 ft (60 m) @1080p over Cat5e/6 130 ft (40 m) @4Kx2K		328 ft (100 m) @1080p 328 ft (100 m) @4Kx2K over Cat6a/7 230 ft (70 m) @4Kx2K over Cat5e/6
AUDIO	Transmits up to Dolby TrueHD or DTS-HD Master				
WALL MOUNTABLE	Yes				
POWER CONSUMPTION	RSNET	ROADNET	IR	RX/TX	DVI
TX/RX Total	11.3W	11.3W	9.1W	9.1W	11.3W
DIMENSIONS (H X W X D)	1.5 x 5 x 4 in. (38 x 127 x 102 mm)	1.5 x 5 x 4 in. (38 x 127 x 102 mm)	0.95 x 2.87 x 2.72 in. (24 x 73 x 69 mm)	0.95 x 2.87 x 2.72 in. (24 x 73 x 69 mm)	1.5 x 5 x 4 in. (38 x 127 x 102 mm)
WEIGHT	.46 lb (.21 kg)	.46 lb (.21 kg)	.25 lb (.11 kg)	.25 lb (.11 kg)	.46 lb (.21 kg)
TEMPERATURE					
Operating Storage	32°F to 104°F (0°C to 40°C) -4°F to 140°F (-20°C to 60°C)				
Certifications	CE, FCC, RoHS (power supplies are cULus certified)				

System Connection Diagram

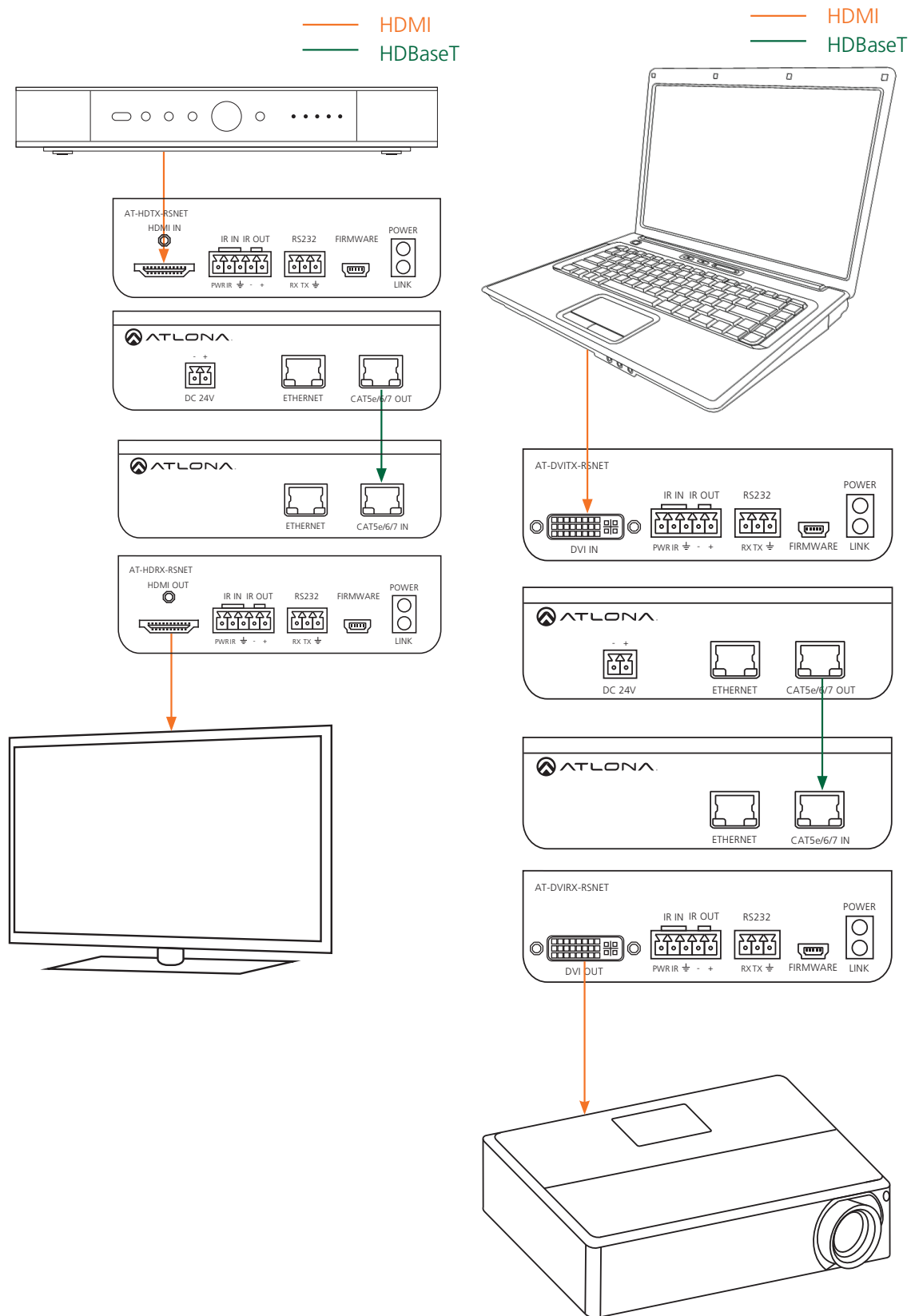

Related Products

Atlona HDMI 4 x 4 Matrix Switcher



AT-PRO3HD44M

Atlona 2 x 8 HDMI to HDBaseT Extended Distance Distribution Amplifier



AT-HDCAT-8ED

HDMI (male) to DVI (female) Locking Adapter



AT14050

Pair with Atlona Matrix Switchers

Our HDBaseT extenders pair with any Atlona HDBaseT device such as the PRO3HD matrix switchers and HDCAT distribution amplifiers

ADAPTERS Get the reliability of DVI with an HDMI extender using the 14050 HDMI (male) to DVI (female) locking adapters.

NOTE: Different HDBaseT technology allows signals up to 230 feet OR to 328 feet. Pairing components with different HDBaseT distances results in reduced maximum performance. Pairing 328-foot-max with 230-foot-max results in 230-foot-max performance.



ATLONA
Connecting Technology

atlona.com • 408.962.0515 • 877.536.3976