



# 2065 Series

## BNC Connectors



### Product Benefits

- Full crimp design
- Designed for analog & digital cables
- Field Installable
- Meets or exceeds HDTV standards

### Mechanical

Durability:	500 Cycles Min Center Contact
Center Contact Retention:	6 lbs. Minimum
Coupling Mechanism:	100 lbs. Minimum
Force to Engage/Disengage:	Torque 2.5 in.-lbs. Max.;
	Longitudinal force 3.0 lbs. Max.
Interface Dimension:	MIL-C-39012 except 75 Ohms

### Environmental

Thermal Shock:	-65°C to +165°C
Moisture Resistance:	0 to 95%: MIL-STD-202 Method 106
Corrosion (Salt Spray):	MIL-STD-202 Method 101 Test Condition B
Flammability:	UL 94-V0 Rated (Center Conductor Insulator)
Vibration:	MIL-STD-202 Method 204 Test Condition B
Solvent Resistance:	MIL-STD-202 Method 215

### Outline Drawing (Plug)

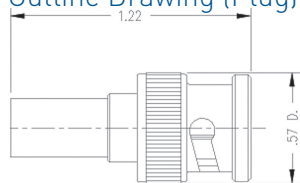

### Electrical

Characteristic Impedance:	75 Ohms
Voltage Rating:	500 Volts RMS
Return Loss:	Less than -36 dB to 1 GHz; -25 dB to 2 GHz; -23 dB to 3 GHz; -20 dB to 5 GHz
Contact Resistance:	Center Contact .0014 Ohms Outer Contact .002 Ohms
Insulation Resistance:	5000 megohms

### Finishes

Body/Bayonet:	Nickel
Center Conductor:	50 millionths inch gold plating over copper plate

Typical Return Loss

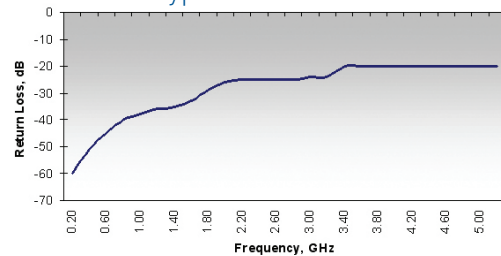

# Plugs

KINGS® Part No.	FOR CABLES*				CABLING			Bulk Packs Available?
	Belden	West Penn/ CDT	Gepco	Others	Crimp Die (KTH-1000)	Crimp Die (KTH-5000)	Trim Code	
2065-1-9	9209A				KTH-2261	KTH-5003	3-661-1	
2065-2-9	1505A 1506A 9259	819 25819 815	VPM2000 VPM2000TS VE61859M		KTH-2261	KTH-5003	3-661-1	YES
2065-15-9	8281	P806	VP618PE VP6000 VP618TK	WE 724	KTH-2119	KTH-5002	3-661-4	
2065-7-9	8241		VJ59U	RG-59 RG-210	KTH-2261	KTH-5003	3-661-1	YES
2065-8-9	7731A 8213		VHD1100		KTH-2004	KTH-5004	3-661-3	
2065-10-9	1694A 1695A	6350 256350 WP6355	VSD2001 VSD2001TS		KTH-2325	KTH-5017	3-661-1	YES
2065-11-9	1855A 1865A	HD825 HD25825 WP8255 WP258255	VDM230 VDM250		KTH-2025	KTH-5003	3-661-1	YES
2065-29-9	1279R 1279P				KTH-2276	KTH-5001	3-661-1	YES
2065-28-9	1520A 179DT			RG-179 RG-187	KTH-2258	KTH-5001	3-661-1	YES

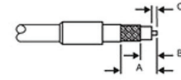

Trim Code	A	B	C
3-661-1	.624	.312	.155
3-661-3	.687	.375	.187
3-661-4	.668	.356	.200

\*Consult factory for cables not listed

# Within Series Adapters

KINGS® Part Number	Adapter Ends	Dimensions				Mounting Hole
		A		B		
		ln	mm	ln	mm	
2029-9-9	Bulkhead, Jack-Jack	1.28	32.5	0.69 D	17.5 D	A
2029-15-9	Jack-Jack	1.28	32.5	0.44 D	11.2 D	
2029-16-9	Jack-Plug-Jack	1.28	32.5	1.06	26.9	
2029-17-9	Bulkhead, Jack-Jack, iso. ground	1.28	32.5	0.63 D	16.0 D	A
2029-20-9	Jack-Plug, Right Angle	0.90	22.9	1.03	26.2	

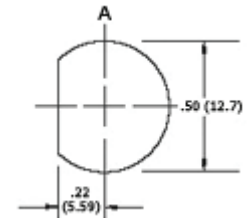

# Terminations

KINGS® Part Number (True 75 Ohm)	Dimensions				Notes
	A		B		
	ln	mm	ln	mm	
2555-3-32	1.00	25.4	0.57 D	14.5 D	75 ohm, 0.1%, 1/2 watt

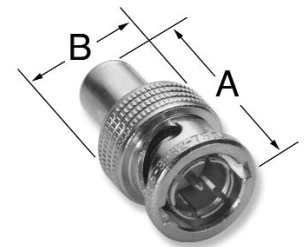

Note:

Connectors are designed for use on both analog and digital cable. Consult your cable manufacturer for cable performance data.



Winchester Electronics  
62 Barnes Industrial Road North  
Wallingford, Connecticut 06492  
203.741.5400 Phone  
203.741.5500 Fax  
www.winchesterelectronics.com