

42" CLASS (42.0" MEASURED DIAGONALLY)

42CQ610H

LCD TV

Hospital Grade LCD Widescreen

Pro:Centric™ Single Tuner™ HDTV  
with HD-PPV Capability



DESIGNED SPECIFICALLY FOR THE HEALTHCARE INDUSTRY

UL HOSPITAL GRADE LISTED  
Built-In Pillow Speaker Port  
Built-in MPI Port  
TV Speaker Disable

EXPANDED PILLOW SPEAKER COMPATIBILITY  
Supports multiple codes (Zenith, Philips, RCA)

EXPRESS SCRIPT  
Easy to use, 8 Step Installer Menu Setup Wizard

**NEW!** LG'S EXCLUSIVE Pro:Centric APPLICATIONS PLATFORM<sup>1</sup>  
Supports Java™ and Adobe® Flash® application  
(Pro:Centric SINGLE TUNER)

**NEW!** b-LAN™ INTEGRATION

**NEW!** REMOTE MANAGEMENT OF TELEVISION  
SETTINGS USING Pro:Centric SERVER (PCS150R) OR  
FREE-TO-GUEST MANAGEMENT APPLIANCE (FMA-LG101)

 EcoSmart™  
Dynamic/Static Power Savings

 CALIFORNIA ENERGY COMMISSION (CEC) COMPLIANT

 RESTRICTION OF HAZARDOUS SUBSTANCES  
(ROHS) COMPLIANT

HD VOD PPV DECRYPTION AND  
INTERACTIVE SYSTEM CAPABILITY  
Integrated Pro:Idiom®

MPEG-2 / MPEG-4 H.264 DECODING

SPLASH IMAGE/LOGO (ON STARTUP)  
Customized Welcome Screen

USB CLONING

NATIVE DISPLAY RESOLUTION  
1920 x 1080 (Full HD 1080p)

DYNAMIC CONTRAST RATIO  
50,000:1

2 HDMI INPUTS WITH HDCP

2 YEAR LIMITED WARRANTY  
(parts and labor)

Extended service plans, leasing, and financing options available.

<sup>1</sup>May require optional software, third party subscription service/contract, and customization at an additional cost.

**ENERGY  
GUIDE** ↓

The estimated annual energy cost determined in accordance with 16 CFR Part 305.5 for model 42CQ610H is \$25.

"Your energy cost depends on your utility rates and use. The estimated cost is based on 11 cents per kWh and 5 hours of use per day. For more information, visit [www.ftc.gov/energy](http://www.ftc.gov/energy)."<sup>1</sup>

<sup>1</sup>FTC Television labeling rule (18 CFR Part 305, as added by 76 Fed. Reg. 1038 (Jan 6, 2011)).

LGsolutions.com

 **LG**  
Life's Good



# WHEN IT'S GREEN.

LG is committed to improving product development, manufacturing and usage to meet the demand for environmentally friendlier products. Our 42CQ610H television has technologies to reduce power consumption and in return increase **cost savings** per patient room.

## EcoSmart

- **Dynamic Power Savings** - Using built-in algorithms, TV will automatically reduce the power consumption based on incoming video, while maximizing picture performance.
- **Static Power Savings** - Picture brightness level can be set at the preferred power consumption level to reduce power and increase energy savings.
- **CEC Compliant** - Meets the Appliance Efficiency Regulations of the California Energy Commission.
- **RoHS Compliant** - Meets directive on restriction of hazardous substances.
- **Power Management** - Automatic shutoff when TV has no activity after selected 1 - 7 hours of operation.

# APPLICATION ACCESSORIES

## Pro:Centric\*

### Interactive Patient Room Experience

An industry leading Pay-Per-View (PPV) compatible television that also supports the Pro:Centric platform, LG's new 42CQ610H allows healthcare facilities to customize the patient room experience. Pro:Centric provides an easy way for the 42CQ610H to interface with interactive program guides, games and internet data feeds, as well as applications designed to connect patients to services such as dietary menus and patient room information.

\*May require additional software and hardware to support third party partner interactive systems or LG's own Free-To-Guest Pro:Centric Application.

## Electronic Program Guide



## Pro:Centric PLATFORM\*

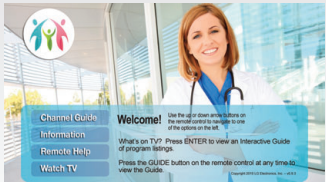
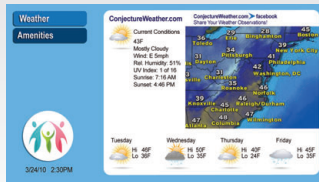

\*May require optional software, hardware, third party subscription service/contract, and customization at an additional cost. Pro:Centric enabled pillow speaker required.

## Pro:Centric SYSTEM OVERVIEW (example for illustrative purpose only)

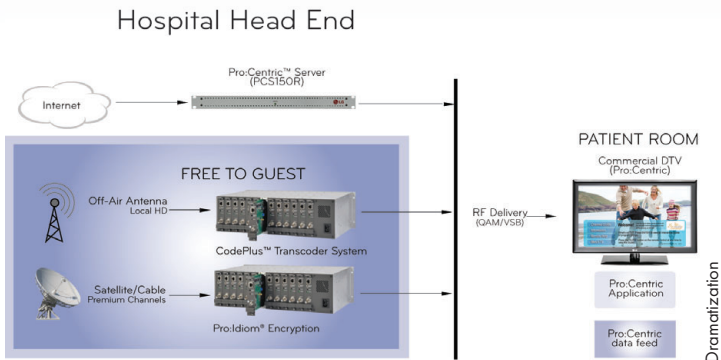

## LG'S FREE-TO-GUEST COST EFFECTIVE SOLUTION

When using LG televisions in For Free-To-Guest hospital installations there are now two options for remote management of TV settings such as virtual channel mapping, cloning of installer menu settings, and other settings:

1. Integrated b-LAN, plus LG's Free-To-Guest Management System (FMA)
2. LG's Pro:Centric server (PCS150R)

Both remote management options avoid having to visit patient rooms to change television settings, thereby saving labor charges to carry out this work.

## HOSPITAL COSTS FOR FREE-TO-GUEST CHANNEL MANAGEMENT

	Estimated Labor Costs	*MAP price	Total	Savings over other brand
Other brand	\$20 (est.) x 2 times per year (to update channels) x 100 rooms x 5 years		\$20,000	
LG Pro:Idiom TV with b-LAN integration plus FMA		\$1,999 (FMA)	\$1,999	\$18,001
LG Pro:Idiom TV with Pro:Centric Server		\$2,500	\$2,500	\$17,500

\* MAP price subject to change.

## FREE-TO-GUEST REMOTE MANAGEMENT DEVICES

### FMA-LG101

HEAD-END SYSTEM



Manages channel line-up changes, channel label changes, designates a startup channel, cloning of commercial installer menu settings, and can set the time/date, and broadcast that information to all the terminals on a regular basis. Also, enables Pro:Idiom tuning for Pro:Idiom encrypted content.

### PCS150R

HEAD-END SYSTEM



Remote management functions also supported via the Pro:Centric server. The Pro:Centric Application software can be remotely added at a later date to deliver the benefits of LG's Applications features (Weather, EPG, Billboards...)

## FREE-TO-GUEST INTEGRATED b-LAN

### b-LAN

FREE-TO-GUEST TECHNOLOGY

Will allow viewing of HD secured Pro:Idiom encrypted content from Pro:Idiom licensed Cable or Satellite providers. Compatible with FMA-100 and FMA-LG101 head-end systems. Pay-Per-View ready.

## POWER ON SPLASH IMAGE

### Welcome Screen

(Default)



(Modified)



LG's hospital-grade patient room televisions feature a Splash Image/Logo (Customized Welcome Screen) feature that allows a healthcare facility to enhance their brand image. It gives the installer the ability to upload a logo/image so that a patient can view it on screen when they turn on the TV. The logo/image is easily uploaded by using a USB memory device.

## EXPRESS SCRIPT

### Express Script Installer Menu Wizard

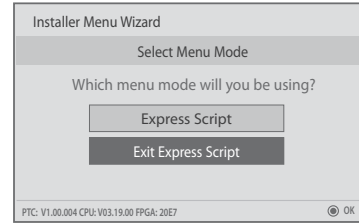

The Express Script Installer Menu Wizard enables users to customize essential items for viewing the TV the first time it is turned on. This 8 step process is a convenient and easy way to provide the preferred settings recommended by the facility. The Express Script Installer Menu Wizard can also be activated from the commercial installer menu.

## CLONING OPTIONS

The LQ630H series has a convenient time and expense saver feature. A select number of commercial menu items are cloning capable. This allows the cloning of a master TV to an infinite number of the same model target TV. This can be easily accomplished in either of two ways, by using a USB memory device or by using an optional LG accessory TLL-1100A TVLink-Loader. This time saving technique will allow the installers to program the preferred commercial settings from a master TV to all the required target televisions in a hospital facility in a matter of just a few minutes per TV.

### Clone using a USB Memory Device

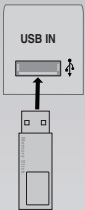

The Installer sets up a master TV with the preferred menu settings. A USB memory device is plugged into the master TV. Menu items are selected to "Learn From TV" and stored on the USB stick. The USB stick is then plugged into a target TV. Menu items are selected to "Teach To TV". The USB device is then unplugged and is ready to engage with the next target TV.

OR

### Clone using OPTIONAL TLL-1100A TVLink-Loader



The Installer sets up a master TV with the preferred menu settings. The TLL-1100A TVLink-Loader is charged up and the MPI cable is connected to both the TLL-1100A and the Master TV. By selecting buttons on this TVLink-Loader, menu items are selected to "Learn From TV" and stored on the TLL-1100A (about 90 seconds). The TLL-1100A is then plugged into a target TV. By selecting buttons on the TVLink-Loader, the TLL-1100A menu items are selected to "Teach To TV". The TVLink-Loader is then unplugged and is ready to engage with the next target TV.

# DIMENSIONS

42CQ610H

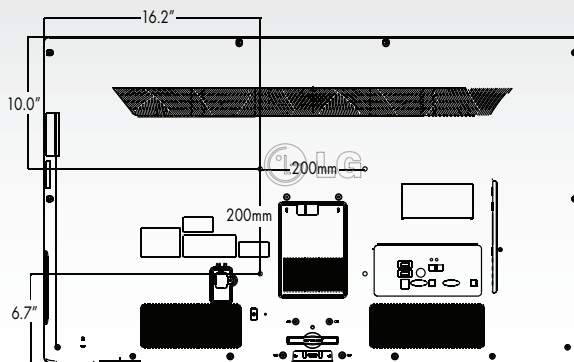
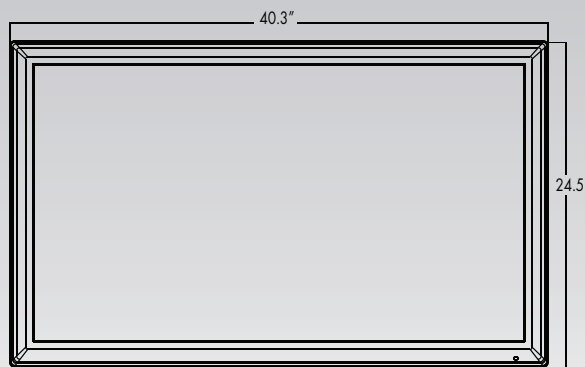

42CQ610H

### REAR

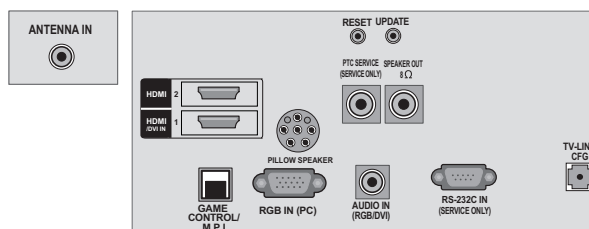

### SIDE



### PILLOW SPEAKER ACCESS

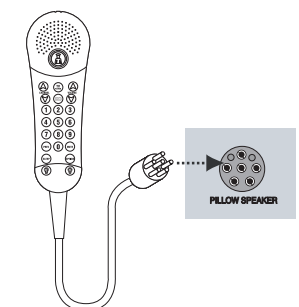

## OPTIONAL ACCESSORY REMOTES

### INSTALLER REMOTE 124-213-07

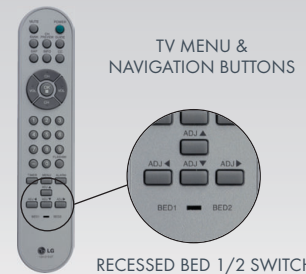

### PATIENT BED 1/2 REMOTE 124-213-08

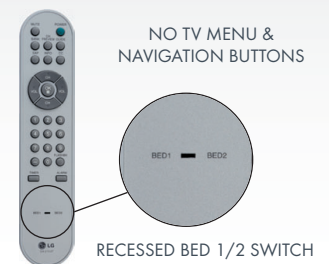

## SPECIFICATIONS

**DISPLAY**

LCD Panel Type	42" class
Display Area	42.0" measured diagonally
Aspect Ratio	16:9
Native Resolution	1920 x 1080
Dynamic Contrast Ratio	50,000:1
Contrast Ratio	800:1
Viewing Angle (Horizontal/Vertical)	178°/178°
Lamp Life	50,000 hours (approx.)
Response Time	5ms

**MAIN SYSTEM**

MPEG2/MPEG4 /H.264 Decoding	Yes
Maximum Computer Resolution (RGB)	1920 x 1080

**TUNING SYSTEM**

# of Tuners	1
ATSC/NTSC/QAM	Yes

**VIDEO**

Comb Filter	Yes
Digital Progressive Scan	Yes
Color Temperature	W50-C50
Enhanced Video	Yes (Dynamic Color, Noise Reduction, Gamma, Black Level, Eye Care, Real Cinema, Color Gamut, Edge Enhancer)

DLTI (Digital Luminance Transient Limiter)	Yes
DCTI (Digital Color Transient Improver)	Yes
Black/Blue Stretcher	Yes
3:2 Pull-Down (film mode)	Yes
Aspect Ratio	Yes (16:9/Just Scan/Set By Program/4:3/Zoom)
XD Color (Active Color Management)	Yes
XD Engine	Yes
Picture Status Modes	6 Modes (Vivid/Standard/Natural/Cinema/Sport/Game)

**AUDIO**

Number of Speakers	2
Dolby Digital® Decoder	Yes
Mono/Stereo/SAP	Yes
LG's patented Infinite Sound	Yes
Invisible Speaker System	Yes
Clear Voice II	Yes
Total Audio Watts (RMS)	2 x 10W (20W)
Bass/Treble/Balance	Yes
Auto Volume Leveler	Yes
Sound Modes	5 Modes (Standard, Music, Cinema, Sport, Game)
Internal Speaker On/Off	Yes

**JACKS**

RF In	1 (Rear)
A/V In	1 (Side)
TV Link CFG	1 (Rear)
RGB In (DB15-RGB)	1 (Rear)
PC Audio In (RGB/DVI)	1 1/8" phone jack (Rear)
HDMI	2 (Rear)
External Speaker Out 8 Ω	1W fixed (3.5mm phone jack), Mono
RS-232C (service only)	1 (Rear)
Pillow Speaker Port (6-pin)	1 (Rear)
USB	1 (Side) MP3/JPEG/HD DivX
Game Port/MPI Jack	1 (Rear)

**CLONING**

USB Cloning	Yes
TLL-1100A TVLink-Loader	Yes (Optional, sold separately)

**SPECIAL FEATURES**

b-LAN	Yes
Power Saving Function	Backlight dimming control
Integrated Pro:Idiom*	Yes
Express Script (Easy, 8-step setup)	Yes
Expanded Pillow Speaker Compatibility	Yes (Supports multiple codes: Zenith, Philips, RCA)
Splash Image Logo (on startup)	Yes
Commercial Installation Menu	Yes
TV Link Protocol	Yes
Discrete IR Codes	Yes
Last Source Power-on Recall	Yes
Auto/Manual Clock	Yes
On/Off Timer	Yes
Sleep Timer	Yes
Menu Language	English/Spanish/French/Korean
Auto/Manual Programming	Yes
Auto Shut-Off Setting	Yes
Channel Labeling	Yes
Closed Caption	Yes (8 options)
Mute	Yes
Flashback	Yes
Parental Control/V-Chip	Yes
Function Menu	Yes

**AGENCY APPROVALS**

UL, CUL, NOM	Yes
RoHS Compliant	Yes
CEC Compliant	Yes
UL Hospital Grade	Yes

**CABINET**

Color	Matte Black
Unit Dimensions (WxHxD)	40.3" x 24.4" x 3.4"
Unit Weight	33.3 lbs
Shipping Dimensions (WxHxD)	43.6" x 30.3" x 9.0"
Shipping Weight	48.1 lbs
Kensington Security Slot	Yes
VESA™ Standard Mount Interface	200mm x 200mm, M6 screws
Stand	Not included

**INCLUDED WITH TV**

UL Hospital Grade Power Cord	6 ft. (right angle wall plug)
Quick Reference Guide	Yes (manuals available online)
Protection Cover	Yes (covers stand opening)
Commercial Mode Setup Guide	Yes
Cable Management Clip	Yes

**OPTIONAL ACCESSORIES**

TVLink-Loader Cloner	TLL-1100A
Patient Remote with Bed1/Bed2	124-213-08
Installer Remote	124-213-07

**POWER**

Dynamic/Static Power Savings	Yes
Power Source	110V
Power Consumption (max.) with Power Saving Modes Disabled	160W
Power Stand-by Mode	Under 1W
Power Consumption (typ.)	125W

**OPERATING ENVIRONMENTS**

Storage Temperature Range	-4° ~ 140°F
Storage Humidity Range	Less than 85%
Operating Temperature Range	32° ~ 104°F
Operating Humidity Range	Less than 80%

**SERVICE/LIMITED WARRANTY**

UPC CODE	
42CQ610H	7 19192 90398 2

\*To view and to ensure proper operation of Pro:Idiom channels, additional equipment and programming services may be required.



All screen images are simulated. Dimensions and weights are approximate. Design, features and specifications subject to change without notice.

© Copyright 2012 LG Electronics USA, Inc. All Rights Reserved. "LG Life's Good" is a registered trademark of LG Corp. XD Engine is a registered trademark of LG Electronics USA, Inc. Pro:Centric and EcoSmart are registered trademarks or trademarks of LG Electronics, Inc. Pro:Idiom is a registered trademark and MPI is a trademark of Zenith Electronics Corp. Dolby and the double-D symbol are registered trademarks of Dolby Laboratories. VESA is a trademark of Video Electronics Standards Association. All other product and brand names are trademarks or registered trademarks of their respective companies.

Printed in the USA. April 2012

LGsolutions.com



LG Electronics U.S.A., Inc.  
HE B2B Division  
2000 Millbrook Drive  
Lincolnshire, IL 60069

Customer Service: 888.865.3026  
www.LGsolutions.com/support

Contact your LG Regional Sales Representative  
Healthcare/Long-Term Care: 877.793.6484

E-mail: info@LGsolutions.com

SPEC\_42CQ610H\_031225\_PR



**LG**  
Life's Good