

Technical Manual

JBL CONTROL 10 L,R*

SPECIFICATIONS



***Current Production, Start February 1991**

ACOUSTIC & ELECTRICAL SPECIFICATIONS:

- Nominal Impedance: 8 ohm
- Power Capacity: 150W IEC Filtered Random Noise
- Frequency Range: 35 Hz to 27 kHz (-10dB)
- Sensitivity: 94 dB SPL*
- Crossover Frequencies: 1.1 kHz and 4.6 kHz

SYSTEM COMPONENTS:

- Cabinet: C10 (Not For Sale)
- Grille: GC10 (69440)
- Low Frequency Transducer: 300mm (12 in.) Cone Transducer (119HS-1)
- DC Resistance: 5.0 ohm $\pm 10\%$ Copper Wire
- Mid Range Transducer: 125mm (5 in.) Cone Transducer (305HS) (69494)
- DC Resistance: 4.95 ohm $\pm 5\%$ Copper Wire

*1 Watt (2.83 V RMS) @ 1 Meter

SYSTEM COMPONENTS: (cont'd)

- High Frequency Transducer: 25mm (1 in.) Pure Titanium Dome Transducer (037Ti) (69495)
- DC Resistance: 3.5 ohm to 4.2 ohm Copper Wire
- Crossover Network: N10-A (73047)

AURAL SWEEP TEST SPECIFICATIONS:

- A. System Aural Sweep Test: 7.0V Input, 20 Hz to 20 kHz
- B. L.F. Aural Sweep Test: 6.0V Input, 20 Hz to 1.2 kHz
- C. M.F. Aural Sweep Test: 4.0V Input, 20 Hz to 1.2 kHz
- D. H.F. Aural Sweep Test: 2.0V Input, 2 kHz to 20 kHz

PHYSICAL SPECIFICATIONS:

- Enclosure Dimensions: 610mm x 432mm x 305mm D (24.0 x 17.0 x 12.0 in. D)
- Shipping Weight: 34 lbs. (15.5 kg) Each

WARRANTY INFORMATION:

- Refer to the Warranty Statement packed with each product.

PACKAGE

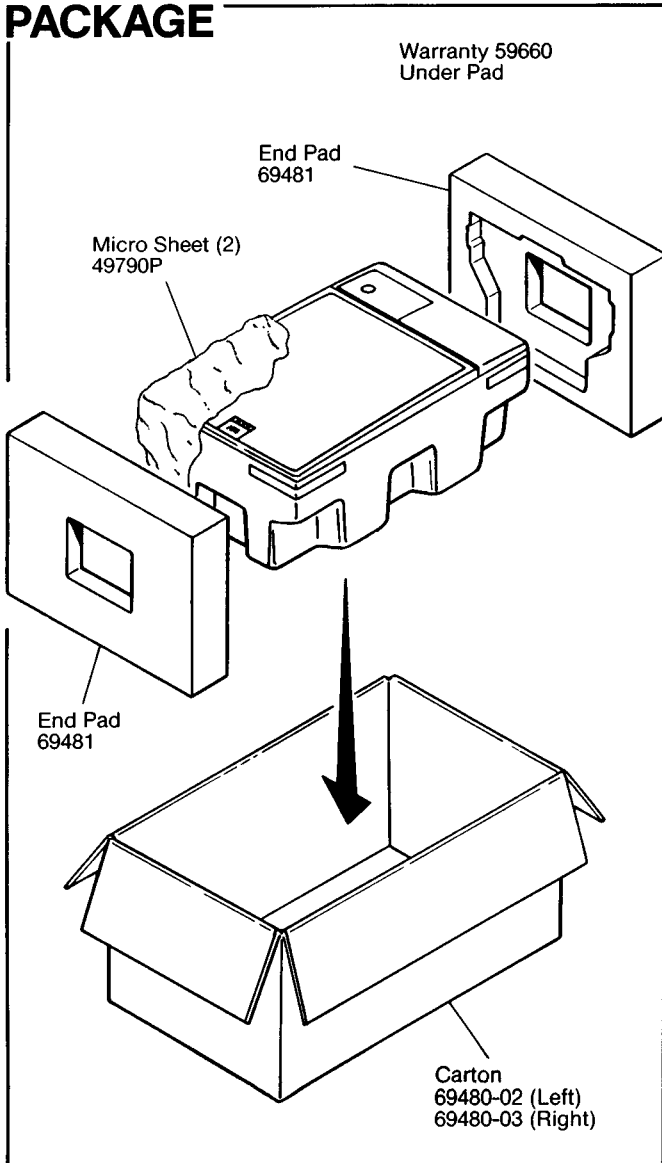

WIRING DIAGRAM

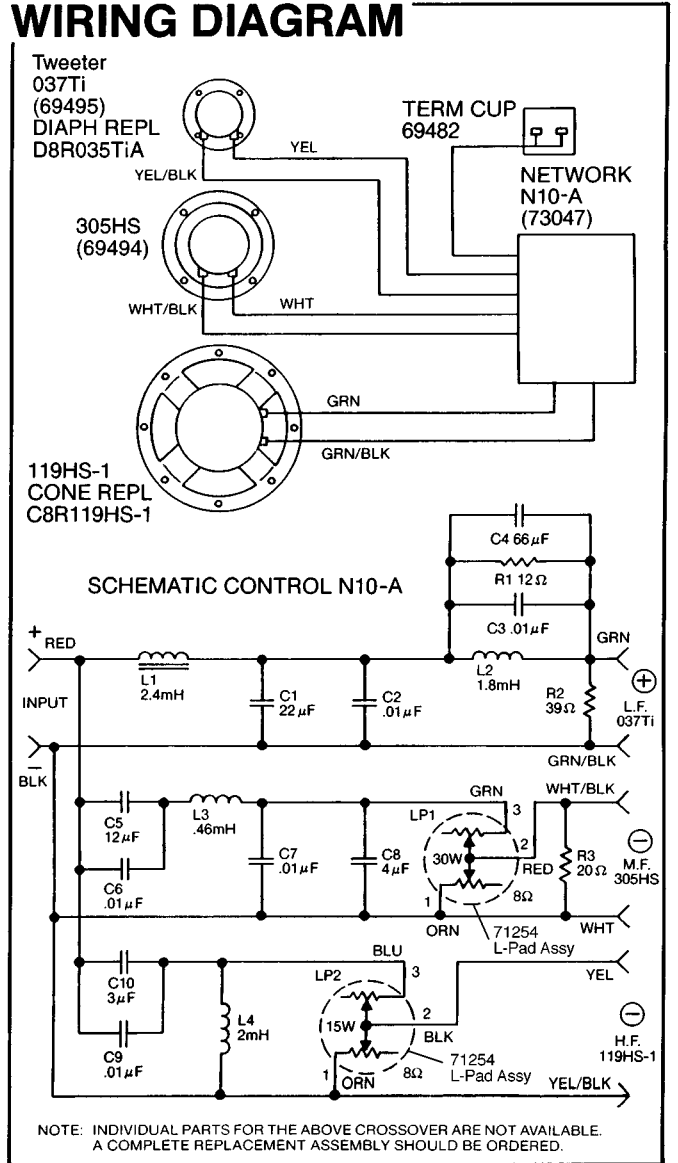

JBL CONTROL 10 L,R REV E

JBL CONTROL 10 L,R

COMPONENT EXPLODED VIEW

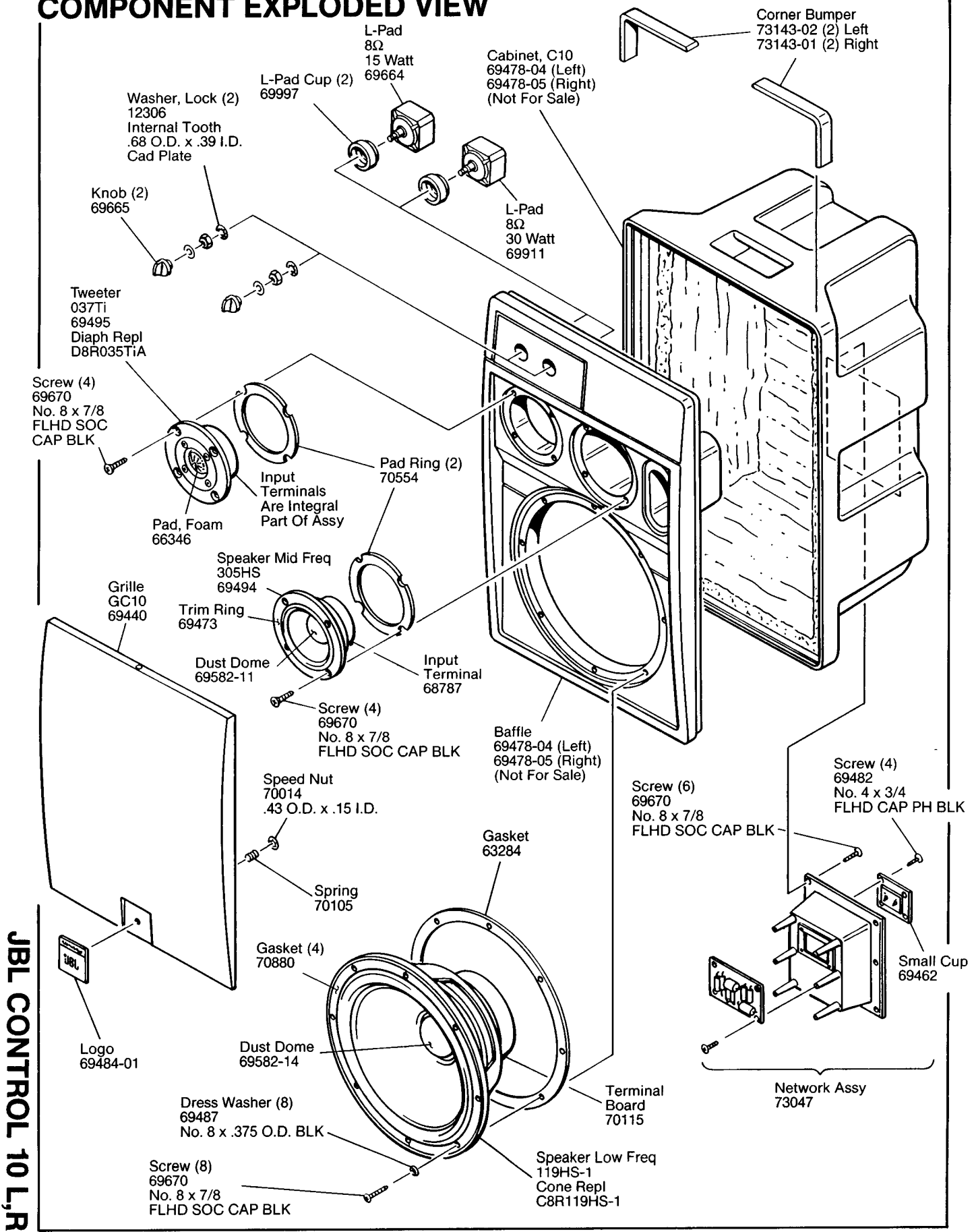

JBL CONTROL 10 L,R