

FWD-S55H2

Full HD LED Backlit Public Display

SONY
make.believe



image simulated

1000 cd/m² Brightness

With direct LED 1000 cd/m² (typical) backlighting, the FWD-S55H2 delivers images with high brightness and clarity, even in large venues and in places with bright ambient lighting.

Images seen in bright ambient lighting



1000 cd/m²

500 cd/m² or under

image simulated

* The FWD-S55H2 is for indoor use only. Direct sunlight can cause image failure or deterioration in quality. Please implement ultraviolet protection, infrared protection, and temperature protection.

Low Power & Energy Efficient

The FWD-S55H2 is designed to be energy efficient, offering low power consumption with LED backlighting (approx. 55% less than a conventional CCFL model from Sony*) which saves on running costs.

* Per unit area

Slim Installation Design

The depth of the FWD-S55H2 unit is approximately 80% that of a conventional CCFL model from Sony. For slim installation, the Signal In and Out terminals are incorporated into this profile, and do not protrude from the unit.

Professional Functions

Landscape / Portrait

The display can be mounted horizontally or vertically

Screen Saver

Screen Saver prevents screen burn-in on the display

DICOM Simulated Gamma Setting

Gamma setting is in accordance with the DICOM (Digital Imaging and Communications in Medicine) GSDF (Grayscale Standard Display Function) standard

Picture-in-Picture

Allows the picture from a secondary source to be displayed within the main picture

Eco Mode

Reduces power consumption up to 40% when using the High setting in Eco mode

Display Control via RS232C/RJ45

Enables monitoring of display status and control of multiple displays over a LAN, VPN or the Internet using Microsoft® Internet Explorer® 7.0 or later

Multi-Display

The FWD-S55H2 can present one dynamic large image by combining up to 16 display units (1x2, 1x3, 1x4, 2x1, 3x1, 4x1, 2x2, 3x3, 4x4)

True Color Control

True color control helps to ensure accurate color reproduction to faithfully reproduce product photos, company logos, etc

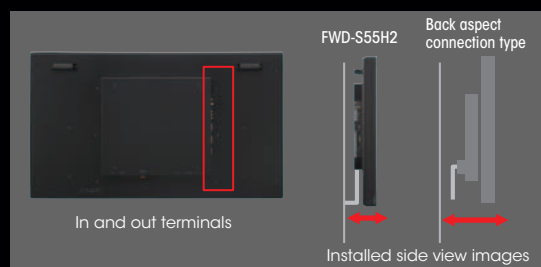

OPTIONAL ACCESSORIES

BKM-FW16
HD-SDI/SDI Input Adaptor



SU-S02
Tabletop Stand



SS-SPG02
Speaker Systems



CONNECTOR PANEL

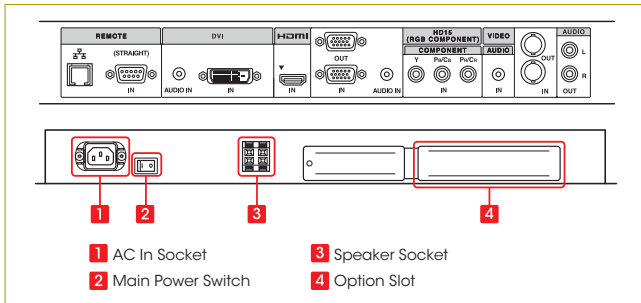

DIMENSIONS

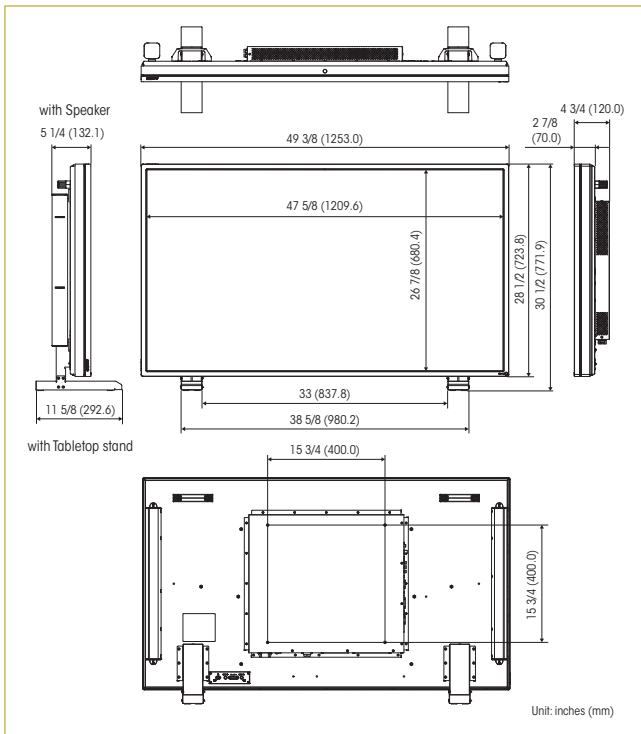

SPECIFICATIONS

FWD-S55H2	
LCD Panel	
Type	a-Si TFT Active Matrix LCD Direct lit type LED Backlight
Panel Size (diagonal)	55 inches
Picture Size (h x v)	47 5/8 x 26 3/4 inches (1,209.6 x 680.4 mm)
Panel Resolution (h x v)	1920 x 1080 pixels, Full HD
Pixel Pitch	0.63 x 0.63 mm
Color Depth	8 bits + FRC, 1.06 billion colors
Brightness	1,000 cd/m ² (typical)
Contrast Ratio	4,000 : 1 (typical)
Viewing Angle*	178 degrees (typical)
Signal	
Color System	NTSC, PAL
Sampling Rate	13.5 MHz to 162 MHz
Inputs/Outputs	
Digital Video	HDMI (1080p) in with audio in, DVI in with audio in Rev. 1.0 compliant
Analog Video	HD15 in with audio in (RGB/Component Video) HD15 out (RGB/Component Video) Composite Video in/out with audio in** (BNC (x2)) Component Video in with audio in** (pin jack (x3))
Remote Control	Network port (RJ45, 10BASE-T/100BASE-TX) RS-232C (D-sub 9-pin, straight)
Audio	Audio out (L/R, pin jack (x2))
Speaker Out	L/R, 7 W + 7 W, 6 ohms
Option Slot	x1 for BKM-FW16
General	
Power Requirements	AC 100 V to 240 V, 50/60 Hz, 2.9 A (maximum)
Power Consumption	250 W (typical) / 290 W (maximum)
Operating Temperature	32°F to 104°F (0°C to 40°C)
Storage Temperature	14°F to 104°F (-10°C to 40°C)
Humidity	20% to 90%, no condensation
Dimensions (w x h x d)	49 3/8 x 28 1/2 x 4 3/4 inches (1,253.0 x 723.8 x 120.0 mm) (excluding protruding parts)
Weight	78.7 lb (35.7 kg)
Regulation Compliance	UL, CSA, CE, GOST-R, IEC, FCC Class B, IC, CISPR, ErP Lot6
Supplied Accessories	AC power cord (x1), AC plug holder (x2), Cable holder (x6), Remote Control RM-FW002 (x1), Size AA (R6) batteries (x2), Operating instructions (x1)

* Measured at a contrast ratio of more than 10:1
** Component video and composite video share an audio input (stereo mini jack (x1))