

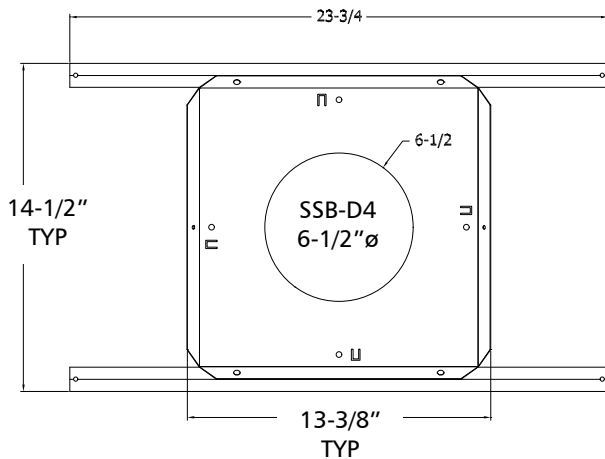

**SSB-D4**  
**SSB-D6**  
**SSB-D8**

**Loudspeaker Mounting Device  
 For "Dog-Leg" Mount**

**0402 - LOUDSPEAKER MOUNTING DEVICES**



SSB-D6 Shown

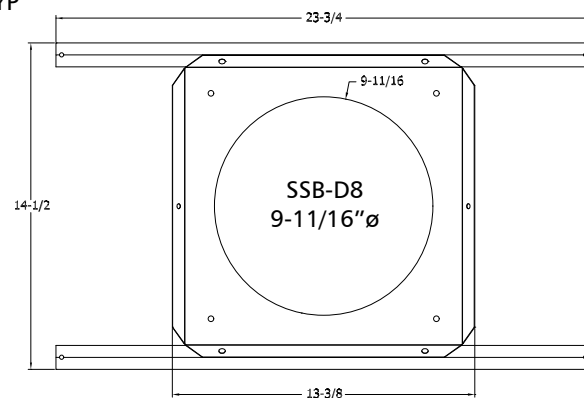
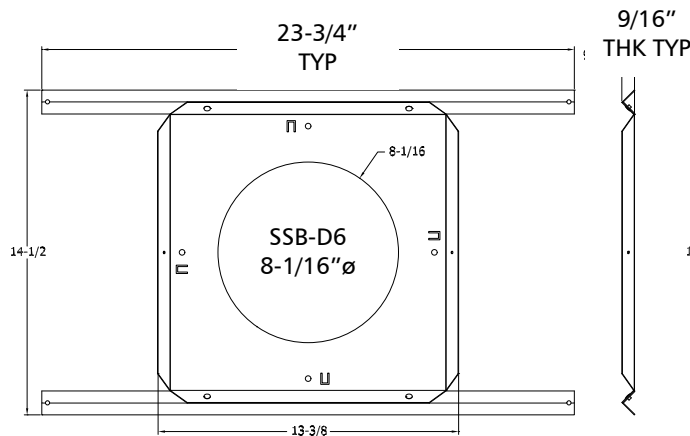

**GENERAL DESCRIPTION**

The Quam SSB-xD is a rust resistant steel, load bearing support for most loudspeakers using a "dog-leg" or cam type mounting mechanism designed for suspended ceilings.

**INTENDED USE**

Parallel to floor plane in a suspended ceiling structure; maximum span of 24" in one dimension; indoor environment.

Models shown correspond to nominal driver size; viz: SSB-D4 is used with a nominal 4" (100mm) driver.

**RECOMMENDED ADDITIONAL QUAM COMPONENTS**

For acoustical isolation and loudspeaker protection when loudspeaker assembly does not have an integral back-can.

SSB-D4, SSB-D6	QUAM ERD8U, 3-1/2" D
SSB-D8	QUAM ES8-6, 6" D

**IMPORTANT NOTE!**

Contractors are urged to verify enclosure diameter and height of loudspeaker above loudspeaker support deck prior to ordering support or rear enclosure, if required.

Recommended construction sequences, installation instructions and A&E Specifications are available in various formats on the Quam Architects' and Engineers' Resources CD or on the web at: [www.quamspeakers.com](http://www.quamspeakers.com)

**04 BACK BOXES / MOUNTING DEVICES**

**Quam-Nichols Company**

234 East Marquette Road, Chicago, IL 60637  
 Phone: (800) NEED NOW Fax: (888) NEED NOW  
 (800) 633 - 3669 (888) 633 - 3669  
 E-Mail: [neednow@qnc.com](mailto:neednow@qnc.com) [www.quamspeakers.com](http://www.quamspeakers.com)



## SSB-D4, SSB-D6, SSB-D8 Support Bridge for Ceiling Tile Installations, 'Dog-Leg' Mount

### INTENDED USE:

Indoor environment, mounted parallel to floor plane in a 24" wide suspended ceiling tile grid.

### 1. PREPARATION

**ALL MODELS:** Determine that the loudspeaker enclosure will fit completely through the hole in the support- AND the 'Dog-Leg' clamps will rest upon the support bridge when fully deployed.

- PLACE the support bridge on the ceiling tile with the rails spanning the 24" dimension.
- MARK AND CUT circle in ceiling tile, using support bridge as a guide.

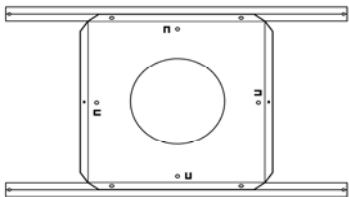

#### ASSEMBLY WITH QUAM ES-8 ( SSB-D8 )

- ALIGN holes in enclosure to holes in support bridge. Use #8-32 screws (not supplied) to attach enclosure to bridge as shown below.
- REMOVE knock-out in enclosure. Run audio feed wire through clamp (not supplied) and make connection to loudspeaker.

Insulate all unused taps from each other, the enclosure and electrical ground.

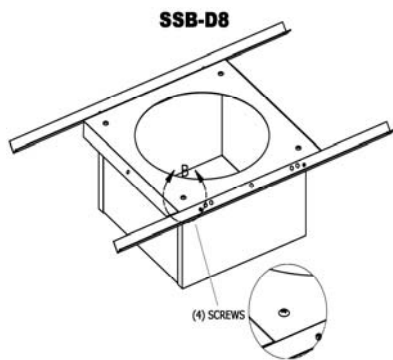

### 2. ASSEMBLY

- PLACE speaker support bridge over ceiling tile. Insert speaker; tighten "dog legs" to grip support bridge and ceiling tile.

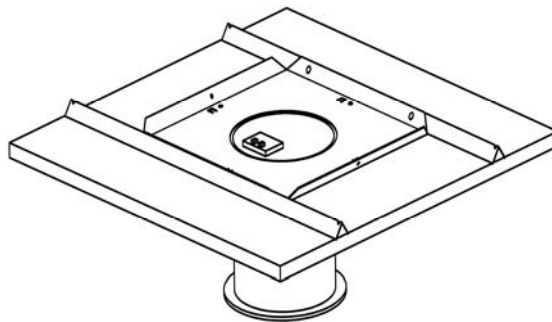

**NOTE!** AHJ/ local codes may require tie-off to structure. Tie-off to support rails using holes provided.

**NOTE!** AHJ/ local codes may require tie-down to grid

Create a hole in the T-bar next to the end of the support rails; secure with wire through the hole in the end of the support rail.

#### 2A. ASSEMBLY WITH QUAM ERD-8/ ERD8U ( SSB-D4 or SSB-D6 ONLY )

- REMOVE knock-out in back-can. Run audio feed wire through clamp (not supplied) and make connection to loudspeaker device.

Insulate all unused taps from each other, the enclosure and electrical ground

- BEND UP (4) horseshoe tabs on bridge. Secure back box to support bridge; insert tabs into appropriate slots in box as shown below. Using pliers, twist 1/4 turn to fasten securely.

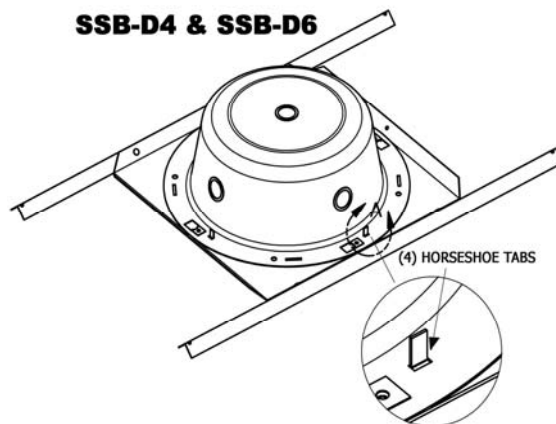

234 East Marquette Road, Chicago, IL 60637  
 Phone: (800) NEED NOW Fax: (888) NEED NOW  
 (800) 633 - 3669 (888) 633 - 3669  
 E-Mail: neednow@qnc.com www.quamspeakers.com

