

# ***SDTV ENG/EFP Professional Lenses***



**A13x6.3B / S13x4.6B RM/ERM\***



## A13x6.3B / S13x4.6B RM/ERM\*



LENS	A13x6.3B RM/ERM*	S13x4.6B RM/ERM*
Zoom Ratio / Format	13X / 2/3"	13X / 1/2"
Focal Length	6.3 to 82 mm	4.6 to 60 mm
Extender	(2X) 12.6 to 164 mm	(2X) 9.2 to 120 mm
Maximum Relative Aperture	F2 (to 61 mm) F2.7 (at 82 mm)	F1.5 (to 45 mm) F2.0 (at 60 mm)
Angular Field	6.3mm 69° 39' x 55° 06'	69° 52' x 55° 18'
4.6mm of View	82mm 6° 06' x 4° 35'	6° 09' x 4° 37'
60mm (Hor. x Vert. in °)	(2X) 12.6mm 38° 30' x 29° 21' 164mm 3° 04' x 2° 18'	(2X) 9.2mm 38° 21' x 29° 15' 120mm 3° 03' x 2° 17'
M.O.D. from Image Plane	0.4 m	0.4 m
Object Area (at Wide)	6.3mm 617mm x 463mm	4.6mm 633mm x 475mm
at M.O.D. (at Tele)	82mm 47mm x 36mm	60mm 49mm x 37mm
(at Wide)	(2X) 12.6mm 309mm x 231mm	(2X) 9.2mm 315mm x 236mm
(at Tele)	164mm 24mm x 18mm	120mm 24mm x 18mm
Filter Size (on Barrel)	ø 82 mm P=0.75	ø 82 mm P=0.75
Weight RM	1.68 kg	1.68 kg
ERM	1.78 kg	1.78 kg
Features	Inner Focus	Inner Focus

### ACCESSORIES: HD & SD ENG/EFP

#### PROFESSIONAL REAR CONTROL KITS

MS-01 Manual Focus/Servo Zoom

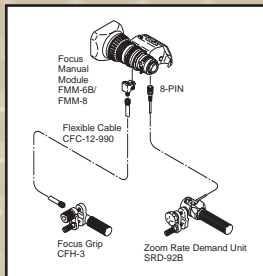

MM-01 Manual Focus/Manual Zoom  
Not available on S16x7.3

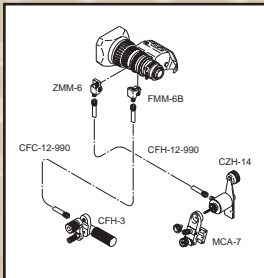

SS-01 Servo Focus/Servo Zoom  
Not available on S16x7.3

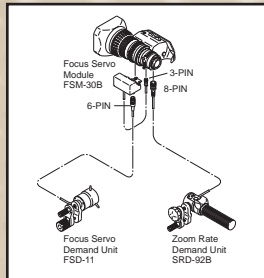

\*Specify camera type.

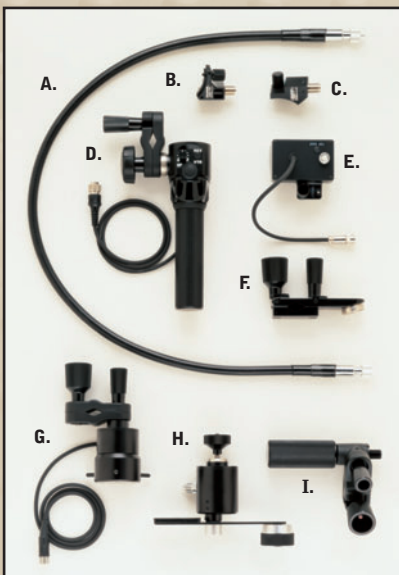

- A. CFC-990 Flex Cable
- B. FMM-6B/FMM-8\* Focus Manual Module
- C. ZMM-6 Zoom Manual Module
- D. SRD-92B Zoom Demand
- E. FSM-30B Focus Servo Module
- F. MCA-7 Mounting Clamp
- G. FSD-11 Focus Demand
- H. CZH-14 Zoom Handle
- I. CFH-3 Focus Handle

\*FMM-8 for use with S16x7.3

### ACCESSORIES: HD & SD ENG/EFP



Wide Attachment (WAT)



Fish-Eye Attachment (F-AT)

### BROADCAST LENS CONVERTERS

Model	Type	ø Size	Converter*	Mag.	Converted Focal Length (mm)	M.O.D. (m)	Weight (kg)
A18x7.6	TELE	85 mm	TCV-85C	1.6x	137.0→219.0	1.54	1.15
ERM/ERD	WIDE	85 mm	WCV-85C/L85	0.8x	7.6→6.1	0.38	1.09/0.57
	WIDE	85 mm	WAT-85C	0.7x	7.6→5.3	-	0.55
	FISHEYE	85 mm	F-AT85C	Approx. 0.55x	-	-	0.62
	RATIO	82 mm	RCV-82SC	0.82x	7.60→6.20	0.40	0.25
A23x7.6	TELE	100 mm	TCV-100C	1.6x	175.0→280.0	2.05	1.06
ERM/ERD	WIDE	100 mm	WCV-100D	0.8x	7.60→6.10	0.51	1.09
	WIDE	100 mm	WAT-100C	0.7x	7.60→5.30	0.39	0.00
	FISHEYE	100 mm	F-ATH100C	0.55x	7.60→4.20	0.24	0.55

### PROFESSIONAL LENS CONVERTERS

Model	Type	ø Size	Converter	Mag.	Converted Focal Length (mm)	M.O.D. (m)	Weight (kg)
A13x6.3	TELE	85 mm	TCV-85C	1.6x	82.0→131.2	1.02	1.15
RM/ERM	WIDE	85 mm	WCV-85C	0.8x	6.3→5.0	0.26	1.09
	WIDE	85 mm	WAT-85C	0.7x	6.3→4.4	-	0.55
	FISHEYE	85 mm	F-AT85C	Approx. 0.55x	-	-	0.62
A20x8.6	TELE	85 mm	TCV-85C	1.6x	172.0→275.2	2.30	1.15
RM/ERM	WIDE	85 mm	WCV-85C/L85	0.8x	8.6→6.9	0.58	1.09/0.57
	WIDE	85 mm	WAT-85C	0.7x	8.6→6.0	-	0.55
	FISHEYE	85 mm	F-AT85C	Approx. 0.55x	-	-	0.62
	RATIO	82 mm	RCV-82SC	0.82x	8.6→7.1	0.61	0.25
S13x4.6	TELE	85 mm	TCV-85C	1.6x	60.0→96.0	1.02	1.03
RM/ERM	WIDE	85 mm	WCV-85C	0.8x	4.6→3.7	0.26	1.09
	WIDE	85 mm	WAT-85C	0.7x	4.6→3.2	-	0.55
	FISHEYE	85 mm	F-AT85C	Approx. 0.55x	-	-	0.62
S17x6.6	TELE	85 mm	TCV-85C	1.6x	114→182.4	2.30	1.15
RM	WIDE	85 mm	WCV-85C	0.8x	6.6→5.3	0.58	1.09
	WIDE	85 mm	WAT-85C	0.7x	6.6→4.6	-	0.55
	FISHEYE	85 mm	F-AT85C	Approx. 0.55x	-	-	0.62
S20x6.4	TELE	85 mm	TCV-85C	1.6x	128.0→204.8	2.30	1.15
RM/ERM	WIDE	85 mm	WCV-85C/L85	0.8x	6.4→5.1	0.58	1.09/0.57
	WIDE	85 mm	WAT-85C	0.7x	6.4→4.5	-	0.55
	FISHEYE	85 mm	F-AT85C	Approx. 0.55x	-	-	0.62

\*TCV/WCV are zoom thru type \*\*ø 95mm P-1 screw on type  
Wide attachment and fisheye attachment can be used at WIDE END.  
Number of M.O.D. is at wide end.