

DESCRIPTION

The MS-900 can make calls to or receive calls from the substation.
It utilizes 2 set of twisted pair cables.

SPECIFICATIONS

Power Source	24 V DC (supplied from the main frame)
Current Consumption	60 mA
Talk System	Duplex or semi-duplex conversation
Talk Frequency	300 - 3,400 Hz
Handset Microphone/Speaker	Dynamic type, 150 Ω
Handsfree Microphone	Electret condenser microphone
Station Speaker	Dynamic type, 8 Ω , ϕ 57 mm, 0.6 W
Key Pad	Membrane switch
Display	12 digits LCD
Auto Dialing Key	8 keys
Station Speaker Volume Control	2-step selection slide switch
Handset Speaker Volume Control	Volume, 0 to +12 dB
Installation Method	Desk-/wall-mountable
Wiring	Twisted pair cables/2-pair
Connection Terminal	Line output: 6-position 4-contact modular jack External speaker output: 2-pin screw terminal (8 Ω /0.6 W)
Operating Temperature	0°C to +40°C
Finish	ABS resin, pale white
Dimensions	216 (W) x 74.5 (H) x 213 (D) mm
Weight	940 g
Accessory	Wall mounting bracket1, Wall mounting screw (wood screw)2, Connection cord (3 m)1

Maximum cable distance

Cable Type	AWG24 (ϕ 0.52 mm)	AWG22 (ϕ 0.65 mm)	AWG20 (ϕ 0.82 mm)
Distance	0.9 km	1.5 km	2.3 km

APPEARANCE

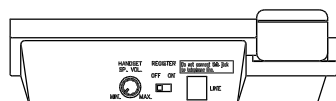

Rear View

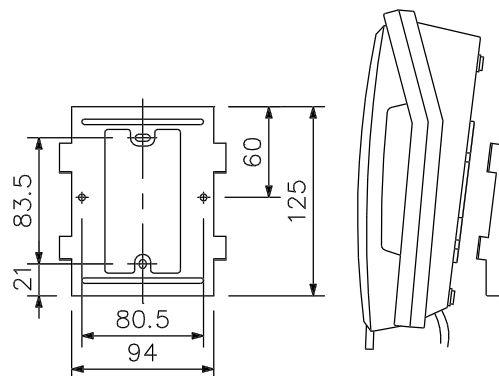

Wall mounting bracket

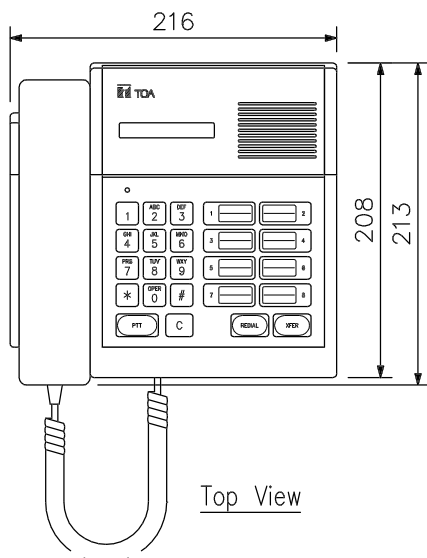

Top View

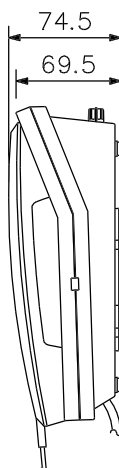

Side View

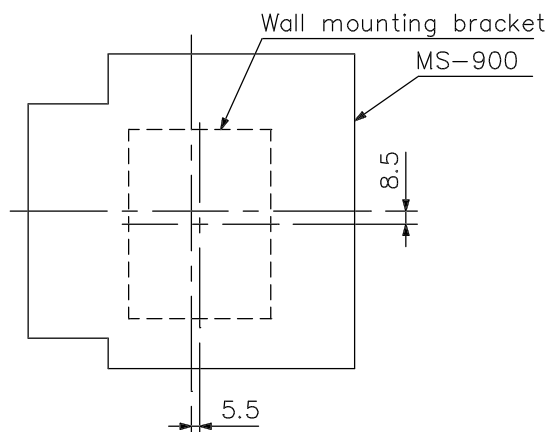

Dimensional diagram for mounting the attached wall mounting bracket.

UNIT:mm SCALE:1/5