

Violet Audio

ADP61

Studio AV Preamp Decoder

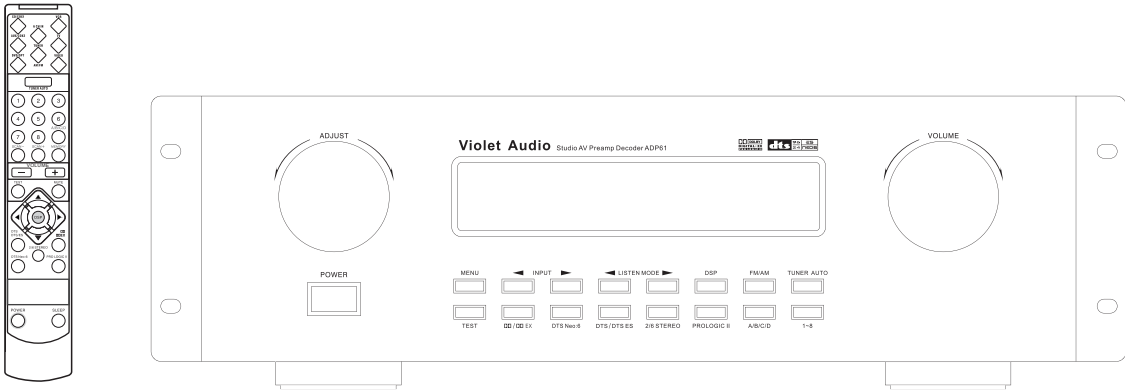

Violet Audio

User's Manual V1.3

incorporates software rev.2

Important Safety Instructions

NOTICE! !

Thank you very much for purchasing our product. We sincerely hope it will bring you much pleasure for many years to come.

In order to enjoy optimum performance from this unit, as well as for matters of personal safety for all concerned, please read this manual carefully.

Also, keep it in a safe place for future reference.



CAUTION
RISK OF SHOCK



CAUTION: To reduce the risk of electric shock, do not remove cover (or back). No user-serviceable parts inside. Please refer all such issues to qualified service personnel.

Explanation of Graphical Symbols



The lightning flash & arrowhead symbol, within an equilateral triangle, is intended to alert you to the presence of danger.



The exclamation point within an equilateral triangle is intended to alert you to the presence of important operating and servicing instructions.

WARNING

To reduce the risk of fire or electric shock, do not expose this unit to rain or moisture.

Voltage:

Voltage are 230/120V AC,50/60Hz.

PLEASE REGISTER YOUR PRODUCT ON

www.violetaudio.com

PLEASE FOLLOW THESE STEPS:

1. Please read all instructions. All the safety and operating instructions should be read carefully before operating this appliance.
2. Store these safety and operating instructions in a safe place for future reference.
3. Please heed all warnings. All warnings issued in this manual exist not only to prevent potential damage to equipment, but also to ensure your personal safety.
4. Follow all instructions. In order to enjoy optimum performance, please follow all instructions and procedures.
5. Do not use this apparatus near water.
6. Remove any dust by using dry cloth or brush. If more thorough cleaning is necessary, use damp cloth (*in this event, please disconnect unit from AC outlet*).
7. Do not block ventilation openings. Proper airflow is essential for optimum operation.
8. Keep unit away from heat sources such as radiators, stoves, ovens, heating ducts and devices (including amplifiers) that can potentially produce heat.
9. Do not tamper with the AC (power) lead. If the plug provided does not fit your power outlet, consult qualified service personnel or electrician for a suitable solution. Also, never use a damaged AC lead, for any purpose!
10. Take measures to protect AC power lead from being walked on, crushed, twisted, cut or pinched. Exposed core is highly dangerous if plugged into AC outlet.
11. Only use attachments and accessories as specified by the manufacturer. Never force connectors!
12. Avoid over-stacking equipment. Stacking more than two units can become unsafe for equipment and operator alike. Use only with a cart, stand, mounting brackets or table specified by your supplier, or specifically sold with the apparatus. Please secure firmly if using a trolley or cart.



Continues overleaf

Important Safety Instructions

13. Unplug receiver during lightning storms or if unused for long periods of time.

14. All servicing issues should be referred on to qualified personnel, especially should the apparatus not operate in a normal manner. It is also highly recommended should the unit be exposed to rain or be subjected to liquid spills, objects falling inside or suffer physical damage to chassis, power-supply cord or plug.

15. Cleaning - Unplug this unit from the wall outlet before cleaning. Do not apply spray, aerosols or liquid cleaners directly onto chassis. If necessary, use only a slightly damp cloth.

16. External antenna - if used with an external antenna, take care to locate the antenna away from power lines.

17. Accidental object and liquid entry - Care should be taken so as to prevent foreign objects or liquids entering the enclosure. Should this occur, detach power cord immediately and refer unit to qualified service personnel. Do not attempt to power up again until approved by said personnel.

18. If you have any doubts as to the safe operation or optimum performance of this unit, please consult your retailer or qualified service personnel.

Setup and Maintenance of the Receiver

- To prevent overheating, please provide sufficient ventilation.
- Do not connect to the AC outlet until all other connections have been completed.
- Do not use your receiver immediately after transferring it from a cold environment to warm. This action may result in a build up of condensation inside the unit.
- Do not expose your receiver to water or excessively high temperatures.
- After having disconnected your receiver, clean the case with a soft cloth, or with a slightly damp leather chamois. Never use strong solvents.
- Should connectors show build up of contaminants over a period of time, in order to ensure optimum performance, clean contacts with appropriate cleaning agents. Consult your dealer or qualified service personnel

Protect Your Receiver From Overheating

- Do not block any ventilation holes or cover unit with materials that impede air flow, such as other equipment, cartons and fabrics etc. Arrange the receiver so that air can circulate freely.
- If stacking is absolutely necessary, please allow for proper air flow between units.
- If mounting on a stand or into a 19" EIU equipment rack, please provide adequate ventilation and spacing with adjacent units.
- Place high heat emitting devices such as power-amplifiers and satellite receivers away from receiver and other sensitive components.

Table of Content

Table of Content	3	Advanced Sound Control	30
Features	4	About the Listening Modes	30
Getting Started ADP61	5	2 Stereo	30
Fittings	5	6 Stereo	30
Installing batteries in the remote controller	6	Dolby Pro Logic II Movie	30
Notes About the Remote Control	6	Dolby Pro Logic II Music	30
Remote control operation range	6	Dolby Digital	30
Connecting to Audio-Visual Components	7	Dolby Digital SurroundEX	30
Digital Connections	8	DTS	31
Connecting the Antenna	9	DTS 96/24	31
AM Loop Antenna and FM Indoor Antenna	9	DTS-ES Discrete	31
Connecting for Power	9	DTS-ES Matrix	31
Connecting Power Amplifiers		Neo:6	31
or Powered Speakers	10	Sound Enhancement Systems	32
Positioning your speakers	11	Dolby Pro Logic	32
Preferred surround placement	12	Dolby Digital and Dolby Digital Surround EX	32
Alternative Surround Placement	12	DTS Neo:6	32
Operating Your ADP61	11	DTS/DTS ES	33
Panel introduction	11	DTS 96/24	33
The Remote Control	13	2/6 Channel Stereo	33
Remote Control Functions	14	DSP(Digital Sound Field Processor)	33
Rear Panel Introduction	15	Adjusting the DTS, Dolby Digital LFE Level	34
Display	17	Dynamic Range(Night Mode)	34
Default Window Display Information	17	Adjusting the Delay Time	35
Power on / off / standby	18	Adjusting the Parameter Settings for Pro	
Last State Memory	18	logic II MUSIC	35
Tone Adjustment	18	Troubleshooting	36
Speaker Settings (Speaker Mode)	19	General	36
Output Level Adjustment	22	Tuner	39
Speaker Level Calibration	24	Remote Control	39
Input Source Selection	25	Other	40
Input Source Reference Level Adjustment	25	Resetting Factory Presets	40
Synchro Audio/Video Sources	25	Abbreviation of the monitor and full	
Sleep Function	26	working name	40
Display Brightness Adjustment	26	Available Selection All Listening Modes	40
Audio Format Recognition	26	Specifications	41
Listen Mode Display	26		
Tuner Functions	27		
Tuner Memory Operation	28		
Retrieving Preset Stations	29		
25-pin D-SUB Input	29		

Main Features:

- Automatic Audio Format Recognition
- Source Format Display
- Bass Management system, Full Digital
- Sub-woofer x-over trim pot (50hz - 150hz)
- Adjustable Reference Level for each individual input section (0db to -15db)
- Pink Noise Generator for line and speaker test
- Treble & Bass trim pots (for FL & FR channels only)
- Digital AM/FM tuner
- 64 Auto Memory Presets (AM/FM separate)
- Quartz PLL Synthesized Digital Tuning system
- Manual Tuning
- Sleep Timer
- Last State Memory, including routing, DSP and decode settings
- Fully functional remote control
- Remote control standby
- 7 balanced XLR outputs
- 7 individual output level and on/off controls
- 2 XLR balanced inputs with pad switch (+4db, 0db & -10db)
- 1 analog stereo line output (pre volume-control)
- 1 digital optical input via TosLink
- 1 digital coaxial input
- 1 AES/EBU input via XLR
- 4 S-video inputs, 1 S-video output
- 4 composite video inputs
- 1 composite video out
- 25-pin D-sub input connector (6-channels +4db bal.)



Manufactured under license from Dolby Laboratories.
"Dolby", "Pro Logic", "Surround EX" and the double-D symbol are trademarks of Dolby Laboratories.

Other Features

Digital Sound-field Processing multi-mode

- Dolby Digital Decoder
- DTS Decoder
- Dolby Digital Surround EX Decoder
- DTS 96/24 Decoder
- DTS ES Discrete Decoder
- DTS-ES Matrix Decoder
- DTS Neo:6 Cinema
- DTS Neo:6 Music
- Dolby Pro Logic II Movie
- Dolby Pro Logic II Music
- 6 CH Stereo Mode
- 2 CH Stereo Bypass Mode
- 8 DSP modes: Live, Cinema, Disco, Stadium, Jazz, Church, Hall & Pro Logic

Enhanced Audio Features

Up to 24-bit/192khz playback via digital inputs
High-resolution D/A converters
DSP effects, including surround (see DSP modes above)
Operation from front panel or IR remote control
Adjustable sub woofer x-over frequency
Adjustable Reference Volume for each input section (0-15db)



DTS, and DTS ES ,Neo:6 and DTS 96/24 are trademarks of Digital Theater Systems, Inc.

Installing batteries in the remote controller

Since the remote control will be used for many of this unit's control operations, you should begin by installing the supplied batteries.

1. Turn the remote control over and slide the battery compartment cover in the direction of the arrow.
2. Insert the batteries(AAA,R03P,UM-4 TYPE) according to the polarity markings on the inside of the battery compartment.
3. Close the battery compartment cover.

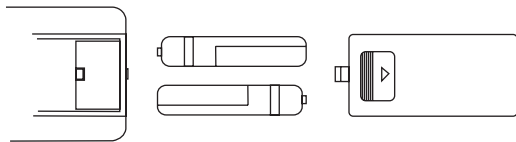

Notes About the Remote Control

Battery Replacement

Should you find the remote controls response gradually decreasing in range, the batteries are most probably reaching the end of their life. Replace both batteries with new ones, preferably of matching brand and type.

Notes

- Use AAA,R3P,UM-4 batteries.
- Be sure the batteries are correctly oriented according to polarity. (See the illustration inside the battery compartment.)
- Remove the batteries if the remote control is not used for an extended period of time.
- Should any battery leak, dispose of it immediately. Avoid physical contact of leaked material with skin or clothing etc. Clean compartment thoroughly before installing new batteries. If in doubt, consult your dealer or service personnel.
- Never dispose of batteries in a furnace or open fire. Exposure to extreme heat or fire may result in an explosion and cause possible injury!

Remote Control Operation Range

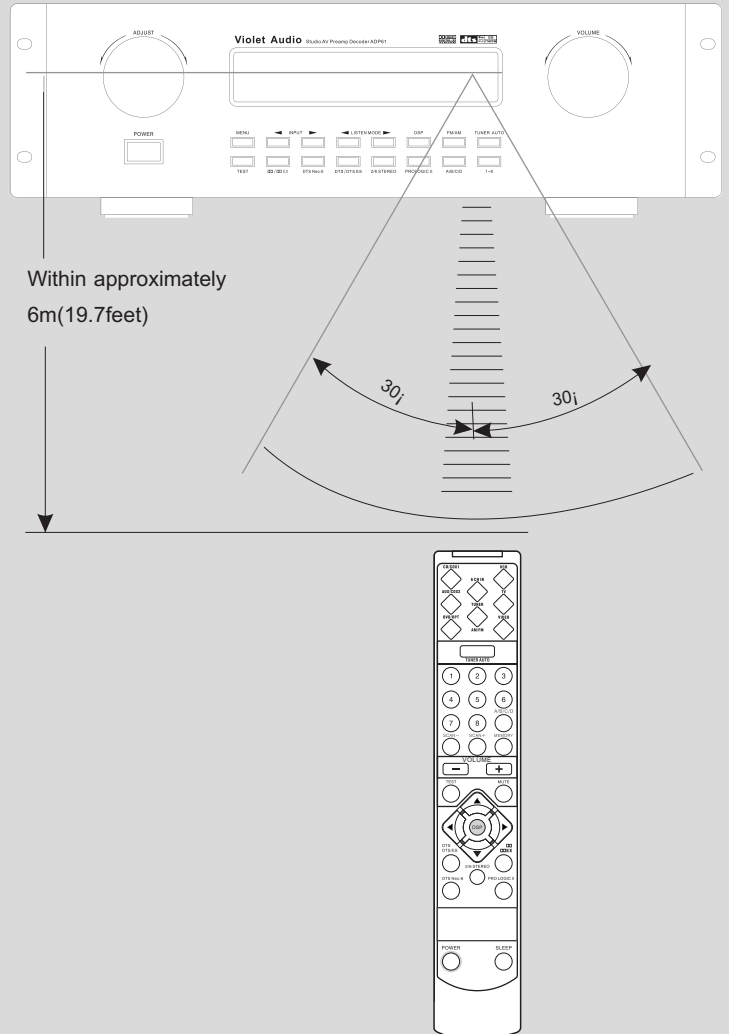

Notes

- The area between the remote control and the main unit must be clear of large obstacles.
- Do not expose the remote control sensor to strong lighting, in particular an inverter type fluorescent lamp. Otherwise, the remote control may not work properly. If necessary, position the main unit away from direct lighting.

Getting Started ADP61

Connecting to Audio-Visual Components

If your video component has a S-Video output connection, you can enjoy enhanced video quality by connecting it to one of the S-Video input sockets on the rear panel of the ADP-61.
 Note: Before plugging in any optical or S-Video cable, make sure the shape or pin configuration of the plug and socket match. Be careful not to apply excessive force when making a connection!

If you have a LD player, DVD player or CD player with a digital output, you can make use of an optical digital cable (not supplied) or coaxial digital cable (not supplied) to carry the audio portion of the signal and enjoy Dolby Digital sound quality.
 One optical or coaxial cable is needed for each LD player, DVD player or CD player. This receiver provides one optical, one coaxial and one XLR digital input for the connection of your components. Please connect your components (e.g. LD, DVD, or CD) to the appropriate digital inputs and press INPUT button to select your connection.
 Note:
 Optical and coax cables carry only the audio portion of the signal. A separate video connection must also be established for a LD player and DVD player. S-video provides the best connection for the video portion of the signal. Composite video (yellow RCA connector) can also be used. It is important to use the same connection type (S-video or composite) to connect the LD or DVD player to the ADP-61 and then from the ADP-61 to the TV, LCD or Plasma display.

Connect components capable of outputting Dolby Digital (e.g. DVD or LD) or standard PCM(CD) format digital signals. Read section on "Digital Connections" under "Getting Started".

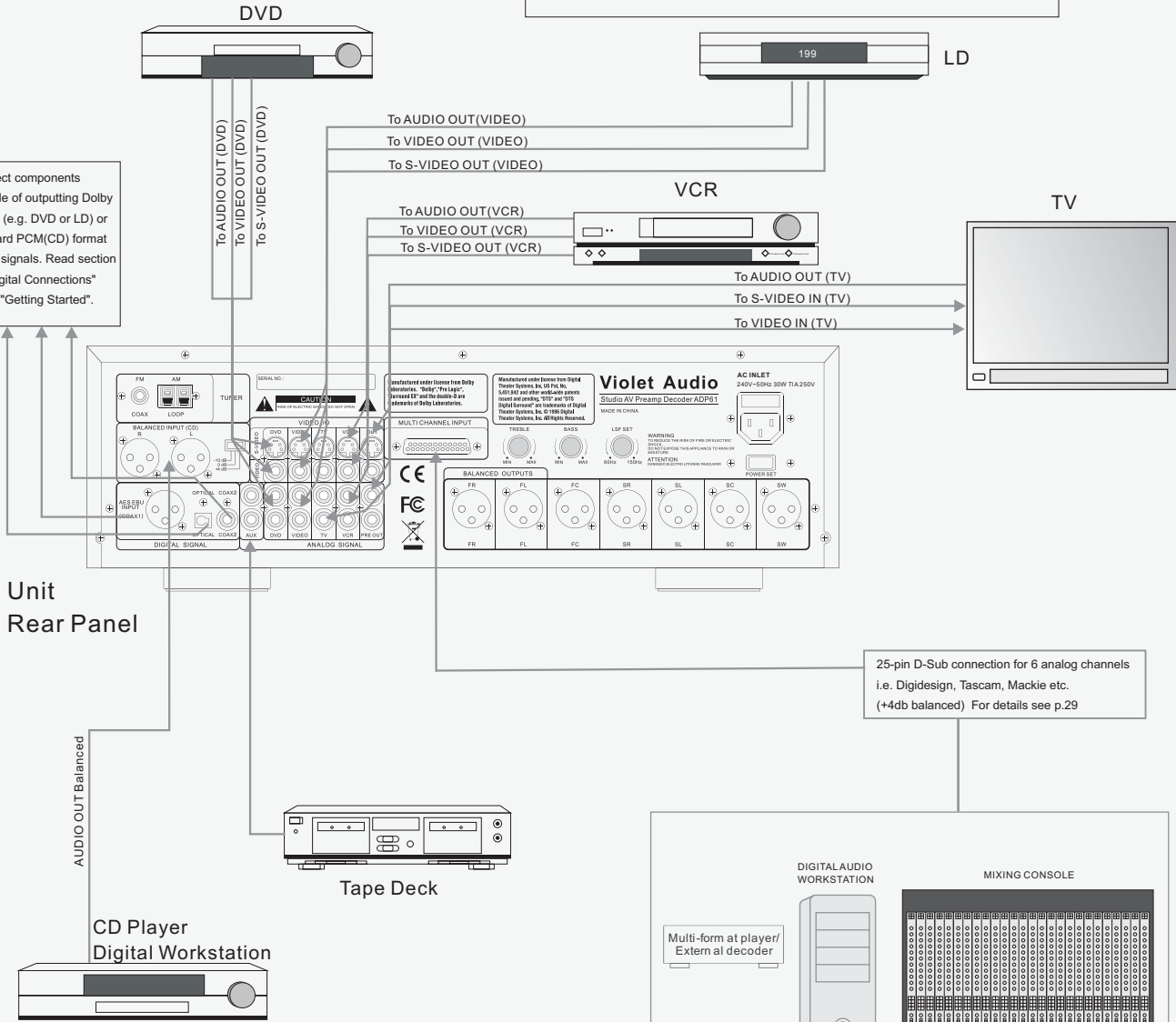

Unit Rear Panel

25-pin D-Sub connection for 6 analog channels i.e. Digidesign, Tascam, Mackie etc. (+4db balanced) For details see p.29

If your CD or DVD player is equipped with digital output jacks, you can enjoy superior sound quality by making use of them.
 S/PDIF Digital connections are possible via either a TOSLINK optical or a 75ohm co-axial cable with RCA connectors. For a AES/EBU connection, a 105ohm digital XLR cable is required.
 Once connected, simply select either Coax-1, Coax-2 or OPTICAL input for each connection.
 Note: This receiver only has one of each digital input type. You may have to use the optical for one unit, while using the co-axial connection for another.
 Also note: Digital cable quality will affect performance. To minimize jitter and other artifacts, only use good quality, well shielded digital cables.

Digital Connections

If your CD, LD, DVD, TV/satellite tuner or DAW etc, are equipped with either coaxial, optical or AES/EBU XLR digital output terminals, you can take advantage of this sonically superior connectivity by utilizing the corresponding input sockets on the ADP61's rear panel

Digital audio signals are not prone to the same type of signal loss and distortion factors as observed with typical analog connections. Digital connections are especially recommended when decoding multi-channel surround information, such as **Dolby Digital** and **DTS** from **LD, DVD, CD** players, and other digital sources.

To make an optical digital connection between this unit and an

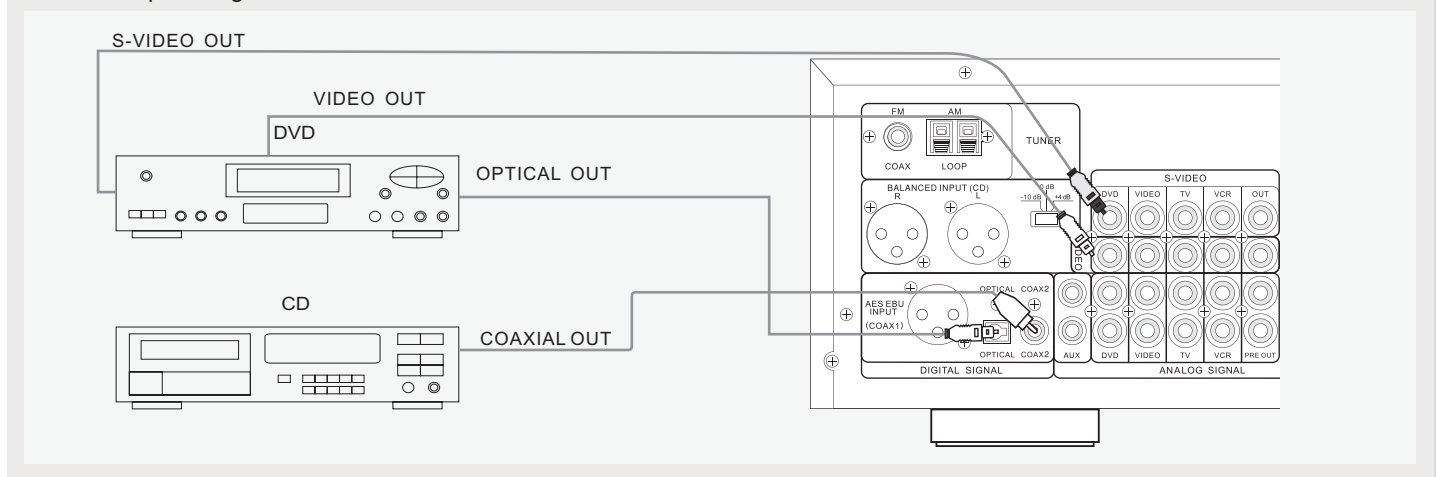

Notes

- When hooking up an A/V unit, such as a VCR, make sure to connect to all necessary terminals to the same name, i.e. S-video or composite video as well as the 2xRCA analog to all relevant sockets labelled "**VCR**". The digital terminals also correlate with certain video sockets (see **HINT** in next column)
- Be sure to attach the dust covers when the OPTICAL terminals are not being used. This prevents contamination by dust etc.
- For accurate DTS-decoding, the DTS bitstream integrity must never become compromised. Incorrect or poor quality cables and connectors can corrupt the bitstream and degrade performance.
- In order to prevent digital errors and enjoy optimal performance, please use dedicated, good quality digital cables.
- For S/PDIF: 70ohm digital co-axial or TosLink optical. For AES/EBU: 110ohm balanced digital co-axial cable.
- All digital audio signal input terminals accept the following sample rate frequencies: 32 kHz, 44.1kHz, 48kHz, 96kHz & 192kHz.
- Quality of digital cables and connectors do have a bearing on sound quality and performance. Keep cable lengths to a minimum.

external unit, remove the cover from each optical terminal, and then connect them by using a commercially available optical fiber cable that conforms to EIAJ standards. Other cables might not function correctly.

Even if you connect an audio/video unit to the OPTICAL (or COAXIAL) terminal of this unit, you must keep the unit connected with the same named analog audio signal terminals of this unit, because digital signal cannot be recorded by a tape deck or VCR connected to this unit. You can switch the selection of input signals between digital and analog easily.

HINT

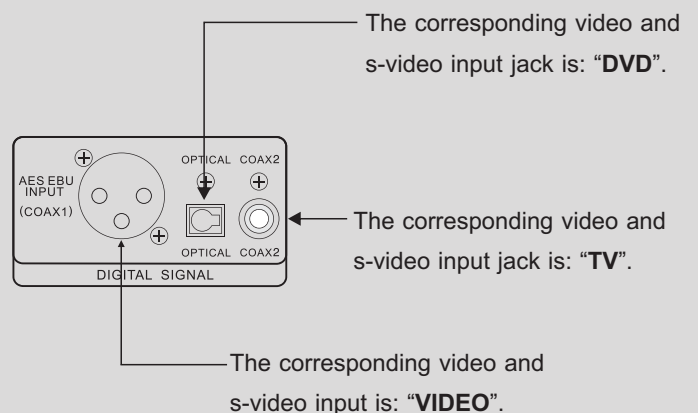

Getting Started ADP61

Connecting the Antenna

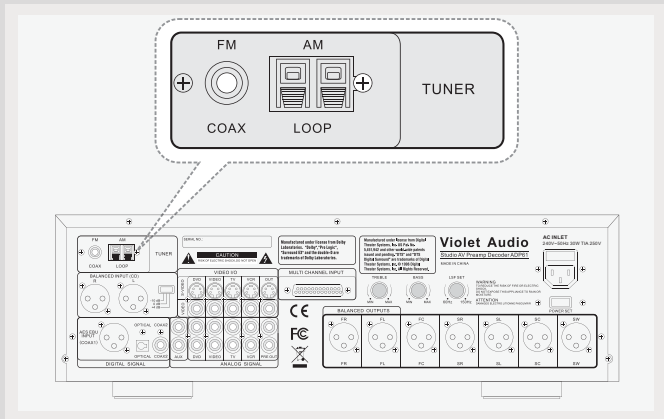

The AM and FM antennae connect to the top left section of the rear panel of the ADP-61.

They must be hooked up in order to receive clear reception.

AM Loop Antenna and FM Indoor Antenna

1. Uncoil the Antenna wire.
2. Press down on the Antenna tab to open the terminal.

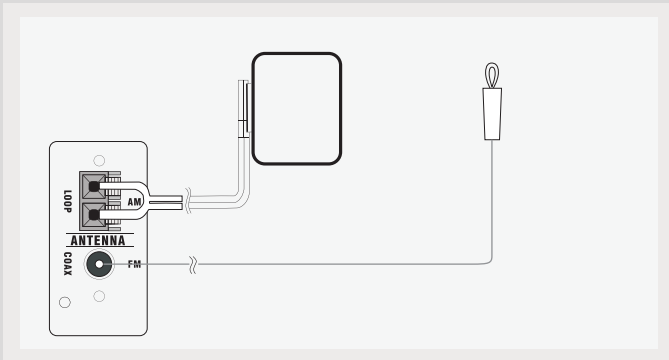

HINT

- For best FM reception, extend antenna to its full length and position at highest possible elevation.
- For AM, rotate the antenna horizontally for optimum reception.

AM Antenna wire Connection

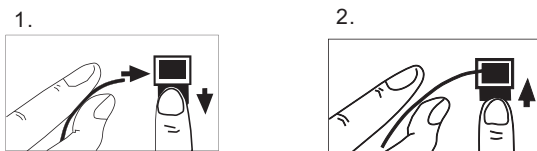

Connecting for Power

Make sure you connect up all your other electronic components and the speakers before plugging your receiver into the outlet. Plug the power cord in the wall outlet, matching the wide blades of the plug with the wide slots of the outlet. Be sure to insert the plug completely.

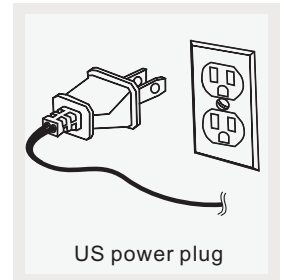

US power plug

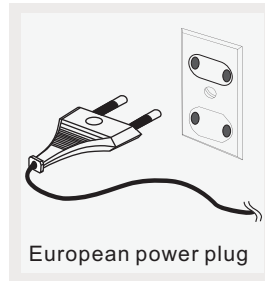

European power plug

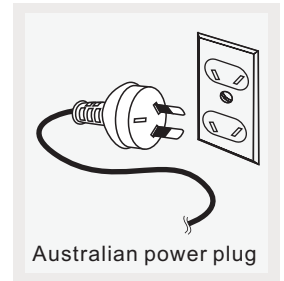

Australian power plug

Notes:

- Do not play audio at a high volume. Hearing experts advise against continuous extended play.
- If you experience a ringing in your ears, reduce volume or discontinue use.
- Always turn down the volume before connecting your speakers.

Connecting Power Amplifiers.

If you are using Powered Speakers, simply connect directly to ADP61 corresponding XLR outputs

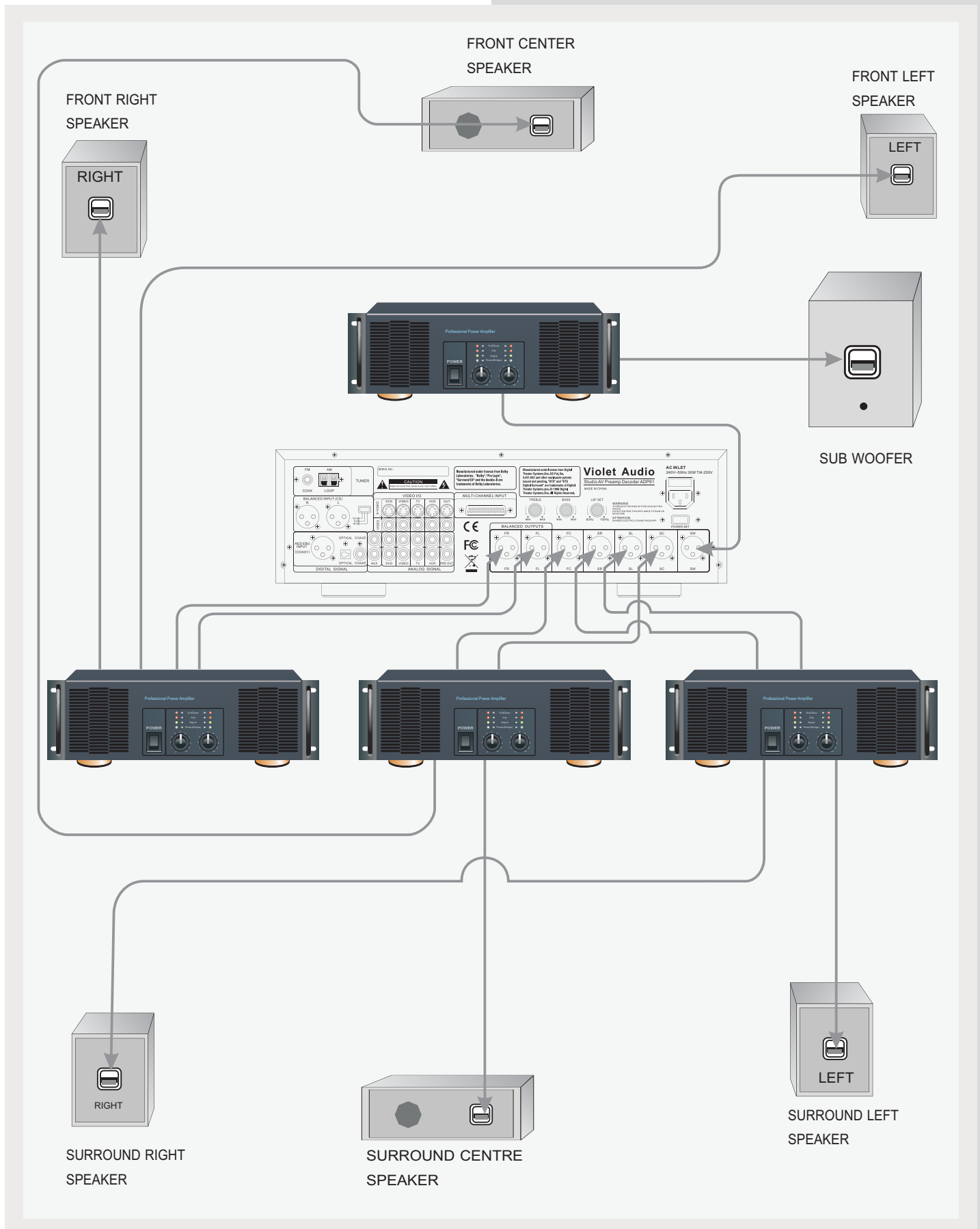

Operating Your ADP61

Panel Introduction

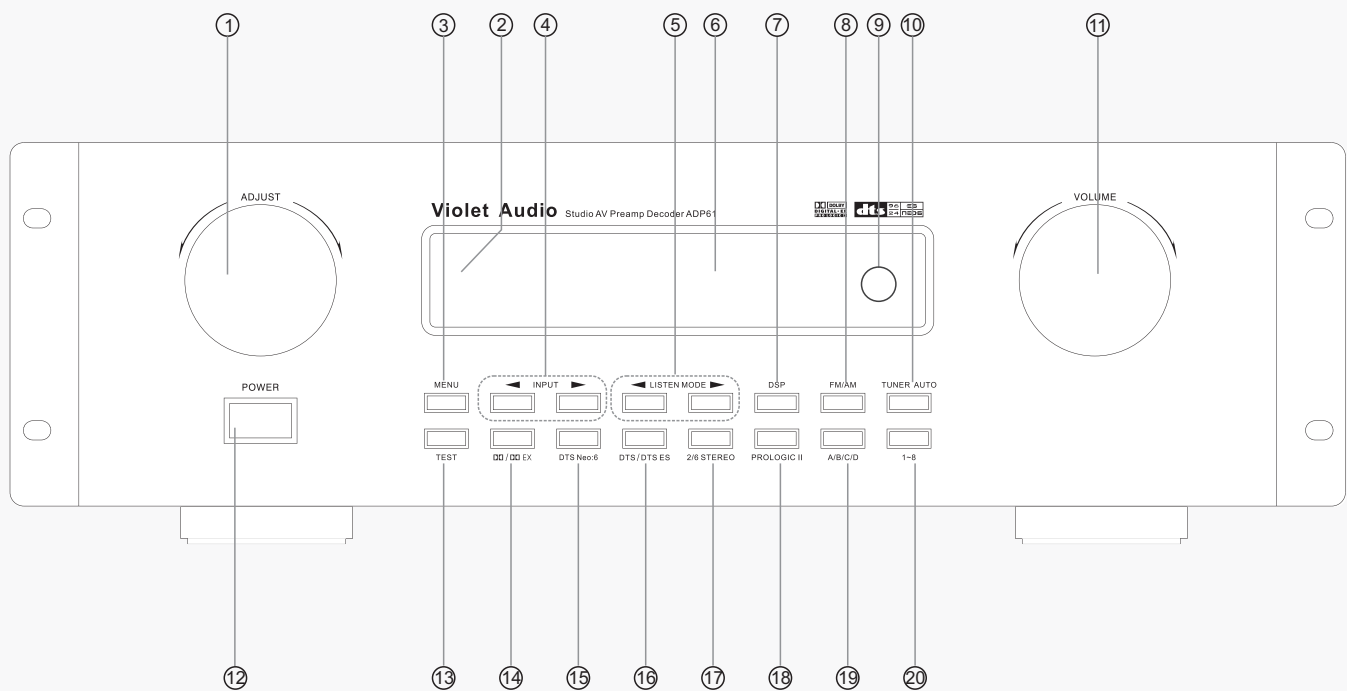

1. ADJUST

This control enables you to adjust individual parameter values, with the exception of the master volume.

Note:

Default parameter is **REF** (Reference Level for currently selected input).

2. Standby indicator

Lights up when unit is in standby mode.

3. MENU selector button

Press the button repeatedly to scroll through the parameter MENU of the current output mode. Use the "ADJUST" knob to edit parameter value.

4. INPUT selector

Enables the selection of input sources.

5. LISTEN MODE

Enables the selection of preferred output modes.

Note:

Dolby Digital and DTS modes only available when receiving from external digital source. I.e. DVD player etc.

6. Display window

Displays a variety of information. e.g. Volume levels, DSP, currently active input source, listening mode and individual parameter values etc.

7. DSP mode

Selects between eight artificial acoustic surround environments: Live, Cinema, Disco, Stadium, Jazz, Church, Hall and ProLogic.

8. FM/AM

Selects either the FM or AM radio bands.

9. Remote control sensor

Receives signals from the remote control.

10. TUNER AUTO automatic radio tuning button

Hold down the button for more than 3 seconds to start automatic preset tuning (*AM/FM have separate memory banks*).

11. Master VOLUME control

Simultaneously controls volume for all output sounds; Front,

Surround, Center, Subwoofer.

Clockwise rotation increases volume, while anti-clockwise reduces it.

12. POWER switch

Press this switch to turn on the power. Press the switch again to turn off. *Note: Power ON defaults to Standby mode.*

13. TEST

Sends Pink Noise test tone sequentially to each analog output.

This enables you to balance output channel levels as well as test your amplifier and speaker connections.

Also performs **Reset** function. See page 40 "Resetting Factory Presets".

14. Dolby Digital & Dolby Digital Surround EX mode

Selection button.

Note:

Input sources must be Dolby Digital or Dolby Digital Surround EX-encoded.

15. DTS Neo:6 Cinema/Music mode selection button

16. DTS & DTS ES mode selection button.

Note: Input sources must be DTS or DTS ES-encoded.

17. 2/6 STEREO

Selects playback of standard 2-channel stereo mode (BYPASS) or splits signal into 6 channels (3 x stereo)

18. PROLOGIC II.

Select between Cinema and Music mode for surround enhancement of stereo source or decoding of Dolby encoded video tape or LD.

19. A/B/C/D

Selects one of the 4 preset station groups (A to D) when the unit is in tuner mode.

20. Number 1-8 button

Press these buttons to select preset tuning channel.

Operating Your ADP61

Your Remote Control

Please be sure you have inserted the batteries into the remote control.

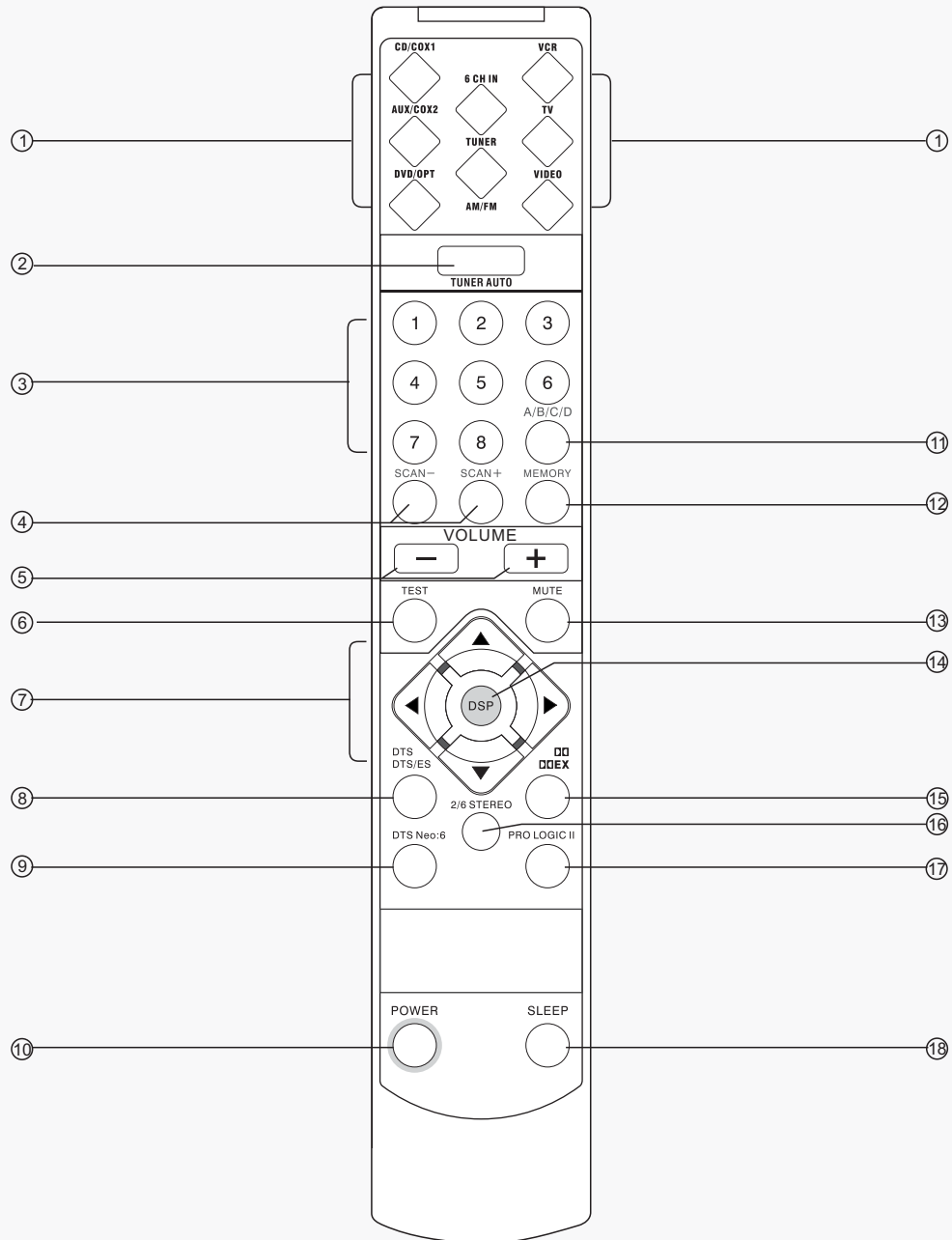

Remote Control Function

1. Input selector section

Selects the input source you want to listen to or watch.

2. TUNER automatically tuning button

Hold down the button for more than 3 seconds to start automatic preset tuning (AM/FM is detached).

3. Numerical keypad (from 1-8)

Press these buttons to select preset tuning channel.

4. Tuning scan buttons

Press the SCAN+ side to tune in to a higher Frequency.
Press the SCAN- side to tune in to a lower frequency. Press and hold for two seconds to scan automatically.

5. Master volume

Controls the level of all seven XLR output channels.

6. TEST

Activates Pink Noise test tones to each output sequentially.

7. SET MAIN MENU button

Press these buttons to turn the unit into the SET MAIN MENU mode.

Scroll to the desired parameter by using the L or R buttons, then press the + or - buttons to adjust value.

8. DTS & DTS ES mode selection button

Note:

Input sources must be DTS or DTS ES-encoded.

9. DTS Neo:6 Cinema/Music mode selection button

10. POWER

Alternates between Power On and Standby Mode.
For this button to function, first make sure the POWER switch is depressed on the ADP-61's main panel and that the red standby light is on.

11. A/B/C/D

Selects one of the 4 preset station groups (A to D), when the unit is in tuner mode.

12. Stores a station in the memory

13. MUTE

Mutes the sound. Press again to restore the audio out to the previous volume level.

14. DSP mode selection button

Eight DSP modes: Live, Cinema, Disco, Stadium, Jazz, Church, Hall, and ProLogic.

15. Dolby Digital & Dolby Digital Surround EX mode selection button

Note: Input sources must be Dolby digital or Dolby Digital Surround EX-encoded.

16. 2 channels stereo mode & 6 channels stereo mode selection button

17. Dolby Pro logic II Movie/Music mode selection button

18. SLEEP button

Sets the sleep time: 10min, 20min, 30min, 40min, 50min, 60min, 70min, 80min, 90min, 100min, 110min, 120min.

Operating Your ADP61

Rear Panel Introduction (note.. Current model has Treble and Bass Control on the rear Panel)

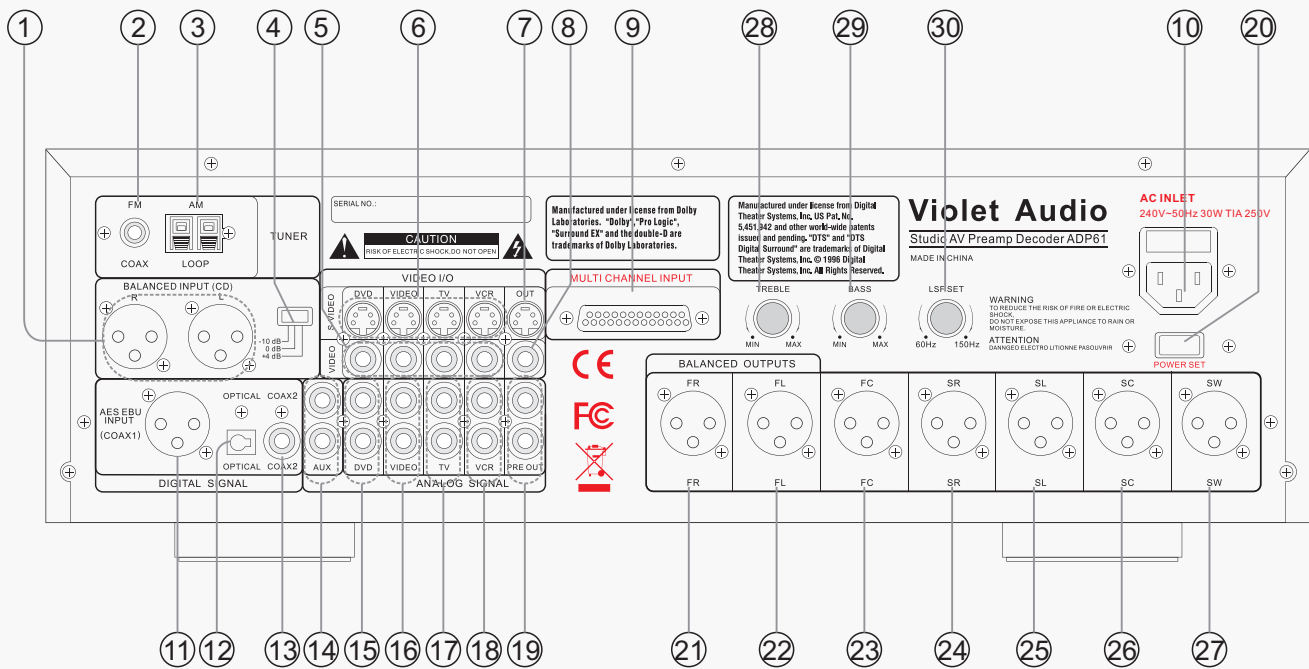

1. CD or DAW Balanced input jacks

2. FM antenna input

3. AM antenna input

4. CD input gain switch

5. Video input jacks

Note: using corresponding analog audio jack.

6. S-Video input jacks

Note: using corresponding analog audio jack.

7. S-Video output jack

8. Video output jack

9. 25-pin D-sub balanced 6-channel input

10. AC ~220/240V 50/60Hz power input plug

11. Digital AES/EBU. XLR input jack

Note:

- Corresponds with the VIDEO input socket group, including Composite Video and S-Video.

12. Digital coaxial input jack

Note:

- Corresponds with the TV input socket group, including Composite Video and S-Video.

13. Digital optical input jack

Note:

- Corresponds with the DVD input socket group, including Composite Video and S-Video.

14. AUX Analog Audio input jacks

15. DVD Analog Audio input jacks

16. VIDEO Analog Audio input jacks

17. TV Analog Audio input jacks

18. VCR Analog Audio input jacks

19. PRE Analog Audio output jacks

20. Voltage: AC 230V 50/60Hz AC 115V 50/60Hz

21. Front Right Balanced output

22. Front Left Balanced output

23. Front Center Balanced output

24. Surround Right Balanced output

25. Surround Left Balanced output

26. Surround Center Balanced output

27. Subwoofer Balanced output

28. TREBLE control

Affects only Front Left and Front Right outputs

29. BASS control

Affects only Front Left and Front Right outputs

30. LSF SET

Adjusts the low-pass frequency point for the sub-woofer channel. Adjustable from 50Hz to 150Hz

Operating Your ADP61

Display

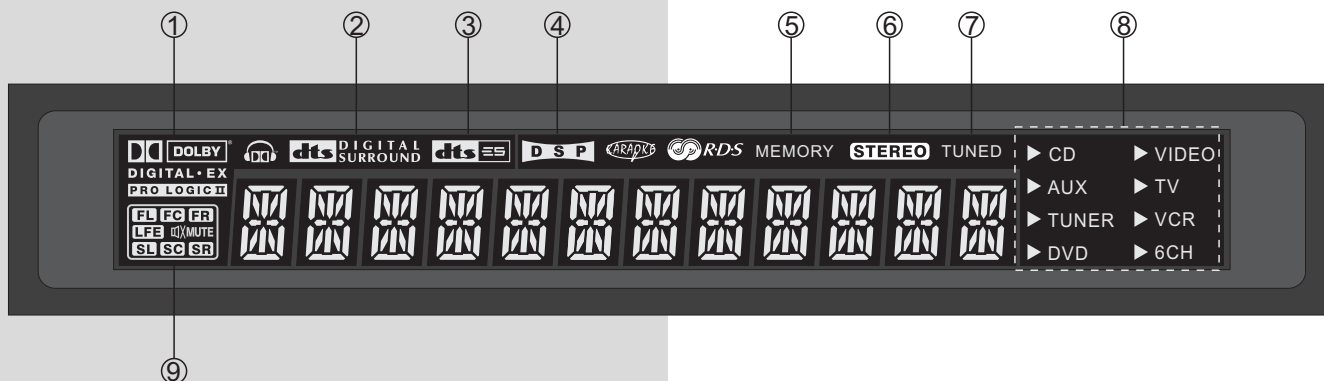

1. DOLBY DIGITAL/DIGITAL.EX/PRO LOGIC II

Lights up when a Dolby Digital signal is received.
Lights up when a Dolby Digital EX signal is received.
Lights up when Dolby Pro logic II mode is selected.

2. DTS DIGITAL SURROUND

Lights up when a DTS signal is received.

3. DTS ES

Lights up when a DTS ES signal is received.

4. DSP

Lights up when DSP mode has been activated.

5. MEMORY

Blinks to show that a station can be stored.

6. STEREO

lights up when a sufficiently strong FM stereo broadcast signal is received.

7. TUNED

Lights up to indicate correct tuning to a station.

8. INPUT SOURCE INDICATOR

Shows which input source is currently active.

9. Speaker Configuration Indicator

Shows all currently active speaker outputs.

FL:Front Left channel

FC:Front Center channel

FR:Front Right channel

LFE:Subwoofer channel

SL:Surround left channel

SC:Surround center channel

SR:Surround right channel

MUTE: Blinks when the MUTE function is on.

Default window display information (software rev.2 only)

1. Current output configuration
2. Currently selected input source
3. Input source Reference Level
4. Master Volume setting
5. Additional input selection options

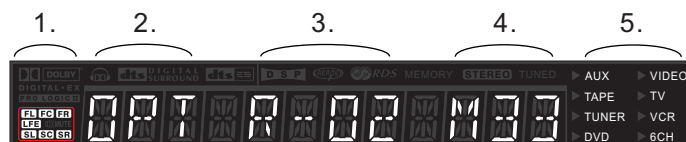

During typical operation, once a function has been selected or a parameter value changed, the display window will automatically revert to this default display mode after 5 seconds.

Switching On / Off

In order to get started, we need to be in Standby mode. For this to happen, make sure the POWER switch on the panel is pressed in. A red indicator light will confirm Standby mode on the display panel.

Now, either press any of the 16 buttons on the front panel of the ADP61 or the STANDBY button on the remote control. You should now see the message VIOLET AUDIO scroll by.

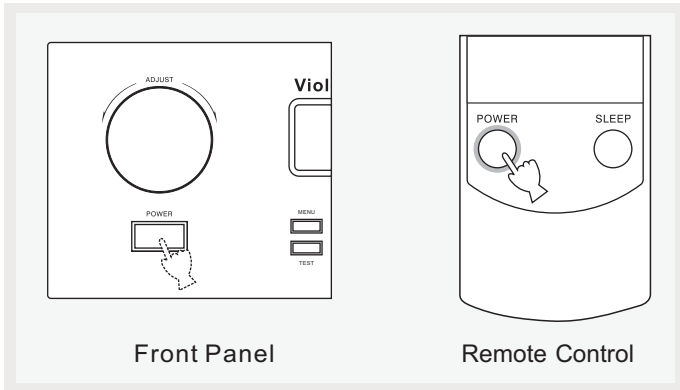

The next state will display similar to this:



For more information, see p.17
(Default Window Display Information)

To go return to STANDBY mode: simply press the STANDBY button on the bottom left of the remote control.

NOTES:

1. Standby mode can only be activated by remote control.
2. Standby mode consumes a small amount of power in order to receive power ON command from infrared remote control.

POWER DOWN: To turn unit off completely, simply press the POWER switch on unit front panel. This will also defeat the Standby mode. Unit can only then be powered up again by first depressing the POWER switch on the front panel.

Last State Memory

The ADP-61 features a **Last State Memory** function. This means that when powering up, all selections and settings from the previous session will be restored. The exception being volume settings above 40db

To Adjust the Tone

Basic equalisation control. Affects only Front Left & Right output channels

Adjust High-frequency level

Turn the TREBLE knob on the panel to adjust high-frequency level. The indented middle position denotes a flat curve, or 0db boost/cut.

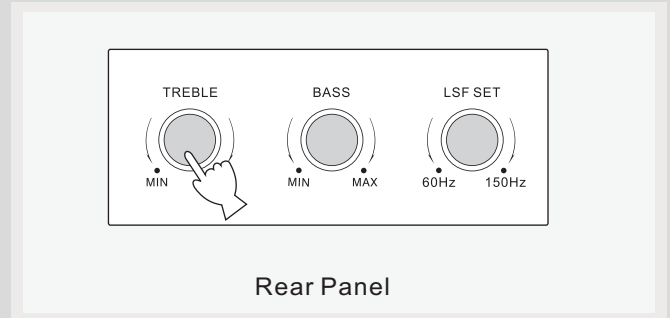

Adjust Low-frequency Level

Turn the BASS knob on the panel to adjust high-frequency level. The indented middle position denotes a flat curve, or 0db boost/cut.

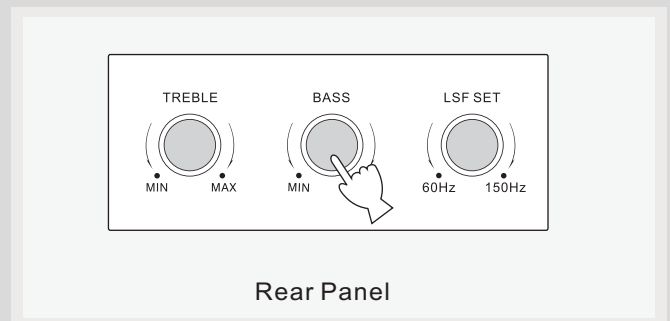

Subwoofer frequency

Set the desired low-pass frequency threshold with the LSF SET knob. Range: 60~150Hz. (Lucasfilm THX specification is 80Hz).

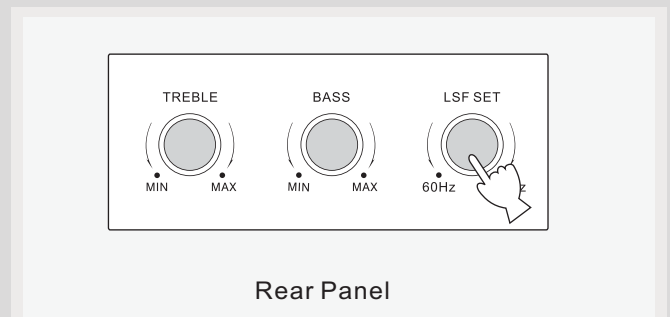

Operating Your ADP61

Speaker Setting(Speaker Mode Settings)

Use this feature to select suitable output modes for your speaker configuration.

1.Main Speakers

Use the MENU button on the panel or the Left and Right ◀ or ▶ buttons on the remote to select "M SPEAK ",and turn the ADJUST knob on the panel or use the Up and Down ▲ or ▼ buttons on the remote to select position.

Choices:LARGE,SMALL.

Initial setting:LARGE.

LARGE:If your main speakers have a high ability for bass reproduction. In this position, full range signals present at the main channels are output from the main speakers.

SMALL: If your main speakers do not have a high ability for bass reproduction. However, if your system does not include a subwoofer,do not select this position.In this position,low bass signals are output from the subwoofer speaker(100Hz).

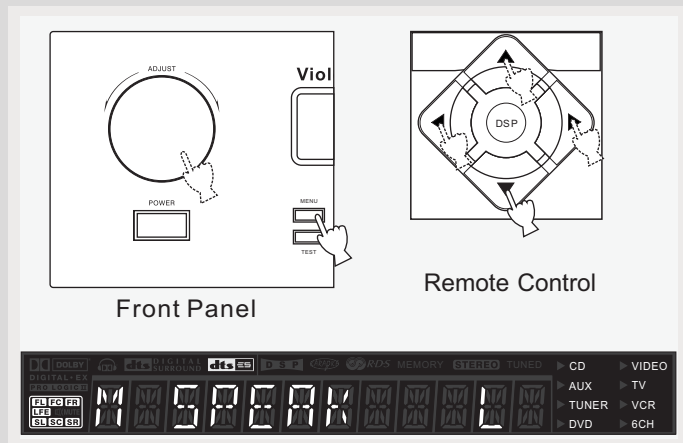

2.Front Center Speaker

Use the MENU button on the panel or the Left and Right ◀ or ▶ buttons on the remote to select "FC SPEAK ",and turn the ADJUST knob on the panel or use the Up and Down ▲ or ▼ buttons on the remote to select position.

Choices:LARGE,SMALL,NONE.

Initial setting:LARGE.

LARGE:Select this if the front center speaker is approximately the same size as the main speakers. The entire range of the front center signal is directed to the front center speaker.

SMALL:Select this position if your front center speaker is smaller than the main speakers. In this position, low bass signals (100 Hz)at the front center channels are output from the subwoofer speaker,or output from left and right main speaker if the subwoofer speaker is in "N" position.

NONE:

Select this position if your system does not include a front center speaker. All of the front center channel signal are directed to the main speakers.

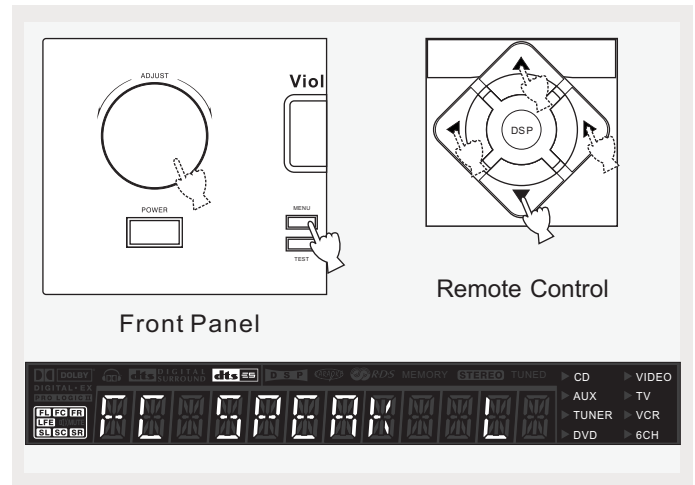

3.Surround Left and Right Speakers

Use the MENU button on the panel or the Left and Right ◀ or ▶ buttons on the remote to select "S SPEAK ", and turn the ADJUST knob on the panel or use the Up and Down ▲ or ▼ buttons on the remote to select position.

Choices:LARGE,SMALL,NONE.

Initial setting:LARGE.

LARGE:Select this position if you have large surround left and right speakers or if a surround subwoofer is connected to your surround speakers.The entire range of the front center signal is directed to the surround left and right speakers.

SMALL:Select this position if your surround left and right speakers do not have a high ability for bass reproduction. In this position, low bass signals (100 Hz) at the surround left and right channels are output from the subwoofer speaker, or output from left and right main speaker if subwoofer speaker is in "N" position.

NONE:Select this position if your system does not include the surround left and right speakers. All of the surround left and right channel signals are directed to the main speakers.

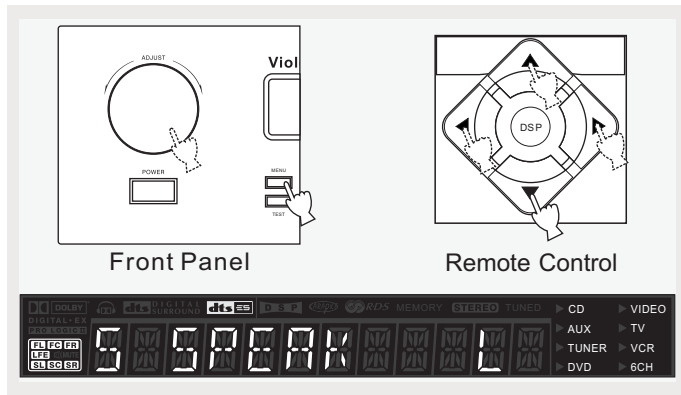

4. Surround Center Speaker

Use the MENU button on the panel or the Left and Right ◀ or ▶ buttons on the remote to select "SC SPEAK", and turn the ADJUST knob on the panel or use the Up and Down ▲ or ▼ buttons on the remote to select position.

Choices: LARGE, SMALL, NONE.

Initial setting: LARGE.

LARGE: Select this position if you have large surround center speaker. The entire range of the surround center signal is directed to the surround center speaker.

SMALL: Select this if your surround center speaker does not have a good ability for bass reproduction. In this position, low bass signal (100 Hz) from surround center is sent to the subwoofer speaker, or output from left and right main speaker if subwoofer speaker is in "N" position.

NONE: Select this position if your system does not include the surround center speaker. All of the surround center channel signal are directed to the surround left and right speakers.

5. Subwoofer Speaker

Use the MENU button on the panel or the Left and Right ◀ or ▶ buttons on the remote to select "SW SPEAK", and turn the ADJUST knob on the panel or use the Up and Down ▲ or ▼ buttons on the remote to select position.

Choices: YES, NONE.

Initial setting: YES.

YES: Select this position if your system includes a subwoofer.

NONE: Select NONE position if your system does not include a subwoofer speaker.

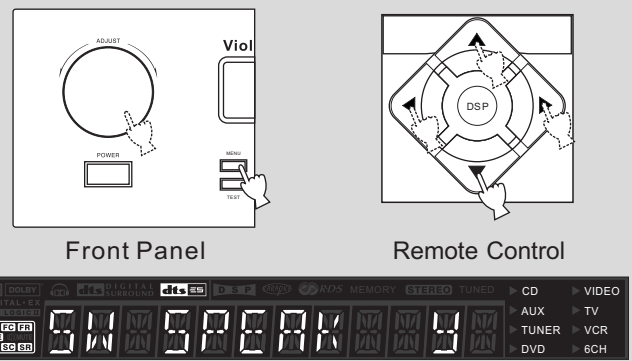

Notes:

- To avoid LFE signal loss in your system. The main speakers selection is in "LARGE" position automatically if your subwoofer speaker is selected "NONE" position.
- When 6 CH INPUT is selected as the input source, all speaker settings are not affected.

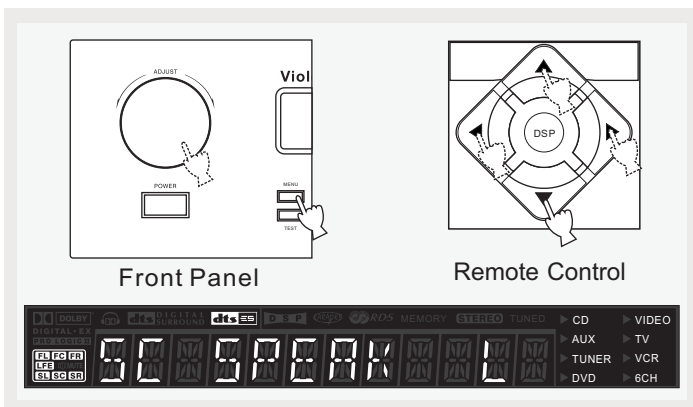

Operating Your ADP61

Adjusting Speaker Output Levels

Use this feature to adjust speaker output levels.

1. Front Left Channel Level

Use the MENU button on the panel or the Left and Right ◀ or ▶ buttons on the remote to select "FL 00dB", and turn the ADJUST knob on the panel or use the Up and Down ▲ or ▼ buttons on the remote to set the level.

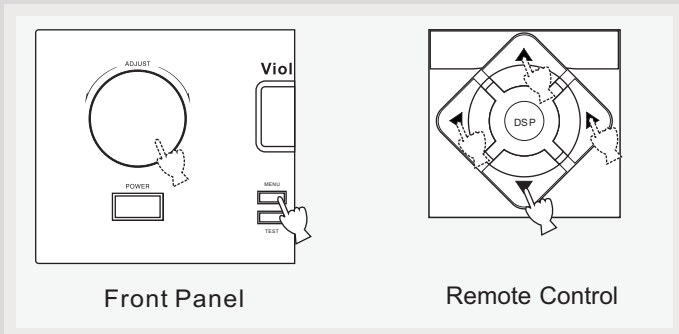

The name of the currently selected speaker and its volume appear on the display, as shown.

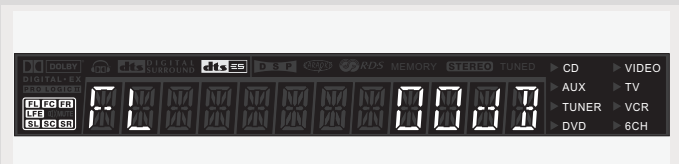

The level can be adjusted from -10dB to +10dB in 1 dB steps. Initial setting: 0dB.

2. Front Center Channel Level

Use the MENU button on the panel or the Left and Right ◀ or ▶ buttons on the remote to select "FC 00dB", and turn the ADJUST knob on the panel or use the Up and Down ▲ or ▼ buttons on the remote to set the level.

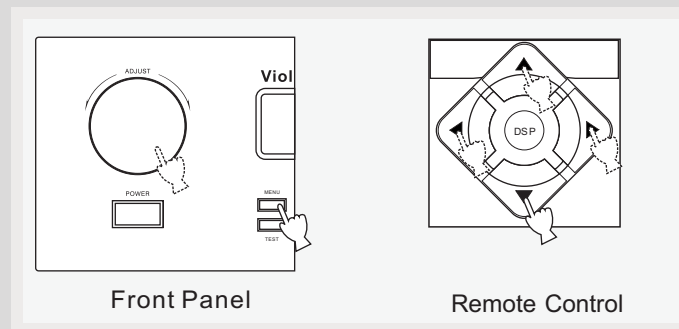

The name of the currently selected speaker and its volume appear on the display, as shown.

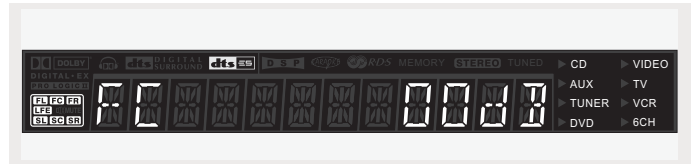

The level can be adjusted from -10dB to +10dB in 1 dB steps. Initial setting: 0dB.

3. Front Right Channel Level

Use the MENU button on the panel or the Left and Right ◀ or ▶ buttons on the remote to select "FR 00dB", and turn the ADJUST knob on the panel or use the Up and Down ▲ or ▼ buttons on the remote to set the level.

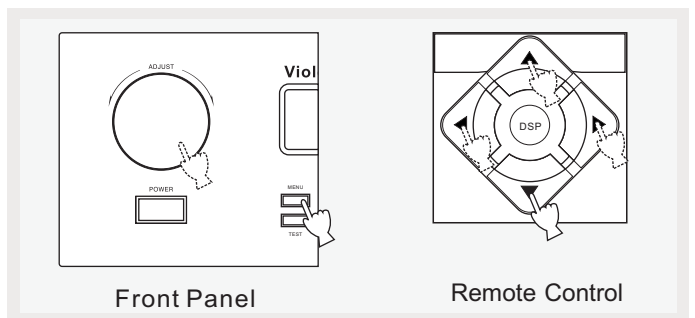

The name of the currently selected speaker and its volume appear on the display, as shown.



The level can be adjusted from -10dB to +10dB in 1 dB steps. Initial setting: 0dB.

4. Surround Left Channel Level

Use the MENU button on the panel or the Left and Right ◀ or ▶ buttons on the remote to select "SL 00dB", and turn the ADJUST knob on the panel or use the Up and Down ▲ or ▼ buttons on the remote to set the level.

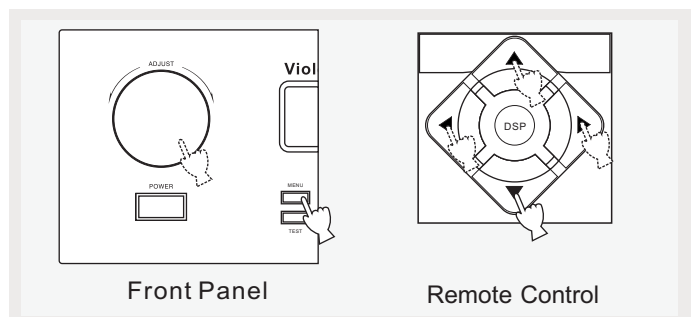

Operating Your ADP61

The name of the currently selected speaker and its volume appear on the display, as shown.

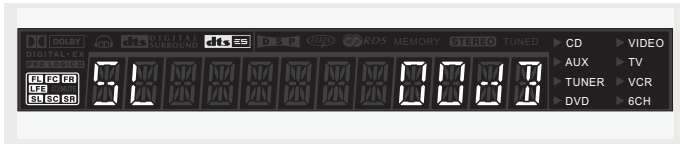

The level can be adjusted from -10dB to +10dB in 1 dB steps. Initial setting:0dB.

5.Surround Center Channel Level

Use the MENU button on the panel or the Left and Right ◀ or ▶ buttons on the remote to select "SC 00dB", and turn the ADJUST knob on the panel or use the Up and Down ▲ or ▼ buttons on the remote to set the level.

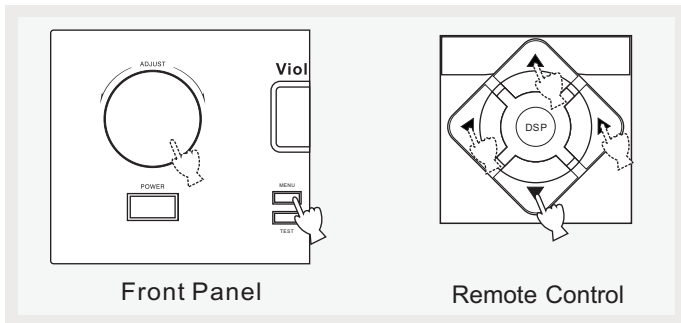

The name of the currently selected speaker and its volume appear on the display, as shown.

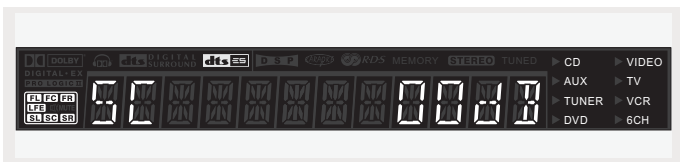

The level can be adjusted from -10dB to +10dB in 1 dB steps. Initial setting:0dB.

6.Surround Right Channel Level

Use the MENU button on the panel or the Left and Right ◀ or ▶ buttons on the remote to select "SR 00dB", and turn the ADJUST knob on the panel or use the Up and Down ▲ or ▼ buttons on the remote to set the level.

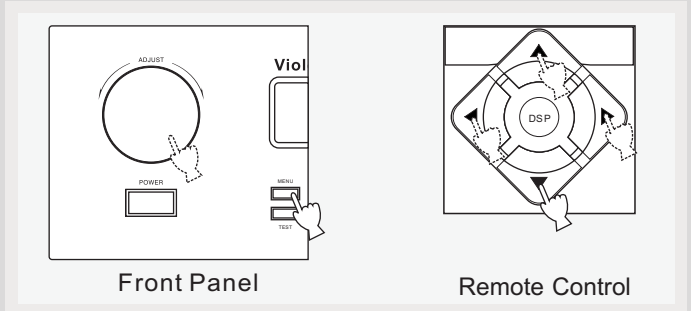

The name of the currently selected speaker and its volume appear on the display, as shown.

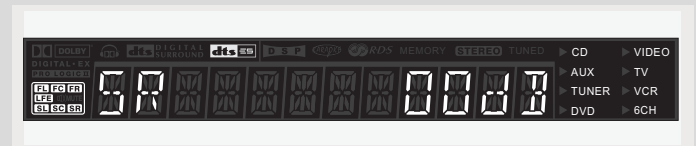

The level can be adjusted from -10dB to +10dB in 1 dB steps. Initial setting:0dB.

7.Subwoofer Channel Level

Use the MENU button on the panel or the Left and Right ◀ or ▶ buttons on the remote to select "SW 00dB", and turn the ADJUST knob on the panel or use the Up and Down ▲ or ▼ buttons on the remote to set the level.

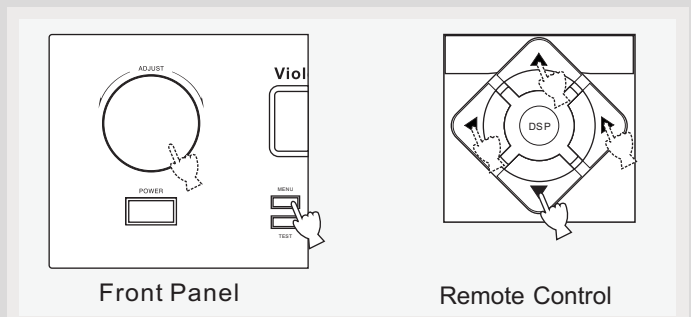

The name of the currently selected speaker and its volume appear on the display, as shown.

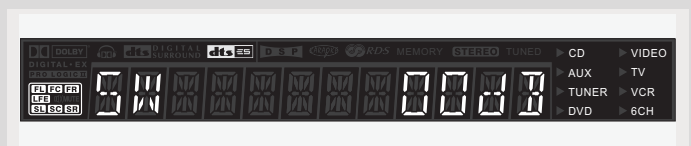

The level can be adjusted from -10dB to +10dB in 1 dB steps. Initial setting:0dB.

Note:

- When adjusting the level of an active subwoofer system, you may also need to adjust the subwoofer's own volume control.

Operating Your ADP61

Speaker Level Calibration

Here you can adjust the level of each speaker with the built-in test tone so that the volume of each speaker is the same at the listening position.

Note:

- The speakers cannot be calibrated while the output of this unit is muted, or when using the multichannel input.

1. Press the TEST button on the remote control or panel, you will hear a test tone (like pink noise) from front left speaker, then front center speaker, then front right speaker, then surround right speaker, surround center, then surround left speaker, and then the subwoofer speaker.

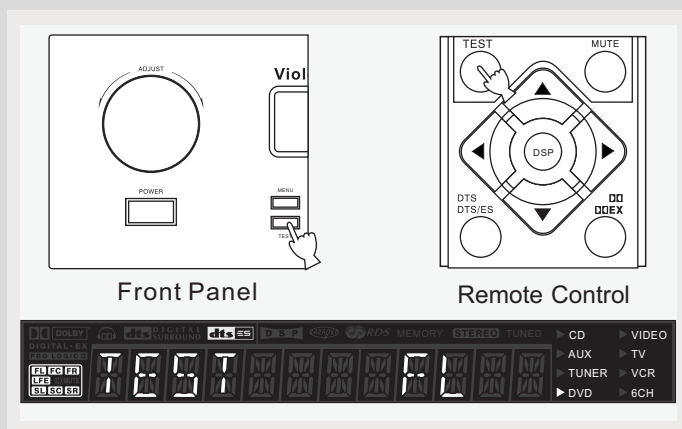

2. Use the MENU button on the panel or the Left and Right ◀ or ▶ buttons on the remote to select the speaker you want to adjust.

Turn the ADJUST knob on the panel or use the Up and Down ▲ or ▼ buttons on the remote to set the volume. The volume can be adjusted from -10 to +10 dB in 1 dB steps.

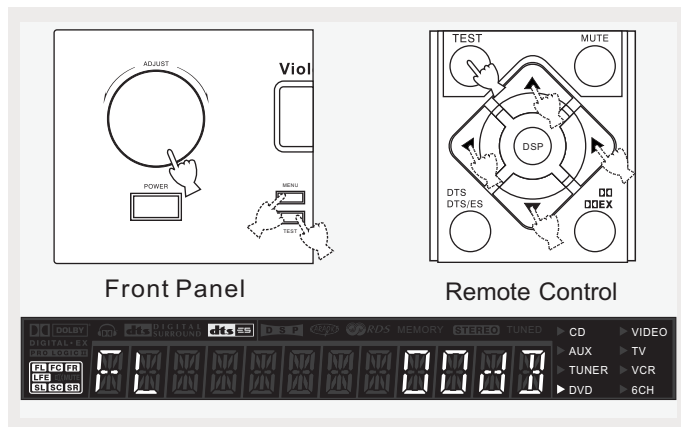

3. Repeat step 2 until the volume of the test tone from each speaker is the same.

4. After adjustment, press TEST again on the remote control or panel to exit testing mode.

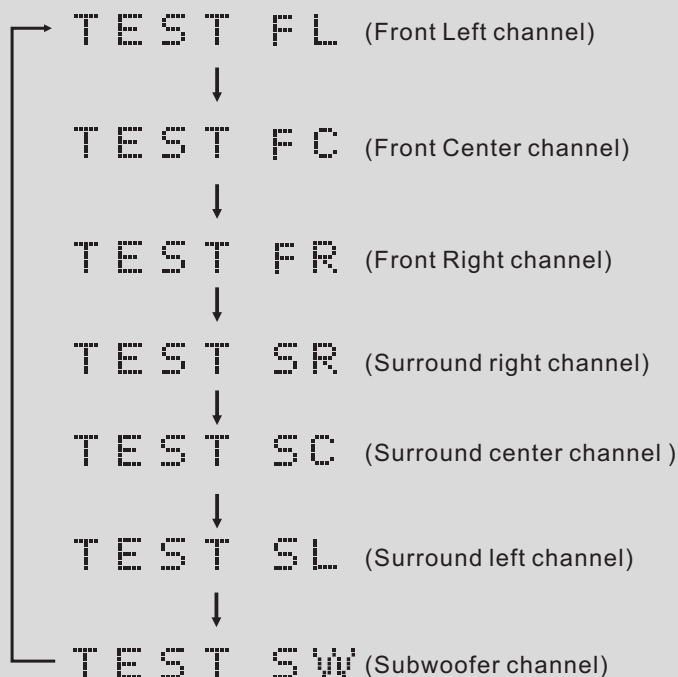

Selecting the Input Source

This section explains how to select the input source (i.e., The AV component that you want to listen to or watch).

This unit has one set exterior decode 6 channel input, six way analog inputs, three way digital (one is optical, two are coaxial) inputs. All these sound sources can be selected on the panel or remote control.

1. Press INPUT buttons on the panel repeatedly to select an input source. This unit is with CD, COAX1, AUX, COAX2, TUNER, DVD, OPTICAL, VCR, TV, VIDEO, 6 CH IN sources.

Every time you press the source button, the input setting (e.g. DVD/OPT1) will be shown on display.

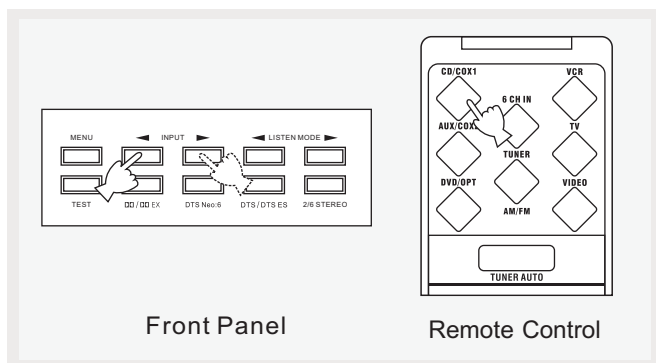

2. Press direct corresponding source button on the remote to select a source.

On the remote control, CD and COAX 1, AUX and COAX 2, DVD and OPTICAL are all double function buttons. If you want to select a digital source by remote control, please press corresponding button.

3. DVD analog signal (DVD RCA) input, Optical (DVD digital signal), DVD Video and DVD S -Video, they belong to the same that input signal group.

VIDEO analog signal (VIDEO RCA) input, COAX1 (VIDEO digital signal), VIDEO Video and VIDEO S -Video belong to the same that input signal group.

TV analog signal (TV RCA) input, COAX2 (TV digital signal), TV Video, TV S -Video belong to the same that input signal group.

Input Reference Level Adjust (software rev 2)

Each individual audio input section features a volume level attenuation function (from 0db to -15db). This is particularly useful for matching levels between various sound sources without having to compensate with the Master Volume control. The Input Reference Level can be edited at any time by simply turning the **ADJUST** control.

(Technical note: all input stages conform to industry standard reference levels, e.g. +4db, -10db etc. Electronically, this attenuation function actually occurs at the output stage.)

Switch Synchro Audio/Video Sources

If you have two or more video devices in your system, please use Audio/Video signal synchro switch function.

Connect each Video/Audio source's group to this unit's same group's input jacks.

The following table lists all the input sources and shows which sources are the same group:

ANALOG AUDIO INPUT JACK	DIGITAL INPUT JACK	VIDEO INPUT JACK	S-VIDEO INPUT JACK
CD	/	/	/
AUX	/	/	/
TUNER	/	/	/
DVD	OPT	DVD	DVD
VIDEO	AES/EBU	VIDEO	VIDEO
TV	COAX2	TV	TV
VCR	/	VCR	VCR

Example 1:

If you connect a DVD player to the DVD input (audio + video) jacks and then press the DVD button, you will be able to have the sound and image from the DVD player.

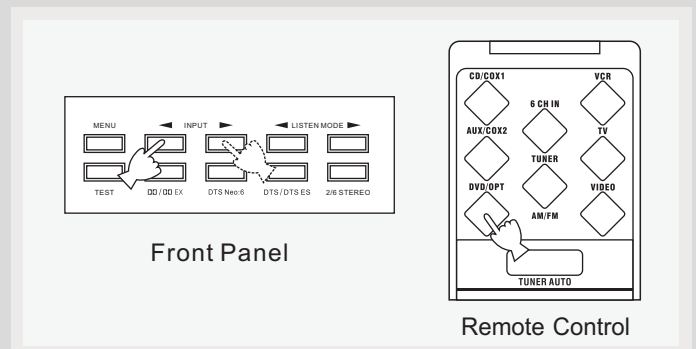

Example 2:

Based on the example 1, the DVD is playing, if a video source (Audio, Video) is connected to VIDEO input jacks of this unit, the VIDEO button is pressed, the image and sound from the VIDEO source will replace the DVD.

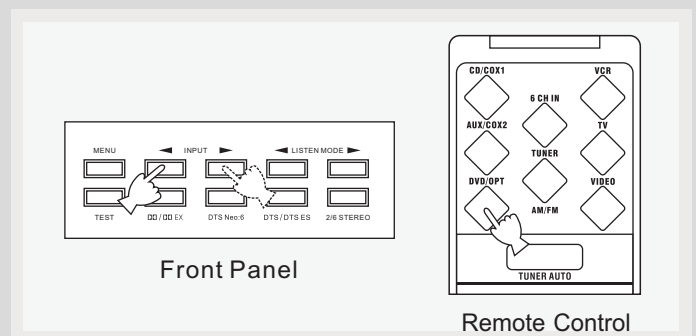

Operating Your ADP61

SLEEP

Use the built-in SLEEP timer to automatically turn this unit into the standby mode after the time you set elapses. The SLEEP timer is useful when you plan to fall asleep while this unit is playing back or recording a source.

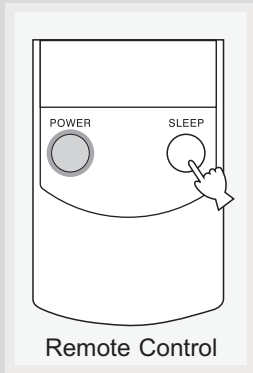

1. Press the SLEEP button repeatedly until the desired SLEEP time appears on the display. From 10 minutes to 120 minutes.

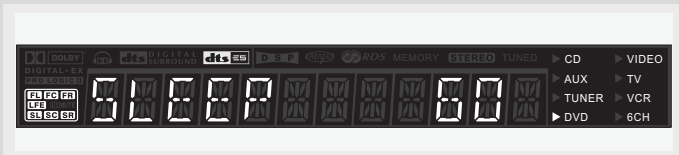

2. To cancel the SLEEP: Press the SLEEP button repeatedly until SLEEP OFF appears on the display(VFD).

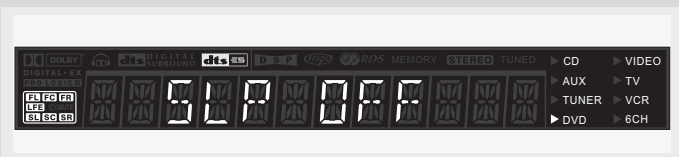
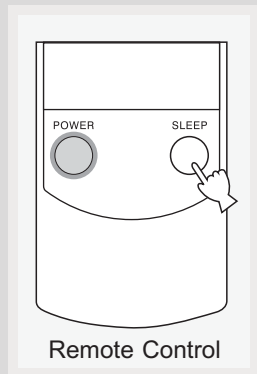

Setting the Display Brightness

Use the MENU button on the panel or the Left and Right ◀ or ▶ buttons on the remote to select "DIMMER 8" item. Turn the ADJUST knob on the panel or use the Up and Down ▲ or ▼ buttons on the remote to select a mode of dimmer.

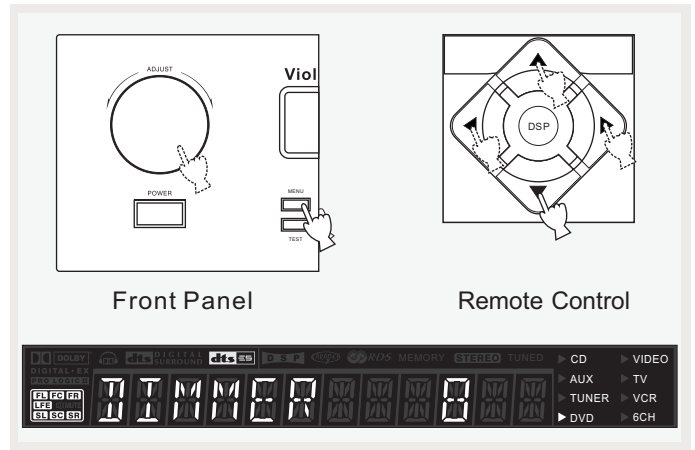

Automatic Audio Format Recognition

When a digital source is playing, the receiver will automatically recognise source format to enter to the proper surround mode and light output speaker indicator on the left-hand side of the display(VFD).

It is important to know, however that not all DTS or Dolby Digital sources are encoded with the full complement of five channels plus LFE*. Output speaker indicator show how many and which speaker you have enabled and the letters inside output speaker indicator show which channel is present in the source information.

*LFE stands for Low Frequency Effect. The indication "LFE" appears if the digital source contains LFE information. In this case, the bass signal will be delivered to the subwoofer, offering more dynamic deep bass sound effects.

Listen Mode Display

This unit detects digital signal sources and selects the corresponding playback mode automatically, but can be manually changed to a different playback mode. The new mode will remain in effect until a differently formatted source is played. For instance, if you play a DTS - encoded DVD, DTS decoding mode is automatically selected. If you manually change to DTS STEREO mode, the unit will remain in DTS STEREO mode until you change the mode manually or play a differently formatted source, i.e. Dolby Digital..

Operating the Tuner

The receiver has a built-in tuner that allows for AM/FM radio function.

There are 2 way to tune; automatic and manual. Automatic tuning is effective when broadcast signals are sufficiently strong and free from interference. If a radio signal is weak, manual tuning is recommended.

Manual tuning

1. Connect the FM and AM antennae accordingly (see page 9 "Connecting the Antenna").

2. Press the POWER switch to turn on the receiver.

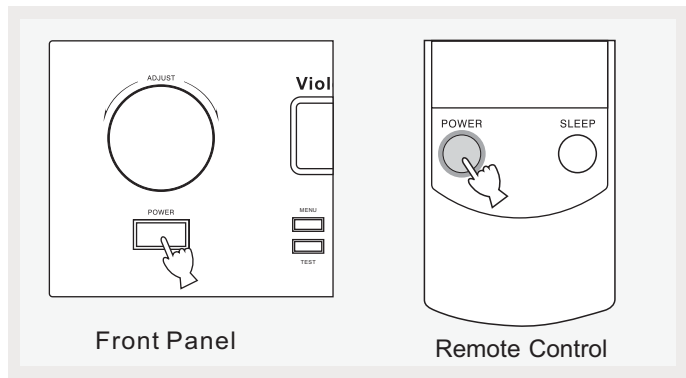

3. Press the TUNER button on the remote or INPUT buttons on front panel to select TUNER as the input source.

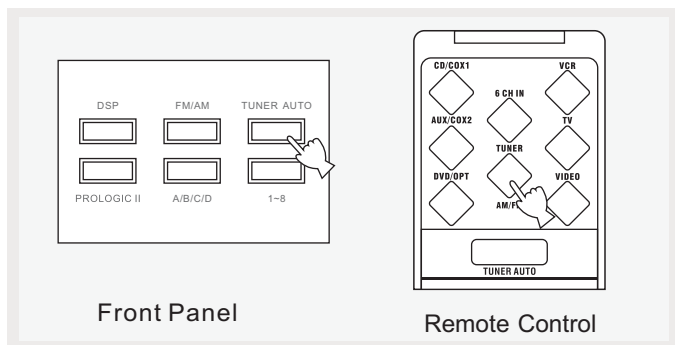

4. Press the FM/AM button on the front or the remote control to select the reception band.

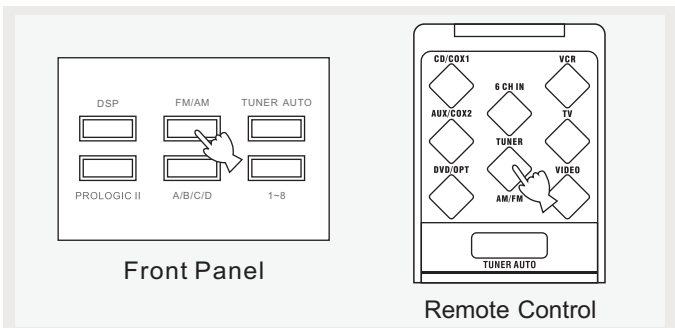

5. Tune by pressing SCAN + or SCAN - repeatedly until the desired station is found. Alternatively, you can press and hold SCAN + or SCAN - for about one second to activate the automatic search function. In this mode, the receiver will automatically tune frequencies until it finds a station. When a FM station broadcast stereo sound, the STEREO indicator lights up.

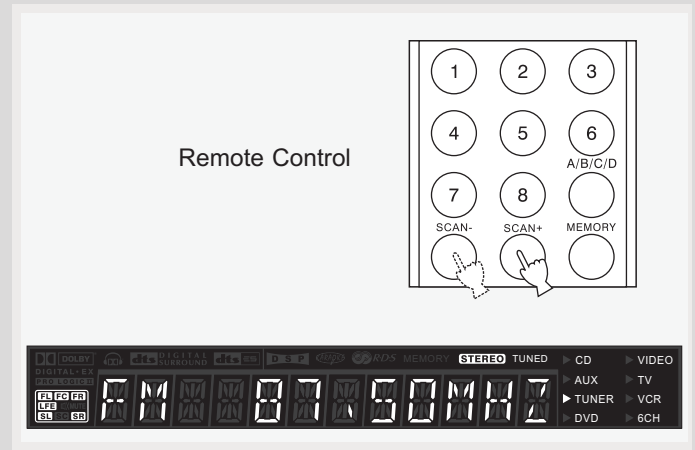

6. Repeat steps 5 to tune another radio station.

7. Select sound effect if needed by pressing preset DSP sound or other available listen modes,

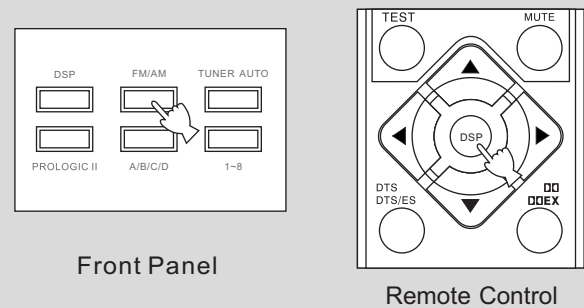

NOTES

1. If there is interference, modify the location of the antenna until the optimal sound is heard. TV and other electronic devices could be the cause of interferences so try to position the antenna away of them.

2. Weak signal can affect the "auto Search function". Adjust the antenna for better reception for more efficient search.

Operating Your ADP61

Storing Tuner Presets:

Automatic Preset Storing:

1. Press the TUNER button on the remote or INPUT buttons on front panel to select TUNER as the input source.
2. Press the FM/AM button on the front panel or the remote to select the reception band.

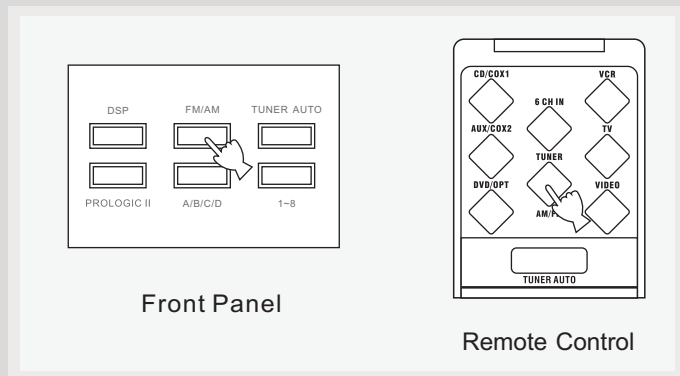

3. Press and hold TUNER AUTO button for 3 seconds on the panel to begin automatic tuning.

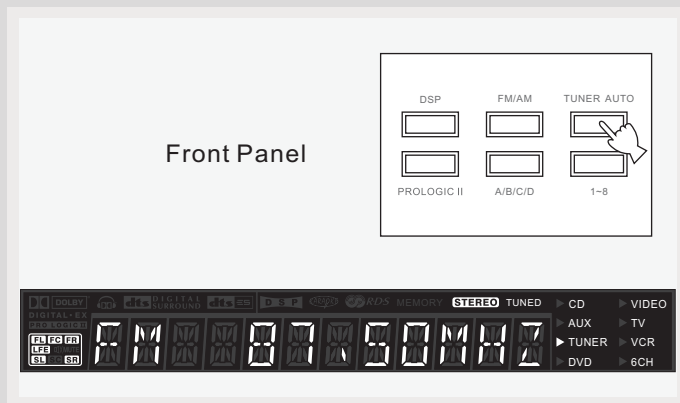

4. Radio frequencies will be browsed and radio stations stored automatically as A1, A2, A3, A4, A5 etc. When all available radio stations are stored or if all 32 memory locations are full, the auto preset will stop.

NOTE

Weak signal can affect the "Automatic Preset Storing function" efficiency. Adjust the antenna for the best reception for more efficient search.

Manually Presetting Station

1. Press the FM/AM button on the front panel or the remote to select the reception band.
2. Tune to a radio station (see "Manual tuning" on page 28 above for details).

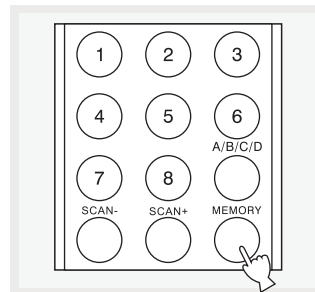

3. Press the MEMORY button on the panel or remote, the "MEMORY" indicator on the display lights up.

4. Press A/B/C/D button on the remote or panel repeatedly to select a preset station group (A to D) while the "MEMORY" indicator is lighting, e.g. "A".

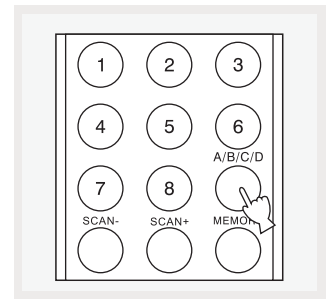

5. While the "MEMORY" indicator is still on, press 1-8 button to select a preset station number. For example, selecting group "A" selecting group "A" in step 4 and number "1" in step 5 would save the station as "A1."

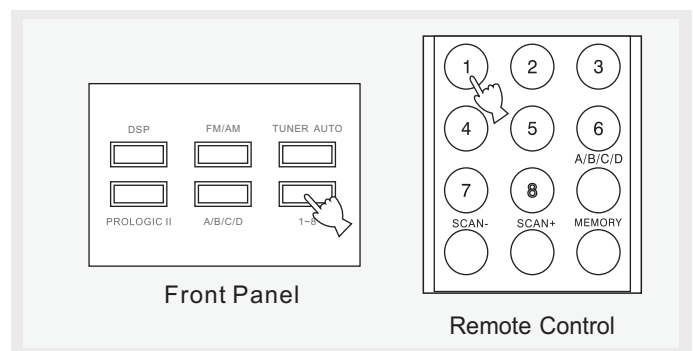

6. Repeat steps 2 to 5 to store other stations.

NOTE

A new setting can be programmed in place of the former one.

This memory is forever before reset.

Advanced Sound Control

About the Listening Modes

With its built-in surround-sound decoders and DSP programs, the AV receiver can transform your home listening room into a movie theater or concert hall.

If you connect surround center speakers will be used for 6.1-channel surround playback.

The AV receiver's surround indicators show which speakers are active in each listening mode.



FL:Front Left Speaker SL:Surround Left Speaker
FC:Front Center Speaker SC:Surround Center Speaker
FR:Front Right Speaker SR:Surround Right Speaker
LFE:Subwoofer

2 Stereo

The selected input source is processed as a stereo signal and output by the front left and right speakers and the subwoofer.



Under any format source:Tuner,Analog signals,PCM CDs,Dolby Prologic,Dolby Digital,Dolby Digital Surround EX,DTS,DTS ES, DTS 96/24,this mode can be selected.

6 Stereo

The selected input source is processed as a 6 stereo signals and output by the front left,center and right speakers,surround left,surround center, surround right and the subwoofer.



Under any format source:Tuner,Analog signals,PCM CDs,Dolby Prologic,Dolby Digital,Dolby Digital Surround EX,DTS,DTS ES, DTS 96/24,this mode can be selected.

Dolby Pro Logic II Movie



Use this mode with DVDs and videos that bear the Dolby Surround logo or TV programs that feature Dolby Surround.You can also use this mode with stereo movies or TV programs and the AV receiver will create a 5.1 surround mix from the 2-channel stereo.



Under Tuner, Analog signals, PCM CDs, Dolby pro logic, format source this mode can be selected.

Dolby Pro Logic II Music



Use this mode to add 5.1 surround to stereo sources such as music CDs and DVDs.



Under Tuner, Analog signals, PCM CDs, Dolby pro logic format source this mode can be selected.

Dolby Digital



With this format you can experience the same superb sound that you get at a movie theater or concert hall. Use this mode with DVDs that bear the Dolby Digital logo.



Under Dolby Digital,Dolby Digital Surround EX format source this mode can be selected.

Dolby Digital Surround EX



With an added surround center channel,this 6.1 channel format offers a heightened sense of space, for added realism with moving sounds,such as those that rotate 360 degrees or pass overhead.Dolby Digital Surround EX material can also be played on conventional 5.1 channel systems,in which case the surround center channel audio is split between the surround left and right channels..Use this mode with DVDs that have a 5.1-

Advanced Sound Control

channel soundtrack and bear the Dolby Digital logo.



Under Dolby Digital, Dolby Digital Surround EX format source, this mode can be selected.

DTS



This digital surround format offers a surround sound experience with exceptional fidelity. It uses compressed digital audio data, with six discrete channels (5.1), and the ability to handle large amounts of audio data while remaining faithful to the original. DTS provides very high-quality sound. You'll need a DTS compatible DVD player in order to enjoy DTS material. Use this mode with DVDs, LDs, or CDs that bear the DTS logo.



Under DTS, DTS ES format source, this mode can be selected.

DTS 96/24



This mode provides higher audio quality. Use it with CDs, LDs, and DVDs that bear the DTS 96/24 logo.



When you play DTS 96KHz/24bit-encoded DVD/ CDs, this unit automatically switches to DTS 96/24 listen mode.

DTS-ES Discrete



This is DTS with an added surround center channel for 6.1 surround sound. Use it with program material recorded in DTS 6.1 format. With the additional surround center channel, this format offers 6.1 fully independent digital channels, providing a realistic sense of movement and space. Use it with program material DTS 6.1, such as CDs, DVDs, or LDs that bear the DTS-ES logo.



Under DTS, DTS ES format source, this mode can be selected.

DTS-ES Matrix



This is DTS with an added surround center channel for 6.1 surround sound. Use it to provide 6.1 channel surround playback with program material recorded in DTS 5.1 format. Since DTS 5.1 program material contains surround center channel information, all channels can be reconstructed for 6.1-channel playback. Use this mode with CDs, DVDs, or LDs that bear the DTS or DTS-ES logo.



Under DTS, DTS ES format source, this mode can be selected.

Neo:6



This mode provides 6.1-channel playback from 2-channel sources. It offers six full-bandwidth channels with excellent separation. There are two modes of operation: Cinema mode for movies, and Music mode for listening to music. Cinema mode simulates the realistic sense of movement that you get with 6.1-channel surround sound sources. Use this mode with videos, DVDs, and TV programs that feature stereo sound. Music mode uses the surround channels to simulate a natural sound field that cannot be produced with conventional stereo. Use this mode with stereo material such as music CDs.



Under Tuner, Analog signals, PCM CDs, format source this mode can be selected.

Advanced Sound Control

Sound Enhancement Systems

This receiver is equipped with several built-in sound enhancement systems.

Dolby Pro Logic

1. Dolby Pro Logic has two modes: MOVIE for movies and MUSIC for 2-channel audio sources.

2. When you play PCM-encoded music CDs, tuner or other 2-channel sources, you can press the PRO LOGIC II button to switch between DOLBY PRO LOGIC II MUSIC and DOLBY PRO LOGIC II MOVIE listen modes.

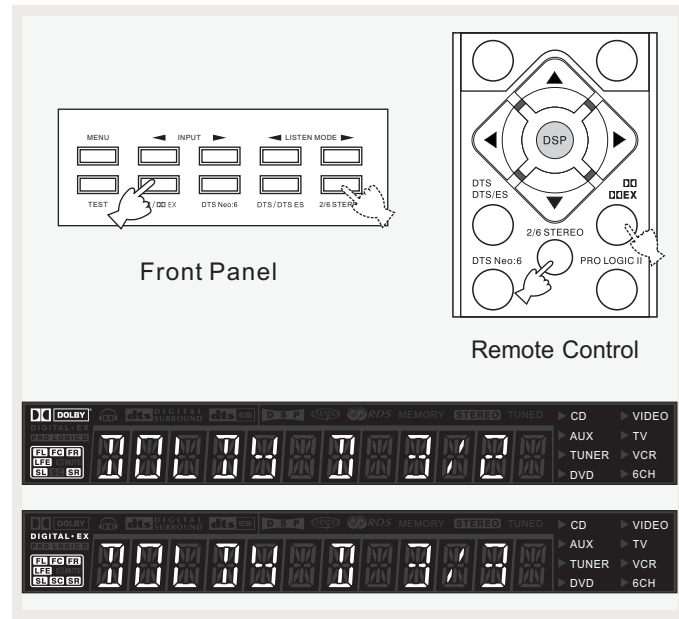
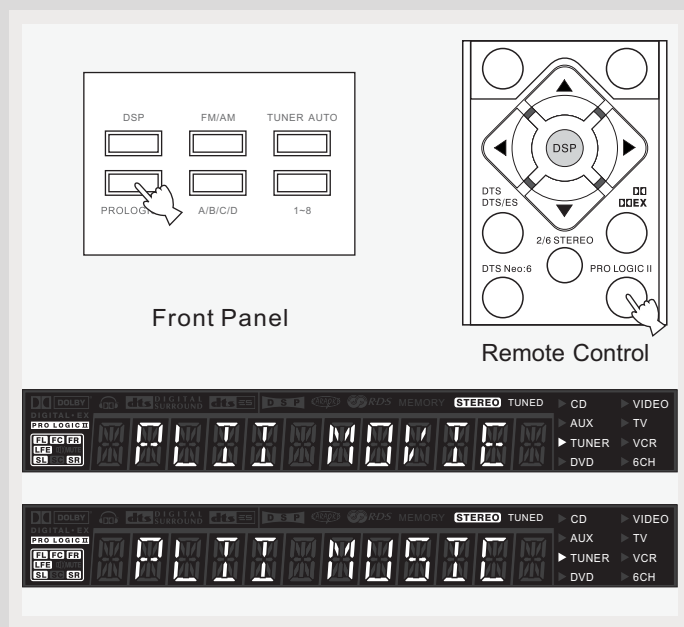

DTS Neo:6

1. Neo:6 has two modes: DTS Neo:6 CINEMA and DTS Neo:6 MUSIC.

2. When you play PCM-encoded music CDs, tuner or other 2-channel sources, you can press the DTS Neo:6 button to switch between DTS Neo:6 CINEMA and DTS Neo:6 MUSIC listen modes.

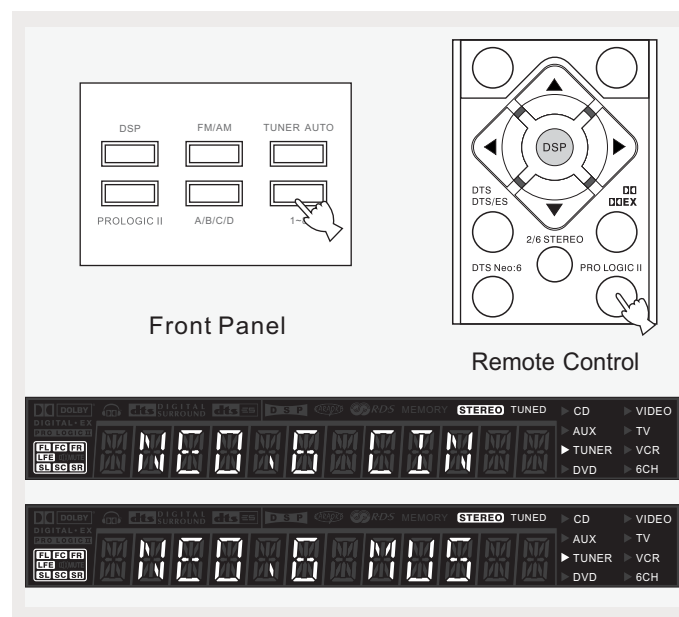

Dolby Digital and Dolby Digital Surround EX

1. When you play Dolby Digital Surround EX-encoded or Dolby Digital-encoded DVD/CDs, this unit automatically switches to Dolby Digital Surround EX or Dolby Digital listen mode.

2. Use the DD EX button to switch between Dolby Digital Surround EX and Dolby Digital listen modes.

3. Dolby Digital is none of surround center, Dolby Digital EX has surround center signal.

4. Press the 2/6 STEREO button to switch between DOLBY STEREO or 6CH STEREO listen modes.

Advanced Sound Control

DTS/DTS ES

1. When you play DTS ES-encoded or DTS-encoded DVD/CDs, this unit automatically switches to DTS or DTS ES listen mode.

2. Press the DTS/DTS ES button to switch between DTS and DTS ES listen modes.

3. DTS is none of surround center, DTS ES has surround center signal.

4. Press the 2/6 STEREO button to switch between DTS STEREO and 6CH STEREO listen modes.

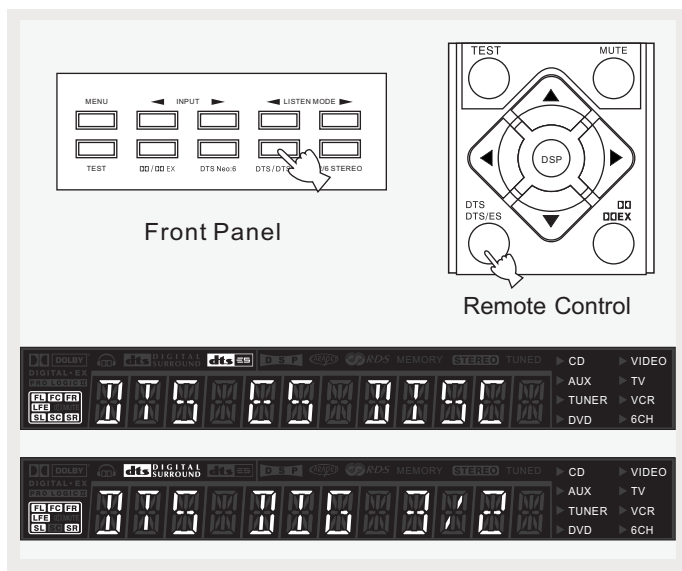

DTS 96/24

1. When you play DTS 96KHz/24bit - encoded DVD/CDs, this unit automatically switches to DTS 96/24 listen mode.

2. Press the 2/6 STEREO button to switch between DTS STEREO and 6CH STEREO listen modes.

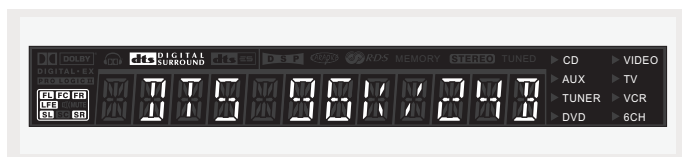

2/6 Channel Stereo

Under any format source, e.g. Tuner, Analog signals, PCM CDs, Dolby pro logic, Dolby Digital, Dolby Digital Surround EX, DTS, DTS ES, DTS 96/24 etc. You can use the 2/6 STEREO button

to switch between 2 and 6 channel stereo listen modes.

2 CH Stereo mode: only output from front Right, front Left and subwoofer.

6 CH stereo mode: six channels output are the same signals.

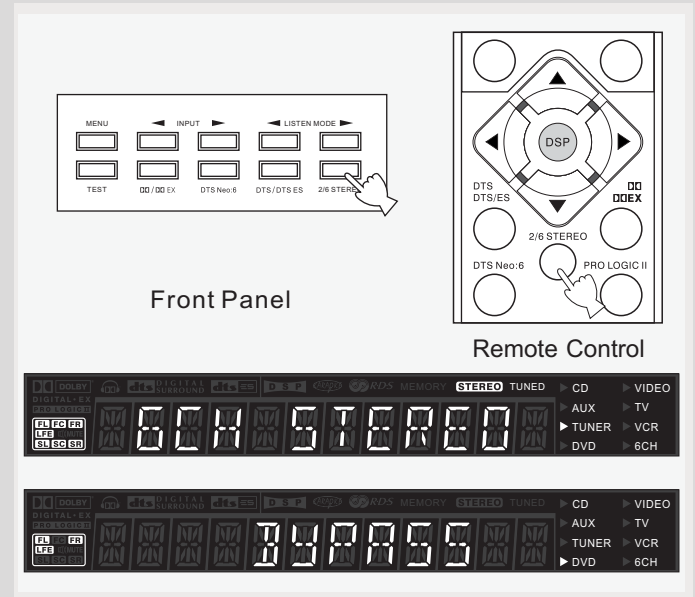

DSP (Digital Sound Field Processor)

There are eight selectable DSP modes for creating various soundfield effects. By pushing the DSP button repeatedly, you can scroll through the list of available presets.

- * LIVE
- * CINEMA
- * DISCO
- * STADIUM
- * JAZZ
- * CHURCH
- * HALL
- * PROLOGIC
- * (DSP OFF)

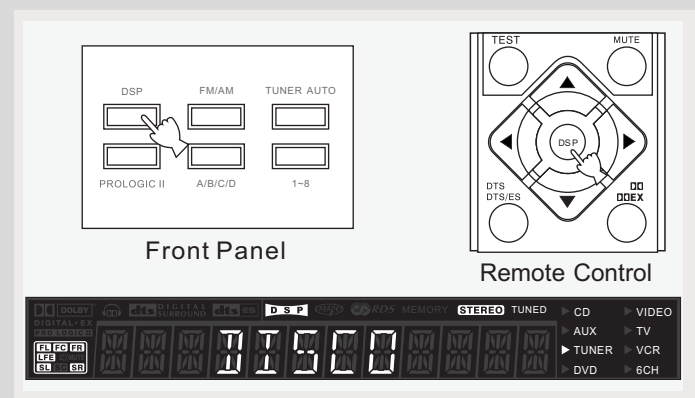

Note:

- When using DSP effects, no decoding is possible, including Dolby Digital and DTS

Advanced Sound Control

Adjusting the DTS, Dolby Digital LFE Level

This adjustment is effective only when DTS, DTS ES, DOLBY DIGITAL or DOLBY DIGITAL SURROUND EX is decoded and the signals of the selected source encoded with DTS, DTS ES, DOLBY DIGITAL and DOLBY DIGITAL SURROUND EX contain LFE signals.

Adjusts the output level at the LFE (low frequency effect) channel. If the LFE signals are mixed with signals of other channels and they are output from the same speakers, the ratio of LFE signals to other signals can be adjusted.

DOLBY DIGITAL, DOLBY DIGITAL SURROUND EX LFE level control range: -10dB to 00 dB.

Preset value: 00dB.

DTS, DTS ES LFE level control range: -10dB to 00 dB.

Preset value: 00dB.

1. Play source which-encoded you want to adjust the LFE level.

2. Use the MENU button on the panel or the Left and Right ◀ or ▶ buttons on the remote so that "XX LFE XXdB" appears on the front panel display.

3. Turn the ADJUST knob on the panel or use the Down and Up ▼ or ▲ buttons on the remote to adjust LFE level.

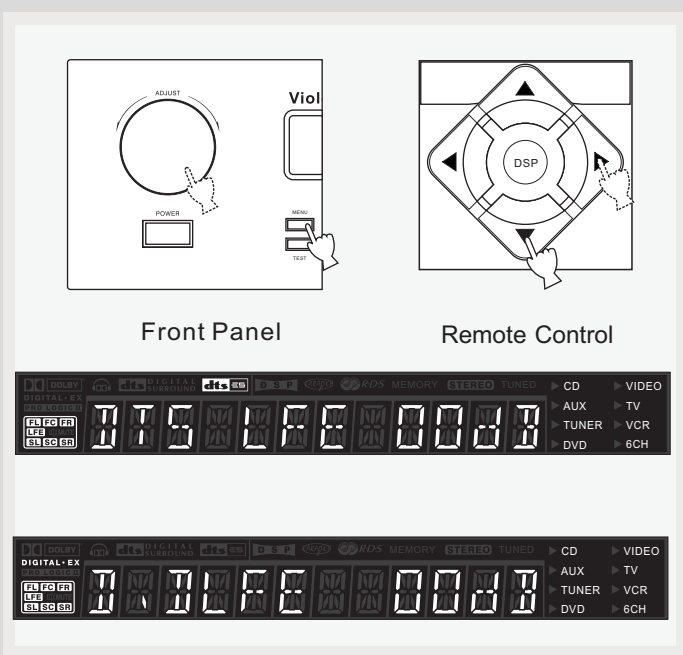

Dynamic Range(Night Mode)

By using Dynamic Range Compression technology, you can enjoy enhanced sound quality by Dolby digital at night without interrupting your roommates or neighbors. While enjoying a Dolby Digital enabled component(DVD,DVB),you can activate Night Mode by pressing MENU button on the remote control or panel,and this mode will compress the difference in volume between normal voices and sounds like explosions.

Use the MENU button on the panel or the Left and Right ◀ or ▶ buttons on the remote to select the parameter of dynamic range.

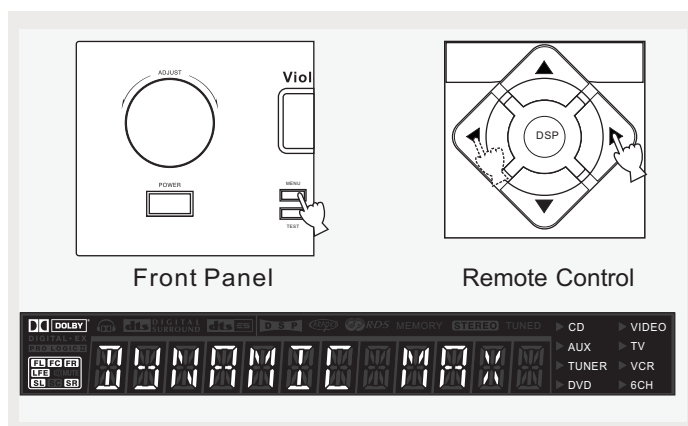

2. Turn the ADJUST knob on the panel or use the Down and Up ▼ or ▲ buttons on the remote to set parameter required.

Choices: MAX(maximum), STD(standard), MIN(minimum).

Initial setting: STD(standard).

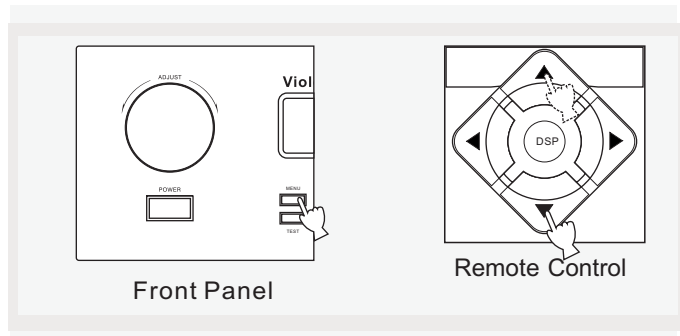

Notes:

- Night Mode can be functioned ONLY during Dolby Digital, Dolby Digital EX playback.
- To play Dolby Digital, Dolby Digital EX, DTS, DTS ES, you MUST Connect the DVD to your receiver with DIGITAL signal (Coaxial or Optical). the Sound Source (DVD software) MUST be Dolby Digital, Dolby Digital EX, DTS, DTS ES encoded.

Advanced Sound Control

Adjusting the Delay Time

You can adjust the time difference between the beginning of the sound from the main speakers and the beginning of the sound effect from the surround and center speakers. The larger the value, the later the sound effect is generated. The delay time can be individually adjusted to all listen modes.

All listen modes center delay control range:0-5ms,Initial is 2 ms.

All listen modes surround delay control range: 0-15ms, Initial is 15ms.

- 1.Select a listen mode you want to adjust the delay time while playing a sources.
- 2.Use the MENU button on the panel or the Left and Right ◀ or ▶ buttons on the remote so that "DELAY" appears on the front panel display.
- 3.Turn the ADJUST knob on the panel or use the Down and Up ▼ or ▲ buttons on the remote to adjust delay time.

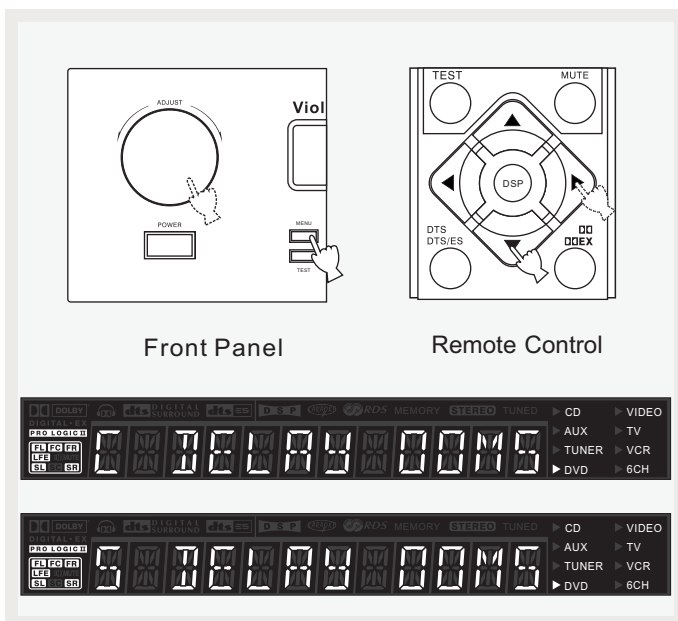

Adjusting the Parameter Settings for Pro Logic II MUSIC

Changing Parameter settings

You can adjust the values of PRO LOGIC II MUSIC parameters so the sound fields are recreated accurately in your listening room.

1.Select PRO LOGIC II MUSIC listen mode.

2.Use the MENU button on the panel or the Left and Right ◀ or ▶ buttons on the remote to select parameter you want to adjust.Turn ADJUST knob on the panel or use the Down and Up ▼ or ▲ buttons on the remote to change parameter value.

3.Repeat step 2 above to change other parameters.

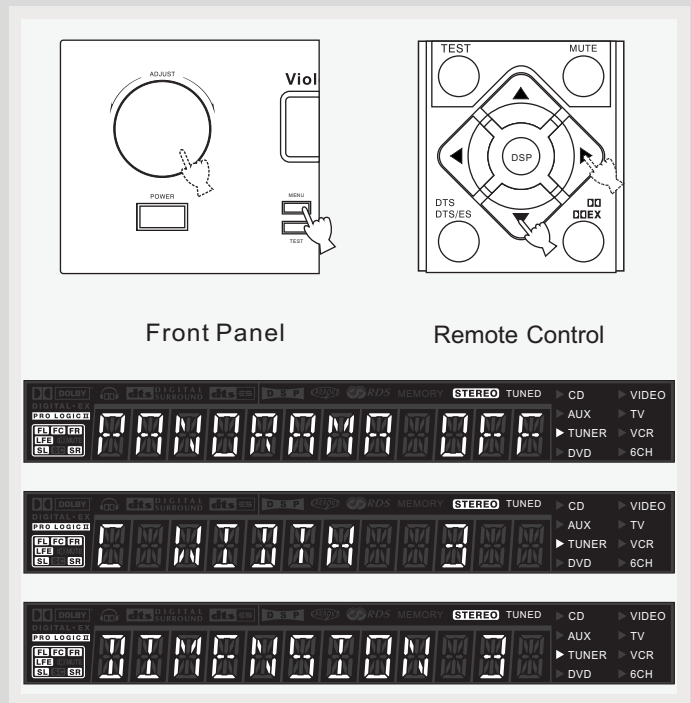

PRO LOGIC II MUSIC Parameter Descriptions

PANORAMA

Function:Turning the function on extends the front stereo image to include the surround speakers for wraparound effect.

Choices:OFF/ON. initial setting is OFF.

DIMENSION

Function:Gradually adjusts the soundfield either towards the front or towards the rear.

Control range:-3 (towards the rear) to +3 (towards the front), initial setting is 0.

C WIDTH (Center Width)

Function:Adjusts the center image from all three front speakers to varying degrees, the larger the value, adjusts the center image towards the main left and right speakers.

Control range:0 (center channel sound is output only from center speaker) to 7 (center channel sound is output only from main left and right speakers), initial setting is 3.

Troubleshooting

Refer to the chart below when the ADP61 does not function properly. If the problem you are experiencing is not listed below or the instructions below do not help, set this unit to the standby mode, disconnect the power cord, and contact the nearest authorized dealer or service center.

General

Problem	Cause	Remedy
This unit fails to turn on when STANDBY/ON(or SYSTEM POWER) is pressed, or enters in the standby mode soon after power has been turned on.	The power cord is not connected or the plug is not completely inserted.	Connect the power cord firmly.
	The protection circuitry has been activated.	Make sure all speaker wire connections on this unit and on all speakers are secure and that the wire for each connection does not touch anything other than its respective connection.
	This unit has been exposed to a strong external electric shock(such as lightning and strong static electricity.)	Set this unit in the standby mode. disconnect the power cord, plug it back in after 30 seconds, then use it normally.
No sound.	Display is disordered. due to external disturb, not natural use etc.	Reset this unit, see page 40 "Resetting Factory Presets".
	Incorrect input or output cable connections.	Connect the cables properly. If the problem persists, the cables may be defective.
	No appropriate input source has been selected.	Select an appropriate input source with INPUT, 6 CH INPUT or the input selector buttons.
	Speaker connections are not secure.	Secure the connections.
	The volume is turned down.	Turn up the volume.
	The sound is muted.	Press MUTE or any operation buttons of this unit to cancel a mute and adjust the volume.
	The signals this unit cannot reproduce are being received from a source component e.g.:a CD-ROM.	Play a source whose signals this unit can reproduce.

Troubleshooting

Problem	Cause	Remedy
The sound suddenly goes off.	The protection circuitry has been activated because of a short circuit, etc.	Check that the speaker wires are not touching each other and then turn this unit back on.
	The sleep timer has turned the unit off.	Turn on the power, and play the source again.
	The sound is muted.	Press MUTE to cancel a mute.
Only the speaker on one side can be heard.	Incorrect cable connections.	Connect the cables properly. If the problem persists, the cables may be defective.
Only the center speaker outputs substantial sound.	When playing a monaural source with a pro-logic II listen mode the source signal is directed to the center channel, and the front and surround speakers output effect sounds.	
No sound from the effect speakers.	The sound field programs are turned off.	Select "6 stereo", another DSP mode or appropriate listen mode.
	You are using a source or program combination that does not output sound from all channels.	Try another sound field program.
No sound from the center speakers.	The output level of the center speaker is set to minimum.	Raise the level of the center speaker.
	"CENTER" in "Speaker Setting" is set to NONE.	Select the appropriate setting for the center speaker.
	2ch Stereo has been selected.	Select "6 stereo", another DSP mode or appropriate listen mode.
No sound from the surround speakers.	The output level of the surround speakers is set to minimum.	Raise the output level of the surround speakers.
	"SURR LR" in "Speaker Setting" is set to NONE.	Select the appropriate setting for the surround left and right speakers.
	A monaural source is being played with "2 STEREO".	Press "DSP" or "2/6STEREO" to turn on the sound fields or select "6 CH STEREO" mode.
No sound from the surround center speaker.	"Surround center" in "Speaker Setting" is set to NONE.	Select the appropriate setting for the surround center speaker.
	The source or the listen selected mode does not contain surround center signals.	Select "6 stereo" or another appropriate listen mode.
NO sound from the subwoofer.	"SW" in "Speaker Setting" is set to "NONE" when a Dolby Digital or DTS or other source signal is being played.	Select "SW" is "YES".
	The source does not contain low bass signals.	

Troubleshooting

Problem	Cause	Remedy
Dolby Digital or DTS sources cannot be played. (Dolby Digital or DTS indicator in the front panel display does not light up.)	The connected component is not set to output Dolby Digital or DTS digital signals.	Make an appropriate setting following the operations instructions for your component.
	No appropriate digital input source has been selected.	Select an appropriate digital input source with the input selector buttons.
A "humming" sound can be heard.	Incorrect cable connections.	Firmly connect the audio plugs. If the problem persists, the cables may be defective.
The volume level cannot be increased, or the sound is distorted.	The component connected to the PRE OUT(REC)jacks of this unit is turned off.	Connect the component to other analog input jacks of this unit.
The sound effect cannot be recorded.	It is not possible to record the sound effect with a recording component.	
A source cannot be recorded by an recording component.	The source component is not connected to this unit's analog the PRE OUT jacks.	Connect the recording component to the analog the PRE OUT jacks.
This unit does not operate properly.	The internal microcomputer has been frozen by an external electric shock (such as lightning or excessive static electricity) or by a power supply with low voltage.	Disconnect the AC power cord from the outlet and then plug it in again after about 30 seconds.
		Reset this unit, see page 40 "Resetting Factory Presets".
"Pa Pa" ringing from relay	Speaker cables are short circuited.	Make sure all speaker cables are connected correctly.
There is noise interference from digital or high-frequency equipment, or this unit.	This unit is too close to the digital or high-frequency equipment.	Move this unit further away from such equipment.
The picture is disturbed.	The video source uses scrambled or encoded signals to prevent dubbing.	
No picture to monitor,	Video signal is not input in correct source.	Change to a correct source.
	Video cable is bad.	Change a connecting cable.
This unit suddenly is turned off automatically. No sound, No any display.	The internal temperature becomes too high and the overheat protection circuitry has been activated.	Wait about 1 hour for this unit to cool down and then turn it back on.

■ Tuner

	Problem	Cause	Remedy
FM	FM stereo reception is noisy.	The characteristics of FM stereo broadcasts may cause this problem when the transmitter is too far away or the antenna input is poor.	Check the antenna connections. Try using a high-quality directional FM antenna. Use the manual tuning method.
	There is distortion, and clear reception cannot be obtained even with a good FM antenna.	There is multipath interference.	Adjust the antenna position to eliminate multipath interference.
	The desired station cannot be tuned in with the automatic tuning method.	The signal is too weak.	Use a high-quality directional FM antenna. Use the manual tuning method.
AM	Previously preset stations can no longer be tuned in.	This unit has been disconnected for a long period.	Preset the stations again.
	The desired station cannot be tuned in with the automatic tuning method.	This signal is weak or the antenna connections are loose.	Tighten the AM loop antenna connections and orient it for best reception. Use the manual tuning method.
	There are continuous crackling and hissing noises.	Noises result from lightning, fluorescent lamps, motors, thermostats and other electrical equipment.	Use an outdoor antenna and a ground wire. This will help some what, but it is difficult to eliminate all noise.
	There are buzzing and whining noises.	A TV set is being used nearby.	Move this unit is away from the TV.

■ Remote Control

	Problem	Cause	Remedy
	The remote control does not work nor function properly.	Wrong distance angle.	The remote control will function within a maximum range of 6 m(20 feet) and no more than 30 degrees offaxis from the front panel.
		Direct sunlight or lighting (from an inverter type of fluorescent lamp, etc.) is striking the remote control sensor of this unit.	Reposition this unit.
		The batteries are weak.	Replace all batteries.
		No batteries installed.	Install the batteries before attempting to operate the remote. Be sure to match the + and - ends of each battery to the symbols shown in the remote battery compartment.

Resetting Factory Presets

If you want to reset all of your unit's parameters for any reason, do the following. This procedure completely resets ALL parameters, including the "Speaker Setting", level, assign and tuner presets.

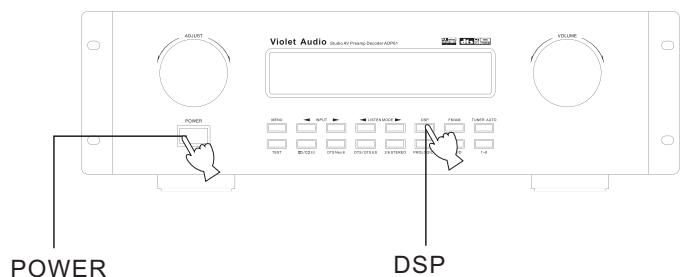

1. Be sure POWER of this unit is off.
2. Press and hold DSP button on the front panel, then press POWER button on the front panel.
3. Unclench DSP button until "SYSTEM RESET" is displayed on the display.



4. The unit is reset to its factory presets.

Playback Mode Display Abbreviations and Full Working Names

NO.	Display Ab.	Full working name
1	DTS DIG DSND	DTS DIGITAL SURROUND
2	DTS ES MTX	DTS ES MATRIX
3	DTS ES DISC	DTS ES DISCRETE
4	Neo. 6 MUS	Neo£6 MUSIC
5	Neo. 6 CIN	Neo£6 CINEMA
6	DOLBY D	DOLBY DIGITAL
7	DOLBY D EX	DOLBY DIGITAL SURROUND EX
8	PRO II MUSIC	DOLBY PRO LOGIC ¢ MUSIC
9	PRO II MOVIE	DOLBY PRO LOGIC ¢ MOVIE
10	D-D STEREO	DOLBY DIGITAL 2CH STEREO
11	D-D 6 STEREO	DOLBY DIGITAL 6CH STEREO

Available Selection All Listening Modes

- BYPASS(2 CH STEREO)
- 6 CH STEREO
- DOLBY DIGITAL
- DOLBY DIGITAL EX
- DOLBY PROLOGIC II MOVIE
- DOLBY PROLOGIC II MUSIC
- DTS
- DTS ES
- DTS 96/24
- Neo:6 CINEMA
- Neo: 6 MUSIC

When you play PCM-encoded music CDs or analog signals (include tuner),the following listen modes are available.

- BYPASS(2 CH STEREO)
- 6 CH STEREO
- DOLBY PROLOGIC II MOVIE
- DOLBY PROLOGIC II MUSIC
- Neo:6 CINEMA
- Neo: 6 MUSIC

When you play DOLBY DIGITAL or DOLBY DIGITAL SURROUND EX-encoded DVD/CDs,the following listen modes are available.

- DOLBY STEREO(2 CH STEREO)
- 6 CH STEREO
- DOLBY DIGITAL
- DOLBY DIGITAL EX

When you play DTS or DTS ES-encoded DVD/CDs, the following listen modes are available.

- DTS STEREO(2 CH STEREO)
- 6 CH STEREO
- DTS
- DTS ES
- DTS 96/24

When you play DTS 96KHz/24bit-encoded DVD/ CDs, this unit automatically switches to DTS 96/24 listen mode.In addition, the following listen modes are available.

- DTS STEREO(2 CH STEREO)
- 6 CH STEREO
- DTS 96/24

Specifications

PRE-AMPLIFIER SECTION:

6.1 channel.....	Line Out
Muting Attenuation.....	65dB
Frequency Response.....	20Hz to 20 kHz 1.5 dB

VIDEO SECTION:

Input (Sensitivity/Impedance).....	1Vp-p/75ohm
Output (Level/Impedance).....	1Vp-p/75 ohm

AM TUNER SECTION:

Tuning Range.....	520 to 1710 kHz
Step.....	10kHz
Frequency Response.....	80Hz - 2kHz +/-6dB
Usable Sensitivity.....	55dBu@ S/N 20dB
Image Ratio.....	27dB @ 1000kHz
IF Rejection.....	35dB

FM TUNER SECTION:

Tuning Range.....	87.5 to 108.0MHz
Step.....	0.05MHz
Frequency Response.....	40Hz - 15kHz +/-3dB
Quieting.....	24dBu
Image Ratio.....	40dB
IF Rejection.....	50dB

Specifications and features are subject to change without notice.

Violet Audio

ADP61

Studio AV Preamp Decoder

WWW.VIOLETAUDIO.COM