

# ***SDTV ENG/EFP Professional Lenses***



**A17x9B / S17x6.6B RM**

# A17x9B / S17x6.6B RM



LENS	A17x9B RM	S17x6.6B RM
Zoom Ratio / Format	17X / 2/3"	17X / 1/2"
Focal Length	9 to 155 mm	6.6 to 114 mm
Maximum Relative Aperture	F1.9 (to 115 mm) F2.6 (at 155 mm)	F1.5 (to 90 mm) F1.9 (at 114 mm)
Angular Field of View (Hor. x Vert. in °)	9mm 52° 06' x 40° 16' 155mm 3° 15' x 2° 26'	6.6mm 51° 44' x 39° 58' 114mm 3° 13' x 2° 25'
M.O.D. from Image Plane	0.9m	0.9m
Object Area (at Wide) at M.O.D (at Tele)	9mm 815mm x 611mm 155mm 47mm x 36mm	6.6mm 808mm x 606mm 114mm 47mm x 35mm
Filter Size (on Barrel)	ø 82 mm P=0.75	ø 82 mm P=0.75
Weight w/o hood	1.25 kg	1.25 kg
Features	Inner Focus	Inner Focus

## ACCESSORIES: HD & SD ENG/EFP PROFESSIONAL REAR CONTROL KITS

MS-01 Manual Focus/Servo Zoom

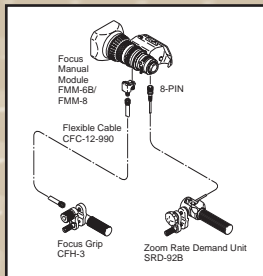

MM-01 Manual Focus/Manual Zoom  
Not available on S16x7.3

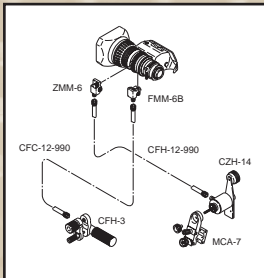

SS-01 Servo Focus/Servo Zoom  
Not available on S16x7.3

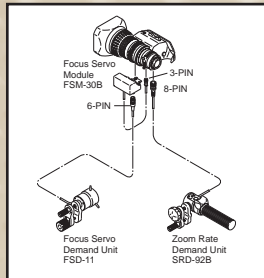

\*Specify camera type.

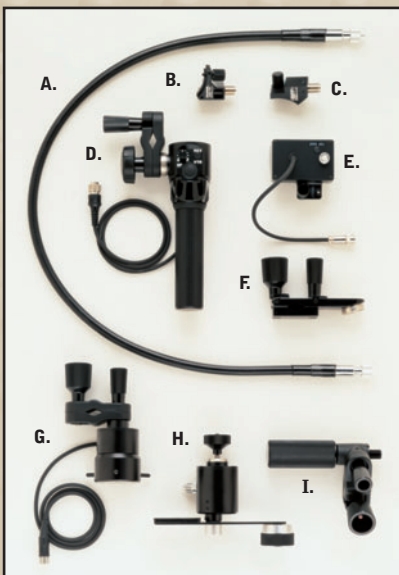

- A. CFC-990 Flex Cable
- B. FMM-6B/FMM-8\* Focus Manual Module
- C. ZMM-6 Zoom Manual Module
- D. SRD-92B Zoom Demand
- E. FSM-30B Focus Servo Module
- F. MCA-7 Mounting Clamp
- G. FSD-11 Focus Demand
- H. CZH-14 Zoom Handle
- I. CFH-3 Focus Handle

\*FMM-8 for use with S16x7.3

## ACCESSORIES: HD & SD ENG/EFP



Wide Attachment (WAT)



Fish-Eye Attachment (F-AT)

## BROADCAST LENS CONVERTERS

Model	Type	ø Size	Converter*	Mag.	Converted Focal Length (mm)	M.O.D. (m)	Weight (kg)
A18x7.6	TELE	85 mm	TCV-85C	1.6x	137.0→219.0	1.54	1.15
ERM/ERD	WIDE	85 mm	WCV-85C/L85	0.8x	7.6→6.1	0.38	1.09/0.57
	WIDE	85 mm	WAT-85C	0.7x	7.6→5.3	-	0.55
	FISHEYE	85 mm	F-AT85C	Approx. 0.55x	-	-	0.62
	RATIO	82 mm	RCV-82SC	0.82x	7.60→6.20	0.40	0.25
A23x7.6	TELE	100 mm	TCV-100C	1.6x	175.0→280.0	2.05	1.06
ERM/ERD	WIDE	100 mm	WCV-100D	0.8x	7.60→6.10	0.51	1.09
	WIDE	100 mm	WAT-100C	0.7x	7.60→5.30	0.39	0.00
	FISHEYE	100 mm	F-ATH100C	0.55x	7.60→4.20	0.24	0.55

## PROFESSIONAL LENS CONVERTERS

Model	Type	ø Size	Converter	Mag.	Converted Focal Length (mm)	M.O.D. (m)	Weight (kg)	
A13x6.3	TELE	85 mm	TCV-85C	1.6x	82.0→131.2	1.02	1.15	
RM/ERM	WIDE	85 mm	WCV-85C	0.8x	6.3→5.0	0.26	1.09	
	WIDE	85 mm	WAT-85C	0.7x	6.3→4.4	-	0.55	
A20x8.6	TELE	85 mm	TCV-85C	1.6x	172.0→275.2	2.30	1.15	
	RM/ERM	WIDE	85 mm	WCV-85C/L85	0.8x	8.6→6.9	0.58	1.09/0.57
	WIDE	85 mm	WAT-85C	0.7x	8.6→6.0	-	0.55	
	FISHEYE	85 mm	F-AT85C	Approx. 0.55x	-	-	0.62	
RATIO	82 mm	RCV-82SC	0.82x	8.6→7.1	0.61	0.25		
S13x4.6	TELE	85 mm	TCV-85C	1.6x	60.0→96.0	1.02	1.03	
RM/ERM	WIDE	85 mm	WCV-85C	0.8x	4.6→3.7	0.26	1.09	
	WIDE	85 mm	WAT-85C	0.7x	4.6→3.2	-	0.55	
	WIDE	85 mm	WAT-85C	0.7x	4.6→3.2	-	0.55	
S17x6.6	RM	TELE	85 mm	TCV-85C	1.6x	114→182.4	2.30	1.15
	WIDE	85 mm	WCV-85C	0.8x	6.6→5.3	0.58	1.09	
	WIDE	85 mm	WAT-85C	0.7x	6.6→4.6	-	0.55	
	FISHEYE	85 mm	F-AT85C	Approx. 0.55x	-	-	0.62	
S20x6.4	TELE	85 mm	TCV-85C	1.6x	128.0→204.8	2.30	1.15	
RM/ERM	WIDE	85 mm	WCV-85C/L85	0.8x	6.4→5.1	0.58	1.09/0.57	
	WIDE	85 mm	WAT-85C	0.7x	6.4→4.5	-	0.55	
	FISHEYE	85 mm	F-AT85C	Approx. 0.55x	-	-	0.62	

\*TCV/WCV are zoom thru type \*\*ø 95mm P-1 screw on type  
Wide attachment and fisheye attachment can be used at WIDE END.  
Number of M.O.D. is at wide end.