

# 12UCM product information sheet

## Product Specifications

**Fits most:** 13" - 24" flat panels

**Supports up to:** 40 lbs (18.1 kg)

**Tilt:** Up to 90°

**VESA compliant:** 75x75 and 100x100

**UL listed:** Yes

**Warranty:** 5 years

**Color:** Black and Silver

## Product Benefits

- Folds up when not in use
- Tilt and pan for multiple viewing angles
- Quick installation
- Includes complete Grade 5 hardware kit

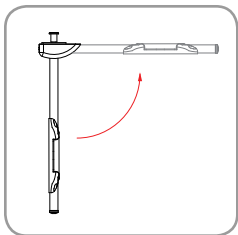

The 12UCM conveniently tucks away when not in use



UL LISTED

## Series



12UCM



17FM-F



17FM-T



37FM-F



17ARM

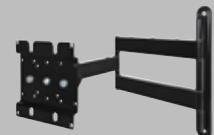

37ARM



48ARMUA



Dedicated to being a one-stop shop for professional products, OmniMount remains on the cutting edge of product innovation. That's why we're the natural choice for any professional, industrial or commercial application. Combined, the FastMount and ARM Series offer a full line of fixed, tilt, flip down and cantilever mounting solutions that are not only simple to install, but also reliable. The 12UCM is a small flip down mount that is the obvious choice for basic under cabinet installations.



# 12UCM technical data sheet



Dedicated to being a one-stop shop for professional products, OmniMount remains on the cutting edge of product innovation. That's why we're the natural choice for any professional, industrial or commercial application. Combined, the FastMount and ARM Series offer a full line of fixed, tilt, flip down and cantilever mounting solutions that are not only simple to install, but also reliable. The 12UCM is a small flip down mount that is the obvious choice for basic under cabinet installations.

## Product Specifications

**Fits most:** 13" - 24" flat panels

**Supports up to:** 40 lbs (18.1 kg)

**Tilt:** Up to 90°

**VESA compliant:** 75x75 and 100x100

**UL listed:** Yes

**Warranty:** 5 years

**Color:** Black and Silver

## Product Benefits

- Folds up when not in use
- Tilt and pan for multiple viewing angles
- Quick installation
- Includes complete Grade 5 hardware kit

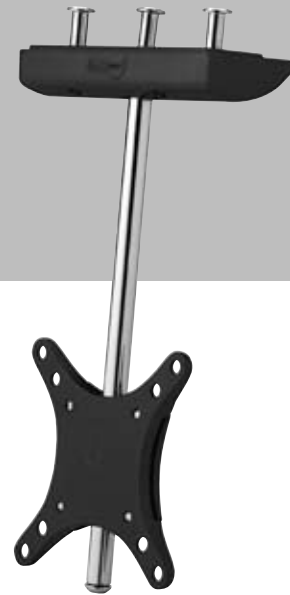

	Color	Stock Code	Packaging UPC	MC UPC
<b>Americas</b>	Black	1003102PRO	728901017698	728901711008
<b>International</b>	Black	NA	NA	NA
<b>Americas</b>	Silver	1002772-1	728901015977	728901709265
<b>International</b>	Silver	NA	NA	NA

	Dimensions WxDxH inches (mm)	Wt lbs (kg)
<b>Product Box</b>	4.6 x 11.4 x 1.7 (118x289x44)	2.2 (1)
<b>Master Carton</b>	5.3 x 12 x 7.5 (135x305x191)	8.8 (4)

Box Contents	Qty
Flip down mount	1
Complete mount installation hardware kit	1
Complete panel attachment hardware kit	1
Instruction manual	1
Flat panel compatibility chart	1

# 12UCM line drawing

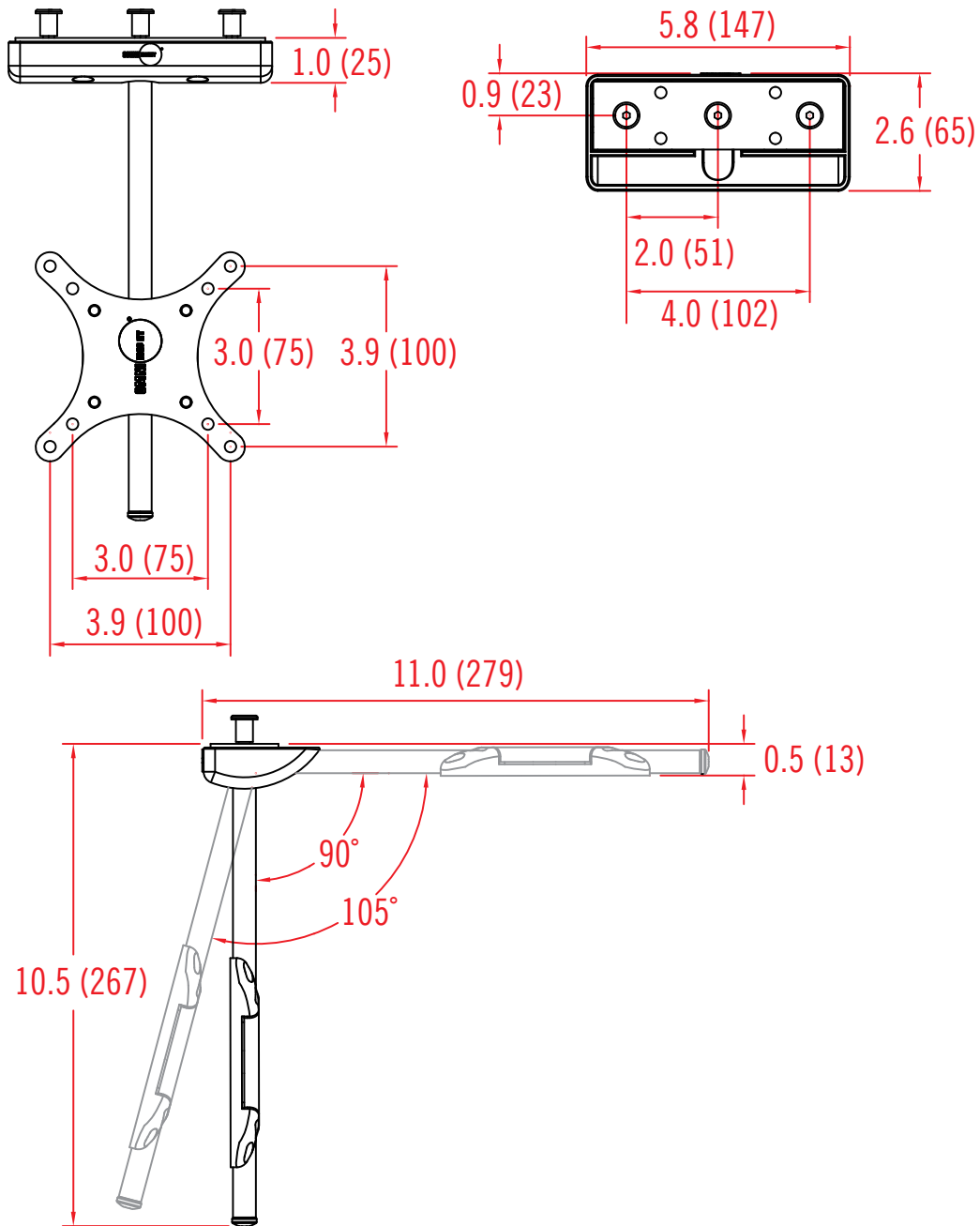

inches (mm)

## Architects Specifications

The under counter mount shall be an OmniMount model 12UCM and shall be located where indicated on the plans. It shall be constructed of sheet metal. Assembly and installation shall be done according to instructions provided by the manufacturer.