

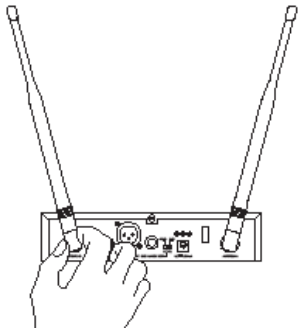

# R300

UHF WIRELESS MICROPHONE – Handheld Transmitter

## QUICK START GUIDE



1. Install Antennas

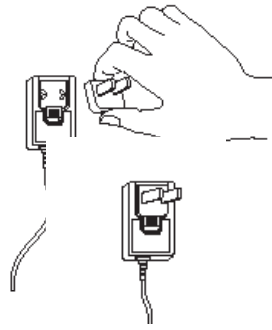

2. Install AC Adapter Blades



3. Plug in Receiver

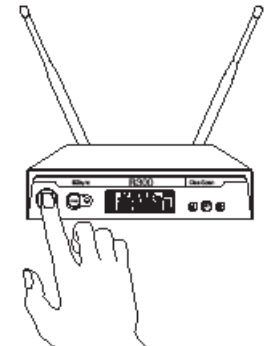

4. Turn on Receiver

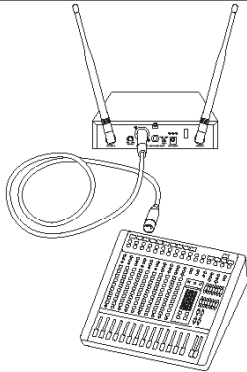

5. Plug Receiver into Audio System

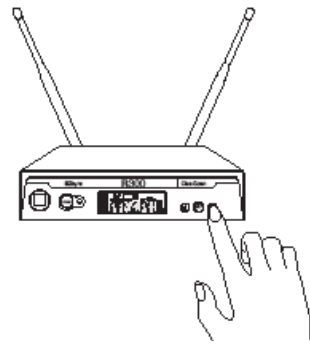

6. Press and Hold ► Until CLEARSCAN Appears

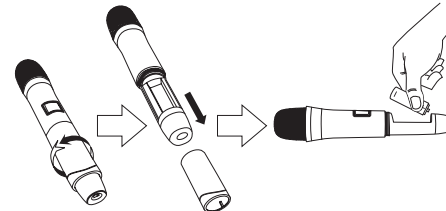

7. Install Batteries in Transmitter

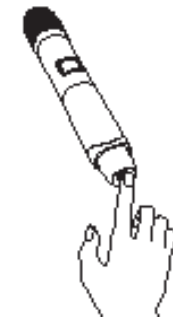

8. Turn on Transmitter

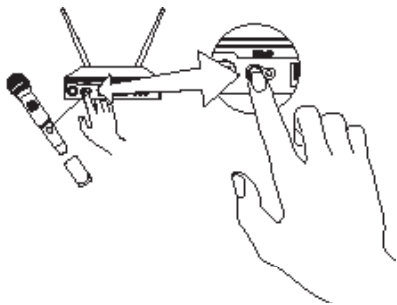

9. EZSync Transmitter

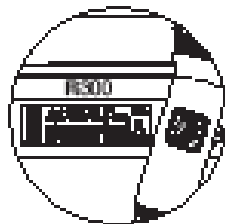

10. Verify Reception

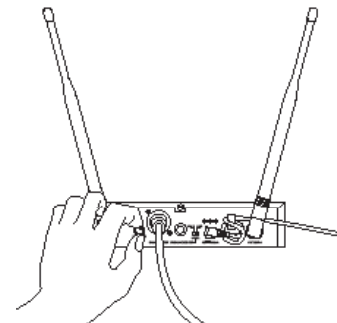

11. Adjust Gain



12. Start Using the R300



# R300

## UHF WIRELESS MICROPHONE – Bodypack Transmitter

### QUICK START GUIDE

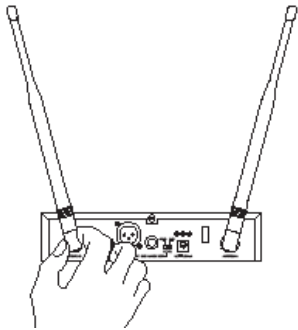

1. Install Antennas

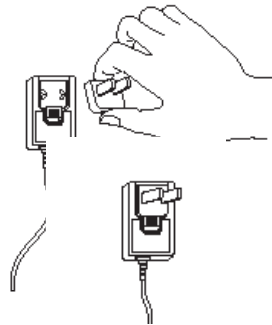

2. Install AC Adapter Blades



3. Plug in Receiver

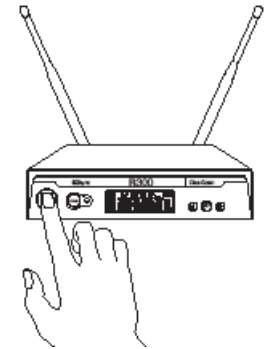

4. Turn on Receiver

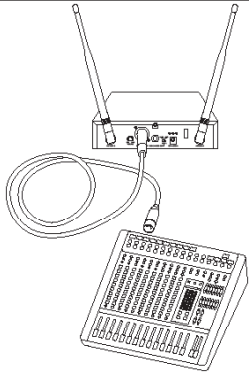

5. Plug Receiver into Audio System

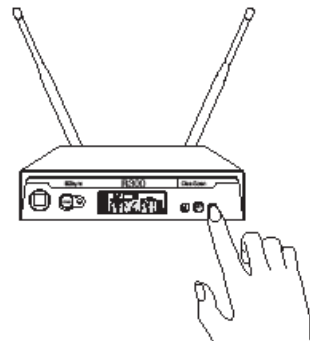

6. Press and Hold ► Until CLEARSCAN Appears

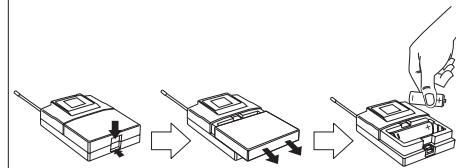

7. Install Batteries in Transmitter

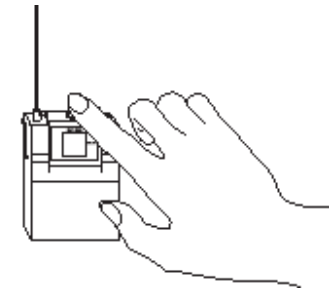

8. Turn on Transmitter

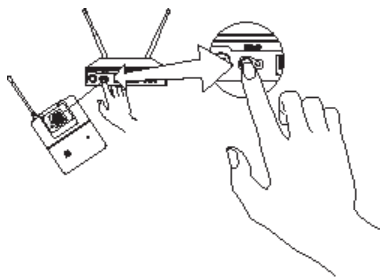

9. EZSync Transmitter

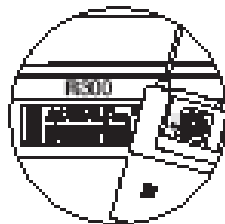

10. Verify Reception

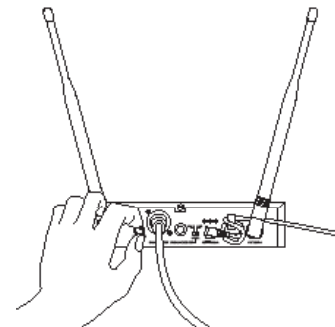

11. Adjust Gain



12. Start Using the R300