

MPC 22

Acoustical Boundary Microphone



FEATURES

- Aimable half-cardioid polar pattern
- High gain-before-feedback
- Flat, wide range frequency response
- High-quality reproduction of speech
- Unobtrusive design
- Ceiling or tabletop mounting
- Fast and easy installation

APPLICATIONS

The MPC 22 acoustical boundary microphone is designed for mounting into tabletops and ceilings. The half-cardioid polar pattern is aimable and assures high-gain-before feedback. The high sensitivity guarantees a constant output level even from long distance sources. Elastic bearing rings achieve mechanical isolation from the mounting surface and therefore offer effective sound isolation of the microphone. The MPC 22 is designed for applications such as tele/video conferencing, recording or amplification of round table discussions and wherever the microphone needs to be as unobtrusive as possible.

VERSIONS

MPC 22 sw	Half-cardioid, black	Order # 441.589
MPC 22 ws	same as above, but white	Order # 441.597
MPC 22 EQ3 sw	Half-cardioid, black, bass roll off filter	Order # 447.190
MPC 22 EQ3 ws	same as above, but white	Order # 447.218

SUPPLIED ACCESSORIES

- Elastic bearing rings

INSTALLATION

- Mounting hole with elastic bearing rings: Ø 24 mm (15/16")
- Mounting hole with elastic bearing rings: Ø 20 mm (13/16")
- Max. table-/ceiling thickness: 57 mm (2.25")

Germany

Theresienstr. 8
D-74072 Heilbronn
Tel. +49 (0)71 31 / 6 17-0
Fax +49 (0)71 31 / 617-224
E-mail: info@beyerdynamic.de
Internet: www.beyerdynamic.de

United States

56 Central Ave.
Farmingdale, NY 11735
Tel. +1 (631) 293-3200
Fax +1 (631) 293-3288
E-mail: salesUSA@beyerdynamic.com
Internet: www.beyerdynamic.com

Great Britain

17 Albert Drive
Burgess Hill RH15 9TN
Tel. +44 (0)1444 / 258 258
Fax +44 (0)1444 / 258 444
E-mail: sales@beyerdynamic.co.uk
Internet: www.beyerdynamic.co.uk

TECHNICAL SPECIFICATIONS

Transducer type	Condenser (back electret)
Operating principle	Pressure gradient
Frequency response	60 - 20,000 Hz
Polar pattern	Half-cardioid
Open circuit voltage	15 mV/Pa \pm -36.5 dBV
Nominal output impedance	200 Ω
Load impedance	\geq 1000 Ω
Max. SPL at 1 kHz	124 dB
Signal-to-noise ratio rel. to 1 Pa	60 dB
A-weighted equivalent SPL	26 dB
Supply voltage	8 - 52 V phantom power
Consumption	3.4 mA
Connector	3-pin XLR male
Dimensions	
Height x Head diameter	9 x 30 mm
Weight	approx. 70 g

FREQUENCY RESPONSE & POLAR PATTERN

This frequency response curve (measuring tolerance \pm 2.5 dB) and polar patterns correspond to a typical production sample for this microphone.

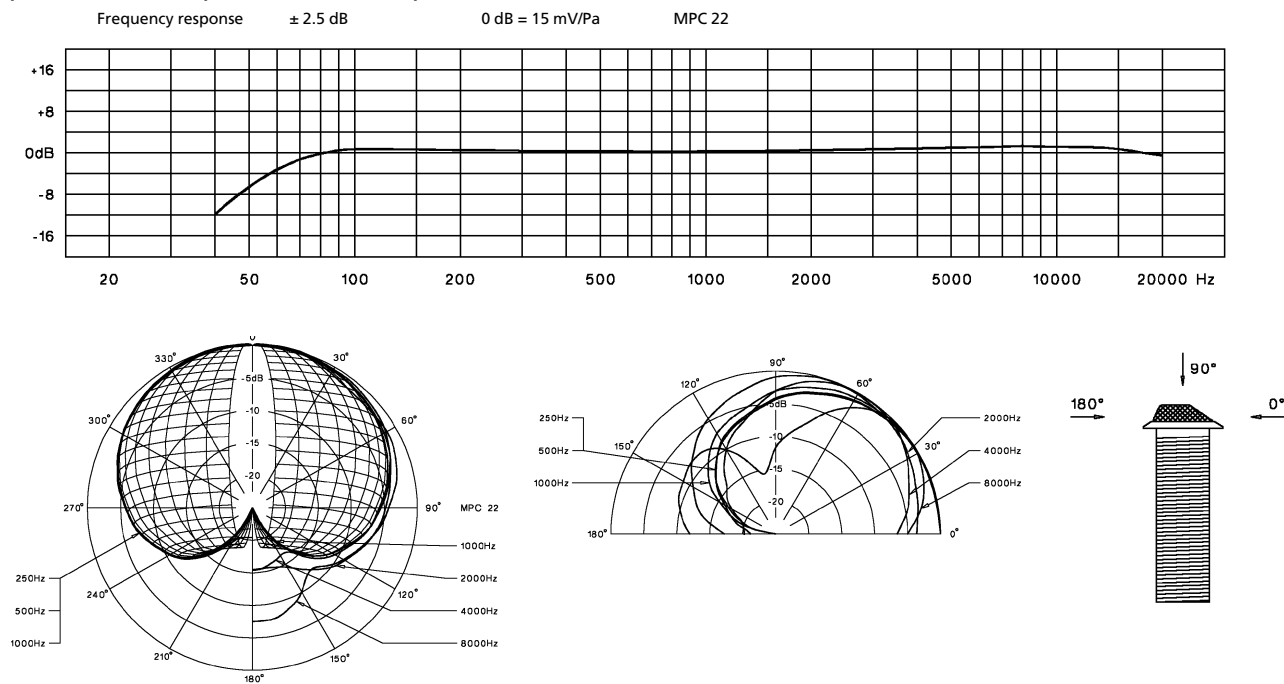

MEASUREMENTS

In millimetres (inches in brackets)

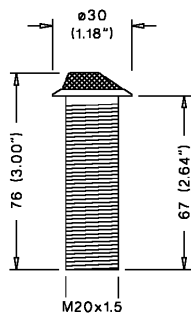

WIRING DIAGRAM

Positive pressure produces positive voltage on pin 2.

