

Model No. **LWBR-4022**

- **Wall-mount rack with support base**
- **40U x 22.4"D x 23.06"W**

The LWBR provides convenient access to equipment in wall-mount applications as the cabinet swings open and pivots smoothly on stainless steel ball transfers set into a support base. A keyed lock in the front secures the cabinet to the backbox, while allowing side-by-side installations. Welded 16-gauge steel construction is finished with beveled corners and a durable black wrinkle powder epoxy paint. Optional front doors for cabinet and base.

Construction & Features

- **Cabinet:** Opens with single-release grasp, then pivots smoothly on stainless steel ball transfers, swinging 90 degrees to access equipment connections. The right-hinged swing can be changed to left using internal spring-loaded hinges. Sides are vented at top and bottom. Side vents have notches to mount optional single-fan kit. Slam latch closure.
- **Base:** Stainless steel ball transfers in the base allow cabinet to pivot smoothly under 500 lbs. load. Base includes two access panels (top and front). Remove front panel to gain an additional 4 rack units of space for mounted equipment.
- **Backbox:** 4.69"D backbox mounts on 16" centers and features a large central cutout area.
- **Cable Management:** Removable knockout panel on top of backbox features 0.5" knockouts for wireless antennas and combination knockouts (.75-.5" and 1.5-1.0") for conduit.
- **Top:** Opening with integral E.I.A. rail accommodates standard 19" accessories. A 4U solid panel used as a shipping stiffener can also be used to close the top.
- **Adjustable Mounting Rails:** Includes one pair of adjustable mounting rails with printed scale to aid equipment installation. Rails are recessed .63" from front, allowing 1.38" clearance between equipment knobs and optional front door.
- **E.I.A./T.I.A. compliant**
- **Made in the U.S.A.** with 100% certified U.S. steel

A&E Specifications

The E.I.A. compliant wall-mount rack shall be Lowell Model No. LWBR-4022, which shall consist of a backbox and cabinet with base. Overall measurements shall be 85.78"H x 22.4"D x 23.06"W with 40U rack space. Construction shall be 16 gauge welded steel with beveled corners and black wrinkle powder epoxy finish. The cabinet shall provide 90 degree pivot capability and swing open from a right hinge, which shall be field-change-



Extra 4U rack space in base — ideal for optional 4U utility drawer.



(L to R) Pin for optional front door can be moved to change swing orientation; stainless steel balls help transfer weight smoothly as cabinet swings open; front key lock secures cabinet to backbox while allowing side-by-side installs.

able to left swing orientation. The cabinet shall feature vented side panels, one pair of adjustable mounting rails, and a keyed lock to secure it to the backbox. It shall include side-mounted fixed rails to accommodate optional power strips. The open top shall have knockouts for conduit, knockouts for BNC antennas, lacing points, and provisions to attach board-mounted accessories. The base shall include stainless steel ball transfers and two access panels to provide an additional 4U of panel space when the front panel is removed. It shall have a load rating of 500 lbs. The backbox with center opening shall be 4.69"D and mount on 16" centers.

Technical Drawings

Measurements are inches.

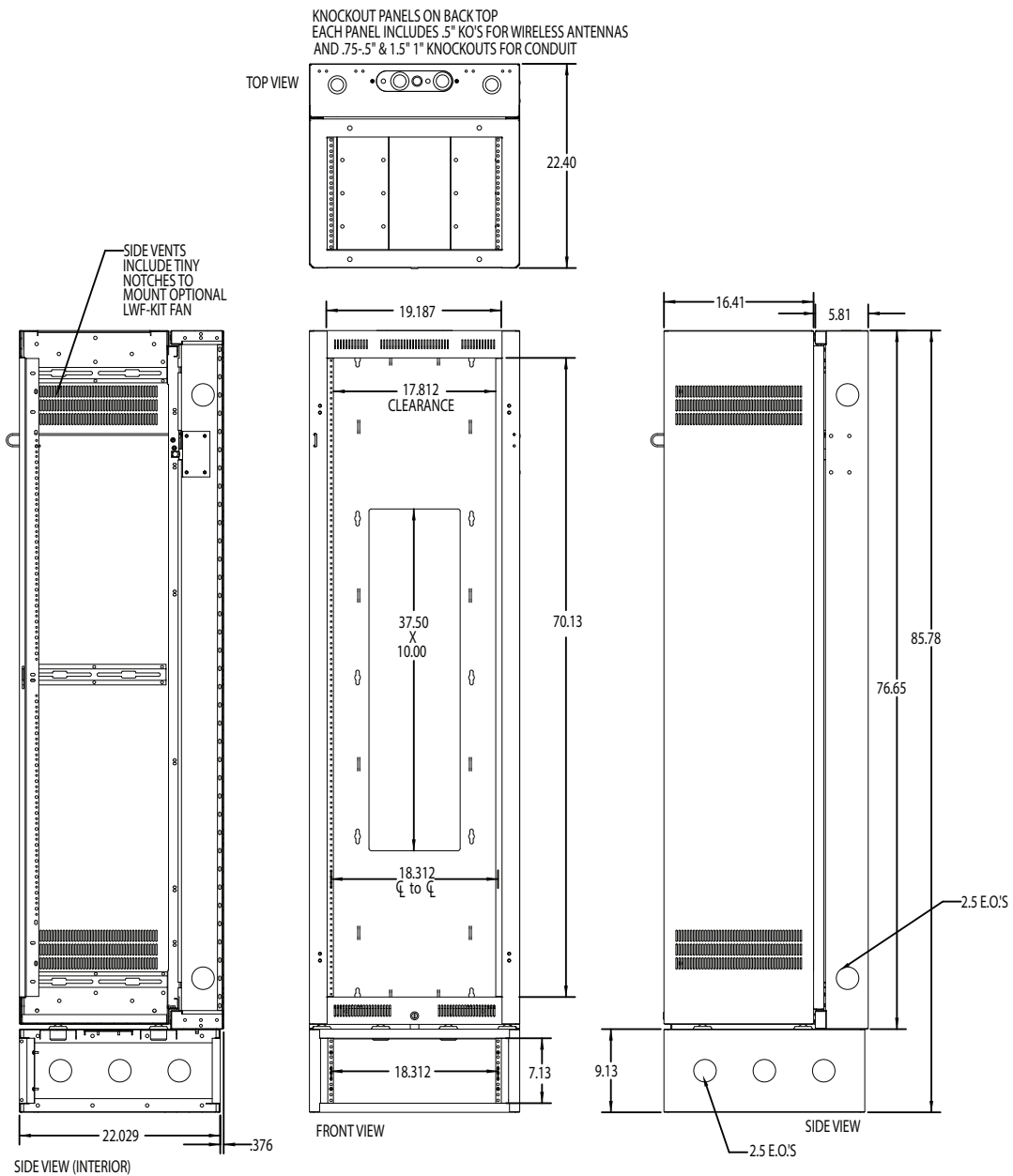

Corner Install Detail

Measurements are inches.

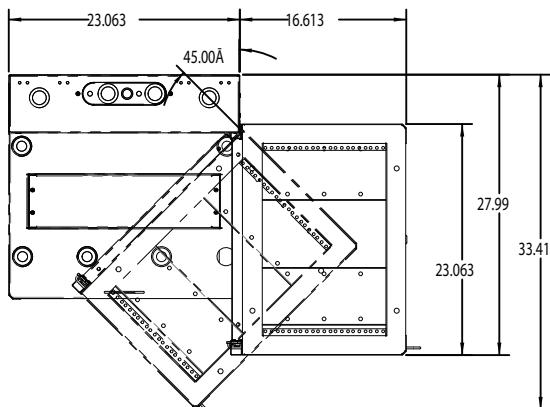

ALLOW 1" FOR OPTIONAL DOOR DEPTH
AND ROOM TO ACCESS SIDE LOCKS

Options

Front Door (LFD Series): Surface-mount front door with key lock mounts left or right without drilling. Front rail clearance to inside of door is 2.5." Available in solid steel, fully vented steel or smoked plexiglass.

Front Base Door (LWBR-BD4): Short door for support base provides flush closure to protect equipment.

Utility Drawer (UDP-414): Includes liner and key lock.

Additional Mounting Rails (RRD-40): 40U rails tapped 10-32 mount anywhere along side brackets.

Magnetic Vent Blockers (MVBLWBR): Set of four magnetic strips aids active thermal management. The strips are typically mounted on the rack's interior to cover front/side vents.

Single Fan Kit (FW1-KIT): Single whisper fan for spot cooling mounts to special notches in rack vents. 50cfm airflow.



Optional flush door
with key lock for base
No. LWBR-BD4.

Model No. Summary

Model No.	Description	Panel Space	Overall Depth	Mtg. Section Depth	Overall Ht	Backbox Ht
LWBR-4022	Pivoting wall rack with base	70.13" / 40U	22.4"	17.53"	85.78"	76.65"
Options						
LFD-40	Solid front door					
LFD-40P	Smoked plexiglass front door					
LFD-40FV	Fully vented front door					
LWBR-BD4	Solid flush-mount door for base					
UDP-414	4U utility drawer					
RRD-40	Additional mounting rails (1 pr, 40U)					
MVBLWBR	Magnetic vent blocker kit					
FW1-KIT	Single fan kit					

1 rack unit (RU or U) = 1.75 inches or 44.45 mm.