



MSD Platinum (Touring/Stage)

MSD Platinum (Touring/Stage)

MSD Platinum 16 R 1CT/8

The MSD Platinum lamps open up new levels of creative freedom in entertainment lighting, with powerful, compact and brilliantly intense light. Their compact, lightweight design provides the freedom to create smaller, lighter luminaires – for use at any location on stage. And their short arc, high color temperature and innovative reflector produce a sparkling, high beam intensity for outstanding color reproduction. They also offer long and reliable lifetime, high efficacy and fast replacement times. It all adds up to an intensely exciting creative experience.

Product data

• General Information

Cap-Base	- [-]
Operating Position	Universal [Universal]
Main Application	Stage/Touring
Life To 50% Failures (Nom)	1500 h
System Description	Reflector E21.9 TCM

• Light Technical

Color Code	2
Initial lumen (Min)	14300 lm
Initial lumen (Nom)	16000 lm
Chromaticity Coordinate X (Nom)	299
Chromaticity Coordinate Y (Nom)	303
Correlated Color Temperature (Nom)	8000 K
Color Rendering Index (Nom)	-

• Operating and Electrical

Power (Rated) (Nom)	330 W
---------------------	-------

• Controls and Dimming

Dimmable	Yes
----------	-----

• Mechanical and Housing

Cap-Base Information	na [-]
----------------------	--------

• Luminaire Design Requirements

Bulb Temperature (Max)	900 °C
Pinch Temperature (Max)	350 °C

• Product Data

Full product code	871829170438600
Order product name	MSD Platinum 16 R 1CT/8
EAN/UPC - Product	8718291704386
Order code	293050
Numerator - Quantity Per Pack	1
Numerator - Packs per outer box	8
Material Nr. (12NC)	928195205314
Net Weight (Piece)	0.080 kg

PHILIPS

Warnings and Safety

- A lamp breaking is extremely unlikely to have any impact on your health. If a lamp breaks, ventilate the room for 30 minutes and remove the parts, preferably with gloves. Put them in a sealed plastic bag and take it to your local waste facilities for recycling. Do not use a vacuum cleaner.

Dimensional drawing

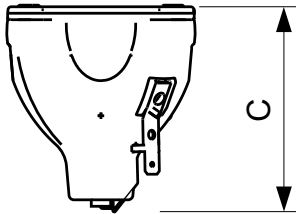
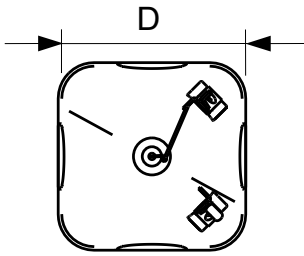

MSD Platinum 15 R, 16 R

Warnings and Safety

- A lamp breaking is extremely unlikely to have any impact on your health. If a lamp breaks, ventilate the room for 30 minutes and remove the parts, preferably with gloves. Put them in a sealed plastic bag and take it to your local waste facilities for recycling. Do not use a vacuum cleaner.

MSD Platinum 16 R

Product	D	O	C
MSD Platinum 16 R 1CT/8	58.5 mm	1.3 mm	66.4 mm

Photometric data

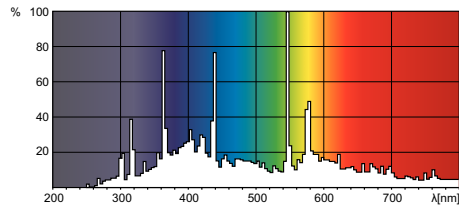
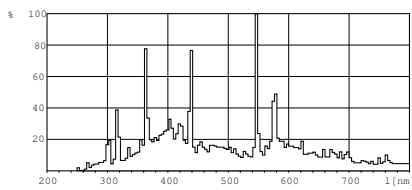

© 2015 Philips Lighting Holding B.V.
All rights reserved.

Specifications are subject to change without notice. Trademarks are the property of Koninklijke Philips N.V. (Royal Philips) or their respective owners.

www.philips.com/lighting

2015, December 7
data subject to change