

MTC

Mobile Transport Cart

Installation Guide

Installationsanleitung, Guía de Instalación, Guida de Installazione, Guide d'Installation, Installatie gids

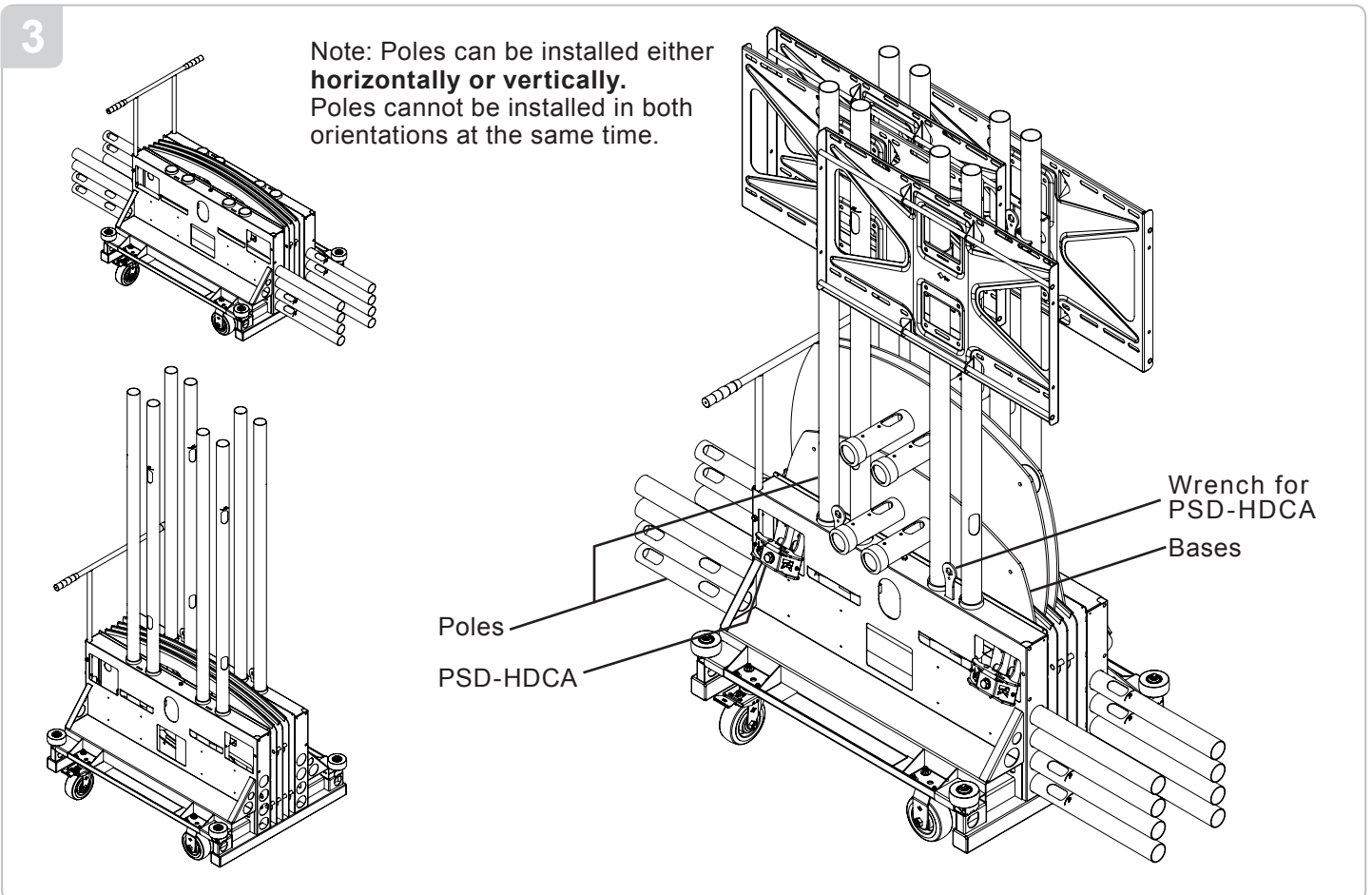
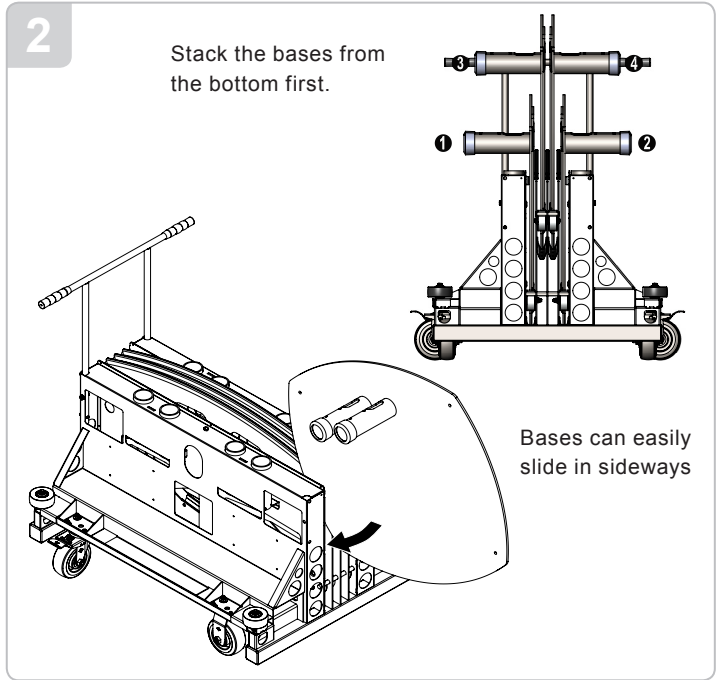
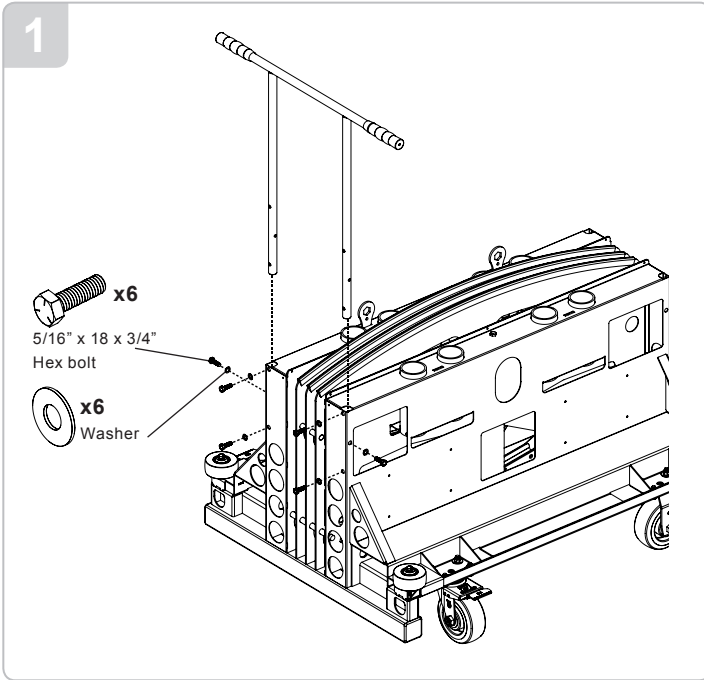

Limited Warranty - Mobile Transport Cart

Limited Warranty. Progressive Marketing Products, Inc. (d/b/a Premier Mounts) (“**Premier Mounts**”) warrants to the original buyer (“**Buyer**”) that any of the Mobile Transport Cart components designed and manufactured by Premier Mounts (“**Product**”) shall be free from defects in material and workmanship which substantially impair their ability to perform their intended function for a period of three (3) years – except that the casters (wheels) are warranted to be free from defects in material and workmanship which impair their ability to perform for a period of two (2) years and any factory-applied powder coat painted finish is warranted to be free from substantial manufacturing-related visible peeling or cracking or chalking under normal atmospheric conditions for a period of one (1) year (“**Finish Warranty**”) – from the date of shipment of the Product (“**Warranty Period**”). **This Limited Warranty may not be assigned or transferred by the Buyer.**

WARRANTY LIMITATIONS

This Limited Warranty covers only the Product and not any other materials not provided by Premier Mounts. This Limited Warranty does not cover damage to the Product that occurs during its shipment, storage, installation or use, or from force majeure acts. This Limited Warranty shall be void if (A) any Product that was purchased from anyone other than Premier Mounts or one of its authorized resellers, (B) assembly of the Product is not performed in accordance with the Premier Mount’s Product Information, (C) if the Product has been modified, repaired, or reworked in a manner not previously authorized by Premier Mounts in writing, (D) more than 550 lbs are placed on the Product, (E) the Product is used on an unpaved or soft surface such as grass, dirt or sand, (F) a caster is hit or otherwise impacts with a forklift, dock or truck, (G) the surface or exterior of a Product that has been defaced, scratched or has been exposed to foreign chemicals, corrosive materials or conditions, (H) any claim relating to failure, loss or damage caused by neglect, misuse or abuse; improper operation or storage; improper transport of the Product, including but not limited to, failure to secure the Product during transport; modification or alteration; improper loading of the Product; collisions with other objects; failure to follow proper operating procedures; or failure to maintain the Product in accordance with reasonable and customary maintenance procedures.

ORIGINAL WARRANTY CLAIMS

If, within the Warranty Period, the Product shall be proven at Premier Mount’s sole discretion to be nonconforming, then Premier Mounts shall repair or provide a replacement for the nonconforming Product, or any nonconforming part thereof, at Premier Mount’s option. Any such repair or replacement does not cause the beginning of new warranty terms, nor shall the Warranty Period of this Limited Warranty be extended. Premier Mount’s aggregate liability for all warranty claims shall not exceed the original Purchase price of the nonconforming Product. Buyer’s right to the benefits of this warranty are conditioned on Buyer’s cooperation with Manufacturer’s reasonable requests which it deems necessary to verify that the claimed defect is covered by this Limited Warranty. A repair shall be deemed acceptable if the defect does not affect a Product’s performance and the defect is not plainly visible from a distance of seven feet. Buyer shall bear all costs of shipment or transportation related to the repair or replacement of the nonconforming product. Such repair or replacement shall be Buyer’s sole remedy and shall fulfill all of Premier Mount’s obligations with respect to the Product and all warranty claims.

What You Must Do To File a Claim. To file a claim under this Warranty, you must call Premier Mounts’ Customer Care line at 1-877-668-6830 within (30) days after Owner has actual or constructive notice of a product which is allegedly defective. Premier Mounts will issue an RMA Case Number, and the claim along with defective product shall be sent to: Premier Mounts, 1321 South State College Blvd., Fullerton, CA 92831, Attention RMA#. All claims shall provide details explaining the nature of the claim and the date of detection. Owner waives any claims not made in this manner during the Warranty Period. Premier Mounts shall have a full and complete opportunity to inspect any alleged defect and review any records concerning the alleged defect. Within a reasonable time after proper notification, Premier Mounts will evaluate your claim and resolve it in accordance with the terms of this Warranty. You should retain this certificate for your records in the event you need to file a claim.

Sole and Exclusive Warranty. THIS WARRANTY IS EXCLUSIVE AND REPLACES ALL OTHER WARRANTIES, WHETHER EXPRESS OR IMPLIED, INCLUDING THE IMPLIED WARRANTIES OF MERCHANTABILITY AND FITNESS FOR A PARTICULAR PURPOSE. This written warranty is your exclusive warranty from Premier Mounts and represents the SOLE REMEDY available to any owner of Premier Mounts’ Mobile Transport Card. Premier Mounts makes NO OTHER REPRESENTATION OR WARRANTY of any kind other than that stated herein. PREMIER MOUNTS WILL NOT BE LIABLE IN ANY EVENT FOR CONSEQUENTIAL, INDIRECT OR INCIDENTAL DAMAGES OF ANY KIND, whether for breach of this warranty, negligence, strict liability in tort, or for any other cause.

Some states do not allow the exclusion or limitation of incidental or consequential damages so the above exclusions or limitations may not apply to you.

Modification of Warranty. This Limited Warranty may not be changed or modified. No one, including any representative or employee of Premier Mounts or any authorized reseller, has authority to assume any additional liability or responsibility for Premier Mounts. This Warranty gives you specific legal rights, and you may have other rights which vary from state to state.

