

Installation Guidelines

Congratulations on purchasing a **SonoSuede™ System** from **Auralex® Acoustics**. You're now on your way to creating a world-class critical listening environment.

SonoSuede Systems offer a unique and sophisticated look beyond traditional acoustical fabrics by utilizing a synthetic suede. The **SonoSuede System** contains both 1" thick absorptive panels and 2" thick corner bass trap panels, which when used together, provide incredibly effective broadband absorption in any room. Use the **SonoSuede System** alone for treatment of small to medium-sized rooms or in combination with other **Auralex** products for full control of larger spaces.

Thank you for Purchasing **Auralex® Total Sound Control® Products!**

SonoSuede™ Systems



SonoSuede HT™



SonoSuede Pro™

SonoSuede™ Systems General Information

SonoSuede HT™ (S3HT) System

This kit contains: (4) S3CT and (8) S3TZ (4L/4R) SonoSuede Panels with mounting hardware.

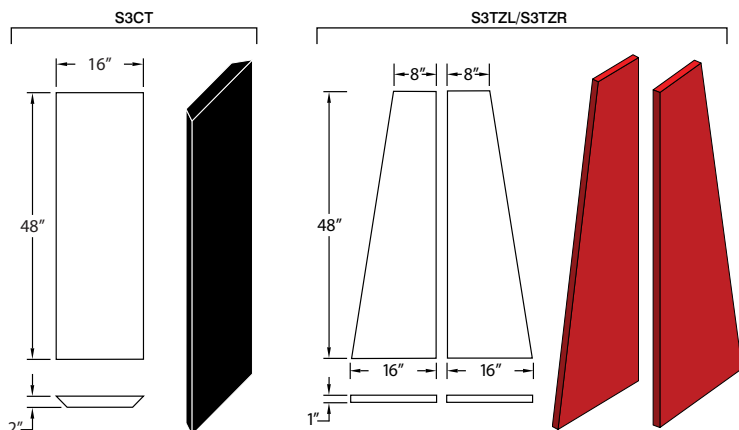

SonoSuede Pro™ (S3PRO) System

This kit contains: (4) S3CT and (8) S3PP SonoSuede Panels with mounting hardware.

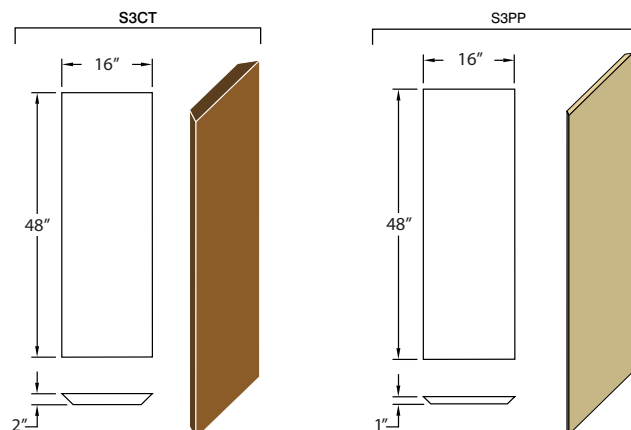

SonoSuede Panels

- 1 Mark intended location of each **SonoSuede** panel on the wall or ceiling.

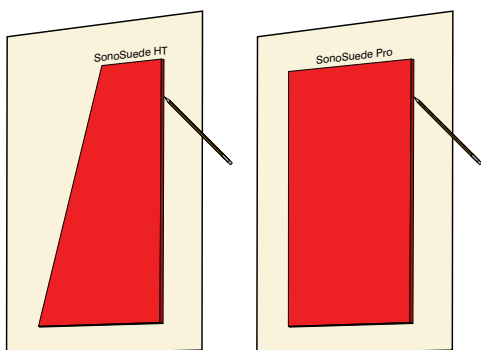

- 2 Install 3 impaling clips within marked **SonoSuede** panel location using drywall screws.

Exact placement of each clip is not necessary.

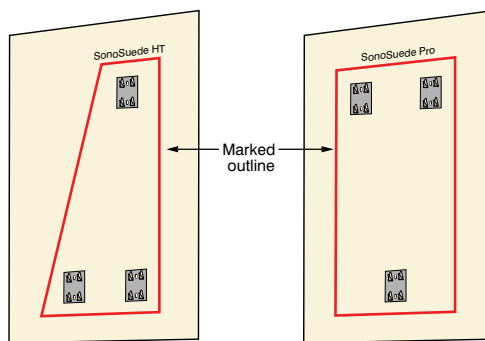

- 3 For improved performance, particularly at low frequencies, space the panel off the wall using the included 1" foam spacer.

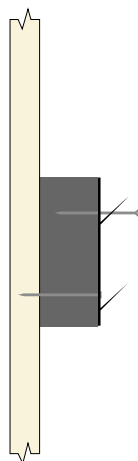

Place the spacer behind the impaling clip, and use at least 1.5" drywall screws to attach the clip (*through the spacer*) to the wall.

This step is optional.

- 4 Start the **SonoSuede** panel $\frac{5}{8}$ " above its intended final height and press downward at a 45° angle until the panel is either flush with the wall/ceiling surface or tight against the impaler clip.

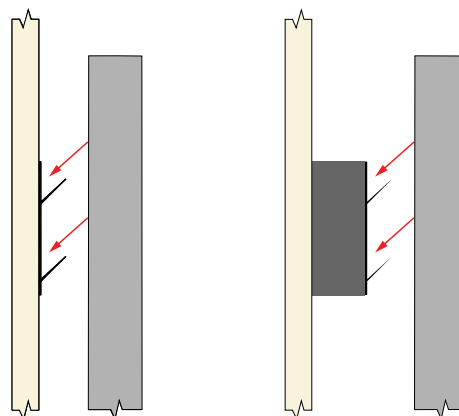

S3CT Corner Installation Guide

- 1 Mark a vertical line 11.2" from the intended placement corner on both sides.

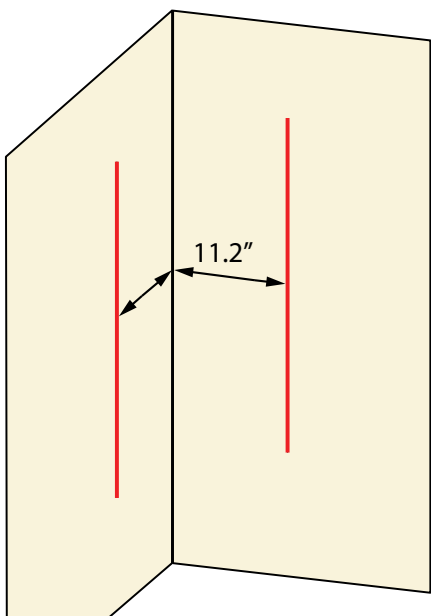

- 2 Hold S3CT in corner with edges aligned to the marked vertical lines.

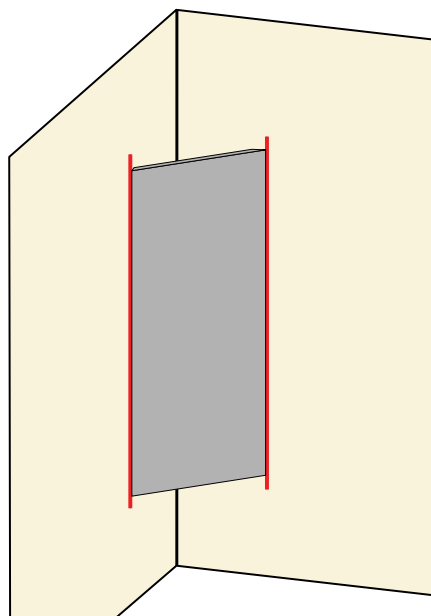

- 3 While continuing to hold panel in place, install one finish nail through the top hardened edge and the side hardened edge of the S3CT. Do not hammer nail completely flush with the face of the panel. Make sure finish nail is installed perpendicular to the wall surface. Repeat in each of the four corners.

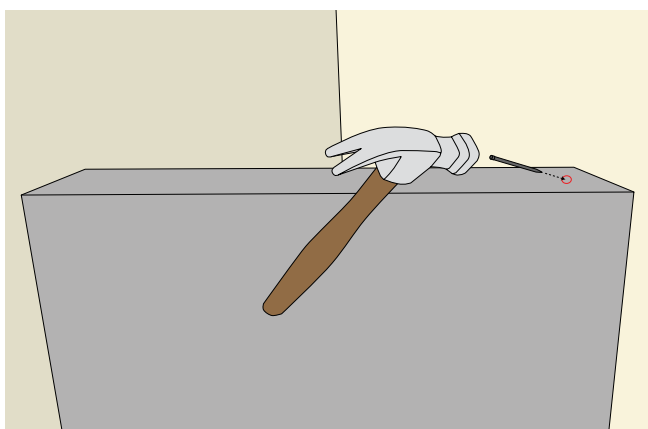

- 4 Using a nail set or another finish nail, carefully countersink installed nail so its head goes through the fabric surface of the S3CT but not through the hardened edge.

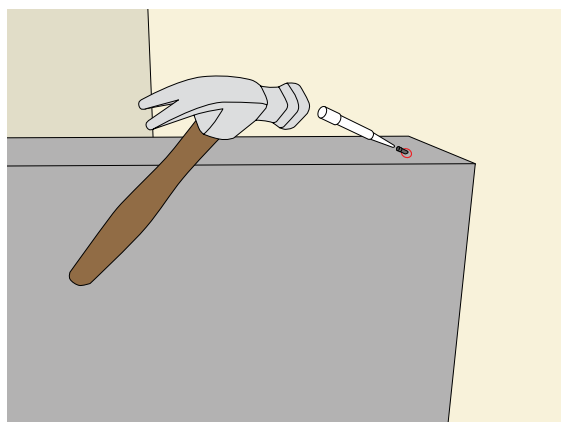

- 5 Once the finish nail has been countersunk into the panel, there may be a small hole remaining in the fabric covering. Simply scrape the fabric in this area with your fingernail and the hole will completely disappear.

Sonosuede HT



Sonosuede Pro



See the **Auralex® Acoustics** website, www.auralex.com, for more information about these and other **Total Sound Control®** products.

These are general recommendations. Should you have any additional questions about the installation of your **SonoSuede™ System**, feel free to contact an **Auralex® Application Specialist** via email at appsupport@auralex.com or call **1-800-95-WEDGE**.

The logo for Auralex acoustics features a stylized sunburst or starburst icon to the left of the word "Auralex" in a bold, sans-serif font. Below "Auralex" is the word "acoustics" in a smaller, lowercase, sans-serif font.