



VP-421

Computer Graphics Video & HDTV ProScale™ Digital Scaler (with DVI Output)



Compatible with HDTV component video signals when used with a breakout cable such as the Kramer C-GM/3RVP.



The **VP-421** is a high-performance digital scaler for computer graphics video and HDTV signals. It scales the input up or down to a selectable computer graphics video or HDTV output signal on a 15-pin HD and DVI connector.

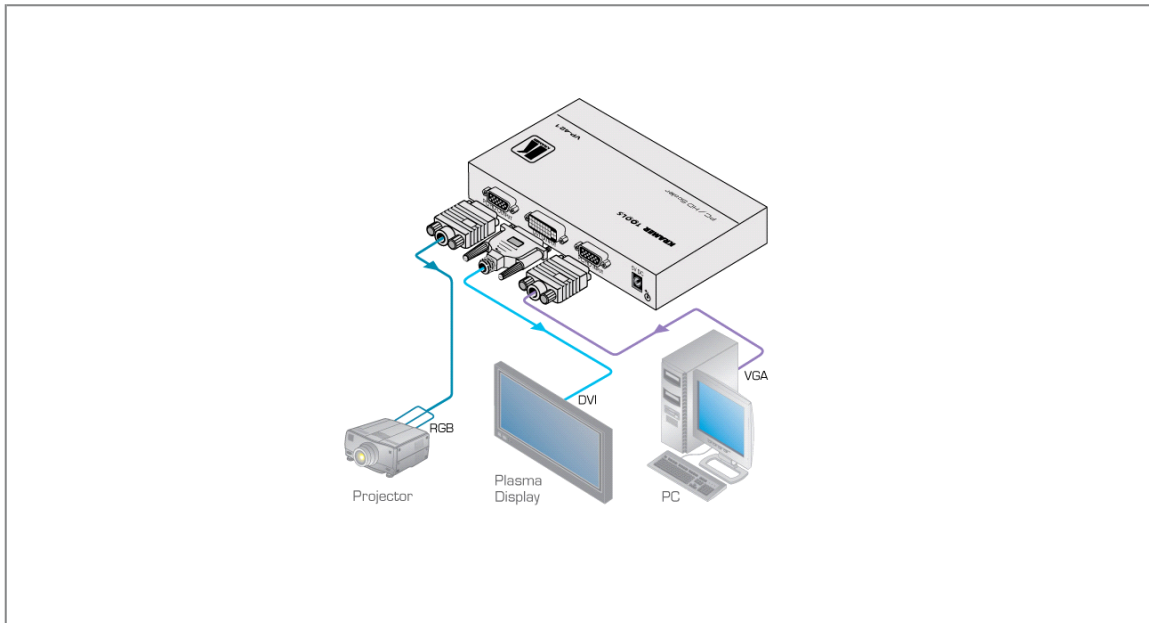



VP-421

FEATURES

- Max. Resolution - WUXGA & 1080p.
- HDTV Compatible.
- Multiple Formats - Supports component (YPbPr) and VGA inputs and outputs.
- Outputs - DVI-D signal (on a DVI-I connector) & 15-pin HD.
- Built-in ProcAmp - Color, sharpness, brightness, contrast, etc.
- Digital Noise Reduction - On/Off.
- Controls - Front panel buttons, on-screen menus.
- Multiple Aspect Ratio Selections.
- Compact MegaTOOLS™ - 2 units can be rack mounted side-by-side in a 1U rack space with the optional RK-T2B universal rack adapter.

TECHNICAL SPECIFICATIONS

INPUT:	1 PC/HD on a 15-pin HD connector, RGBHV/YPbPr.
OUTPUTS:	1 PC/HD on a 15-pin HD connector, RGBHV/YPbPr; 1 DVI on a DVI connector.
OUTPUT RESOLUTIONS:	PC: VGA, SVGA, XGA, 1280x800, UXGA, SXGA, WXGA, SXGA+, WXGA+, WSXGA, WUXGA; HDTV: 480p, 576p, 720p @50/60Hz, 1080p @50/60Hz, 1080i @50/60Hz.
OUTPUT REFRESH RATE:	60Hz for computer graphics resolutions, 50/60Hz for HDTV resolutions.
PROCESSING DELAY:	3 frames.
CONTROLS:	Front panel buttons, ON and component output LEDs.
POWER SOURCE:	5V DC, 1A.
DIMENSIONS:	19cm x 13.5cm x 2.5cm (7.5" x 5.3" x 0.98") W, D, H.
WEIGHT:	0.66kg (1.45lbs) approx.
ACCESSORIES:	Power supply.
OPTIONS:	RK-T2B 19" rack adapter.